

UNITED STATES  
DEPARTMENT OF THE INTERIOR  
GEOLOGICAL SURVEY

30-039-20936

## APPLICATION FOR PERMIT TO DRILL, DEEPEN, OR PLUG BACK

1a. TYPE OF WORK <b>DRILL</b> <input checked="" type="checkbox"/> <b>DEEPEN</b> <input type="checkbox"/> <b>PLUG BACK</b> <input type="checkbox"/>			5. LEASE DESIGNATION AND SERIAL NO. NM 03547		
b. TYPE OF WELL OIL WELL <input type="checkbox"/> GAS WELL <input checked="" type="checkbox"/> OTHER <input type="checkbox"/> SINGLE ZONE <input checked="" type="checkbox"/> MULTIPLE ZONE <input type="checkbox"/>			6. IF INDIAN, ALLOTTEE OR TRIBE NAME		
2. NAME OF OPERATOR Caulkins Oil Company			7. UNIT AGREEMENT NAME		
3. ADDRESS OF OPERATOR Post Office Box 780, Farmington, New Mexico			8. FARM OR LEASE NAME Breech F		
4. LOCATION OF WELL (Report location clearly and in accordance with any State requirements.)* At surface 940 from north and 1850 from west of Section 35 27 North 6 West At proposed prod. zone Same			9. WELL NO. 10		
14. DISTANCE IN MILES AND DIRECTION FROM NEAREST TOWN OR POST OFFICE* 35 miles southeast of Blanco, New Mexico			10. FIELD AND POOL, OR WILDCAT South Blanco		
15. DISTANCE FROM PROPOSED* LOCATION TO NEAREST PROPERTY OR LEASE LINE, FT. (Also to nearest drilg. unit line, if any) 940		16. NO. OF ACRES IN LEASE 1600	11. SEC., T., R., M., OR BLK. AND SURVEY OR AREA Section 35 27 North 6 West		
18. DISTANCE FROM PROPOSED LOCATION* TO NEAREST WELL, DRILLING, COMPLETED, OR APPLIED FOR, ON THIS LEASE, FT. 1120		19. PROPOSED DEPTH 3250	12. COUNTY OR PARISH Rio Arriba		
21. ELEVATIONS (Show whether DF, RT, GR, etc.) 6583 Ground		13. STATE New Mexico			
22. APPROX. DATE WORK WILL START* June 15, 1974					

PROPOSED CASING AND CEMENTING PROGRAM				
SIZE OF HOLE	SIZE OF CASING	WEIGHT PER FOOT	SETTING DEPTH	QUANTITY OF CEMENT
12 3/4"	8 5/8"	24#	120'	Sufficient to circulate
7 7/8"	3 1/2"	9.30	32.50	Approx. 300 sacks

It is proposed to drill well to approx. 3250'. 3 1/2" casing will be run to TD and cemented with sufficient cement to cover Alamo Sand. After cement sets 120 hours or more 3 1/2" will be perforated opposite Pictured Cliffs Sand and then sand water fraced. 1" IJ tubing will be run to top of Pictured Cliffs pay.

A pressure operated double blowout preventor will be used at all times while drilling below 120'.

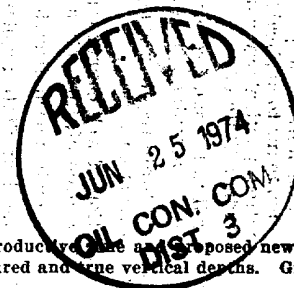

IN ABOVE SPACE DESCRIBE PROPOSED PROGRAM: If proposal is to deepen or plug back, give data on present production and proposed new productive zone. If proposal is to drill or deepen directionally, give pertinent data on subsurface locations and measured and true vertical depths. Give blowout preventer program, if any.

24. SIGNED Charles E. Dargatzis TITLE Superintendent DATE May 30, 1974

(This space for Federal or State office use)

PERMIT NO. \_\_\_\_\_ APPROVAL DATE \_\_\_\_\_

APPROVED BY SA TITLE \_\_\_\_\_ DATE \_\_\_\_\_

CONDITIONS OF APPROVAL, IF ANY:

\*See Instructions On Reverse Side

CAULKINS OIL COMPANY  
Post Office Box 780  
Farmington, New Mexico

May 30, 1974

United States Dept. of the Interior  
Geological Survey  
Post Office Box 1809  
Durango, Colorado 81301

Gentlemen:

Following is our 12 point development plan for surface use on our well number 10, located in NW $\frac{1}{4}$  of section 35 27 north 6 west, Rio Arriba County, New Mexico:

- (1) Existing road now used to service Caulkins Oil Company Well Number 11, located in NE $\frac{1}{4}$  of section 35 27 north 6 west will be used.
- (2) From well number 11 to new well number 10 approx. 1125' of new road to be built.
- (3) (4) See topo map.
- (5) no tank battery
- (6) Water will be hauled from Caulkins Oil Company water hole located in SW $\frac{1}{4}$  of section 3 26 north 6 west.
- (7) All cutting and trash will be confined in reserve pit shown on attached layout plat.
- (8) (9) No camp or airstrip.
- (10) Surface vegetation is sage brush and native grama.
- (11) Reserve pit will be cleaned up and leveled, then complete location area will be reseeded with BLM approved seed mixture.
- (12) Location will be on gentle hillside. High side of location will have approx. a 5' cut.

Yours very truly,

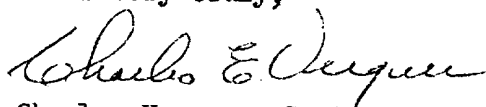

Charles Verquer, Supt.

Caulkins Oil Company

**NEW MEXICO OIL CONSERVATION COMMISSION  
WELL LOCATION AND ACREAGE DEDICATION PLAT**

Form C-102  
Supersedes C-128  
Effective 1-1-65

All distances must be from the outer boundaries of the Section.

Operator <b>Caulkins Oil Company</b>			Lease <b>NM 03547</b>		Well No. <b>10</b>
Unit Letter <b>C</b>	Section <b>35</b>	Township <b>27 North</b>	Range <b>6 West</b>	County <b>Rio Arriba</b>	
Actual Footage Location of Well: <b>940</b> feet from the <b>North</b> line and <b>1850</b> feet from the <b>West</b> line					
Ground Level Elev. <b>6583</b>	Producing Formation <b>Pictured Cliffs</b>		Pool <b>South Blanco</b>		Dedicated Acreage: <b>160</b> Acres

1. Outline the acreage dedicated to the subject well by colored pencil or hachure marks on the plat below.
2. If more than one lease is dedicated to the well, outline each and identify the ownership thereof (both as to working interest and royalty).
3. If more than one lease of different ownership is dedicated to the well, have the interests of all owners been consolidated by communitization, unitization, force-pooling, etc?

☐ Yes    ☐ No    If answer is "yes," type of consolidation \_\_\_\_\_

If answer is "no," list the owners and tract descriptions which have actually been consolidated. (Use reverse side of this form if necessary.) \_\_\_\_\_

No allowable will be assigned to the well until all interests have been consolidated (by communitization, unitization, forced-pooling, or otherwise) or until a non-standard unit, eliminating such interests, has been approved by the Commission.

**CERTIFICATION**

I hereby certify that the information contained herein is true and complete to the best of my knowledge and belief.

Name *Charles E. Vignone*

Position **Superintendent**

Company **Caulkins Oil Company**

Date **May 30, 1974**



Date Surveyed  
**May 22, 1974**

Registered Professional Engineer  
and/or Land Surveyor

*E.V. Echohawk*  
Certificate No. **3602**  
**E.V. Echohawk LS**

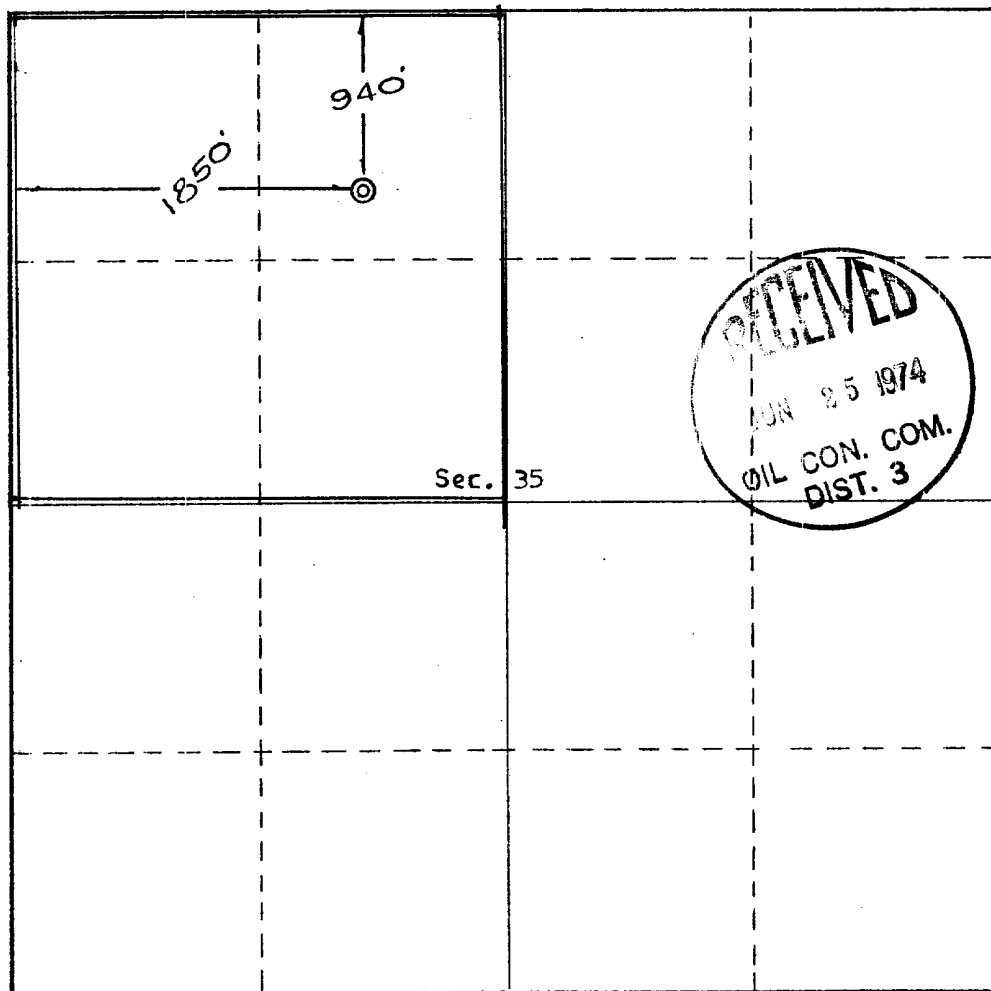

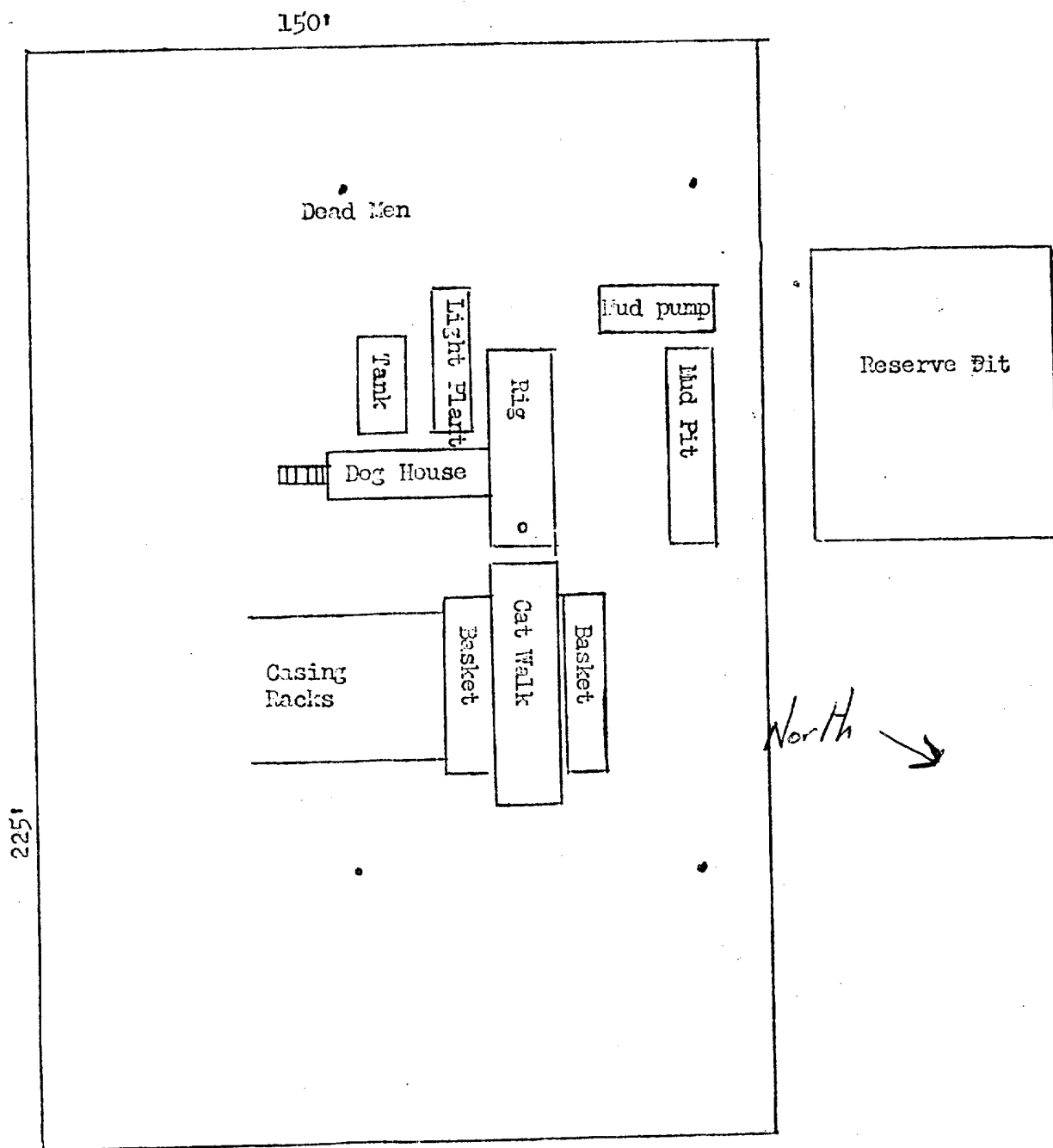

Scale - 33 1/3 feet per inch

Well number 10

Located in NW $\frac{1}{4}$  of section 35 27 north 6 west

