

UNITED STATES
DEPARTMENT OF THE INTERIOR
GEOLOGICAL SURVEY

30-039-20937

5. LEASE DESIGNATION AND SERIAL NO.

SF 080669

6. IF INDIAN, ALLOTTEE OR TRIBE NAME

7. UNIT AGREEMENT NAME

San Juan 27-4 Unit

8. FARM OR LEASE NAME

San Juan 27-4 Unit

9. WELL NO.

74

10. FIELD AND POOL, OR WILDCAT

Tapacito Pictured Cliffs

11. SEC., T., R., M., OR BLK.
AND SURVEY OR AREASec. 17, T-27-N, R-4-W
NMPM

12. COUNTY OR PARISH

Rio Arriba

13. STATE

NM

1a. TYPE OF WORK

DRILL ☒DEEPEN ☐PLUG BACK ☐

b. TYPE OF WELL

OIL
WELL ☐GAS
WELL ☒

OTHER

SINGLE
ZONE ☒MULTIPLE
ZONE ☐

2. NAME OF OPERATOR

El Paso Natural Gas Company

3. ADDRESS OF OPERATOR

PO Box 990, Farmington, NM 87401

4. LOCATION OF WELL (Report location clearly and in accordance with any State requirements.)*

At surface

810'S, 1125'E

At proposed prod. zone

14. DISTANCE IN MILES AND DIRECTION FROM NEAREST TOWN OR POST OFFICE*

15. DISTANCE FROM PROPOSED*

LOCATION TO NEAREST
PROPERTY OR LEASE LINE, FT.
(Also to nearest drlg. unit line, if any)

16. NO. OF ACRES IN LEASE

17. NO. OF ACRES ASSIGNED
TO THIS WELL

160.00

18. DISTANCE FROM PROPOSED LOCATION*

TO NEAREST WELL, DRILLING, COMPLETED,
OR APPLIED FOR, ON THIS LEASE, FT.

19. PROPOSED DEPTH

4235'

20. ROTARY OR CABLE TOOLS

Rotary

21. ELEVATIONS (Show whether DF, RT, GR, etc.)

7175'GL

22. APPROX. DATE WORK WILL START*

23.

PROPOSED CASING AND CEMENTING PROGRAM

SIZE OF HOLE	SIZE OF CASING	WEIGHT PER FOOT	SETTING DEPTH	QUANTITY OF CEMENT
12 1/4"	8 5/8"	24.0#	120'	106 cu. ft. to circulate
6 3/4"	2 7/8"	6.4#	4235'	233 cu. ft. to cover Ojo Alamo

Selectively perforate and sandwater fracture the Pictured Cliffs formation.

The SE/4 of Section 17 is dedicated to this well.

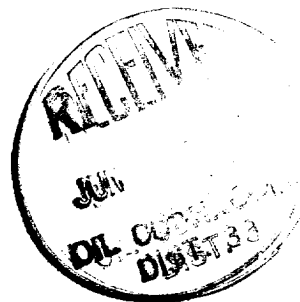

IN ABOVE SPACE DESCRIBE PROPOSED PROGRAM: If proposal is to deepen or plug back, give data on present productive zone and proposed new productive zone. If proposal is to drill or deepen directionally, give pertinent data on subsurface locations and measured and true vertical depths. Give blowout preventer program, if any.

24. SIGNED A. G. Lisco TITLE Drilling Clerk DATE June 21, 1974

(This space for Federal or State office use)

PERMIT NO. _____ APPROVAL DATE _____

APPROVED BY [Signature] TITLE _____ DATE _____

CONDITIONS OF APPROVAL, IF ANY:

*See Instructions On Reverse Side

**NEW MEXICO OIL CONSERVATION COMMISSION
WELL LOCATION AND ACERAGE DEDICATION PLAT**

All distances must be from the outer boundaries of the Section

Operator EL PASO NATURAL GAS COMPANY			Lease SAN JUAN 27-4 UNIT (SF-080669)		Well No. 74
Unit Letter P	Section 17	Township 27 NORTH	Range 4 WEST	County RIO ARriba	
Actual Footage Location of Well: 810 feet from the SOUTH line and 1125 feet from the EAST line					
Ground Level Elev. 7175.0	Producing Formation PICTURED CLIFFS	Pool TAPACITO PICTURED CLIFFS		Dedicated Acreage 160.00	Acres

1. Outline the acreage dedicated to the subject well by colored pencil or hatchure marks on the plat below.
2. If more than one lease is dedicated to the well, outline each and identify the ownership thereof (both as to working interest and royalty),
3. If more than one lease of different ownership is dedicated to the well, have the interests of all owners been consolidated by communization, unitization, force-pooling, etc?

(X) Yes () No If answer is "yes," type of consolidation Unitization

If answer is "no," list the owners and tract descriptions which have actually consolidated. (Use reverse side of this form if necessary.)

No allowable will be assigned to the well until all interests have been consolidated (by communization, unitization, forced-pooling, or otherwise) or until a non standard unit, eliminating such interests, has been approved by the Commission.

CERTIFICATION

I hereby certify that the information contained herein is true and complete to the best of my knowledge and belief.

M. G. Buies
 Name
 Drilling Clerk
 Position
 El Paso Natural Gas Co.
 Company
 June 21, 1974
 Date

I hereby certify that the well location shown on this plat was plotted from field notes of actual surveys made by me or under my supervision, and that the same is true and correct to the best of my knowledge and belief.

16 October 1973
 Date Surveyed
James P. Leese
 Registered Professional Engineer
 and/or Land Surveyor
 JAMES P. LEESE
 1963
 Certificate No. 123

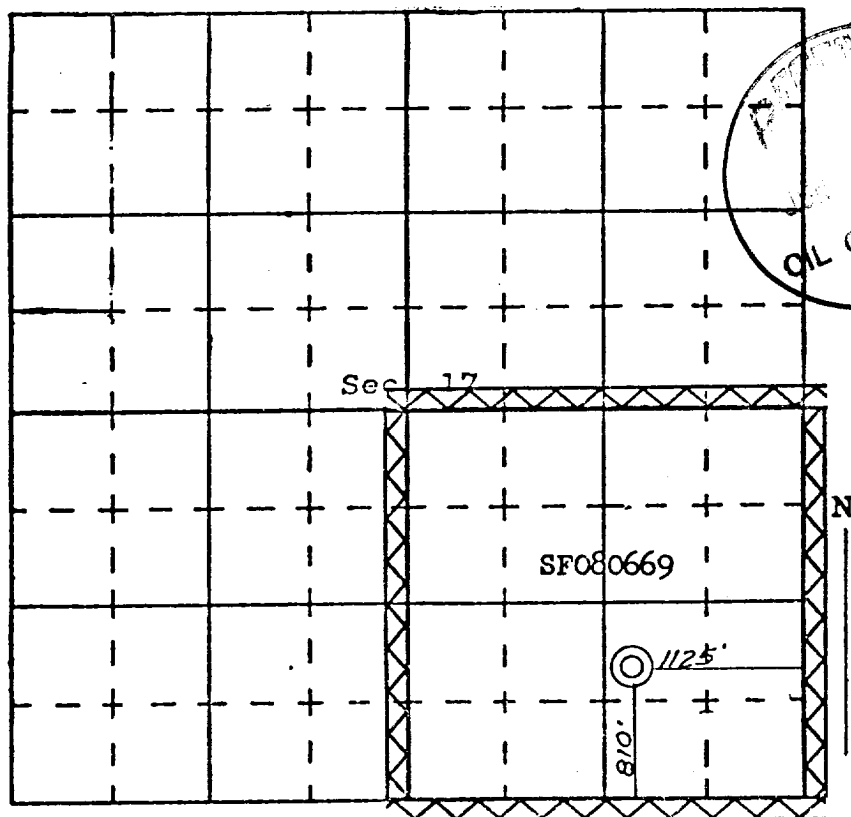

LOCATION AND EQUIPMENT LAY-OUT

San Juan Camp Station PA

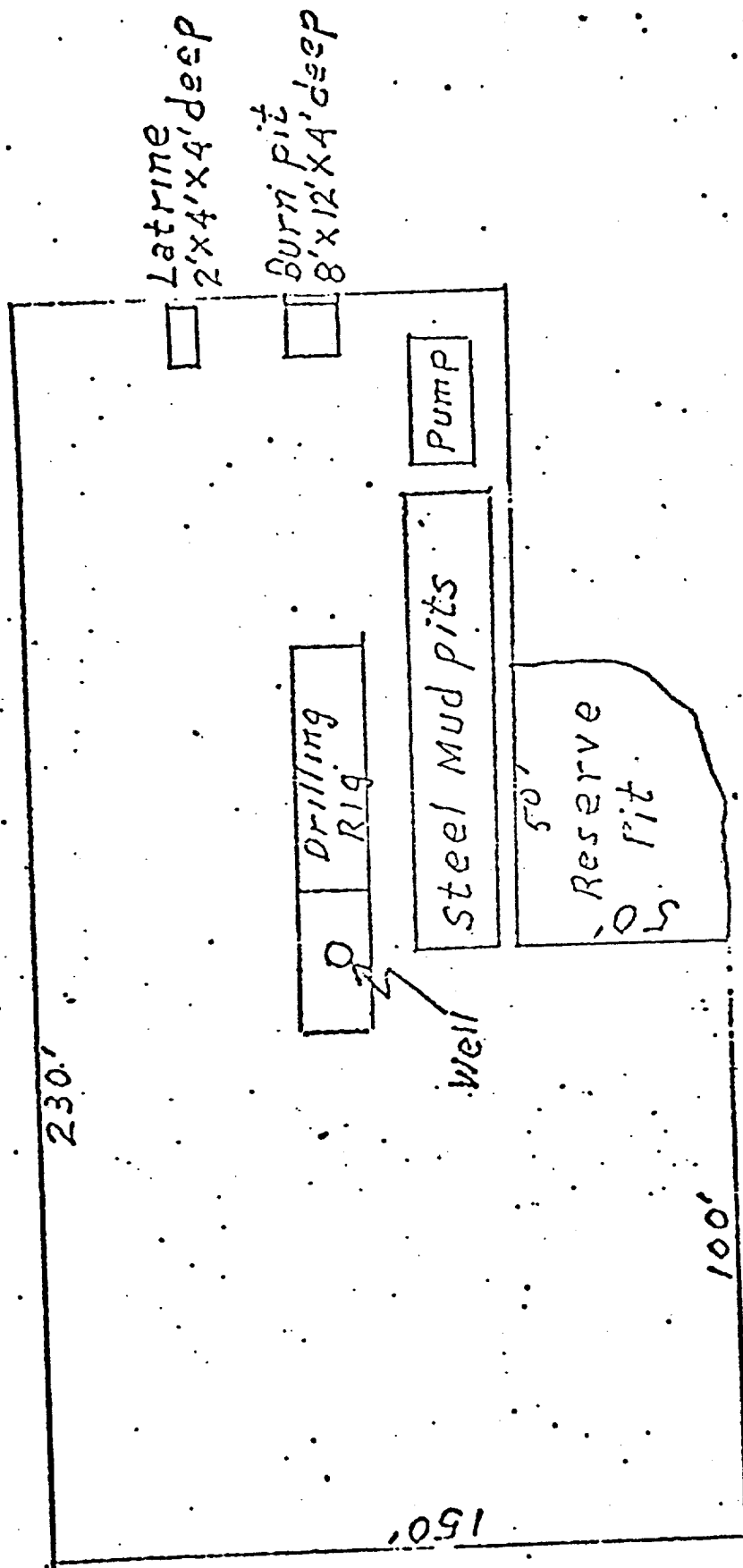

[illegible]

EXISTING ROADS	_____
EXISTING PIPELINES	++ ++
EXISTING ROAD & PIPELINE	++ ++
PROPOSED ROADS	_____
PROPOSED PIPELINES	++ ++ ++
PROPOSED ROAD & PIPELINE	++ ++ ++