

UNITED STATES  
DEPARTMENT OF THE INTERIOR  
GEOLOGICAL SURVEY30-039-21166  
5. LEASE DESIGNATION AND SERIAL NO.

## APPLICATION FOR PERMIT TO DRILL, DEEPEN, OR PLUG BACK

6. IF INDIAN, ALLOTTEE OR TRIBE NAME

Jicarilla Contract #95

7. UNIT AGREEMENT NAME

8. FARM OR LEASE NAME

Jicarilla G

9. WELL NO.

3A

10. FIELD AND POOL, OR WILDCAT

Blanco Mesaverde

11. SEC., T., R., M., OR BLK.  
AND SURVEY OR AREA

Sec. 35, T-27-N, R-3-W

12. COUNTY OR PARISH

13. STATE

Rio Arriba

New Mexico

1a. TYPE OF WORK

DRILL ☒DEEPEN ☐PLUG BACK ☐

b. TYPE OF WELL

OIL  
WELL ☐GAS  
WELL ☒

OTHER

SINGLE  
ZONE ☒MULTIPLE  
ZONE ☐

2. NAME OF OPERATOR

Mobil Oil Corporation

3. ADDRESS OF OPERATOR

P. O. Box 633, Midland, Texas 79701

4. LOCATION OF WELL (Report location clearly and in accordance with any State requirements.)

At surface

990' FNL &amp; 990' FWL, Sec. 35, T-27-N, R-3-W

At proposed prod. zone

Same as surface

14. DISTANCE IN MILES AND DIRECTION FROM NEAREST TOWN OR POST OFFICE\*

15. DISTANCE FROM PROPOSED\*

LOCATION TO NEAREST

PROPERTY OR LEASE LINE, FT.

(Also to nearest drlg. unit line, if any)

4295.4'

16. NO. OF ACRES IN LEASE

2560

17. NO. OF ACRES ASSIGNED  
TO THIS WELL

320 (2 wells)

18. DISTANCE FROM PROPOSED LOCATION\*  
TO NEAREST WELL, DRILLING COMPLETED,  
OR APPLIED FOR, ON THIS LEASE, FT.

3305'

19. PROPOSED DEPTH

6500'

20. ROTARY OR CABLE TOOLS

Rotary

21. ELEVATIONS (Show whether DF, RT, GR, etc.)

7304 Ground

22. APPROX. DATE WORK WILL START\*

As soon as possible

23.

## PROPOSED CASING AND CEMENTING PROGRAM

SIZE OF HOLE	SIZE OF CASING	WEIGHT PER FOOT	SETTING DEPTH	QUANTITY OF CEMENT
12-1/4"	8-5/8"	20# - Misco	0 - 300'	(1) Circulate to surface
7-7/8"	4-1/2"	9.5# - K-55	0 - 6500'	(2) Circulate to surface

## CEMENTING PROGRAM

(1) Class B Cement containing 2% CaCl<sub>2</sub>(2) Circulate in two stages using light weight filler cement in the lead slurry  
of each stage and tail w/ neat cement to cover pay zone.

## MUD PROGRAM

Depth	Type Mud	Weight	Viscosity	PH	Water Loss
0 - 300'	Spud				
300'-6500'	Fresh water gel	8.8-9.2	30-50	9+	10 cc

## BLOWOUT PREVENTER PROGRAM ATTACHED

IN ABOVE SPACE DESCRIBE PROPOSED PROGRAM: If proposal is to deepen or plug back, give data on present productive zone and proposed new productive zone. If proposal is to drill or deepen directionally, give pertinent data on subsurface locations and measured and true vertical depths. Give blowout preventer program, if any.

24.

SIGNED A. D. Bond A. D. Bond TITLE Proration Staff Assistant DATE December 1, 1975

(This space for Federal or State office use)

PERMIT NO.

APPROVAL DATE

APPROVED BY

TITLE

DATE

CONDITIONS OF APPROVAL, IF ANY:

\*See Instructions On Reverse Side

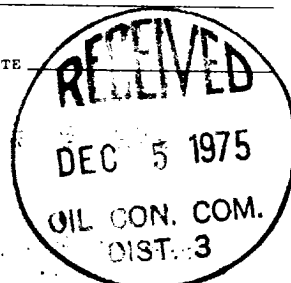

PROPOSED CHOKE MANIFOLD  
(MINIMUM REQUIREMENTS)  
8 5/8 " CASING STRING

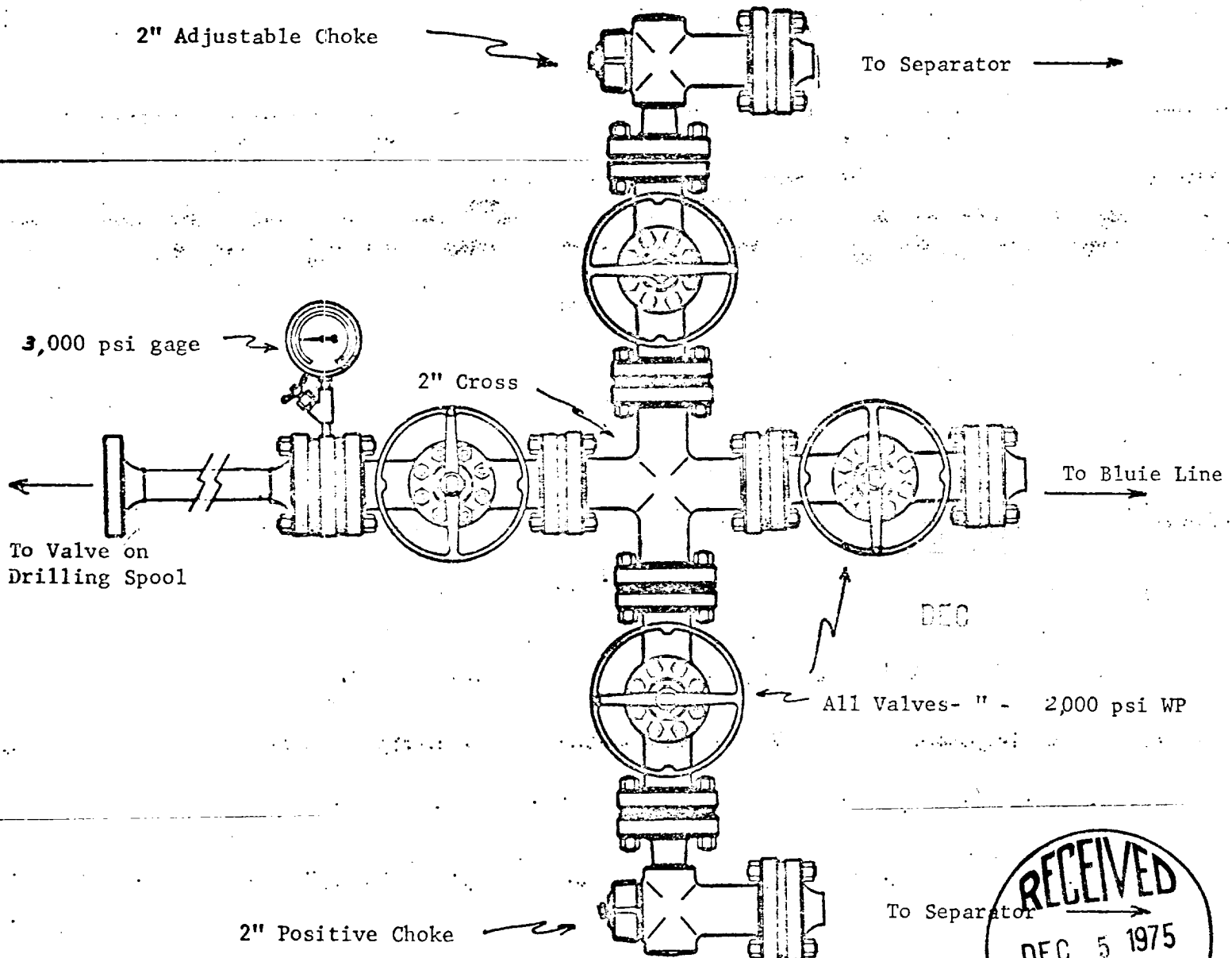

MOBIL OIL CORP.  
WELL NAME & NO. Jicarilla G  
Well #3A  
Rio Arriba COUNTY, New Mexico

PROPOSED BOP STACK  
8 5/8 " CASING

Bell Nipple

Flowline

BOP w/ BLANK Rams  
2,000 psi WP

BOP w/ PIPE Rams  
2,000 psi WP

Kill Line 2 " 2,000 psi WP

8 " Flange

RECEIVED

DEC 5 1975

OIL CON. COM.  
DIST 3

All Valves

2,000 psi WP

8 " 2,000 psi WP  
Flange

DEC

MOBIL OIL CORPORATION  
WELL Jicarilla G, Well #3A  
Rio Arriba COUNTY,  
New Mexico

*dyf*

MOBIL OIL CORPORATION  
P. O. Box 633  
Midland, Texas 79701

TWELVE-POINT SURFACE USE PLAN FOR  
DRILLING OPERATIONS ON FEDERAL LEASES

Lease Name: Jicarilla G Well No. 3A  
Well Location: 990' FNL & 990' FWL, Sec. 35, T-27-N, R-3-W  
Field: Blanco Mesaverde  
County: Rio Arriba State: New Mexico

1. \* Existing roads including location of the exit from the main highway.
2. \* Planned access roads.
3. \* Location of wells.
4. \* Lateral roads to well location.
5. \* Location of tank batteries and flow lines.
6. Location and types of water supply: Water will be trucked to the well site.
7. Methods for handling waste disposal: Waste will be burned, buried and/or hauled from the well site.
8. Location of camps: None
9. Location of air strips: None
10. Location layout to include position of rig, mud tanks, reserve pits, burn pits, pipe racks, etc.: See attached diagram of proposed rig layout.
11. Plans for restoration of the surface: Pits will be backfilled and levelled to original grade and left for return of natural vegetation. The pad will be left in place for well servicing.
12. Any other information that may be used in evaluating the impact on environment: Location falls on timbered ridge consisting of pinon and some pine trees.

\* Shown on attached map.

B50



RESERVE PIT LOCATION

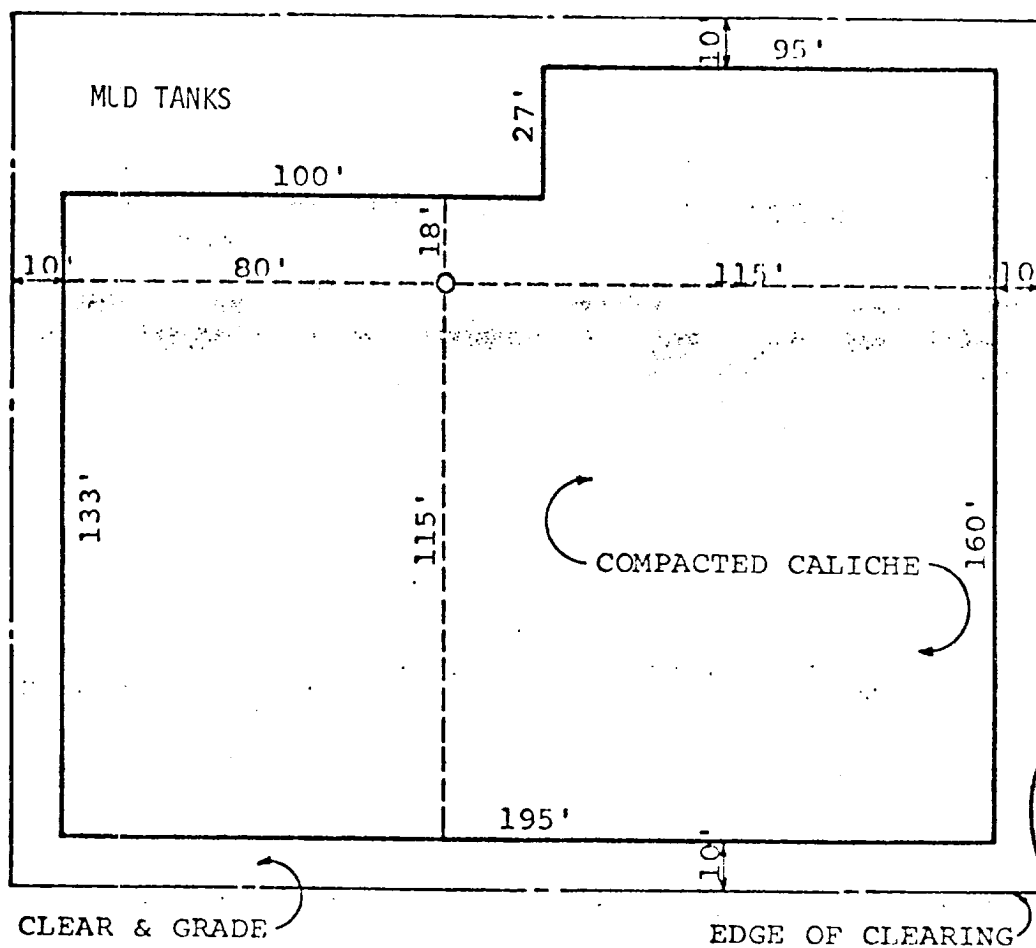

CLEAR & GRADE

EDGE OF CLEARING

APPROXIMATELY 792 C.Y. CALICHE  
REQUIRED FOR 6" COMPACTED PAD.

RECEIVED  
DEC 5 1975  
OIL CON. COM.  
DIST. 3

DEC

JICARILLA G, WELL #3A  
990' FN & WL, Sec. 35,  
T-27-N, R-3-W,  
Rio Arriba Co., New Mexico

NO.	DATE	BY	ALTERATION
STANDARD LOCATION PLAN 5000'-7000' DEEP WELLS ON STABLE SOIL			
MOBIL OIL CORPORATION Midland, Texas			
DRAWN C.L.T.		ENG. NO.	
CHECKED		SCALE 1"=40'	
		DATE 9-15-66	
		A-322	

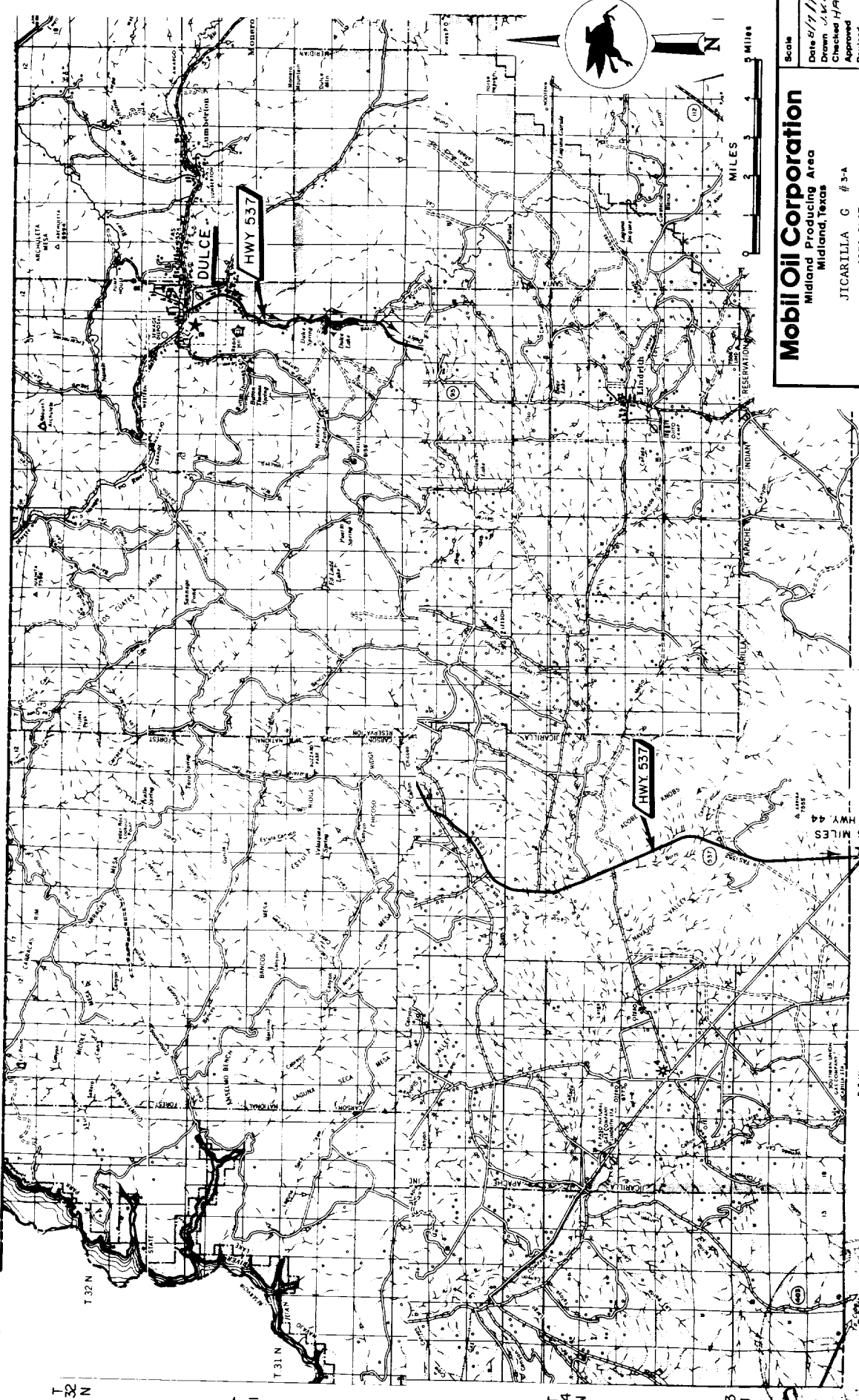

**Mobil Oil Corporation**  
Midland Producing Area  
Midland, Texas  
JTCARILLA G # 3-A  
AREA PLAT  
RIO ARriba COUNTY, NEW MEXICO

Scale  
Date 8/1/53  
Drawn J.M.H.  
Checked H.A.C.  
Approved  
Revised

4.6 MILES  
TO HWY. 44

DIST 3

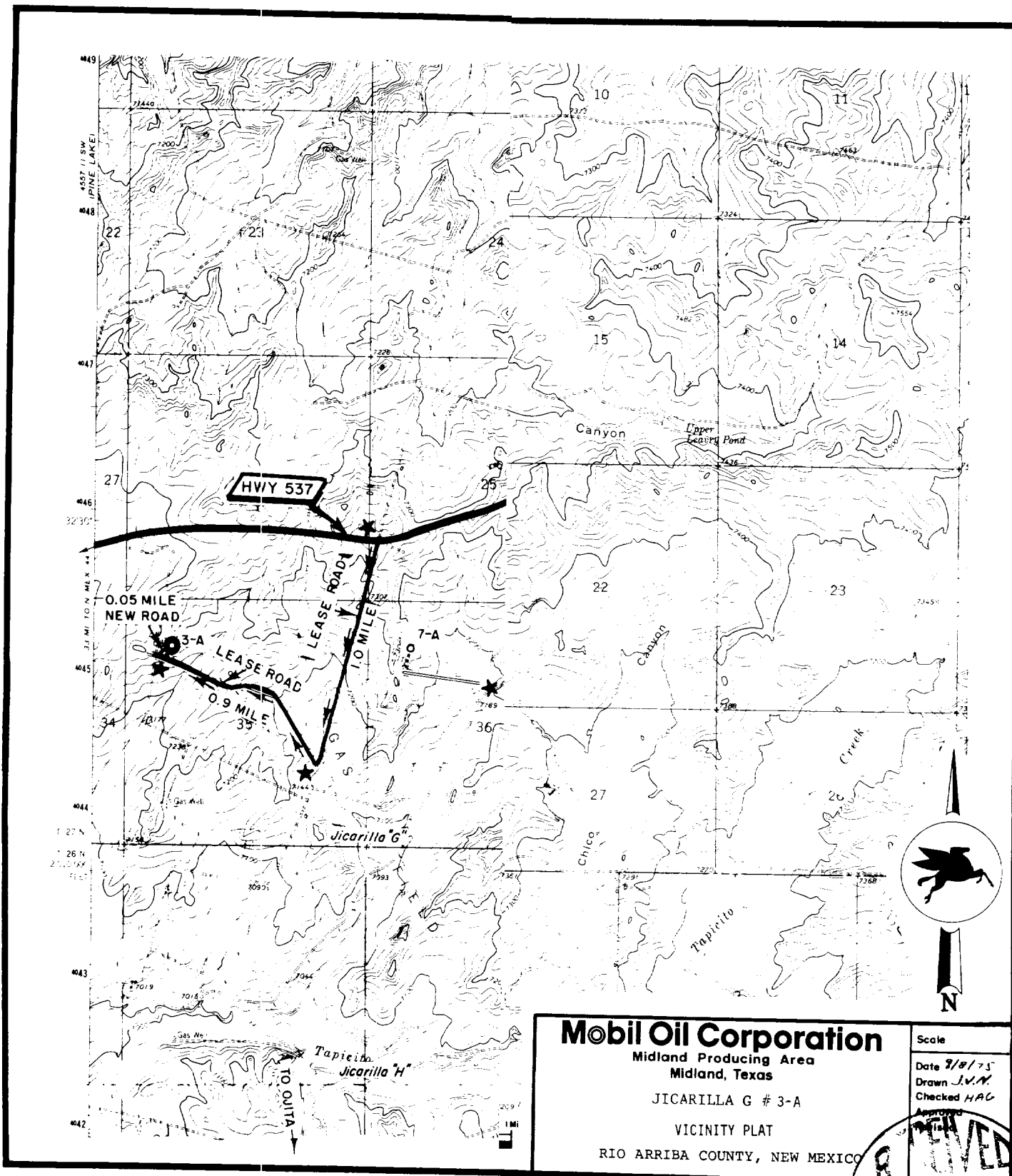

**NEW MEXICO OIL CONSERVATION COMMISSION  
WELL LOCATION AND ACREAGE DEDICATION PLAT**

Form C-102  
Supersedes C-128  
Effective 1-1-65

All distances must be from the outer boundaries of the Section.

Operator <b>Mobil Oil Corporation</b>			Lease <b>Jicarilla G</b>		Well No. <b>3A</b>
Unit Letter <b>D</b>	Section <b>35</b>	Township <b>27N</b>	Range <b>3W</b>	County <b>Rio Arriba</b>	
Actual Footage Location of Well: <div style="display: flex; justify-content: space-between;"> <span>990' feet from the North line and</span> <span>990' feet from the West line</span> </div>					
Ground Level elev. <b>7304'</b>	Producing Formation <b>Mesaverde</b>	Pool <b>Blanco Mesaverde</b>	Dedicated Acreage: <b>320 (2 wells)</b> Acres		

1. Outline the acreage dedicated to the subject well by colored pencil or hachure marks on the plat below.
2. If more than one lease is dedicated to the well, outline each and identify the ownership thereof (both as to working interest and royalty).
3. If more than one lease of different ownership is dedicated to the well, have the interests of all owners been consolidated by communitization, unitization, force-pooling, etc?

☐ Yes ☐ No If answer is "yes," type of consolidation \_\_\_\_\_

If answer is "no," list the owners and tract descriptions which have actually been consolidated. (Use reverse side of this form if necessary.) \_\_\_\_\_

No allowable will be assigned to the well until all interests have been consolidated (by communitization, unitization, forced-pooling, or otherwise) or until a non-standard unit, eliminating such interests, has been approved by the Commission.

N 89° 59' E 5297.9'

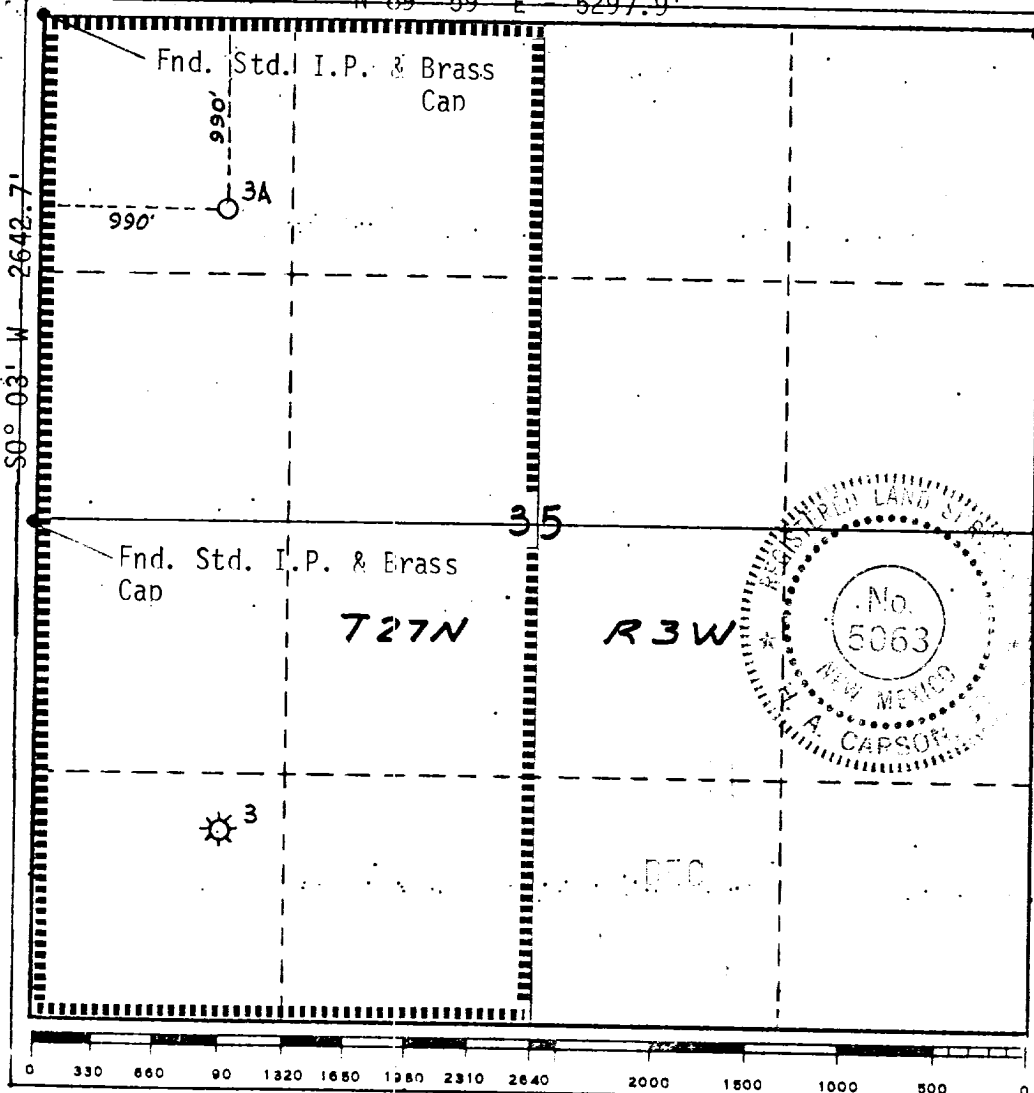

**CERTIFICATION**

I hereby certify that the information contained herein is true and complete to the best of my knowledge and belief.

Name  
**A. D. Bond**

Position  
**Proration Staff Assistant**

Company  
**Mobil Oil Corporation**

Date  
**December 1, 1975**

I hereby certify that the well location shown on this plat was plotted from field notes of actual surveys made by me or under my supervision, and that the same is true and correct to the best of my knowledge and belief.

Date Surveyed  
**August 13, 1975**

Registered Professional Engineer and/or Land Surveyor  
**H. A. Carson, Jr.**

Certificate No.  
**5063**

