

UNITED STATES
DEPARTMENT OF THE INTERIOR
GEOLOGICAL SURVEY

API - 30-039-21200

5. LEASE DESIGNATION AND SERIAL NO.

SF-078048

6. IF INDIAN, ALLOTTEE OR TRIBE NAME

7. UNIT AGREEMENT NAME

8. FARM OR LEASE NAME

Porkchop

9. WELL NO.

2

10. FIELD AND POOL, OR WILDCAT

Ballard, PC

11. SEC., T., R., M., OR BLK.
AND SURVEY OR AREA

Sec. 29, T26N, R7W

12. COUNTY OR PARISH

Rio Arriba

13. STATE

New Mexico

1a. TYPE OF WORK

DRILL ☒DEEPEN ☐PLUG BACK ☐

b. TYPE OF WELL

OIL
WELL ☐GAS
WELL ☒

OTHER

SINGLE
ZONE ☒MULTIPLE
ZONE ☐

2. NAME OF OPERATOR

LYNCO OIL CORPORATION

3. ADDRESS OF OPERATOR

7890 E. Prentice Ave. Englewood, Colorado 80110

4. LOCATION OF WELL (Report location clearly and in accordance with any State requirements.)*

At surface

1650' FSL and 1850' FEL

At proposed prod. zone

SAME

14. DISTANCE IN MILES AND DIRECTION FROM NEAREST TOWN OR POST OFFICE*

16 miles North of Lybrook, New Mexico

15. DISTANCE FROM PROPOSED*

LOCATION TO NEAREST
PROPERTY OR LEASE LINE, FT.
(Also to nearest drlg. unit line, if any)

790'

16. NO. OF ACRES IN LEASE

160

17. NO. OF ACRES ASSIGNED
TO THIS WELL

160

18. DISTANCE FROM PROPOSED LOCATION*
TO NEAREST WELL, DRILLING, COMPLETED,
OR APPLIED FOR, ON THIS LEASE, FT.

19. PROPOSED DEPTH

3200

20. ROTARY OR CABLE TOOLS

Rotary

21. ELEVATIONS (Show whether DF, RT, GR, etc.)

7083 GR

22. APPROX. DATE WORK WILL START*

March 30, 1976

23.

PROPOSED CASING AND CEMENTING PROGRAM

SIZE OF HOLE	SIZE OF CASING	WEIGHT PER FOOT	SETTING DEPTH	QUANTITY OF CEMENT
12 1/4"	8 5/8"	20.00	100'	75 sacks - Circulated
7 7/8"	4 1/2"	10.50	3200'	150 sacks

Drill 7 7/8" hole with mud to Total Depth of 3200'. Run and cement 4 1/2" casing with 150 sacks. Perforate and fracture treat Pictured Cliffs formation. Run 1 1/4" tubing, test and complete well.

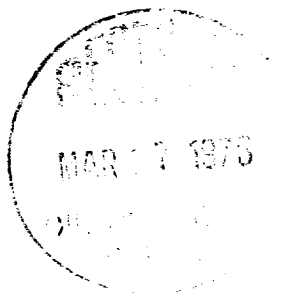

IN ABOVE SPACE DESCRIBE PROPOSED PROGRAM: If proposal is to deepen or plug back, give data on present productive zone and proposed new productive zone. If proposal is to drill or deepen directionally, give pertinent data on subsurface locations and measured and true vertical depths. Give blowout preventer program, if any.

24. SIGNED CRISTINA L. FUNDINGSLAND, JR. TITLE Vice President DATE 3/12/76

(This space for Federal or State office use)

PERMIT NO. _____

APPROVAL DATE _____

APPROVED BY _____

TITLE _____

DATE _____

CONDITIONS OF APPROVAL, IF ANY:

Okal

*See Instructions On Reverse Side

Instructions

General: This form is designed for submitting proposals to perform certain well operations, as indicated, on all types of lands and leases for appropriate action by either a Federal or a State agency, or both, pursuant to applicable Federal and/or State laws and regulations. Any necessary special instructions concerning the use of this form and the number of copies to be submitted, particularly with regard to local, area, or regional procedures and practices, either are shown below or will be issued by, or may be obtained from, the local Federal and/or State office.

Item 1: If the proposal is to redrill to the same reservoir at a different subsurface location or to a new reservoir, use this form with appropriate notations. Consult applicable State or Federal regulations concerning subsequent work proposals or reports on the well.

Item 4: If there are no applicable State requirements, locations on Federal or Indian land should be described in accordance with Federal requirements. Consult local State or Federal office for specific instructions.

Item 14: Needed only when location of well cannot readily be found by road from the land or lease description. A plat, or plats, separate or on this reverse side, showing the roads to, and the surveyed location of, the well, and any other required information, should be furnished when required by Federal or State agency offices.

Items 15 and 18: If well is to be, or has been directionally drilled, give distances for subsurface location of hole in any present or objective production zone.

Item 22: Consult applicable Federal or State regulations, or appropriate officials, concerning approval of the proposal before operations are started.

**NEW MEXICO OIL CONSERVATION COMMISSION
WELL LOCATION AND ACREAGE DEDICATION PLAT**

Form C-102
Supersedes C-128
Effective 1-1-65

All distances must be from the outer boundaries of the Section.

Operator Lynco Oil Corporation			Lease Porkchop		Well No. 2
Unit Letter J	Section 29	Township 26 North	Range 7 West	County Rio Arriba	
Actual Footage Location of Well: 1650 feet from the South line and 1850 feet from the East line					
Ground Level Elev. 7083	Producing Formation Pictured Cliffs	Pool Ballard		Dedicated Acreage: 160 Acres	

1. Outline the acreage dedicated to the subject well by colored pencil or hachure marks on the plat below.
2. If more than one lease is dedicated to the well, outline each and identify the ownership thereof (both as to working interest and royalty).
3. If more than one lease of different ownership is dedicated to the well, have the interests of all owners been consolidated by communitization, unitization, force-pooling, etc?

☐ Yes ☐ No If answer is "yes," type of consolidation _____

If answer is "no," list the owners and tract descriptions which have actually been consolidated. (Use reverse side of this form if necessary.) _____

No allowable will be assigned to the well until all interests have been consolidated (by communitization, unitization, forced-pooling, or otherwise) or until a non-standard unit, eliminating such interests, has been approved by the Commission.

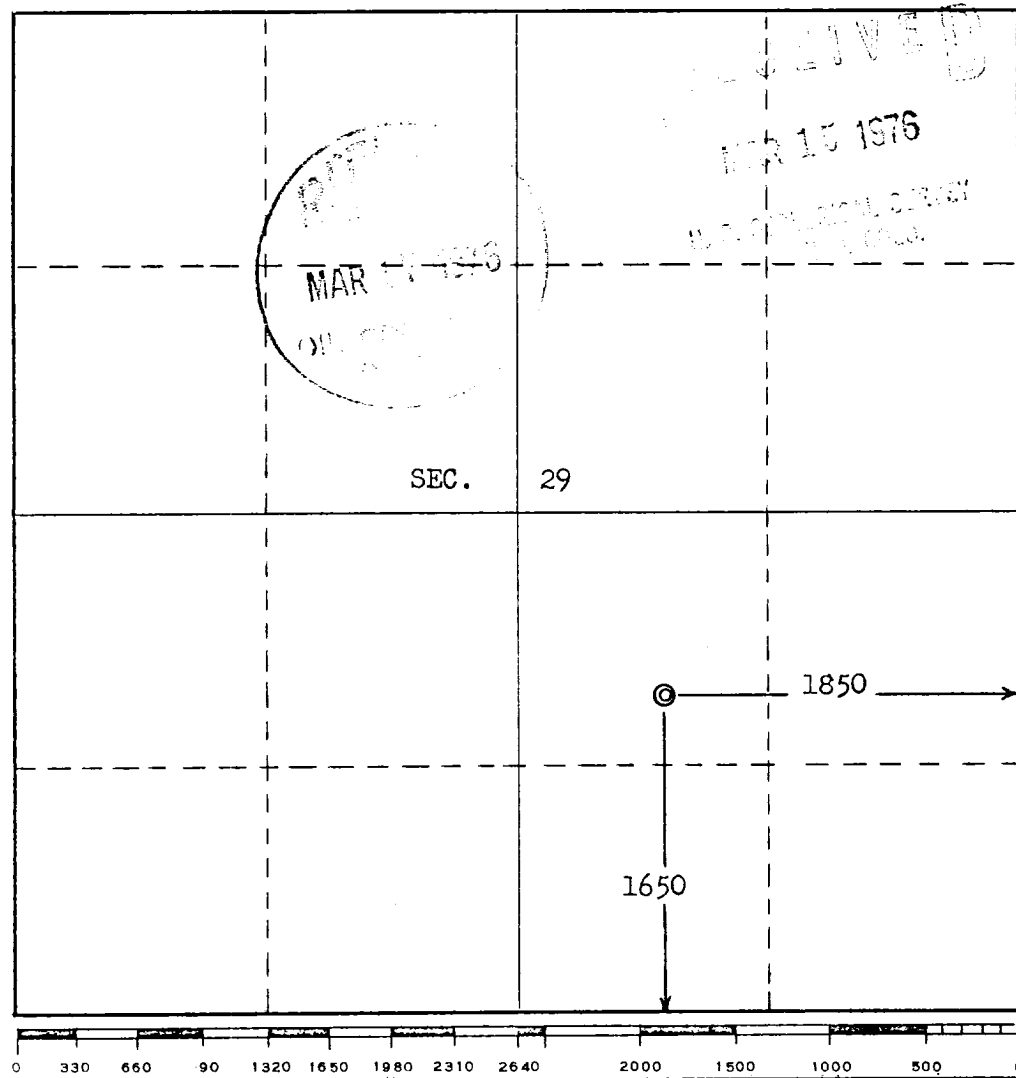

CERTIFICATION

I hereby certify that the information contained herein is true and complete to the best of my knowledge and belief.

**ORIGINAL SIGNED BY
E. L. FUNDINGSLAND, JR.**

Name
E. L. Fundingsland, Jr.

Position
Vice President

Company
Lynco Oil Corporation

Date
March 12, 1976

I hereby certify that the well location shown on this plat was plotted from field notes of actual surveys made by me or under my supervision, and that the same is true and correct to the best of my knowledge and belief.

Date Surveyed
March 9, 1976

Registered Professional Engineer
and/or Land Surveyor

E. V. Echohawk

Certificate No. **3602**
E.V. Echohawk LS

LYNCO OIL CORPORATION

#2 DENVER TECHNOLOGICAL CENTER
7890 E. PRENTICE AVE.
ENGLEWOOD, COLORADO 80110
303 - 770-0903

SURFACE DEVELOPMENT PLAN
PORKCHOP #2 - PICTURED CLIFFS TEST
SE $\frac{1}{4}$ SECTION 29 T26N R7W
RIO ARriba COUNTY, NEW MEXICO

1. Existing roads are shown on the attached USGS Topographic Map.
2. No new access road will be constructed due to the presence of existing roads.
3. Water for drilling will be purchased from the Hill Top Liquor Store.
4. Waste and disposal will be burned in the burn pits, latrine or reserve pit as applicable.
5. There will be no airstrip or camp associated with the drilling of this well.
6. Upon completion or abandonment of this test, the location will be cleaned, leveled and restored and a dry hole marker placed if applicable.
7. Other BLM stipulations will be followed.

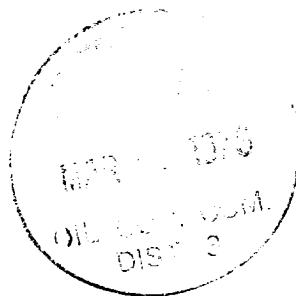

MAR 15 1976
U.S. DEPT. OF THE INTERIOR
BUREAU OF LAND MANAGEMENT

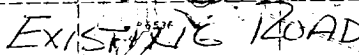

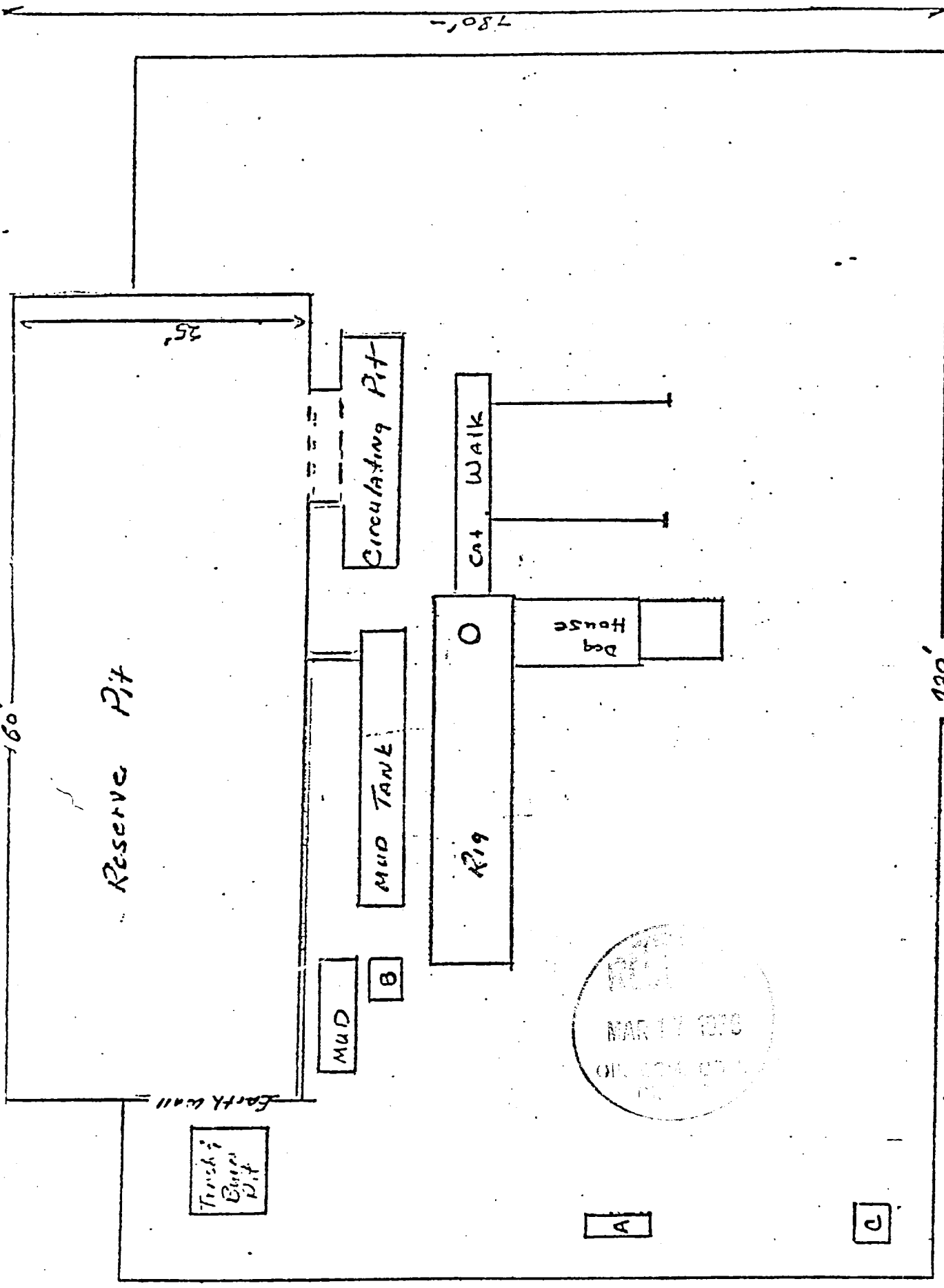

PORK CHOP #2

- A Propane Tank
- B Mud Pump
- C Latrine