

UNITED STATES
DEPARTMENT OF THE INTERIOR
BUREAU OF LAND MANAGEMENT

30-039-24749

APPLICATION FOR PERMIT TO DRILL, DEEPEN, OR PLUG BACK

1a. TYPE OF WORK DRILL		5. LEASE NUMBER SF-080385	
1b. TYPE OF WELL GAS		6. IF INDIAN, ALL. OR TRIBE NAME	
2. OPERATOR UNION OIL CO. OF CAL.		7. UNIT AGREEMENT NAME RINCON UNIT	
3. ADDRESS OF OPERATOR P O BOX 2074 FARMINGTON, NM, 87401 (505)-325-8786		8. FARM OR LEASE NAME RINCON Unit	
4. LOCATION OF WELL 850' FNL, 790' FEL		9. WELL NO. 284	
10. FIELD, POOL, OR WILDCAT BASIN FRUITLAND COAL		11. SEC. 26, T. 27N, R. 07W	
14. DISTANCE FROM NEAREST TOWN 40 Miles SE of Bloomfield		12. COUNTY Rio Arriba	13. STATE New Mex.
15. DISTANCE FROM PROPOSED LOCATION TO NEAREST PROPERTY OR LEASE LINE 790'	16. ACRES IN LEASE 2560.00	17. ACRES ASSIGNED TO WELL E / 320 340.56	
18. DISTANCE FROM PROPOSED LOCATION TO NEAREST WELL DRILLING, COMPLETED OR APPLIED FOR ON THIS LEASE: 259'	19. PROPOSED DEPTH 3372'	20. ROTARY OR CABLE TOOLS Rotary	
21. ELEVATIONS (DF, FT, GR, ETC.) 6742' GL	22. APPROX. DATE WORK WILL BEGIN Spring 1990		
23. PROPOSED CASING AND CEMENTING PROGRAM SEE ATTACHED DRILLING PLAN			
24. AUTHORIZED BY: <u>Chris Russell</u> <u>4/6/90</u> AGENT DATE			
PERMIT NO. _____ APPROVAL DATE _____ APPROVED BY _____ TITLE _____ DATE _____			
NOTE: THIS FORMAT IS ISSUED IN LIEU OF BLM FORM 3160			

RECEIVED

MAY 07 1990

OIL CON. DIV.
DIST. 3

This action is subject to technical and
procedural review pursuant to 43 CFR 3160
and appeal pursuant to 43 CFR 3160.4.

APPROVED
AS AMENDED

MAY 03 1990

AREA MANAGER

OK
(9)

034100Z

FM T-100

TO C-100

2 100

Submit to Appropriate
District Office
State Lease - 4 copies
Fee Lease - 3 copies

State of New Mexico
Energy, Minerals and Natural Resources Department

Form C-102
Revised 1-1-89

OIL CONSERVATION DIVISION

P.O. Box 2088
Santa Fe, New Mexico 87504

DISTRICT I
P.O. Box 1980, Hobbs, NM 88240

DISTRICT II
P.O. Drawer DD, Artesia, NM 88210

DISTRICT III
1000 Rio Arriba Rd., Aztec, NM 87410

WELL LOCATION AND ACREAGE DEDICATION PLAT

All Distances must be from the outer boundaries of the section

Operator UNION OIL CO. OF CALIFORNIA			Lease RINCON UNIT		Well No. 284
Unit Letter A	Section 26	Township T.27 N.	Range R.7 W.	County RIO ARRIBA COUNTY	
Actual Footage Location of Well: 850 feet from the NORTH line and 790 feet from the EAST line					
Ground level Elev. 6742	Producing Formation FRUITLAND COAL		Pool BASIN FRUITLAND COAL		Dedicated Acreage: 320.346.56 Acres

- Outline the acreage dedicated to the subject well by colored pencil or hatchure marks on the plat below.
- If more than one lease is dedicated to the well, outline each and identify the ownership thereof (both as to working interest and royalty).
- If more than one ownership is dedicated to the well, have the interest of all owners been consolidated (by communitization, unitization, force-pooling, etc.)?
☐ Yes ☐ No If answer is "yes" type of consolidation _____
If answer is "no" list the owners and tract descriptions which have actually been consolidated. (Use reverse side of this form if necessary.)
No allowable will be assigned to the well until all interests have been consolidated (by communitization, unitization, forced-pooling, or otherwise) or until a non-standard unit, eliminating such interest, has been approved by the Division.

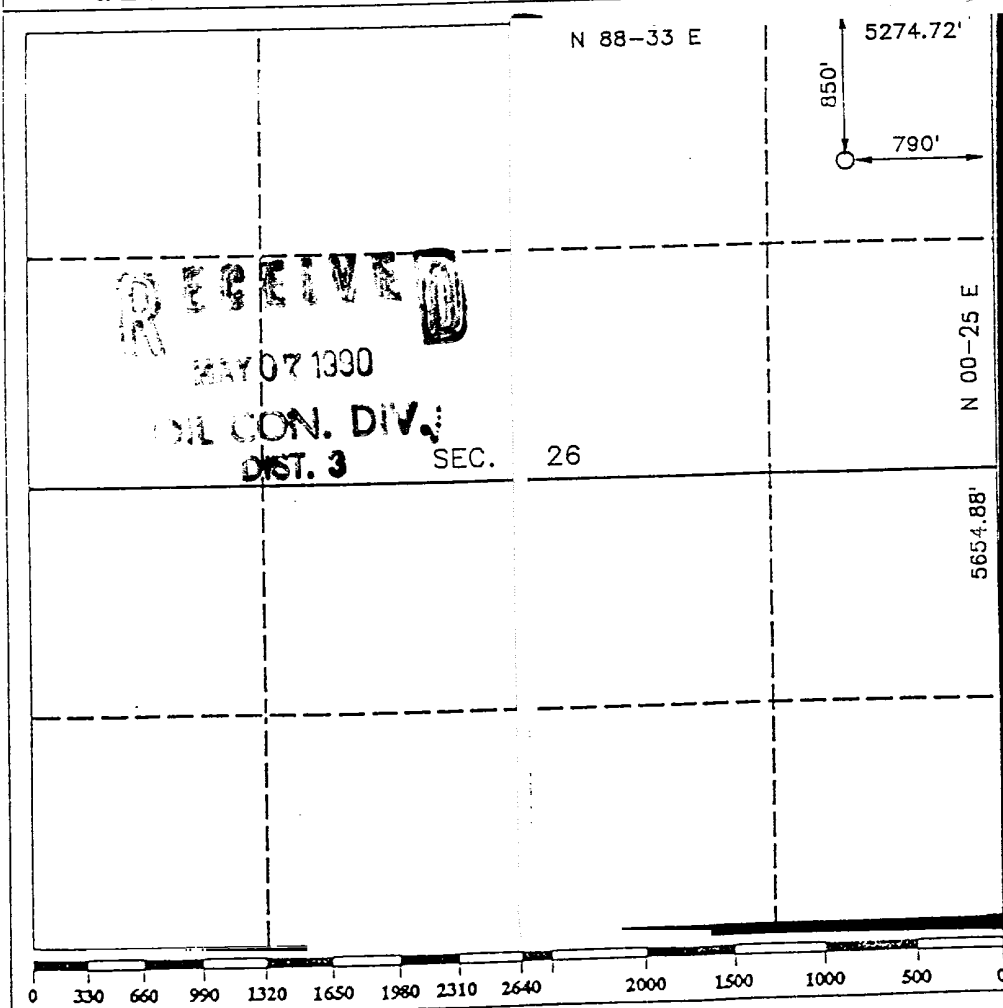

OPERATOR CERTIFICATION
I hereby certify that the information contained herein is true and complete to the best of my knowledge and belief.

Signature
Chris Russell
Printed Name
Chris Russell
Position
AGENT
Company
UNOCAL
Date
4/6/90

SURVEYOR CERTIFICATION

I hereby certify that the well location shown on this plat was plotted from field notes actual surveys made by me or under my supervision, and that the same is true and correct to the best of my knowledge and belief.

Date Surveyed
MARCH 25, 1990
Signature of Professional Surveyor
R. Howard Daggett
Professional Surveyor
9678
Certificate No.
9678
Registered Professional
Land Surveyor