

UNITED STATES
DEPARTMENT OF THE INTERIOR
BUREAU OF LAND MANAGEMENT

APPLICATION FOR PERMIT TO DRILL, DEEPEN, OR PLUG BACK

1a. TYPE OF WORK
DRILL ☒ DEEPEN ☐ PLUG BACK ☐

b. TYPE OF WELL
OIL WELL ☐ GAS WELL ☒ OTHER ☐ SINGLE ZONE ☒ MULTIPLE ZONE ☐

2. NAME OF OPERATOR
Union Oil Company of California

3. ADDRESS OF OPERATOR
1004 N. Big Spring St. #635, Midland, TX 79701-3340

4. LOCATION OF WELL (Report location clearly and in accordance with any State requirements.)
At surface
1581' FNL and 1929' FEL, Sec 20, T27N, R6W
At proposed prod. zone
Same

14. DISTANCE IN MILES AND DIRECTION FROM NEAREST TOWN OR POST OFFICE*
Approximately 40 miles southeast of Bloomfield, N.M.

10. DISTANCE FROM PROPOSED* LOCATION TO NEAREST PROPERTY OR LEASE LINE, FT. (Also to nearest drig. unit line, if any)
702'

18. NO. OF ACRES IN LEASE
2558.72'

17. NO. OF ACRES ASSIGNED TO THIS WELL
320

19. PROPOSED DEPTH
3140'

20. ROTARY OR CABLE TOOLS
Rotary

22. APPROX. DATE WORK WILL START*
ASAP

21. ELEVATIONS (Show whether DF, RT, GR, etc.)
6480' GL

23. PROPOSED CASING AND CEMENTING PROGRAM

SIZE OF HOLE	SIZE OF CASING	WEIGHT PER FOOT	SETTING DEPTH	
12-1/4"	8-5/8"	24 #	225'	175 sacks to surface
7-7/8"	5-1/2"	17 #	3140'	410 sacks to surface

Proposed Drilling Program

MIRU. Drill 12-1/4" hole with spud mud to 225'. Survey. Rig up and run casing and cement as outlined in attached drilling plan. WOC @ 18 hours. NUBOP, choke, and kill line (2000#) and test same plus casing. Drill out with 7-7/8" hole from 225' to T.D. with fresh water mud. Run surveys @ 500' intervals or first bit trip succeeding 500'. At T.D. log with DISFL, GR, SP, FDC, CNL-GR. Run and cement casing as outlined in attached drilling plan. RDMOL.

IN ABOVE SPACE DESCRIBE PROPOSED PROGRAM: If proposal is to deep zone. If proposal is to drill or deepen directionally, give pertinent preventer program, if any.

24.

SIGNER

(This space for Federal or State office use)

PERMIT NO.

APPROVED BY
CONDITIONS OF APPROVAL, IF ANY:

TITLE Agent for UNOCAL

APPROVAL DATE

TITLE

NMOCD

*See Instructions On Reverse Side

RECEIVED

MAR 26 1990

productivity
used and true vertical depth. Give blowout
OH CON. DIV
DIST. 3

DATE 10/27/89

APPROVED
AS AMENDED

MAR 20 1990

AREA MANAGER

RECEIVED

WARS 8-19-41

OIL COM. CIV.
DIST. 3

UNITED STATES
DEPARTMENT OF THE INTERIOR
BUREAU OF LAND MANAGEMENT

SUBMIT IN TRIPLICATE*
(Other instructions on re-
verse side)

Budget Bureau No. 1004-0135
Expires August 31, 1985

SUNDRY NOTICES AND REPORTS ON WELLS

(Do not use this form for proposals to drill or to deepen or plug back to a different reservoir.
Use "APPLICATION FOR PERMIT—" for such proposals.)

1. OIL WELL <input type="checkbox"/> GAS WELL <input checked="" type="checkbox"/> OTHER	5. LEASE DESIGNATION AND SERIAL NO. SF-079366
2. NAME OF OPERATOR Union Oil of California, Inc.	6. IF INDIAN, ALLOTTEE OR TRIBE NAME
3. ADDRESS OF OPERATOR P.O. Box 2074 Farmington, NM, 87401	7. UNIT AGREEMENT NAME RINCON UNIT
4. LOCATION OF WELL (Report location clearly and in accordance with any State requirements.* See also space 17 below.) At surface 1581' FNL, 1929' FEL, Sec20, T27N, R6E	8. FARM OR LEASE NAME RINCON
14. PERMIT NO.	9. WELL NO. #254
15. ELEVATIONS (Show whether DF, RT, GR, etc.) 6480' GL	10. FIELD AND POOL, OR WILDCAT Fruitland Coal
	11. SEC., T., R., M., OR BLK. AND SURVEY OR AREA Sec.20 T27N, R6E
	12. COUNTY OR PARISH Rio Arriba
	13. STATE NM

16. Check Appropriate Box To Indicate Nature of Notice, Report, or Other Data

NOTICE OF INTENTION TO:		SUBSEQUENT REPORT OF:	
TEST WATER SHUT-OFF <input type="checkbox"/>	PULL OR ALTER CASING <input type="checkbox"/>	WATER SHUT-OFF <input type="checkbox"/>	REPAIRING WELL <input type="checkbox"/>
FRACTURE TREAT <input type="checkbox"/>	MULTIPLE COMPLETE <input type="checkbox"/>	FRACTURE TREATMENT <input type="checkbox"/>	ALTERING CASING <input type="checkbox"/>
SHOOT OR ACIDIZE <input type="checkbox"/>	ABANDON* <input type="checkbox"/>	SHOOTING OR ACIDIZING <input type="checkbox"/>	ABANDONMENT* <input type="checkbox"/>
REPAIR WELL <input type="checkbox"/>	CHANGE PLANS <input checked="" type="checkbox"/>	(Other) <input type="checkbox"/>	
(Other) <input type="checkbox"/>		(NOTE: Report results of multiple completion on Well Completion or Recompletion Report and Log form.)	

17. DESCRIBE PROPOSED OR COMPLETED OPERATIONS (Clearly state all pertinent details, and give pertinent dates, including estimated date of starting any proposed work. If well is directionally drilled, give subsurface locations and measured and true vertical depths for all markers and zones pertinent to this work.)*

1. Attached please find new acreage dedication(this well is now orthodox).
- 2.Change casing from 5-1/2" to 4-1/2", K-55, 10½#. Cement volumes will be increased in order to circulate cement to surface.

RECEIVED
MAR 2 6 1990
OIL CON. DIV
DIST. 3
FARMINGTON, NEW MEXICO
90 MAR -5 AM 8:
RECEIVED
MAIL ROOM

18. I hereby certify that the foregoing is true and correct
SIGNED Chris Russell TITLE Agent DATE 3/5/90
(This space for Federal or State office use)

APPROVED BY _____ TITLE _____ DATE _____
CONDITIONS OF APPROVAL, IF ANY:

NMOCD

*See Instructions on Reverse Side

01111111

01111111

01111111
01111111

Submit to Appropriate
District Office
State Lease - 4 copies
Fee Lease - 3 copies

State of New Mexico
Energy, Minerals and Natural Resources Department

Form C-102
Revised 1-1-89

OIL CONSERVATION DIVISION

P.O. Box 2088
Santa Fe, New Mexico 87504-2088

DISTRICT I
P.O. Box 1980, Hobbs, NM 88240

DISTRICT II
P.O. Drawer DD, Artesia, NM 88210

DISTRICT III
1000 Rio Brazos Rd., Aztec, NM 87410

WELL LOCATION AND ACREAGE DEDICATION PLAT
All Distances must be from the outer boundaries of the section

Operator Unocal, Inc.			Lease Rincon		
Unit Letter G	Section 20	Township T. 27 N.	Range R. 6 W.	County NMPM	Well No. Unit #254
Actual Footage Location of Well: 1581' feet from the North line and 1929' feet from the East line					
Ground level Elev. 6480'	Producing Formation Fruitland Coal		Pool Fruitland Coal	Dedicated Acreage: 320 Acres	

1. Outline the acreage dedicated to the subject well by colored pencil or hatchure marks on the plat below.
2. If more than one lease is dedicated to the well, outline each and identify the ownership thereof (both as to working interest and royalty).
3. If more than one lease of different ownership is dedicated to the well, have the interest of all owners been consolidated by communitization, unitization, force-pooling, etc.?
☐ Yes ☐ No If answer is "yes" type of consolidation _____
If answer is "no" list the owners and tract descriptions which have actually been consolidated. (Use reverse side of this form if necessary.)
No allowable will be assigned to the well until all interests have been consolidated (by communitization, unitization, forced-pooling, or otherwise) or until a non-standard unit, eliminating such interest, has been approved by the Division.

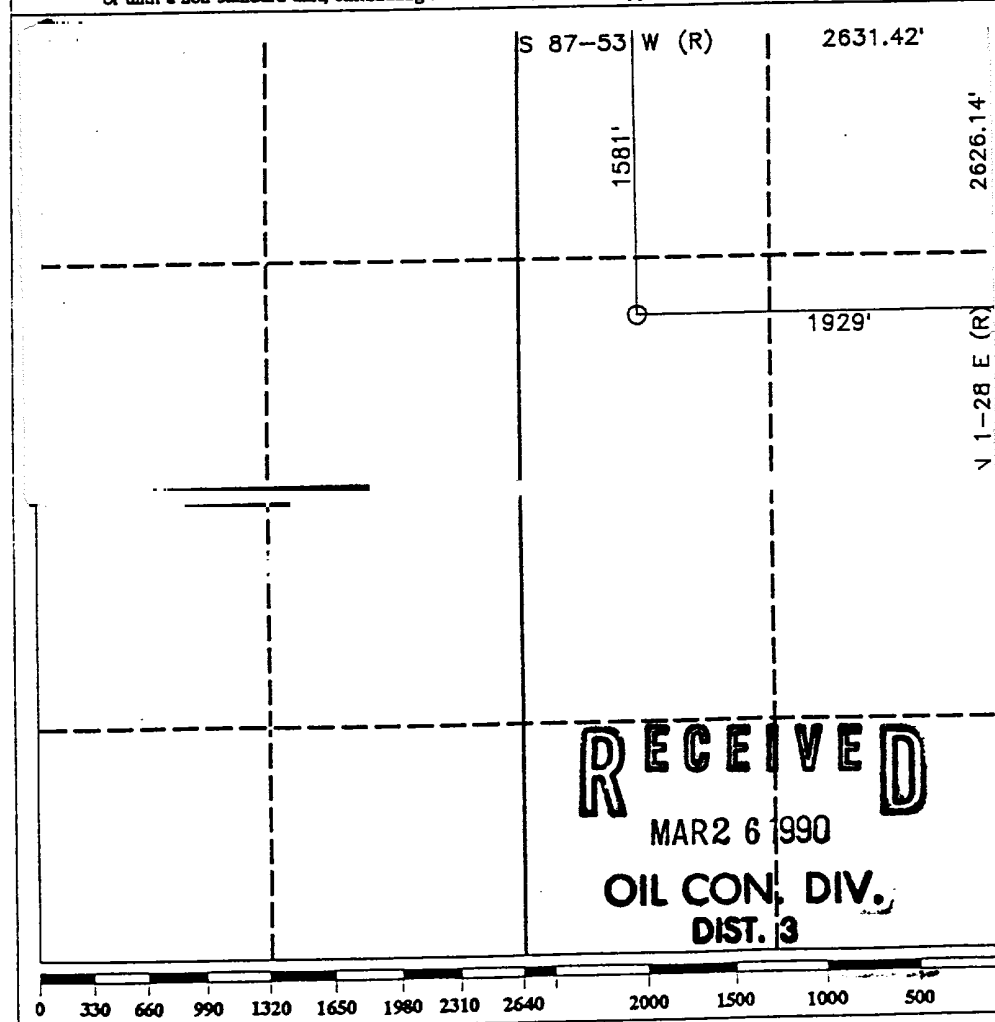

RECEIVED
MAR 26 1990
OIL CON. DIV.
DIST. 3

OPERATOR CERTIFICATION

I hereby certify that the information contained herein is true and complete to the best of my knowledge and belief.

Signature
Chris Russell
Printed Name
Chris Russell
Position
Agent
Company
Union Oil Co. of Cal.
Date
3/5/90

SURVEYOR CERTIFICATION

I hereby certify that the well location shown on this plat was plotted from field notes or actual surveys made by me or under my supervision, and that the same is true and correct to the best of my knowledge and belief.

Date Surveyed
10-10-89
Signature & Seal of Professional Surveyor
R. Howard Daggett
Certificate No. **9679**
Registered Professional Land Surveyor

UNITED STATES
GOVERNMENT
OFFICE OF THE ATTORNEY GENERAL
WASHINGTON, D.C.

This is a detailed topographic map of a region in Kincon Unit. The map features a prominent river flowing from the upper left towards the lower right. A major road, indicated by a thick black line, runs parallel to the river. Another road, marked with a dashed line, is labeled 'SANCTUARY'. A third road, also dashed, is labeled 'Dodge Canyon'. The map includes numerous contour lines and numerical labels, such as 197, 193, 170, 131, 101, 92, 89, 86, 83, 80, 77, 74, 71, 68, 65, 62, 59, 56, 53, 50, 47, 44, 41, 38, 35, 32, 29, 26, 23, 20, 17, 14, 11, 8, 5, 2, and 1. A grid system is overlaid on the map, with letters A through J and numbers 1 through 10. The map is oriented with North at the top.

F

30-039-24663

03-26-90

F. loc. 1581/N; 1929/E Elev. 6480 GL Spd. Cu. ft. TD Cu. ft. PB
 Casing S. @ W' Sx. Int. @ W Sx. Pr. @ W Sx. T. @ T Gas
 Csg. Perf. Prod. Stim. Grav. 1st Del. Gas 1st Del. Oil

BO/D			Hrs.		SICP		PSI After		Days GOR		Grav.		1st Del.		Oil		\$							
MCF/D After			I.P.																					
TOPS			NITD		X		Well Log		TEST DATA		Schd.		PC		Q		PW		PD		D		Ref.No.	
Ojo Alamo			C-103				Plat		X		✓													
Kirtland			C-104				Electric Log																	
Fruitland							C-122																	
Pictured Cliffs			Ditr				Dfo																	
Chacra			Dair				Dac																	
Cliff House																								
Menefee																								
Point Lookout																								
Mancos																								
Gallup																								
Greenhorn																								
Dakota																								
Entrada																								

P
o
o

BasinFrCoalCo. RA S 20 T27N R 06W U GOver. Union Oil Co. of Cal., Lee. Rincon Unit

No. 254

Rincon Unit #254

G-20-27N-06W

UNION OIL CO. OF CALIF.

APR 27 1990

CERTIFIED--RETURN RECEIPT REQUESTED
P-140-441-827

RECEIVED
APR 30 1990
OIL CON. DIV.
DIST. 3

Union Oil Company of CA
P. O. Box 2074
Farmington, NM 87499

Gentlemen:

Enclosed is your Application for Permit to Drill (APD) well No. 254 Rincon Unit, SW/4NE/4 sec. 20, T. 27 N., R. 6 W., Rio Arriba County, New Mexico, lease SF-079366. As requested by your letter dated April 18, 1990, the subject APD is rescinded and returned.

You are required to request surface rehabilitation instructions from this office if construction activities occurred on the referenced drill site. If this office does not receive comment within 30 days, we will presume that no construction occurred and proceed accordingly. Later discovery that construction activities have in fact occurred, may result in assessment of liquidated damages.

Sincerely,

Ken Townsend

FOR Ron Fellows
 Area Manager

Enclosure

cc: New Mexico Oil Conservation Division, 1000 Rio Brazos Road,
Aztec, NM 87410

Abandon Location