

RECEIVED

MAY 24 1990

UNITED STATES  
DEPARTMENT OF THE INTERIOR  
BUREAU OF LAND MANAGEMENT

30-039-24772

FARMINGTON, NEW MEXICO

OIL CON. DIV.

ADDITION FOR PERMIT TO DRILL, DEEPEN, OR PLUG BACK

1a. TYPE OF WORK DRILL	5. LEASE NUMBER SF-079366	
1b. TYPE OF WELL GAS	6. IF INDIAN, ALL. OR TRIBE NAME	
2. OPERATOR <i>23708</i> UNION OIL CO. OF CAL.	7. UNIT AGREEMENT NAME RINCON UNIT	
3. ADDRESS OF OPERATOR P O BOX 2074 FARMINGTON, NM, 87401 (505)-325-8786	8. FARM OR LEASE NAME RINCON <i>Unit 11510</i>	
4. LOCATION OF WELL  1419' FNL, 794' FEL BHL- 1419' FNL, 1528' FEL	9. WELL NO. 254 10. FIELD, POOL, OR WILDCAT BASIN FRUITLAND COAL <i>7/1629</i>	
14. DISTANCE FROM NEAREST TOWN 40 Miles SE of Bloomfield	12. COUNTY Rio Arriba	13. STATE New Mex.
15. DISTANCE FROM PROPOSED LOCATION TO NEAREST PROPERTY OR LEASE LINE 794'	16. ACRES IN LEASE 2558.72	17. ACRES ASSIGNED TO WELL <i>N/320</i>
18. DISTANCE FROM PROPOSED LOCATION TO NEAREST WELL DRILLING, COMPLETED OR APPLIED FOR ON THIS LEASE: 269'	19. PROPOSED DEPTH 3200' VD 3546' MD	20. ROTARY OR CABLE TOOLS DRILLING OPERATIONS AUTHORIZED ARE SUBJECT TO COMPLIANCE WITH ATTACHED "GENERAL REQUIREMENTS".
21. ELEVATIONS (DF, FT, GR, ETC.)  6579' GR	22. APPROX. DATE WORK WILL BEGIN Spring 1990	
23. PROPOSED CASING AND CEMENTING PROGRAM SEE ATTACHED DRILLING PLAN		
24. AUTHORIZED BY: <i>Chris Russell</i> AGENT		

This action is subject to technical and  
procedural review pursuant to 43 CFR 3165.3  
and appeal pursuant to 43 CFR 3165.4.

*4/18/90*  
DATE

PERMIT NO. \_\_\_\_\_ APPROVAL DATE \_\_\_\_\_  
APPROVED BY \_\_\_\_\_ TITLE \_\_\_\_\_ DATE \_\_\_\_\_

NOTE: THIS FORMAT IS ISSUED IN LIEU OF BLM FORM 3160-5

APPROVED  
AS AMENDED

MAY 11 1990

AREA MANAGER

DD # 34 (H) IR-8768

NMOCD



State of New Mexico  
Energy, Minerals and Natural Resources Department

Form C-102  
Revised 1-1-89

OIL CONSERVATION DIVISION  
P.O. Box 2088  
Santa Fe, New Mexico 87504-2088

4 copies  
3 copies

Box 1980, Hobbs, NM 88240

Drawer DD, Artesia, NM 88210

Box 1980, Hobbs, NM 88240

WELL LOCATION AND ACREAGE DEDICATION PLAT  
All Distances must be from the outer boundaries of the section

Operator <b>UNION OIL CO. OF CALIFORNIA</b>		Lease <b>RINCON UNIT</b>		Well No. <b>254</b>
Section <b>20</b>	Township <b>T.27 N.</b>	Range <b>R.6 W.</b>	County <b>RIO ARriba COUNTY</b>	
Actual Footage Location of Well: <b>1419</b> feet from the <b>NORTH</b> line and <b>794</b> feet from the <b>EAST</b> line				
Ground level Elev. <b>6579</b>	Producing Formation <b>FRUITLAND COAL</b>		Pool <b>BASIN FRUITLAND COAL</b>	Dedicated Acreage: <b>320</b> Acres

- Outline the acreage dedicated to the subject well by colored pencil or hatchure marks on the plat below.
- If more than one lease is dedicated to the well, outline each and identify the ownership thereof (both as to working interest and royalty).
- If more than one lease of different ownership is dedicated to the well, have the interest of all owners been consolidated by communitization, unitization, force-pooling, etc.?  
☐ Yes ☐ No If answer is "yes" type of consolidation \_\_\_\_\_  
If answer is "no" list the owners and tract descriptions which have actually been consolidated. (Use reverse side of this form if necessary).  
No allowable will be assigned to the well until all interests have been consolidated (by communitization, unitization, forced-pooling, or otherwise) or until a non-standard unit, eliminating such interest, has been approved by the Division.

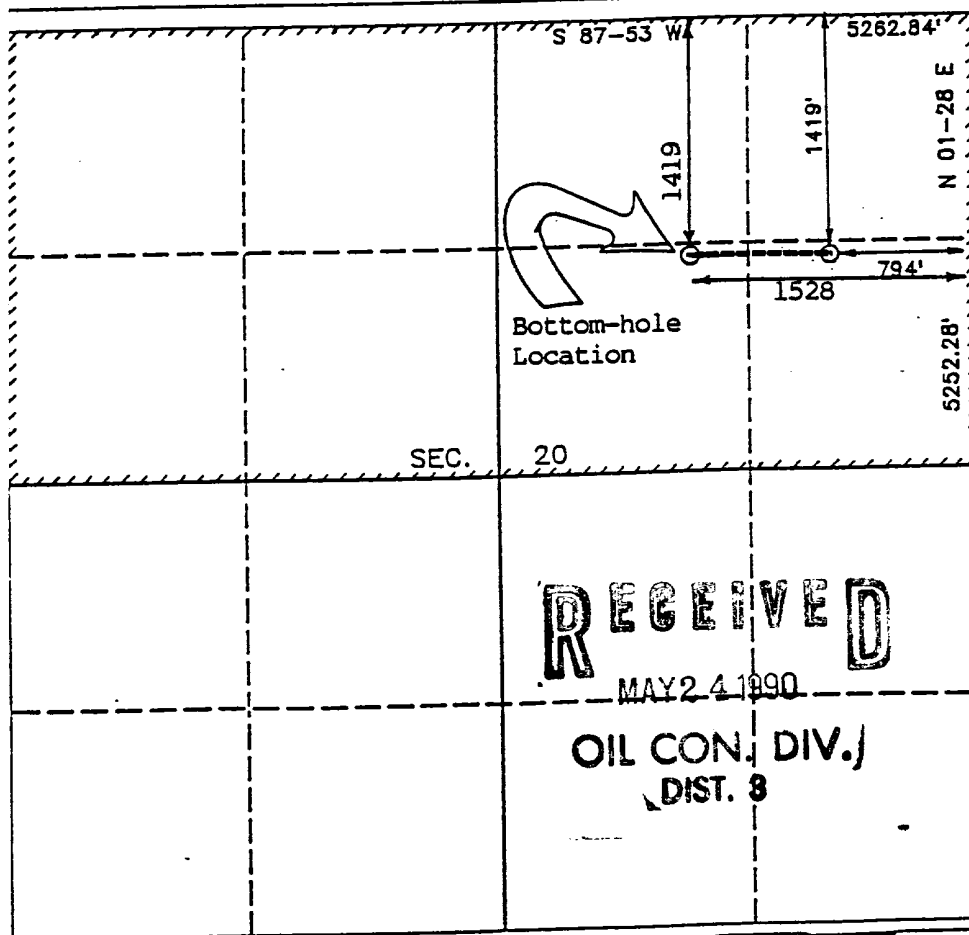

OPERATOR CERTIFICATION

I hereby certify that the information contained herein is true and complete to the best of my knowledge and belief.

Signature  
*William Hering*  
Printed Name  
**William Hering**  
Position  
**District Petroleum Eng.**  
Company  
**Union Oil Co. of Calif.**  
Date  
**April 9, 1990**

SURVEYOR CERTIFICATION

I hereby certify that the well location shown on this plat was plotted from field notes of actual surveys made by me or under my supervision, and that the same is true and correct to the best of my knowledge and belief.

Date Surveyed  
**APRIL 9 1990**  
Signature & Seal of the Professional Surveyor  
**R. EDWARD DAGGETT**  
Certificate No.  
**9679**  
Registered Professional Land Surveyor

0 330 660 990 1320 1650 1980 2310 2640 2000 1500 1000 500 0

**UNOCAL**

**RINCON UNIT WELL NO. 254**  
**SECTION VIEW OF 60 DEGREE WELLBORE**

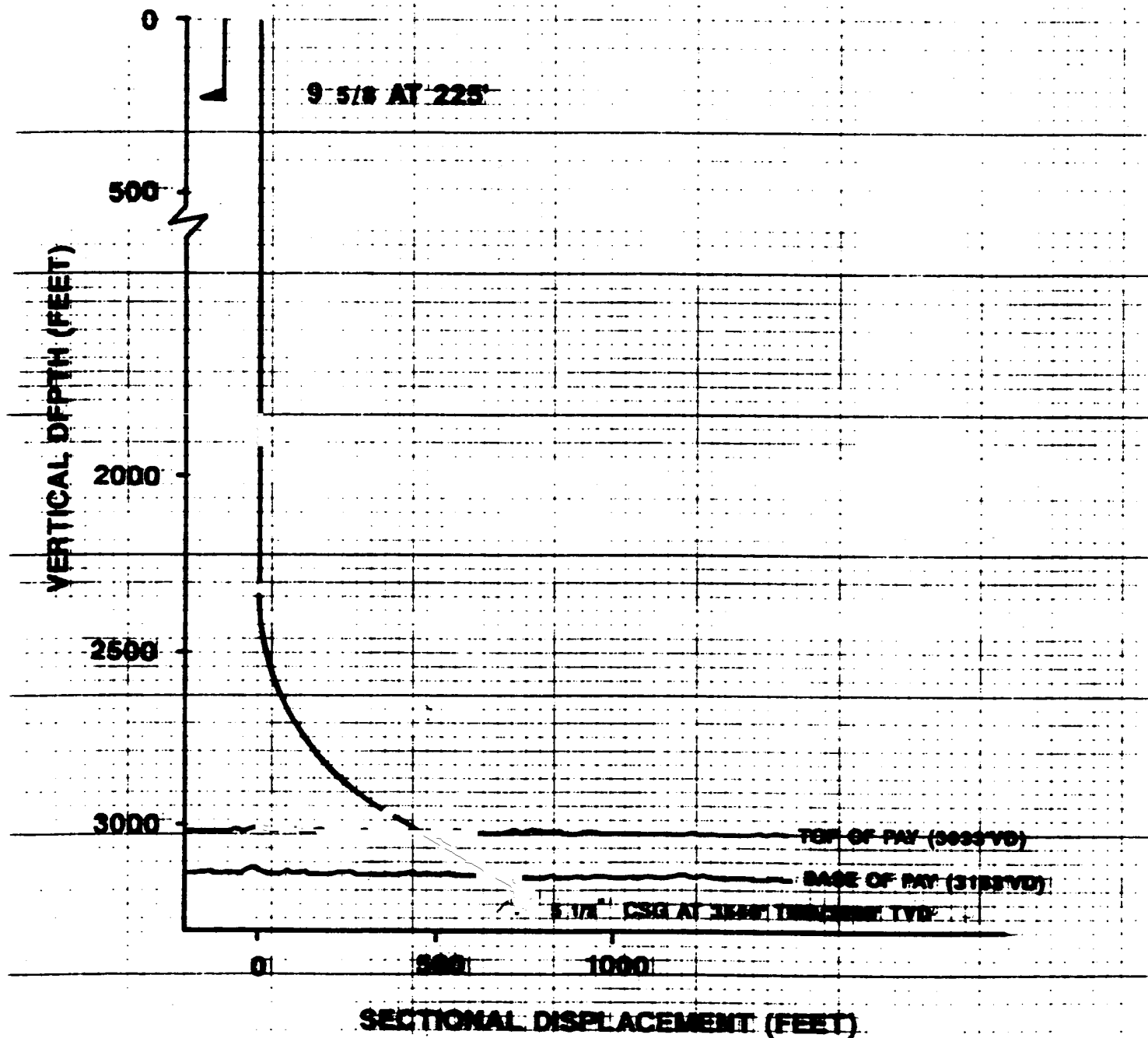

## 8 POINT DRILLING PLAN

### 1. ESTIMATED FORMATION TOPS

<u>FORMATION NAME</u>	<u>VERT. DEPTH</u>	<u>MEAS. DEPTH</u>	<u>ANGLE</u>
Ojo Alamo	2074'	2074'	0.0
Kirtland Shale	2379'	2379.3'	8.0
Fruitland	2814'	2855'	40.0
Pictured Cliffs	3153'	3212'	60.0
Total Depth	3200'	3546'	60.0

NOTE: Wellbore will be directionally drilled, kick-off-point will be at 2362', angle will be built at a rate of 8.0 deg./100' to a maximum angle of 60 degrees directed due west of surface location (see attached section view)

### 2. OIL, GAS, WATER, OR OTHER MINERAL BEARING ZONES

<u>EXPECTED GAS ZONES</u>	<u>VERT. DEPTH FROM GL</u>
Fruitland coal	2814'-3153'
Pictured Cliffs	3153'-TD
<u>EXPECTED WATER ZONES</u>	<u>VERT. DEPTH FROM GL</u>
Ojo Alamo	2074'

Possible water zones will be protected by 9-5/8" surface casing and/or 5-1/2" production strings, both of which will be cemented to surface.

### 3. PRESSURE CONTROL BOP'S AND RELATED EQUIPMENT

Casing Head: 9-5/8" X 11" - 2000 psi W.P.

BOP Stack and Related Equipment:(See attachment #1)

One double-gate BOP with 5-1/2" pipe and blind rams.

One choke manifold with adjustable and positive chokes.

The BOP and choke manifold will be rated at 2000 psi,

Testing Procedure:

The BOP and related equipment will be tested to 2000 psi in accordance with the provisions of Onshore Oil and Gas Order No. 2.

BOP's will be operationally tested daily, and each test will be logged in the IADC Daily Drilling Report.

Blooie line:

The blooie line and related equipment will meet all requirements of Onshore Oil and Gas Order No. 2.

4. CASING AND CEMENTING PROGRAM

<u>SURFACE CASING</u>						
<u>AGE</u>	<u>Depth</u>	<u>Hole Size</u>	<u>Size</u>	<u>Weight</u>	<u>Grade</u>	<u>Thread</u>
New	0-225'	12-1/4"	9-5/8"	36.0#	K-55	ST&C

<u>INTERMEDIATE CASING</u>						
<u>Age</u>	<u>Depth</u>	<u>Hole Size</u>	<u>Size</u>	<u>Weight</u>	<u>Grade</u>	<u>Thread</u>
New	0-TD	7-7/8"	5-1/2"	15.5#	K-55	ST&C

MINIMUM SAFETY FACTORS

Collapse: 1.0  
Tension: 1.8  
Burst: 1.0

Cementing Program:

1. The 9-5/8" surface casing will be cemented to the surface with 175 sacks of class "B" cement with 2% CaCl<sub>2</sub> and 1/4# per sack flocele.
2. The 5-1/2" production casing will be cemented in 2 stages with the DV tool set at 2900'. 1st stage will be cemented with 85 sacks class "H" cement with .95% Flo-Lock-1, 18% Thrifty Lite, 3% KCL, 3# Hi-seal.  
2nd stage will be cemented with 325 sacks pacesetter lite with 6% gel, 1/3# cello-seal. .8% CF-1, 3# Hi-seal followed with 50 sacks class "C" cement. Actual cement volumes will be calculated from open hole logs and will be designed to circulate to surface.

