

UNITED STATES  
DEPARTMENT OF THE INTERIOR  
BUREAU OF LAND MANAGEMENT

RECEIVED  
BLM

30-039-25159 22 FEB -1 AM 10:40  
APPLICATION FOR PERMIT TO DRILL, DEEPEN, OR PLUG BACK

1a. TYPE OF WORK  
DRILL

1b. TYPE OF WELL  
GAS

2. OPERATOR  
MERIDIAN OIL INC.  
14538

3. ADDRESS & PHONE NO. OF OPERATOR  
P O BOX 4289  
FARMINGTON, NM 87499

4. LOCATION OF WELL  
1870'FNL 1775'FEL

5. LEASE NUMBER  
SF-079365

6. IF INDIAN, ALL. OR TRIBE NAME

7. UNIT AGREEMENT NAME  
SAN JUAN 28-6 UNIT

8. FARM OR LEASE NAME  
SAN JUAN 28-6 UNIT 7462

9. WELL NO.  
428

10. FIELD, POOL, OR WILDCAT  
BASIN 71629 FRUITLAND COAL

11. SEC. T. R. M OR BLK.  
G SEC. 14 T27N R06W NMPM

12. COUNTY  
RIO ARRIBA

13. STATE  
NM

14. DISTANCE IN MILES FROM NEAREST TOWN  
10 MILES SO GOVERNADOR

15. DISTANCE FROM  
PROPOSED LOCATION 1775'  
TO NEAREST PROPERTY  
OR LEASE LINE.

16. ACRES IN LEASE  
320.00

17. ACRES ASSIGNED TO WELL

18. DISTANCE FROM  
PROPOSED LOCATION  
TO NEAREST WELL DR. 300'  
COMPL., OR APPLIED  
FOR ON THIS LEASE.

19. PROPOSED DEPTH  
3287'

20. ROTARY OR CABLE TOOLS  
ROTARY

21. ELEVATIONS (DF, FT, GR, ETC.)  
6491'GL

22. APPROX. DATE WORK WILL START

23. PROPOSED CASING AND CEMENTING PROGRAM

\*SEE OPERATIONS PLAN

24. AUTHORIZED BY:

REG. DRILLING ENGR.

RECEIVED

FEB 18 1992

OIL CON. DIV. 1

1/30/92 DIST. 3  
DATE

PERMIT NO. \_\_\_\_\_ APPROVAL DATE \_\_\_\_\_ APPROVED  
AS AMENDED

APPROVED BY \_\_\_\_\_ TITLE \_\_\_\_\_ DATE \_\_\_\_\_

NOTE: THIS FORMAT IS ISSUED IN LIEU OF US BLM FORM 3160-3.

ARCH REPORT SUBMITTED 11/04/91

NMOCD

Submit to Appropriate  
District Office  
State Lease - 4 copies  
Fee Lease - 3 copies

State of New Mexico  
Energy, Minerals and Natural Resources Department

Form C-102  
Revised 1-1-89

OIL CONSERVATION DIVISION

P.O. Box 2088  
Santa Fe, New Mexico 87504-2088

RECEIVED  
BLM

92 FEB -4 AM 10:40

DISTRICT I

P.O. Box 1980, Hobbs, NM 88240

DISTRICT II

P.O. Drawer DD, Artesia, NM 88210

DISTRICT III

1000 Rio Brazos Rd., Aztec, NM 87410

WELL LOCATION AND ACREAGE DEDICATION PLAT

All Distances must be from the outer boundaries of the section

Operator Meridian Oil Inc.		Lease San Juan 28-6 Unit		Well No. 428	
Unit Letter G	Section 14	Township 27 North	Range 6 West	County NM PM Rio Arriba	
Actual Footage Location of Well: 1870 feet from the North line and 1775 feet from the East line					
Ground level Elev. 6491'	Producing Formation Fruitland Coal		Pool Basin	Dedicated Acreage: 320 Acres	

- Outline the acreage dedicated to the subject well by colored pencil or hectare marks on the plat below.
- If more than one lease is dedicated to the well, outline each and identify the ownership thereof (both as to working interest and royalty).
- If more than one lease of different ownership is dedicated to the well, have the interest of all owners been consolidated by communitization, unitization, force-pooling, etc.?  
☒ Yes ☐ No If answer is "yes" type of consolidation unitization  
If answer is "no" list the owners and tract descriptions which have actually been consolidated. (Use reverse side of this form if necessary.)  
No allowable will be assigned to the well until all interests have been consolidated (by communitization, unitization, forced-pooling, or otherwise) or until a non-standard unit, eliminating such interest, has been approved by the Division.

OPERATOR CERTIFICATION

I hereby certify that the information contained herein is true and complete to the best of my knowledge and belief.

*Peggy Bradfield*  
Signature

Peggy Bradfield

Printed Name

Regulatory Affairs

Position

Meridian Oil Inc.

Company

Date

SURVEYOR CERTIFICATION

I hereby certify that the well location shown on this plat was plotted from field notes of actual surveys made by me or under my supervision, and that the same is true and correct to the best of my knowledge and belief.

Date Sur

10-17-91

Signature

Professional Seal

8857

Certificate No.

6857

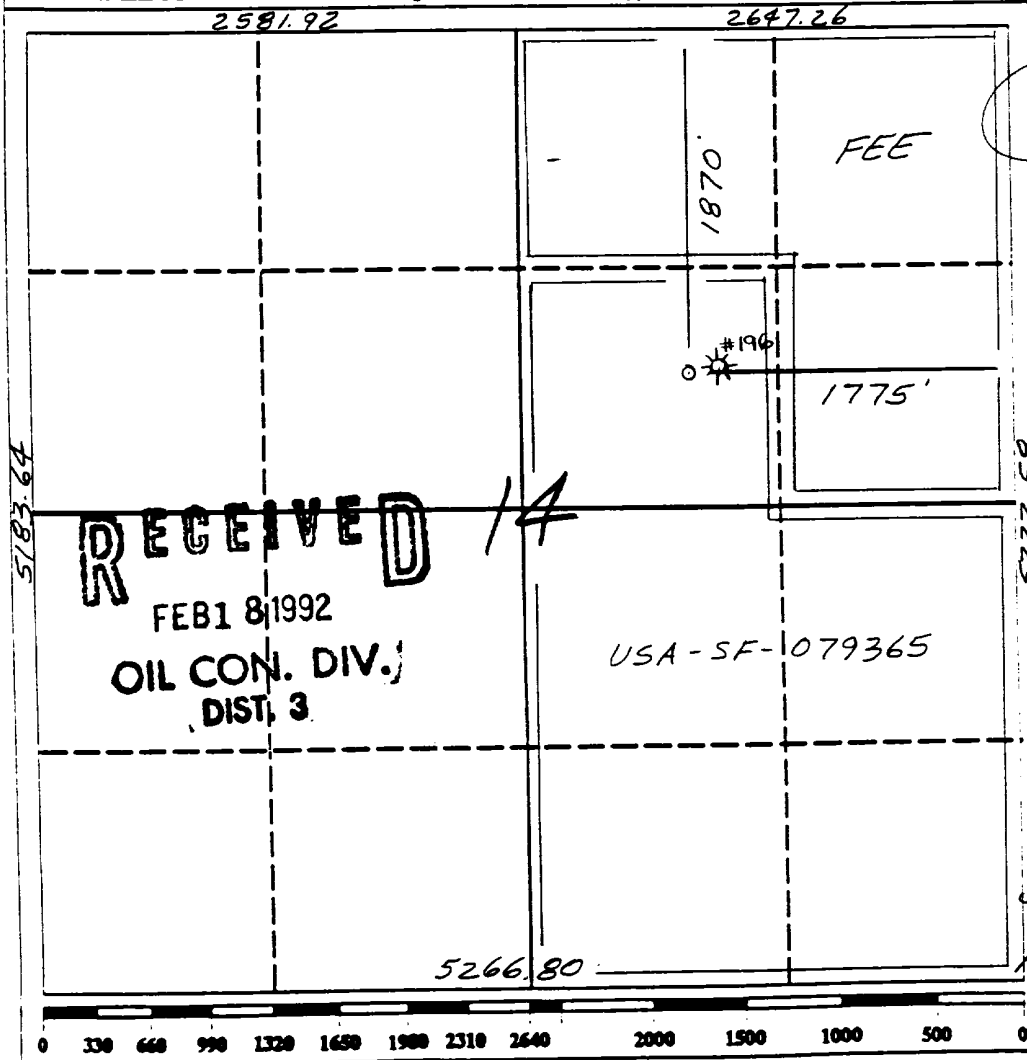

**Well Name:** San Juan 28-6 Unit No. 428  
**Section 14, T-27-N, R-6-W**  
**Basin-Fruitland Coal**

**1870' FNL - 1775' FEL**  
**Rio Arriba New Mexico**  
**Elevation 6491'**

**Formation Tops:** Surface- San Jose

Ojo Alamo- 2617  
 Kirtland- 2697  
 Fruitland- 3035  
 Fruitland Coal Top- 3110  
 Fruitland Coal Base- 3241  
 Pictured Cliffs- 3243

**Total Depth- 3287**

**Logging Program:** Mud logs from 3035 to total depth.

<b>Mud Program:</b>	<b>Interval</b>	<b>Type</b>	<b>Weight</b>	<b>Visc.</b>	<b>Fl. Loss</b>
	0 - 200	Spud	8.4 - 8.9	40-50	no control
	200 - 3287	Non-dispersed	8.4 - 9.5	30-60	no control

<b>Casing Program:</b>	<b>Hole Size</b>	<b>Depth Interval</b>	<b>Csg. Size</b>	<b>Weight</b>	<b>Grade</b>
	12 1/4"	0 - 200	8 5/8"	24.0#	K-40
	7 7/8"	0 - 3287	4 1/2"	10.5#	K-55

<b>Tubing Program:</b>	<b>Depth Interval</b>	<b>Csg. Size</b>	<b>Weight</b>	<b>Grade</b>
	0 - 3287	2 3/8"	4.7#	J-55

**Float Equipment:** 8 5/8" surface casing - saw tooth guide shoe. Centralizers will be run in accordance with Onshore Order #2.

4 1/2" production casing - float shoe on bottom. Three centralizers run every other joint above shoe. Two turbolizing type centralizers - one below and one into the base of the Ojo Alamo @ 2617'. Standard centralizers thereafter every fourth joint up to the base of the surface pipe.

**Wellhead Equipment:** 8 5/8" x 4 1/2" x 2 3/8" x 11" 3000 psi xmas tree assembly.

**Cementing:**

8 5/8" surface casing - cement with 211 sacks of class "B" cement with 1/4# flocele/sack and 3% calcium chloride (250 cu ft. of slurry, 200% excess to circulate to surface). WOC 12 hours. Test casing to 600 psi for 30 minutes.

4 1/2" production casing - lead with 780 sacks of 65/35 class "B" poz with 6% gel, 2% calcium chloride and 1/2 cu.ft. Perlite/sack (10.3 gallons of water/sack) tail with 100 sacks of class "B" with 2% calcium chloride. 1500 cu.ft. of slurry, 100% excess to circulate to surface. If hole conditions permit, a 600 ft. spacer will be run ahead of the cement slurry to avoid mud contamination of the cement. WOC 12 hours. If cement does not circulate to surface, a temperature log will be run after 8 hours to determine TOC.