

UNITED STATES
DEPARTMENT OF THE INTERIOR
BUREAU OF LAND MANAGEMENT

Form approved.
Budget Bureau No.1004-0136
Expires: December 31, 1991

APPLICATION FOR PERMIT TO DRILL OR DEEPEN

1a. TYPE OF WORK
DRILL ☒ **DEEPEN** ☐

b. TYPE OF WELL
OIL WELL ☐ GAS WELL ☒ OTHER ☐ SINGLE ZONE ☐ MULTIPLE ZONE ☒

2. NAME OF OPERATOR
Amoco Production Company
Attention: Julie L. Acevedo

3. ADDRESS AND TELEPHONE NO.
P.O. Box 800, Denver, Colorado 80201

4. LOCATION OF WELL (Report location clearly and in accordance with any State requirements.)
At surface 1080FNL 810FWL
At proposed prod. zone

14. DISTANCE IN MILES AND DIRECTION FROM NEAREST TOWN OR POST OFFICE*
41 miles from Aztec, N.M.

15. DISTANCE FROM PROPOSED LOCATION TO NEAREST PROPERTY OR LEASE LINE, FT.
(Also to nearest drlg. unit line, if any)

16. NO. OF ACRES IN LEASE
1689.94

17. NO. OF ACRES ASSIGNED TO THIS WELL
W/2 320 319.99

18. DISTANCE FROM PROPOSED LOCATION TO NEAREST WELL, DRILLING, COMPLETED, OR APPLIED FOR, ON THIS LEASE, FT.

19. PROPOSED DEPTH
7985'

20. ROTARY OR CABLE TOOLS
Rotary

21. ELEVATIONS (Show whether DF, RT, GR., etc.)
6799'GR This action is subject to technical and procedural review pursuant to 43 CFR 3165.4 and appeal pursuant to 43 CFR 3165.4

22. APPROX. DATE WORK WILL START*
10-01-93

23. PROPOSED DRILLING AND CEMENTING PROGRAM

SIZE OF HOLE	GRADE, SIZE OF CASING	WEIGHT PER FOOT	SETTING DEPTH	QUANTITY OF CEMENT
17 1/2"	13 3/8" J-55	61#	400'	625cf Cl B W/2% CaCl2 (Cement to surface)
12 1/4"	9 5/8" J-55	36#	3738'	2575cf Cl B (Cement to surface)
8 3/4"	7" J-55	23#	7550'	991cf Cl B 50/50poz(Cement to surface)

24. DRILLING OPERATIONS AUTHORIZED ARE SUBJECT TO COMPLIANCE WITH ATTACHED GENERAL REQUIREMENTS.

Notice of Staking was submitted on 8/11/93

Lease Description:

T27N-R7W
Sec. 3: Lots 1,2,3,4,S/2N/2 (N/2)
Sec. 5: Lots 1,2,S/2NE/4 (NE/4)
T28N-R7W:
Sec. 27: SE/4,E/2NE/4
Sec. 34: Lots 3,4,N/2SW/4,NW/4 (W/2)
Sec. 35: Lots 1,2,3,4, N/2S/2, N/2(ALL)

CONFIDENTIAL
RECEIVED
JAN 25 1994
OIL CON. DIV.
DIST 3

IN ABOVE SPACE DESCRIBE PROPOSED PROGRAM: If proposal is to deepen, give data on present productive zone and proposed new productive zone. If proposal is to drill or deepen directionally, give pertinent data on subsurface locations and measured and true vertical depths. Give blowout preventer program, if any.

24. SIGNED Julie L. Acevedo TITLE Sr. Staff Assistant DATE 09-13-1993
(This space for Federal or State office use)

PERMIT NO. _____ APPROVAL DATE _____
Application approval does not warrant or certify that the applicant holds legal or equitable title to those rights in the subject lease which would entitle the applicant to a leasehold interest.
CONDITIONS OF APPROVAL, IF ANY:

APPROVED BY OK TITLE NMOCD DATE JAN 20 1994
DISTRICT MANAGER

*See Instructions On Reverse Side
Title 18 U.S.C. Sect on 1001, makes it a crime for any person knowingly and willfully to make to any department or agency of the United States any false, fictitious or fraudulent statements or representations as to any matter within its jurisdiction.

Submit to Appropriate
District Office
State Lease - 4 copies
Fee Lease - 3 copies

State of New Mexico
Energy, Minerals and Natural Resources Department

Form C-102
Revised 1-1-89

OIL CONSERVATION DIVISION

P.O. Box 2088
Santa Fe, New Mexico 87504-2088

DISTRICT I
P.O. Box 1980, Hobbs, NM 88240

DISTRICT II
P.O. Drawer DD, Artesia, NM 88210

DISTRICT III
1000 Rio Brazos Rd., Aztec, NM 87410

WELL LOCATION AND ACREAGE DEDICATION PLAT

All Distances must be from the outer boundaries of the section

Operator AMOCO PRODUCTION COMPANY			Lease San Juan 28-7 Unit		Well No. 181M
Unit Letter D	Section 3	Township 27 NORTH	Range 7 WEST	County NMPM RIO ARRIBA	
Actual Footage Location of Well: 1080 feet from the NORTH line and 810 feet from the WEST line					
Ground level Elev. 6799	Producing Formation Blanco Mesaverde		Pool Blanco Mesaverde		Dedicated Acreage: 320 319.92 Acres W/2

- Outline the acreage dedicated to the subject well by colored pencil or hatchure marks on the plat below.
- If more than one lease is dedicated to the well, outline each and identify the ownership thereof (both as to working interest and royalty).
- If more than one lease of different ownership is dedicated to the well, have the interest of all owners been consolidated by communitization, unitization, force-pooling, etc.?
☒ Yes ☐ No If answer is "yes" type of consolidation unit
If answer is "no" list the owners and tract descriptions which have actually been consolidated. (Use reverse side of this form if necessary.)
No allowable will be assigned to the well until all interests have been consolidated (by communitization, unitization, forced-pooling, or otherwise) or until a non-standard unit, eliminating such interest, has been approved by the Division.

OPERATOR CERTIFICATION

I hereby certify that the information contained herein is true and complete to the best of my knowledge and belief.

Signature Kelly Stearns
Printed Name **Kelly Stearns**
Position **Business Analyst**
Company **Amoco Production Company**
Date **8-11-93**

SURVEYOR CERTIFICATION

I hereby certify that the well location shown on this plat was plotted from field notes of actual surveys made by me or under my supervision, and that the same is true and correct to the best of my knowledge and belief.

Date Surveyed
August 4, 1993

Signature & Seal of
Professional Surveyor

GARY D. VANN
NEW MEXICO
REGISTERED PROFESSIONAL LAND SURVEYOR
7016
Gary Vann
7016

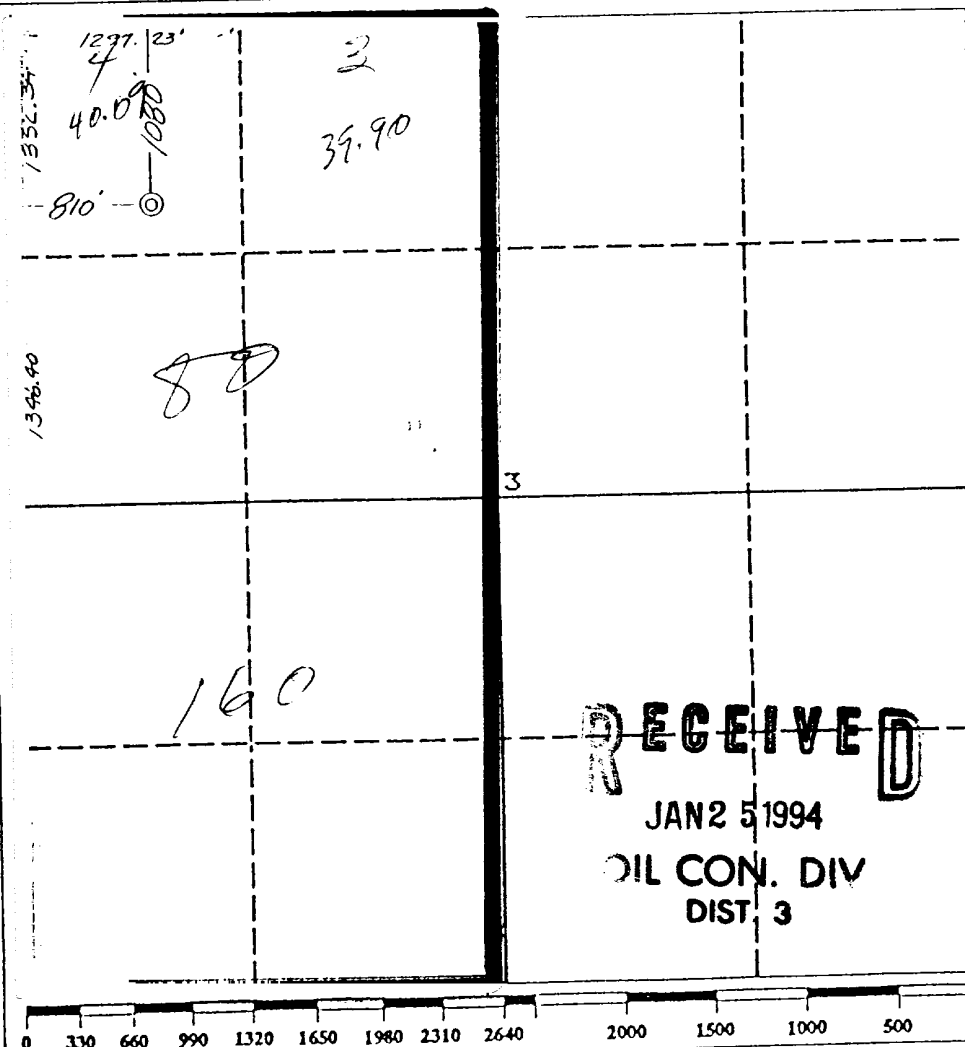

Submit to Appropriate
District Office
State Lease - 4 copies
Fee Lease - 3 copies

State of New Mexico
Energy, Minerals and Natural Resources Department

Form C-102
Revised 1-1-89

OIL CONSERVATION DIVISION

P.O. Box 2088
Santa Fe, New Mexico 87504-2088

RECEIVED

DISTRICT I
P.O. Box 1980, Hobbs, NM 88240

DISTRICT II
P.O. Drawer DD, Artesia, NM 88210

DISTRICT III
1000 Rio Brazos Rd., A. Sec, NM 87410

WELL LOCATION AND ACREAGE DEDICATION PLAT

All Distances must be from the outer boundaries of the section

BUREAU OF LAND MANAGEMENT
FARMINGTON RESOURCE AREA

SEP 1993

Operator AMOCO PRODUCTION COMPANY			Lease San Juan 28-7 Unit		Well No. 181M
Unit Letter D	Section 3	Township 27 NORTH	Range 7 WEST	County RIO ARRIBA	
Actual Footage Location of Well: 1080 feet from the NORTH line and 810 feet from the WEST line					
Ground level Elev. 6799	Producing Formation Basin Dakota		Pool Basin Dakota		Dedicated Acreage: 320 319.99 Acres W/2

- Outline the acreage dedicated to the subject well by colored pencil or hatchure marks on the plat below.
- If more than one lease is dedicated to the well, outline each and identify the ownership thereof (both as to working interest and royalty).
- If more than one lease of different ownership is dedicated to the well, have the interest of all owners been consolidated by communitization, unitization, force-pooling, etc.?
☒ Yes ☐ No If answer is "yes" type of consolidation unit
If answer is "no" list the owners and tract descriptions which have actually been consolidated. (Use reverse side of this form if necessary.)
No allowable will be assigned to the well until all interests have been consolidated (by communitization, unitization, forced-pooling, or otherwise) or until a non-standard unit, eliminating such interest, has been approved by the Division.

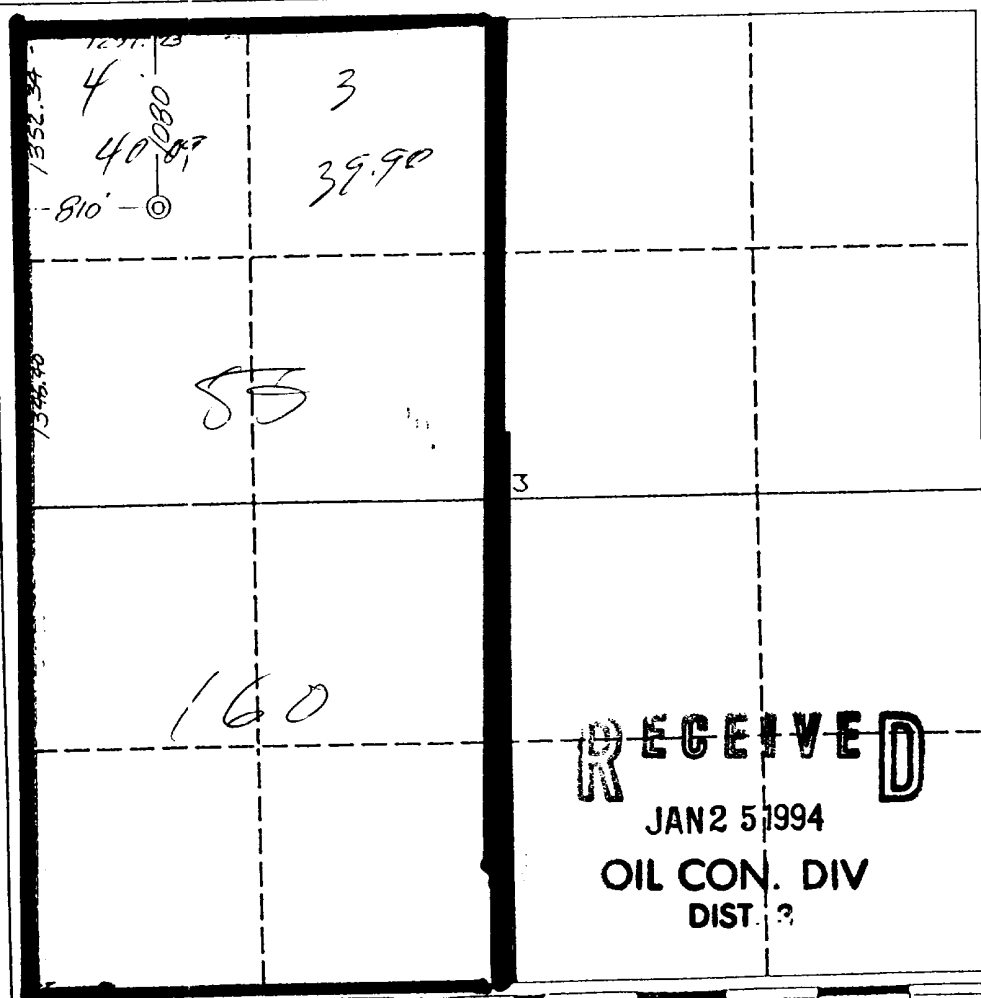

OPERATOR CERTIFICATION

I hereby certify that the information contained herein is true and complete to the best of my knowledge and belief.

Signature
Kelly Stearns
Printed Name
Kelly Stearns
Position
Business Analyst
Company
Amoco Production Company
Date
8-11-93

SURVEYOR CERTIFICATION

I hereby certify that the well location shown on this plat was plotted from field notes of actual surveys made by me or under my supervision, and that the same is true and correct to the best of my knowledge and belief.

Date Surveyed
August 4, 1993

Signature & Seal of
Professional Surveyor

GARY D. VANN
NEW MEXICO
REGISTERED PROFESSIONAL LAND SURVEYOR
7016
Wann

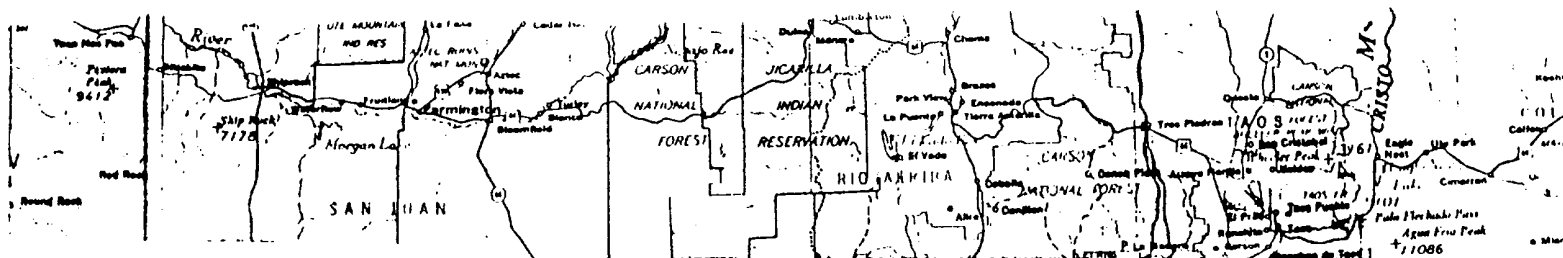

REF. # 554

1080' F/NL 810' F/WL

SEC. 3, T27N, R7W, NMPM

RAIL POINT: 193 miles from Montrose, Co.

MUD POINT: 41 miles from Aztec, N.M.

CEMENT POINT: 45 miles from Farmington, N.M.

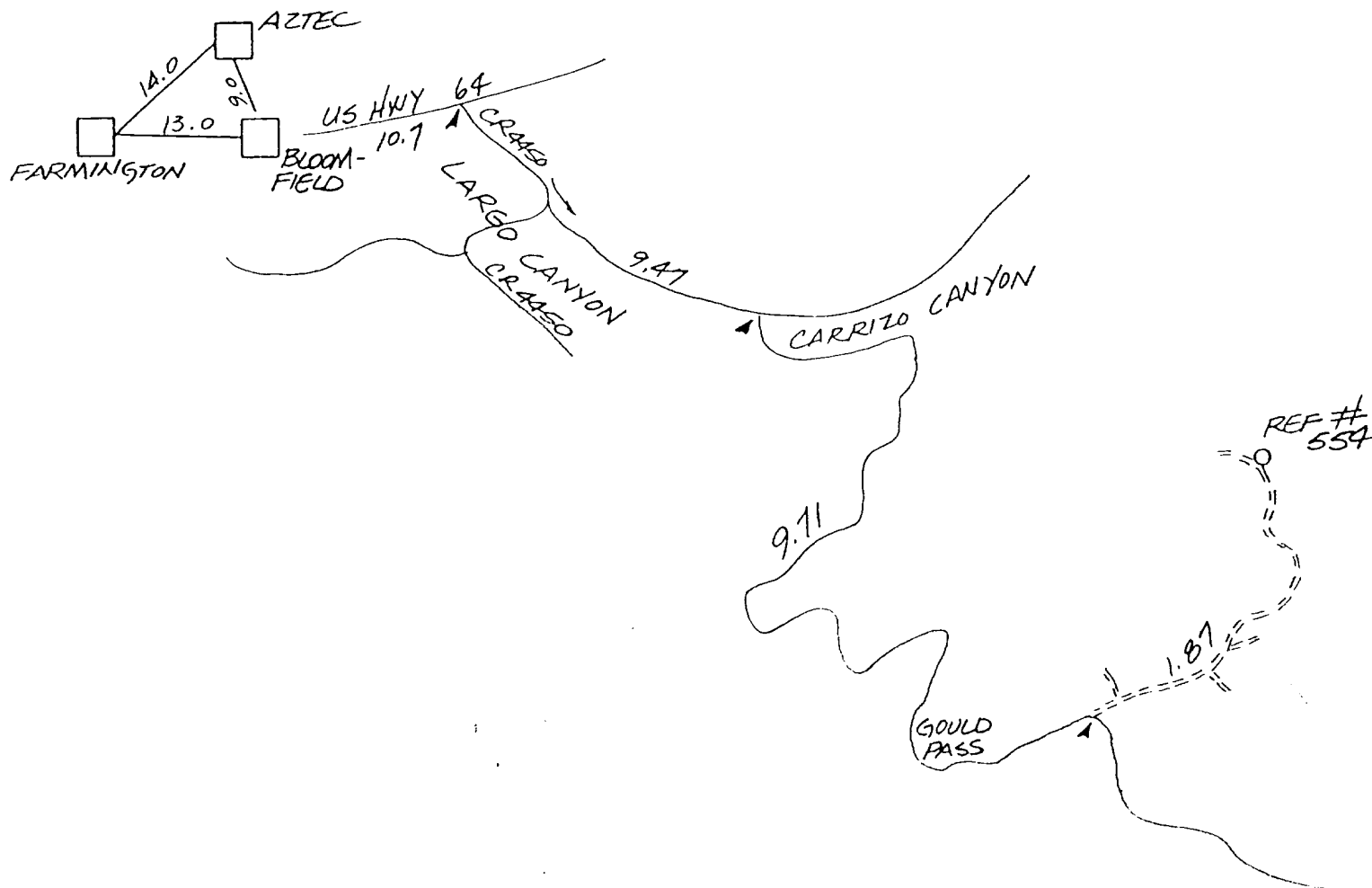

AMNEN PRODUCTION COMPANY

EXHIBIT "D"

