

UNITED STATES  
DEPARTMENT OF THE INTERIOR  
BUREAU OF LAND MANAGEMENT

SUBMIT IN TRIPLICATE\*  
(Other instructions on reverse side)

FORM APPROVED  
OMB NO. 1004-0136  
Expires: February 28, 1995

RECEIVED  
BLM

APPLICATION FOR PERMIT TO DRILL OR DEEPEN

1a. TYPE OF WORK DRILL ☒ DEEPEN ☐ 070 FARMINGTON, NM

b. TYPE OF WELL OIL WELL ☐ GAS WELL ☒ OTHER ☐ SINGLE ZONE ☐ MULTIPLE ZONE ☒

2. NAME OF OPERATOR UNION OIL COMPANY OF CALIFORNIA 23708

3. ADDRESS AND TELEPHONE NO. P. O. Box 2620, Casper, WY 82602 (307)234-1563, ext. 116

4. LOCATION OF WELL (Report location clearly and in accordance with any State requirements.)\*  
At surface 1725  
1980' FNL, 1980' FWL  
At proposed prod. zone Same

14. DISTANCE IN MILES AND DIRECTION FROM NEAREST TOWN OR POST OFFICE\*  
Approximately 25 miles SE of Blanco, New Mexico

15. DISTANCE FROM PROPOSED\* LOCATION TO NEAREST PROPERTY OR LEASE LINE, FT. (Also to nearest drlg. unit line, if any) 1980'

18. DISTANCE FROM PROPOSED LOCATION\* TO NEAREST WELL, DRILLING, COMPLETED, OR APPLIED FOR, ON THIS LEASE, FT. 1000'

21. ELEVATIONS (Show whether DF, RT, GR, etc.) 6655' GR

23. PROPOSED CASING AND CEMENTING PROGRAM

SIZE OF HOLE	GRADE, SIZE OF CASING	WEIGHT PER FOOT	SETTING DEPTH
12 1/4"	8 5/8" -K-55	24#	350'
7 7/8"	5 1/2" -K-55	17# & 15.5#	± 7780'

PROPOSED DRILLING PROGRAM

Drill 12 1/4" hole to 350' w/ spud mud. Run and cmt to surface 8 5/8" csg. Nipple up and test BOPE. Drill 7 7/8" hole to ± 7780' -TD w/ fresh water/gel mud system. Log and if productive, run and cement 5 1/2" csg in 2 stages w/"DV" tool @ ± 5000'. Selectively perforate the Dakota and Mesa Verde formations. Fracture stimulate both zones separately as required. Test and complete w/packer and 2 3/8" tbg.

NOTE: Bond coverage pursuant to 43 CFR 3104 for lease activities is being provided by Union Oil Company of California (BLM Bond # CA0048).

RECEIVED  
AUG - 1 1994

IN ABOVE SPACE DESCRIBE PROPOSED PROGRAM: If proposal is to deepen, give data on present productive zone and proposed new productive zone. If proposal is to drill or deepen directionally, give pertinent data on subsurface locations and measured and true vertical depths. Give blowout prevention program, if any.

24. SIGNED Jim Benson TITLE Drilling Superintendent DATE 1/12/94

(This space for Federal or State office use)

PERMIT NO. \_\_\_\_\_ APPROVAL DATE \_\_\_\_\_  
Application approval does not warrant or certify that the applicant holds legal or equitable title to those rights in the subject lease which would entitle the applicant to conduct operations thereon.  
CONDITIONS OF APPROVAL, IF ANY:

APPROVED BY \_\_\_\_\_ TITLE \_\_\_\_\_ DATE \_\_\_\_\_  
DISTRICT MANAGER

\*See Instructions On Reverse Side

Title 18 U.S.C. Section 1001, makes it a crime for any person knowingly and willfully to make to any department or agency of the United States any false, fictitious or fraudulent statements or representations as to any matter within its jurisdiction.

5. LEASE DESIGNATION AND SERIAL NO.  
SF 079321  
6. IF INDIAN, ALLOTTEE OR TRIBE NAME  
7. UNIT AGREEMENT NAME  
RINCON  
8. FARM OR LEASE NAME, WELL NO.  
11510 RINCON 139E 158E  
9. API WELL NO.  
30-039-25453  
10. FIELD AND POOL, OR WILDCAT  
Basin Dakota/Blanco Mesa Verde  
11. SEC., T., R., M., OR BLK. AND SURVEY OR AREA  
F Sec. 25, T27N, R7W  
12. COUNTY OR PARISH  
Rio Arriba  
13. STATE  
New Mexico

16. NO. OF ACRES IN LEASE 640-656.48  
17. NO. OF ACRES ASSIGNED TO THIS WELL 328.03  
20. ROTARY OR CABLE TOOLS  
Rotary

22. APPROX. DATE WORK WILL START\* 4-15-94

DRILLING OPERATIONS ARE SUBJECT TO CENSUS WITH ATTACHED "GENERALITY OF CEMENTS"

± 250 sxs Class "B"  
2 stage w/DV tool @ ± 5000'  
1st-lead, ± 450 sxs "Lite", tail 125 sxs Class "B"  
2nd-lead, ± 750 sxs "Lite", tail 125 sxs Class "B"

APPROVED  
AS AMENDED

JUN 29 1994

District I  
P. O. Box 1980, Hobbs, NM 88241-1980  
District II  
P.O. Drawer DD, Artesia, NM 88211-0719  
District III  
1000 Rio Brazos RD., Aztec, NM 87410  
District IV  
P.O. Box 2088, Santa Fe, NM 87504-2088

State of New Mexico  
Energy, Minerals & Natural Resources Department

Form C-102  
Revised February 21, 1994

OIL CONSERVATION DIVISION  
P.O. Box 2088  
Santa Fe, NM 87504-2088

Instructions on back  
Submit to Appropriate District Office  
State Lease - 4 Copies  
Fee Lease - 3 Copies

AMENDED REPORT

WELL LOCATION AND ACREAGE DEDICATION PLAT

1 API Number <u>90-039-25453</u>	2 Pool Code 72319 / 71599	3 Pool Name Blanco Mesaverde / Basin Dakota
4 Property Code 11510	5 Property Name Rincon Unit	6 Well Number No. 138E
7 OGRID No. 023708	8 Operator Name Union Oil Company of California	9 Elevation 6666' GR

10 Surface Location

UL or lot no. F	Section 25	Township 27N	Range 7W	Lot Idn	Feet from the 1735	North/South line North	Feet from the 1725	East/West line West	County Rio Arriba
--------------------	---------------	-----------------	-------------	---------	-----------------------	---------------------------	-----------------------	------------------------	----------------------

11 Bottom Hole Location If Different From Surface

UL or lot no.	Section	Township	Range	Lot Idn	Feet from the	North/South line	Feet from the	East/West line	County
12 Dedicated Acres <u>320 328.03</u>	13 Joint or Infill Infill	14 Consolidation Code U	15 Order No.						

NO ALLOWABLE WILL BE ASSIGNED TO THIS COMPLETION UNTIL ALL INTERESTS HAVE BEEN CONSOLIDATED  
OR A NON-STANDARD UNIT HAS BEEN APPROVED BY THE DIVISION

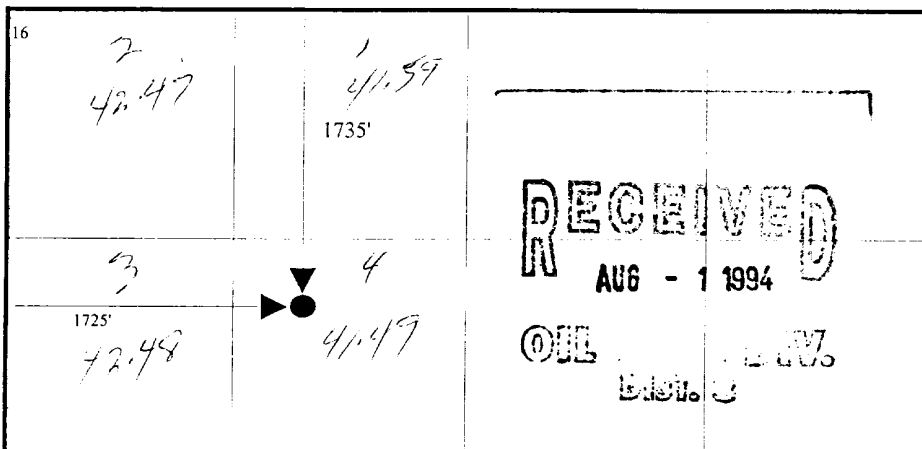
16 	17 OPERATOR CERTIFICATION I hereby certify that the information contained herein is true and complete to the best of my knowledge and belief  Signature: <u>Dana L. Delventhal</u> Printed Name: Dana L. Delventhal Title: Agent Date: 25-Jul-94
	18 SURVEYOR CERTIFICATION I hereby certify that the well location shown on this plat was plotted from field notes of actual surveys made by me or under my supervision, and that the same is true and correct to the best of my belief.  Date of Survey Signature and Seal Professional Surveyor:  Certificate Number

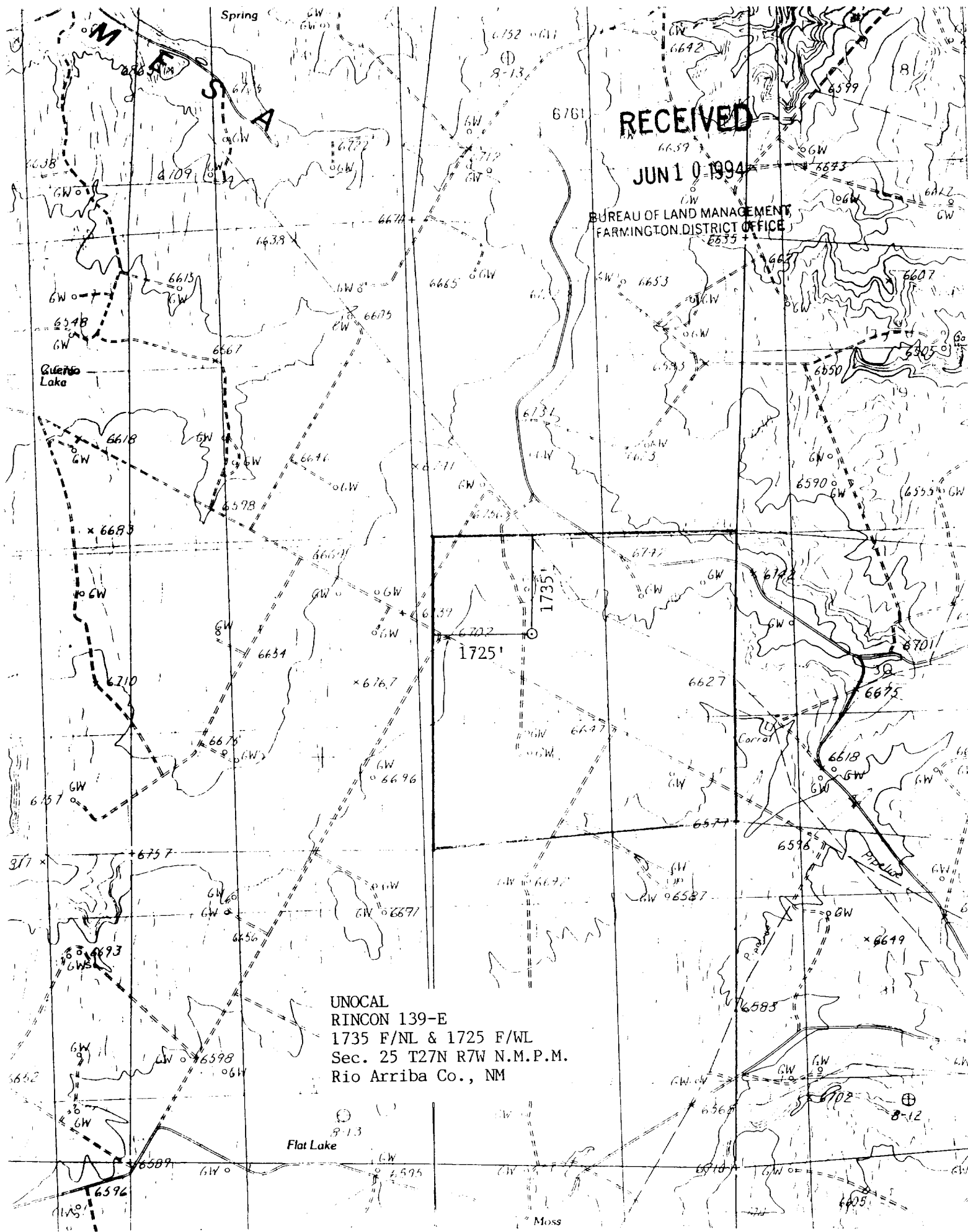

RECEIVED

JUN 10 1994

BUREAU OF LAND MANAGEMENT  
FARMINGTON DISTRICT OFFICE

UNOCAL  
RINCON 139-E  
1735 F/NL & 1725 F/WL  
Sec. 25 T27N R7W N.M.P.M.  
Rio Arriba Co., NM

Flat Lake

Moss