

UNITED STATES
DEPARTMENT OF THE INTERIOR
BUREAU OF LAND MANAGEMENT

FORM APPROVED
Budget Bureau No. 1004-0135
Expires: March 31, 1993

SUNDRY NOTICES AND REPORTS ON WELLS

Do not use this form for proposals to drill or to deepen or reentry to a different reservoir.
Use "APPLICATION FOR PERMIT—" for such proposals

SUBMIT IN TRIPLICATE

1. Type of Well

☐ Oil Well ☒ Gas Well ☐ Other

2. Name of Operator

Union Oil Company of California

3. Address and Telephone No.

913 West Broadway, Bloomfield, NM 87413

4. Location of Well (Footage, Sec., T., R., M., or Survey Description)

25-27N-07W
=====

1980'N - 1980'W

5. Lease Designation and Serial No.

SF-079321

6. If Indian, Allottee or Tribe Name

7. If Unit or CA, Agreement Designation

RINCON UNIT

8. Well Name and No.

RINCON UNIT #139E

9. API Well No.

10. Field and Pool, or Exploratory Area

DK/MV

11. County or Parish, State

RIO ARRIBA, NM

12. CHECK APPROPRIATE BOX(s) TO INDICATE NATURE OF NOTICE, REPORT, OR OTHER DATA

TYPE OF SUBMISSION

- ☒ Notice of Intent
☐ Subsequent Report
☐ Final Abandonment Notice

TYPE OF ACTION

- ☐ Abandonment
☐ Recompletion
☐ Plugging Back
☐ Casing Repair
☐ Altering Casing
☒ Other Buried Gas Pipeline
☐ Change of Plans
☐ New Construction
☐ Non-Routine Fracturing
☐ Water Shut-Off
☐ Conversion to Injection
☐ Dispose Water

(Note: Report results of multiple completion on Well Completion or Recompletion Report and Log form.)

13. Describe Proposed or Completed Operations (Clearly state all pertinent details, and give pertinent dates, including estimated date of starting any proposed work. If well is directionally drilled, give subsurface locations and measured and true vertical depths for all markers and zones pertinent to this work.)*

UNION OIL COMPANY OF CALIFORNIA PROPOSES TO LAY A BURIED NATURAL GAS PIPELINE FROM THE RINCON UNIT #139E TO THE EXISTING RINCON UNIT #16 FLOW LINE. THE LINE WILL BE BURIED A MINIMUM OF 36" BELOW THE SURFACE AND WILL BE MARKED WITH PIPELINE MARKERS.

TIE LENGTH (BLM) = 1100.00'

PIPE SPECIFICATIONS: GAS
- 4.5" STEEL
- WT = 0.156", GR=X-42
- WP = 250#
- OP = 85#
- TEST PRESSURE = 1050#
- DEPTH = 36" MIN.

WATER - NONE

ARCH REPORT #: CASA 94-45 (ORIGINAL) - See New Report for REROUTE
ARCH REPORT DATE: 06-14-94 (ORIGINAL) - New Report for REROUTE in progress

SEE ATTACHED COPIES OF SURVEY PLAT AND TOPO.

14. I hereby certify that the foregoing is true and correct

Signed

Title Production Engineer

Date

6/29/94

(This space for Federal or State office use)

Approved by

Title

Date

JUL 15 1994

Conditions of approval, if any:

DISTRICT MANAGER

Title 18 U.S.C. Section 1001, makes it a crime for any person knowingly and willfully to make to any department or agency of the United States any false, fictitious or fraudulent statements or representations as to any matter within its jurisdiction.

*See Instruction on Reverse Side

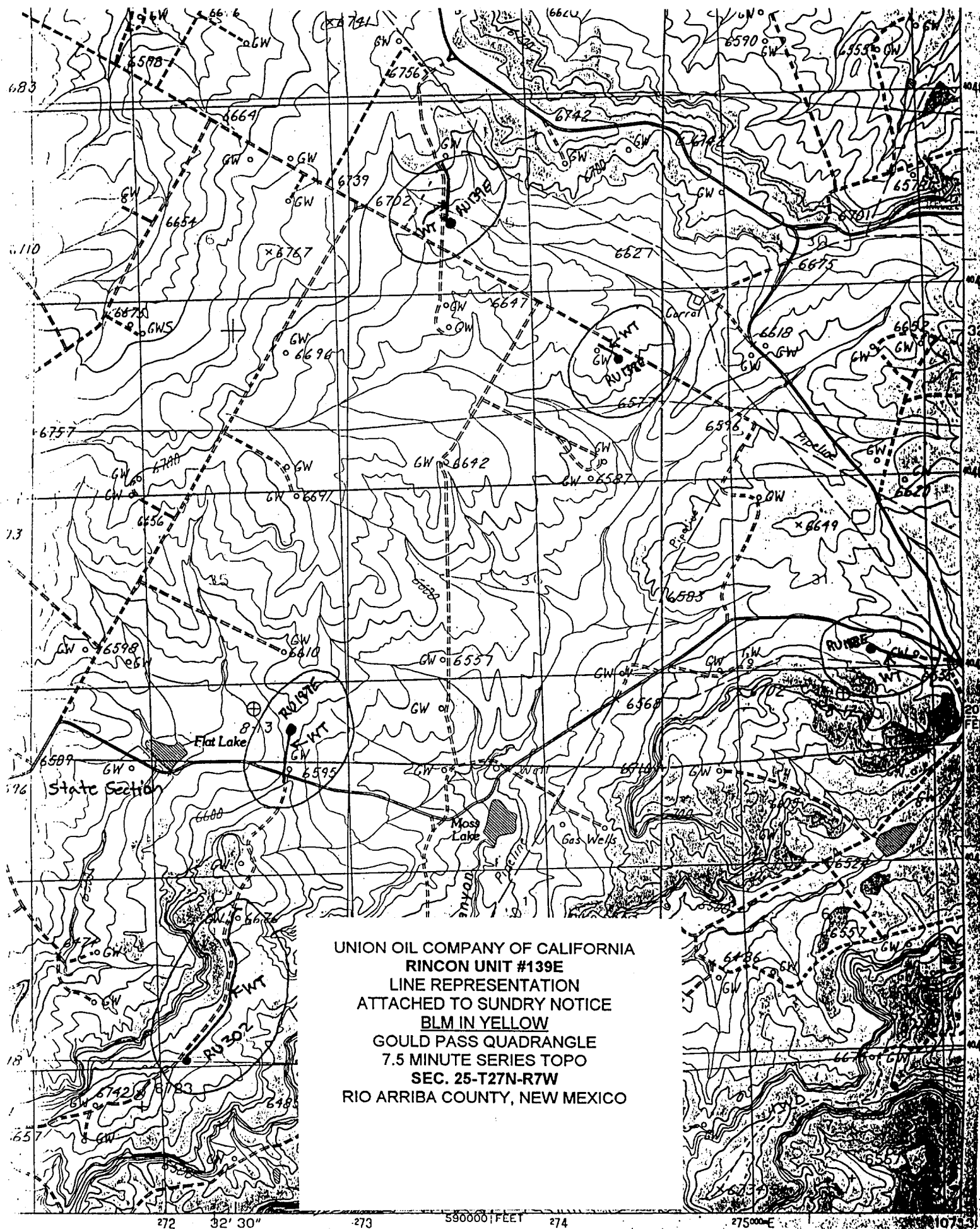

UNOCAL PROPOSED PIPELINE FOR RINCON UNIT NO. 139E

LOCATED IN SE/4, NW/4 AND THE NE/4, NW/4 OF SECTION 25 TOWNSHIP 27 NORTH
RANGE 7 WEST N.M.P.M., RIO ARriba COUNTY, NEW MEXICO
JUNE 30, 1984

