

# BURLINGTON RESOURCES

SAN JUAN DIVISION

February 13, 1997

SENT FEDERAL EXPRESS

Mr. William LeMay  
New Mexico Oil Conservation Division  
2040 South Pacheco Street  
Santa Fe, New Mexico 87505

Re: San Juan 28-6 Unit #207M *D 27*  
1450'FNL, 1575'FWL Section 10, T-28-N, R-6-W, Rio Arriba County, NM  
API #30-039-25612

Dear Mr. LeMay:

This is a request for administrative approval for downhole commingling the Blanco Mesa Verde and Basin Dakota pools in the subject well. This well is a new Mesa Verde/Dakota well that is being drilled and completed in 1997.

To comply with the New Mexico Oil Conservation Division rules, Burlington Resources Oil & Gas Company is submitting the following for your approval of this commingling:

1. Form C107A - Application for Downhole Commingling;
2. C-102 plat for each zone showing its spacing unit and acreage dedication;
3. Expected production curves;
4. Notification list of offset operators;
5. Shut in wellhead pressure and calculated down hole pressure;
6. Nine-section plats for the Mesa Verde and Dakota.

Notification of Mesa Verde and Dakota interest owners is covered under Reference Order #R-10696 issued November 7, 1996 attached.

We will consult with the Supervisor of the Aztec District Office of the New Mexico Oil Conservation Division to establish an allocation formula.

Please let me know if you require additional data.

Sincerely,



Peggy Bradfield  
Regulatory/Compliance Administrator

encs.

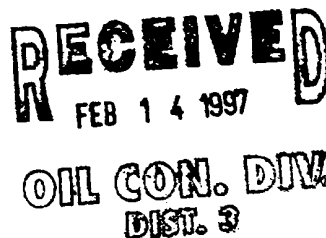

DISTRICT I  
P.O. Box 1980, Hobbs, NM 88241-1980  
DISTRICT II  
811 South First St., Artesia, NM 88210-2835  
DISTRICT III  
1000 Rio Brazos Rd, Aztec, NM 87410-1893

State of New Mexico  
Energy, Minerals and Natural Resources Department  
OIL CONSERVATION DIVISION  
2040 S. Pacheco  
Santa Fe, New Mexico 87505-6429

Form C-107-A  
New 3-12-96  
APPROVAL PROCESS :  
\_\_X Administrative \_\_Hearing  
EXISTING WELLBORE  
\_\_ YES \_\_X NO

APPLICATION FOR DOWNHOLE COMMINGLING

Operator Burlington Resources Oil & Gas Company		Address PO Box 4289, Farmington, NM 87499	
Lease San Juan 28-6 Unit	Well No. 207M	Unit Ltr. - Sec - Twp - Rge D 10-27-6	County Rio Arriba
Spacing Unit Lease Types: (check 1 or more)			
OGRID NO. 014538 Property Code 7462 API NO. 30-039-25612 Federal __x__, State ____, (and/or) Fee ____			

The following facts are submitted in support of downhole commingling:	Upper Zone	Intermediate Zone	Lower Zone
1. Pool Name and Pool Code	Mesa Verde - 72319		Dakota - 71599
2. Top and Bottom of Pay Section (Perforations)	will be supplied upon completion		will be supplied upon completion
3. Type of production (Oil or Gas)	gas		gas
4. Method of Production (Flowing or Artificial Lift)	flowing		flowing
5. Bottomhole Pressure Oil Zones - Artificial Lift: Estimated Current Gas & Oil - Flowing: Measured Current All Gas Zones: Estimated or Measured Original	(Current) a. 666 psi (see attachment)  (Original) b. 1275 psi (see attachment)	a.  b.	a. 599 psi (see attachment)  b. 3211 psi (see attachment)
6. Oil Gravity (°API) or Gas BTU Content	BTU 1198		BTU 1054
7. Producing or Shut-In?	shut in		shut in
Production Marginal? (yes or no)	no		yes
* If Shut-In and oil/gas/water rates of last production  Note: For new zones with no production history, applicant shall be required to attach production estimates and supporting data  * If Producing, give data and oil/gas/water water of recent test (within 60 days)	Date: n/a Rates:	Date: Rates:	Date: n/a Rates:
	Date: n/a Rates:	Date: Rates:	Date: n/a Rates:
8. Fixed Percentage Allocation Formula -% for each zone (total of %'s to equal 100%)	Oil: % Gas: %  will be supplied upon completion	Oil: % Gas: %  will be supplied upon completion	Oil: % Gas: %  will be supplied upon completion

9. If allocation formula is based upon something other than current or past production, or is based upon some other method, submit attachments with supporting data and/or explaining method and providing rate projections or other required data.
10. Are all working, overriding, and royalty interests identical in all commingled zones? Yes ☒ No ☐  
If not, have all working, overriding, and royalty interests been notified by certified mail? Yes ☒ No ☐  
Have all offset operators been given written notice of the proposed downhole commingling? ☒ Yes ☐ No
11. Will cross-flow occur? ☒ Yes ☐ No If yes, are fluids compatible, will the formations not be damaged, will any cross-flowed production be recovered, and will the allocation formula be reliable. ☒ Yes ☐ No (If No, attach explanation)
12. Are all produced fluids from all commingled zones compatible with each other? ☒ Yes ☐ No
13. Will the value of production be decreased by commingling? ☐ Yes ☒ No (If Yes, attach explanation)
14. If this well is on, or communitized with, state or federal lands, either the Commissioner of Public Lands or the United States Bureau of Land Management has been notified in writing of this application. ☒ Yes ☐ No
15. NMOC Reference Cases for Rule 303(D) Exceptions: ORDER NO(S). Reference Order # R-10696 attached
16. ATTACHMENTS:  
\* C-102 for each zone to be commingled showing its spacing unit and acreage dedication.  
\* Production curve for each zone for at least one year. (If not available, attach explanation.)  
\* For zones with no production history, estimated production rates and supporting data.  
\* Data to support allocation method or formula.  
\* Notification list of all offset operators.  
\* Notification list of working, overriding, and royalty interests for uncommon interest cases.  
\* Any additional statements, data, or documents required to support commingling.

I hereby certify that the information above is true and complete to the best of my knowledge and belief.

SIGNATURE James A. Smith TITLE Production Engineer DATE 02-13-97  
TYPE OR PRINT NAME James A. Smith TELEPHONE NO. (505) 327-9700

District I  
PO Box 1780, Hobbs, NM 88241-1780  
District II  
PO Drawer 80, Artesia, NM 88211-0719  
District III  
1000 Nio Huenes Rd., Aztec, NM 87410  
District IV  
PO Box 2088, Santa Fe, NM 87504-2088

State of New Mexico  
Energy, Minerals & Natural Resources Department

OIL CONSERVATION DIVISION  
PO Box 2088  
Santa Fe, NM 87504-2088

Form C-10  
Revised February 21, 1995  
Instructions on back  
Submit to Appropriate District Office  
State Lease - 4 Copies  
Fee Lease - 3 Copies

☐ AMENDED REPORT

WELL LOCATION AND ACREAGE DEDICATION PLAT

API Number 30-039-256.12	Well Code 72319/71599	Well Name Blanco Mesaverde/Basin Dakota
Property Code 7462	Property Name San Juan 28-6 Unit	Well Number 207M
OGRID No. 14538	Operator Name BURLINGTON RESOURCES OIL & GAS COMPANY	Elevation 6239'

10 Surface Location

UL or lot no. F	Section 10	Township 27-N	Range 6-W	Lot No. 1450	Feet from the North/South line North	Feet from the East/West line West	County R.A.
--------------------	---------------	------------------	--------------	-----------------	--	---	----------------

11 Bottom Hole Location if Different From Surface

UL or lot no.	Section	Township	Range	Lot No.	Feet from the North/South line	Feet from the East/West line	County
---------------	---------	----------	-------	---------	-----------------------------------	---------------------------------	--------

12 Dedication Acres  
W/320  
W/320

13 Joint or Infill  
14 Consolidation Code  
15 Order No.

NO ALLOWABLE WILL BE ASSIGNED TO THIS COMPLETION UNTIL ALL INTERESTS HAVE BEEN CONSOLIDATED  
OR A NON-STANDARD UNIT HAS BEEN APPROVED BY THE DIVISION

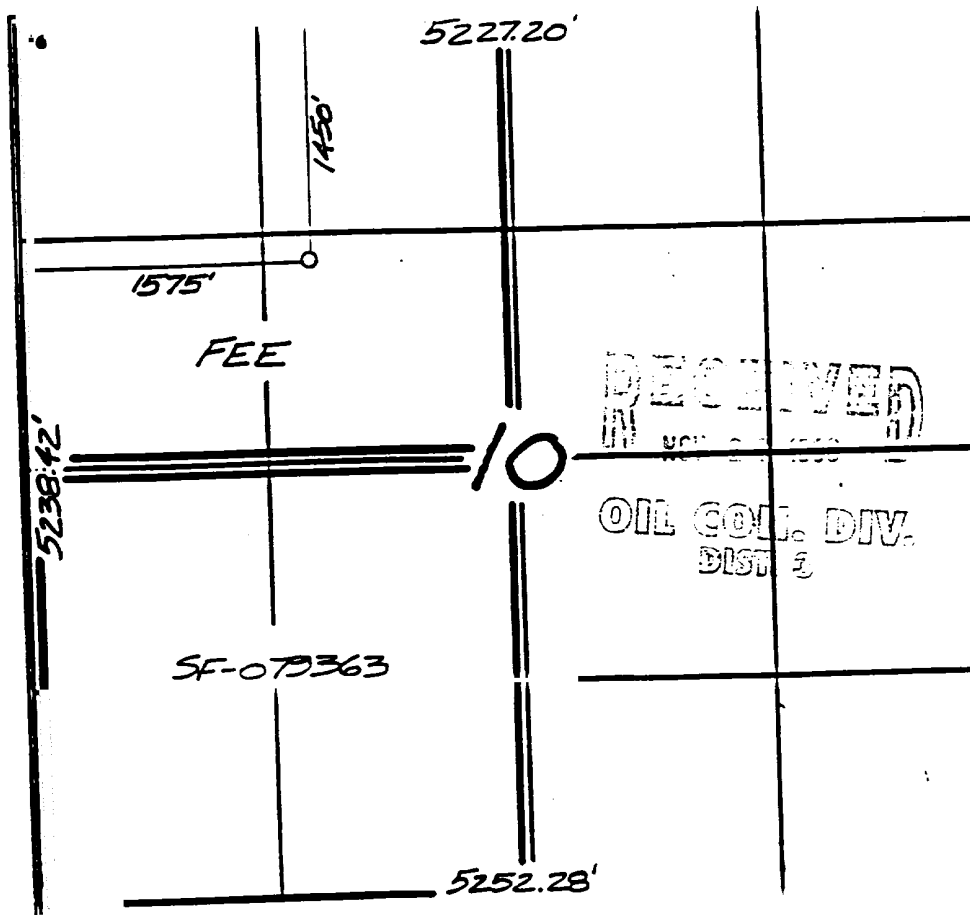

17 OPERATOR CERTIFICATE

I hereby certify that the information contained herein is true and complete to the best of my knowledge and belief.

Signature  
Peggy Bradfield  
Printed Name  
Regulatory Administrator  
Title  
11-25-96  
Date

18 SURVEYOR CERTIFICATE

I hereby certify that the well location shown on this plat was plotted from field notes of actual surveys made by or under my supervision, and that the same is true and correct to the best of my belief.

10/15/96

Date of Survey  
Signature  
NEAL C. EDWARDS  
8857  
6857

***BURLINGTON RESOURCES OIL AND GAS COMPANY***

**San Juan 28-6 Unit #207M  
OFFSET OPERATOR \ OWNER PLAT**

**Mesaverde / Dakota Formations Commingle Well**

**Township 27 North, Range 6 West**

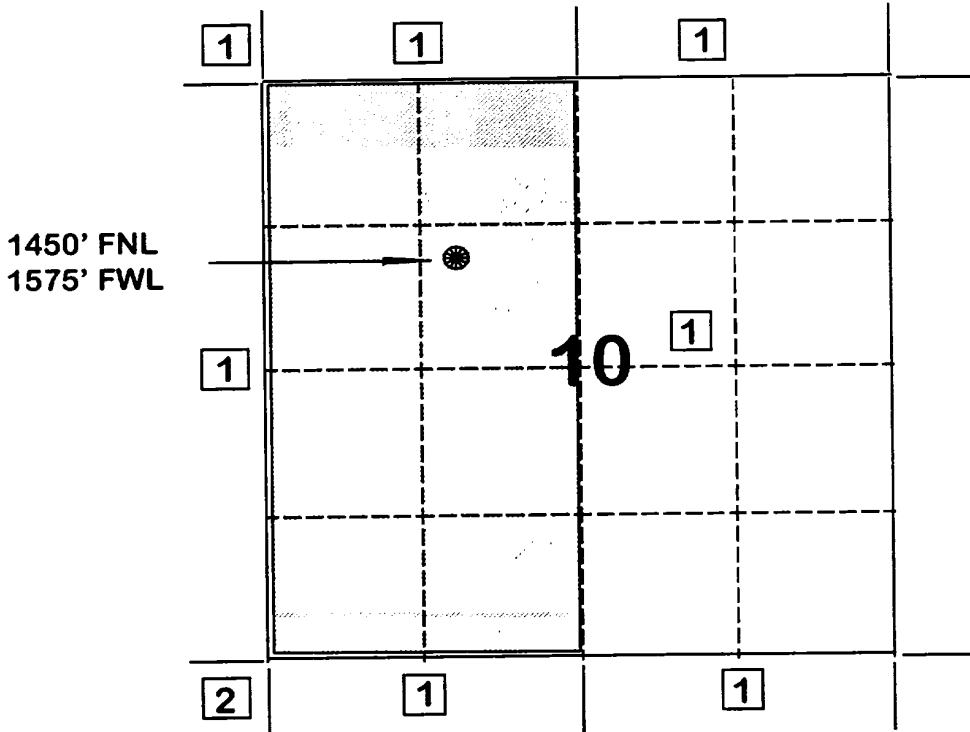

- 1) **Burlington Resources Oil and Gas Company Successor to Meridian Oil Inc.**
- 2) **UNOCAL Corp.**  
**1004 North Big Spring, Suite 300**  
**Midland, TX 79702**

# DAKOTA

SUN JUN 20 6 UNIT : 207M : 336440 -1

\* GAS  
\* OIL  
\* OIL/GAS  
\* WATER

10000  
1000  
1000  
1000

1000  
100  
100  
100

100  
10  
10  
10

10  
1  
1  
1

1  
0.1  
0.1  
0.1

1  
0.01  
0.01  
0.01

— DAILY GAS  
□ SIUHP  
+ FWHP

EXCLUDED PRODUCTION CURVE

Prop 22

- GAS Mcf/d
- OIL Bbl/d
- OIL/GAS
- WATER Bbls/d

RateTime  
Semi Log

98 00 02 04 06 08 10 12 14 16 18 20 22 24 26 28 30 32 34 36 38 40 42 44 46

MESA VERDE

SON JIJON 211-G UNIT : 207M : 33697A-1

Prop 21

TELEPHONE

SH  
H3

၁၀၇၂

110  
14

00  
00  
00  
00

001  
001  
001  
001

④

001  
001  
001  
001

↓

00  
01  
01  
00

1  
2  
3  
4  
5

9  
4  
1  
8

1

11

9-0-1

LL

0.0  
0.0  
1.0

3  
2  
1

# DAILY GAS

**SHIPS**

1111

RateTime  
Semi Log

**• GAS MCF/d**

00-01L Bb1/d

**Oil/GAS**

WATER Bb1s/d

**FLOWING AND STATIC BHP  
CULLENDER AND SMITH METHOD**

VERSION 1.0 3/13/94

GAS GRAVITY	0.614
COND. OR MISC. (C/M)	C
%N2	0.15
%CO2	1.2
%H2S	0
DIAMETER (IN)	1.5
DEPTH (FT)	7458
SURFACE TEMPERATURE (DEG F)	60
BOTTOMHOLE TEMPERATURE (DEG F)	200
FLOWRATE (MCFPD)	0
SURFACE PRESSURE (PSIA)	2700
BOTTOMHOLE PRESSURE (PSIA)	3210.9

SAN JUAN 28-6 UNIT #206 DAKOTA -ORIGINAL

**FLOWING AND STATIC BHP  
CULLENDER AND SMITH METHOD**

VERSION 1.0 3/13/94

GAS GRAVITY	0.614
COND. OR MISC. (C/M)	C
%N2	0.15
%CO2	1.2
%H2S	0
DIAMETER (IN)	1.5
DEPTH (FT)	7458
SURFACE TEMPERATURE (DEG F)	60
BOTTOMHOLE TEMPERATURE (DEG F)	200
FLOWRATE (MCFPD)	0
SURFACE PRESSURE (PSIA)	513
BOTTOMHOLE PRESSURE (PSIA)	599.4

SAN JUAN 28-6 UNIT #206 DAKOTA - CURRENT



Page No.: 1  
Print Time: Tue Jan 28 13:25:42 1997  
Property ID: 1892  
Property Name: SAN JUAN 28-6 UNIT | 206 | 44080A-1  
Table Name: K:\ARIES\RR97PDP\TEST.DBF

SJ 28-6 #207m  
Dakota offset

--DATE-- ---CUM GAS-- M SIWHP  
: : : : :Mcf: : :Psi:

05/27/74	0	2699.0	
06/18/74	0	2700.0	← original
10/25/74	38266	1278.0	
05/05/75	107377	819.0	
04/29/76	158712	670.0	
07/05/77	207211	613.0	
08/21/79	273492	597.0	
08/12/81	334499	582.0	
09/28/83	387549	671.0	
09/04/85	433439	716.0	
10/05/88	483187	862.0	
07/15/93	569153	513.0	← current

**FLOWING AND STATIC BHP  
CULLENDER AND SMITH METHOD**  
VERSION 1.0 3/13/94

GAS GRAVITY	0.702
COND. OR MISC. (C/M)	C
%N2	0.29
%CO2	0.8
%H2S	0
DIAMETER (IN)	2
DEPTH (FT)	5364
SURFACE TEMPERATURE (DEG F)	60
BOTTOMHOLE TEMPERATURE (DEG F)	150
FLOWRATE (MCFPD)	0
SURFACE PRESSURE (PSIA)	1095
BOTTOMHOLE PRESSURE (PSIA)	1274.5

SAN JUAN 28-6 UNIT #24 MESAVERDE -ORIGINAL

**FLOWING AND STATIC BHP  
CULLENDER AND SMITH METHOD**

VERSION 1.0 3/13/94

GAS GRAVITY	0.702
COND. OR MISC. (C/M)	C
%N2	0.29
%CO2	0.8
%H2S	0
DIAMETER (IN)	2
DEPTH (FT)	5364
SURFACE TEMPERATURE (DEG F)	60
BOTTOMHOLE TEMPERATURE (DEG F)	150
FLOWRATE (MCFPD)	0
SURFACE PRESSURE (PSIA)	580
BOTTOMHOLE PRESSURE (PSIA)	666.3

SAN JUAN 28-6 UNIT #24 MESAVERDE -ORIGINAL

```
Print Time: Tue Jan 28 13:25:07 1997
Property ID: 3994
Property Name: SAN JUAN 28-6 UNIT | 24 | 49372A-1
Table Name: K:\ARIES\RR97PDP\TEST.DBF
```

ST 28-6 #207m  
mesa verde offset

11/13/55	0	1095.0	← original
12/01/55	0	1094.0	
08/24/56	45000	862.0	
04/24/57	80000	737.0	
09/06/58	140000	829.0	
06/14/59	173000	794.0	
06/14/60	215000	675.0	
06/13/61	255000	664.0	
06/04/62	289000	654.0	
08/02/63	330000	645.0	
04/22/64	355000	635.0	
05/03/65	388000	619.0	
06/07/66	421000	634.0	
05/25/67	448000	611.0	
05/27/68	477000	605.0	
07/28/70	540011	536.0	
06/22/71	570514	496.0	
06/07/72	600802	477.0	
05/02/74	653611	530.0	
09/10/76	710800	521.0	
05/09/89	930084	582.0	
05/20/91	958502	568.0	
06/09/91	959495	580.0	← current

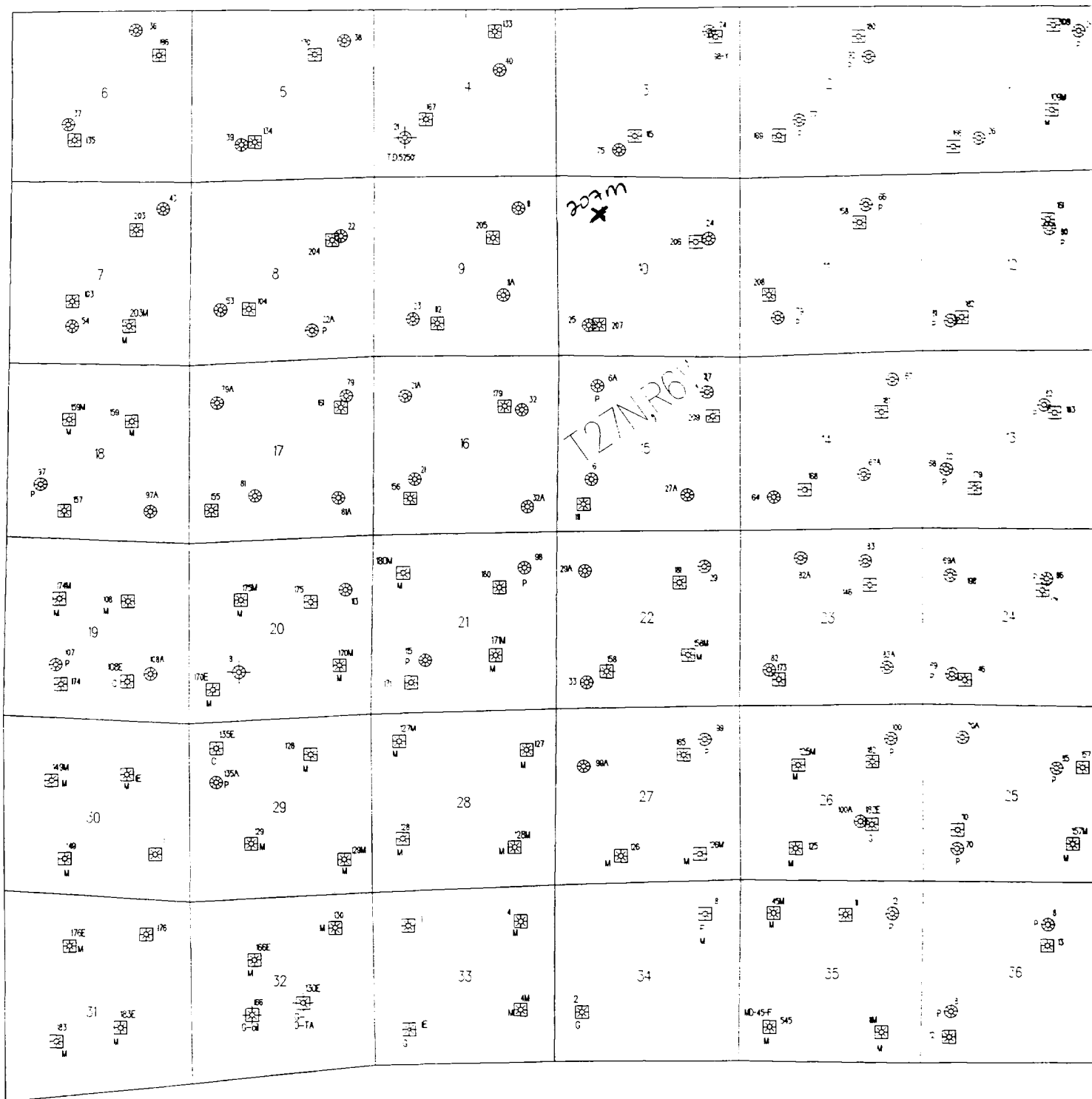

STATE OF NEW MEXICO  
ENERGY, MINERALS AND NATURAL RESOURCES DEPARTMENT  
OIL CONSERVATION DIVISION

IN THE MATTER OF THE HEARING  
CALLED BY THE OIL CONSERVATION  
DIVISION FOR THE PURPOSE OF  
CONSIDERING:

CASE NO. 11628  
ORDER NO. R-10696

APPLICATION OF BURLINGTON RESOURCES  
OIL & GAS COMPANY FOR THE ESTABLISHMENT  
OF A DOWNHOLE COMMINGLING "REFERENCE  
CASE" FOR ITS SAN JUAN 28-6 UNIT PURSUANT  
TO DIVISION RULE 303.E. AND THE ADOPTION  
OF SPECIAL ADMINISTRATIVE RULES THEREFOR,  
SAN JUAN COUNTY, NEW MEXICO..

**ORDER OF THE DIVISION**

**BY THE DIVISION:**

This cause came on for hearing at 8:15 a.m. on October 17 and November 7, 1996, at Santa Fe, New Mexico, before Examiners David R. Catanach and Michael E. Stogner, respectively.

NOW, on this 12th day of November, 1996, the Division Director, having considered the testimony, the record and the recommendations of the Examiner, and being fully advised in the premises,

**FINDS THAT:**

- (1) Due public notice having been given as required by law, the Division has jurisdiction of this cause and the subject matter thereof.
- (2) The applicant, Burlington Resources Oil & Gas Company (Burlington), pursuant to the provisions of Division Rule 303.E., seeks to establish a downhole commingling "reference case" to provide exceptions for (a) marginal economic criteria, (b) pressure criteria, (c) allocation formulas and (d) modification of notification rules on a unit-wide basis for downhole commingling of Dakota, Mesaverde, Fruitland Coal and Pictured Cliffs gas production within existing or future drilled wells within the San Juan 28-6 Unit, San Juan County, New Mexico.
- (3) Division Rule No. 303.E., amended by Order No. R-10470-A, currently states:

"If sufficient data exists on a lease, pool, formation, geographic area, etc., so as to render it unnecessary to repeatedly provide such data on Form C-107-A, an operator may except any of the various criteria required under Paragraph 303.D. of this rule by establishing a "reference case". The Division, upon its own motion, or by application from an operator, may establish "reference cases" either administratively or by hearing. Upon Division approval of such "reference cases" for specific criteria, subsequent applications to downhole commingle (Form C-107-A) will be required only to cite the Division order number which established such exceptions and shall not be required to submit data for those criteria."

(4) The applicant is the current operator of the San Juan 28-6 Unit which encompasses some 27,735 acres in Townships 27 and 28 North, Range 6 West, NMPM. San Juan County, New Mexico.

(5) Within the San Juan 28-6 Unit, the applicant currently operates ninety (90) Basin-Dakota Gas Pool wells, one hundred twenty-six (126) Blanco-Mesaverde Gas Pool wells, fifty-one (51) South Blanco-Pictured Cliffs Gas Pool wells, and fifty-eight (58) Basin-Fruitland Coal Gas Pool wells.

(6) According to its evidence and testimony, Burlington seeks to:

- a) establish a "reference case" for marginal economic criteria in the Dakota and Pictured Cliffs formations whereby these formations and/or pools may be identified as "marginal" on Form C-107-A's subsequently filed for wells within the San Juan 28-6 Unit. The applicant further proposes that the data provided in the immediate case serve as supplemental data or confirmation that these formations and/or pools should be classified as "marginal";
- b) establish a "reference case" for pressure criteria in the Dakota and Pictured Cliffs formations whereby the Division may utilize data provided in the immediate case to verify the pressure data provided on Form C-107-A's subsequently filed for wells within the San Juan 28-6 Unit;

- c) establish a "reference case" whereby the Division utilizes the data presented in the immediate case to endorse or approve certain methods of allocating production whereby the applicant need not submit additional data or justification when proposing a certain method of allocating production on Form C-107-A's subsequently filed for wells within the San Juan 28-6 Unit; and.
- d) establish a "reference case" or an administrative procedure for authorizing the downhole commingling of existing or future drilled wells within the San Juan 28-6 Unit without additional notice to each affected interest owner as required by Division Rule No. 303.D.

(7) In support of its request to except marginal economic criteria, the applicant presented geologic and engineering evidence and testimony which indicates that within the San Juan 28-6 Unit:

- a) the structure and thickness of the Dakota and Pictured Cliffs formations are very consistent;
- b) the average recoverable Dakota and Pictured Cliffs gas reserves underlying an undeveloped drill block are approximately 449 MMCFG and 186 MMCFG, respectively;
- c) the average initial producing rate for a newly drilled or recompleted Dakota and Pictured Cliffs gas well is approximately 254 MCFGD and 216 MCFGD, respectively; and,
- d) the estimated ultimate gas recoveries and initial producing rates from the Dakota and Pictured Cliffs formations are insufficient to justify drilling stand alone wells and/or dually completed wells to recover such gas reserves.

(8) The evidence and testimony presented by the applicant indicates that the Dakota and Pictured Cliffs formations within the San Juan 28-6 Unit should be properly classified as "marginal".

(9) In support of its request to except pressure criteria within the Dakota and Pictured Cliffs formations within the San Juan 28-6 Unit, the applicant presented engineering evidence and testimony which indicates that:



- a) the average shut-in bottomhole pressure within the Dakota and Pictured Cliffs formations at the time of initial development was approximately 3,172 psi and 1,173 psi, respectively; and.
- b) the average current shut-in bottomhole pressure within the Dakota and Pictured Cliffs formations is approximately 980 psi and 393 psi, respectively.

(10) There is sufficient pressure data available within the San Juan 28-6 Unit so as to except pressure criteria as proposed by the applicant.

(11) The applicant testified that various allocation methods will be utilized for downhole commingled wells within the San Juan 28-6 Unit depending on the circumstances. Some of the methods and circumstances are described as follows:

- a) the subtraction method will likely be utilized in those instances involving the Basin-Fruitland Coal Gas Pool and in those instances where a zone with a well established decline rate is commingled with a newly completed zone;
- b) a fixed allocation formula will be utilized in those instances where production history for both zones is available, or in those instances where newly completed zones are tested and stabilized flow rates obtained.

(12) The allocation methods proposed by the applicant are routinely utilized by industry and approved by the Division and therefore, the proposal to except allocation formulas should be approved.

(13) In support of its request to establish a "reference case" or administrative procedure for providing notice within the San Juan 28-6 Unit the applicant presented evidence and testimony which indicates that:

- a) the interest ownership between two zones within a given wellbore in the San Juan 28-6 Unit is generally not common;
- b) pursuant to Division Rule No. 303.D., applicant is currently required to notify all interest owners within the San Juan 28-6 Unit every time a Form C-107-A is submitted to the Division. There are a considerable number of such interest owners within the unit;

- c) providing notice to each interest owner within the San Juan 28-6 Unit of subsequent downhole comminglings is unnecessary and is an excessive burden on the applicant;
- d) the downhole commingling of wells within the San Juan 28-6 Unit Area will benefit working, royalty, and overriding royalty interest owners. In addition, the downhole commingling of wells within the San Juan 28-6 Unit should not violate the correlative rights of any interest owner;
- e) no interest owner appeared at the hearing in opposition to the establishment of a "reference case" or administrative procedure for notice.

(14) An administrative procedure should be established within the San Juan 28-6 Unit for obtaining approval for subsequent downhole commingled wells without notice to Unit interest owners, provided however that, all other provisions contained within Division Rule No. 303.C. are complied with.

(15) Approval of the proposed "reference cases" for marginal economic criteria, pressure criteria, allocation formulas and notice will lessen the burden on the applicant insofar as providing the data required pursuant to Division Rule No. 303.D. and Form C-107-A, will provide the applicant a streamlined method for obtaining downhole commingling approvals within the San Juan 28-6 Unit, and will not violate correlative rights.

**IT IS THEREFORE ORDERED THAT:**

(1) The application of Burlington Resources Oil & Gas Company to establish a "reference case" for (a) marginal economic criteria, (b) pressure criteria, (c) allocation formulas and (d) modification of notification rules on a unit-wide basis for downhole commingling of Dakota, Mesaverde, Fruitland Coal and Pictured Cliffs gas production within existing or future drilled wells within the San Juan 28-6 Unit, San Juan County, New Mexico, is hereby approved.

(2) Upon filing of Division Form No. C-107-A's for wells subsequently downhole commingled within the San Juan 28-6 Unit Area, the applicant shall not be required to submit supporting data to justify the classification of the Pictured Cliffs and Dakota formations as "marginal", supporting data to verify the Pictured Cliffs and Dakota pressure information provided, and support or justification for utilizing a given method or formula for allocation of production, provided however, in the event any of the data described above appearing on Form C-107-A appears to be beyond the data range provided in this case, the Division may require the submittal of additional supporting data.

(3) In order to obtain Division authorization to downhole commingle wells within the San Juan 28-6 Unit, the applicant shall file a Form C-107-A with the Santa Fe and Aztec Offices of the Division. Such application shall contain all the information required under Rule No. 303.C. of the Division Rules and Regulations, provided however that the applicant shall not be required to provide notice to all interest owners within the San Juan 28-6 Unit of such proposed commingling.

(4) Jurisdiction of this cause is retained for the entry of such further orders as the Division may deem necessary.

DONE at Santa Fe, New Mexico, on the day and year hereinabove designated.

STATE OF NEW MEXICO  
OIL CONSERVATION DIVISION



WILLIAM J. LeMAY  
Director

S E A L

State of New Mexico  
Energy, Minerals and Natural Resources Department  
Oil Conservation Division

Sundry Notices and Reports on Wells

<p>1. Type of Well GAS</p> <hr/> <p>2. Name of Operator <b>BURLINGTON RESOURCES</b> OIL &amp; GAS COMPANY</p> <hr/> <p>3. Address &amp; Phone No. of Operator PO Box 4289, Farmington, NM 87499 (505) 326-9700</p> <hr/> <p>4. Location of Well, Footage, Sec., T, R, M 1450'FNL, 1575'FWL, Sec.10, T-27-N, R-6-W, NMPM, Rio Arriba County</p>	<p>API # (assigned by OCD) 30-039-25612</p> <p>5. Lease Number Fee</p> <p>6. State Oil&amp;Gas Lease #</p> <p>7. Lease Name/Unit Name San Juan 28-6 Unit</p> <p>8. Well No. 207M</p> <p>9. Pool Name or Wildcat Blanco MV/Basin DK</p> <p>10. Elevation:</p>
--	--

Type of Submission	Type of Action
<input type="checkbox"/> Notice of Intent	<input type="checkbox"/> Abandonment
<input checked="" type="checkbox"/> Subsequent Report	<input type="checkbox"/> Recompletion
<input type="checkbox"/> Final Abandonment	<input type="checkbox"/> Plugging Back
	<input type="checkbox"/> Casing Repair
	<input type="checkbox"/> Altering Casing
	<input checked="" type="checkbox"/> Other -
	<input type="checkbox"/> Change of Plans
	<input type="checkbox"/> New Construction
	<input type="checkbox"/> Non-Routine Fracturing
	<input type="checkbox"/> Water Shut off
	<input type="checkbox"/> Conversion to Injection

13. Describe Proposed or Completed Operations

2-8-97 MIRU. ND WH. NU BOP. TIH w/free point to 2170'. Chemical cut 4 1/2" csg @ 2166'.  
TOOH w/51 jts 4 1/2" csg. TIH to lnr top @ 2166'. Work swedge on 4 1/2" csg  
cut off. TOOH. TIH, blow well & CO.

RECEIVED  
FEB 10 1997  
OIL CON. DIV.  
DIST. 3

SIGNATURE  Regulatory Administrator February 17, 1997

(This space for State Use)

Approved by \_\_\_\_\_ Original Signed by FRANK T. CHAVEZ Title SUPERVISOR DISTRICT # 3 Date FEB 19 1997