

DISTRICT I  
P.O. Box 1980, Hobbs, NM 88241-1980

DISTRICT II  
811 South First St. Artesia NM 88210-2835

DISTRICT III  
1000 Rio Brazos Rd. Aztec, NM 87410-1693

State of New Mexico  
Energy, Minerals and Natural Resources Department

OIL CONSERVATION DIVISION

2040 S. Pacheco  
Santa Fe, New Mexico 87505-6429

Form C-107-A  
New 3-12-96

APPROVAL PROCESS:

☒ Administrative ☐ Hearing

EXISTING WELLBORE

☐ YES ☒ NO

APPLICATION FOR DOWNHOLE COMMINGLING

Conoco Inc.

10 Desta Dr. Ste 100W, Midland, Tx. 79705-4500

Address

San Juan Unit 28-7

#214M

Section 4, T-27-N, R-7-W, P

Rio Arriba

Lease

Well No

Unit Ltr Sec Twp Rge

County

Spacing Unit Lease Types (check 1 or more)

OGRID NO. 005073 Property Code 16608 API NO. 30-039-25793 Federal ☒ State ☐ (and/or) Fee ☐

The following facts are submitted in support of downhole commingling.	Upper Zone	Intermediate Zone	Lower Zone
1. Pool Name and Pool Code	Blanco Mesaverde 72319		Basin Dakota 71599
2. TOP and Bottom of Pay Section (Perforations)	4940-5890'		7540-7777'
3. Type of production (Oil or Gas)	Gas		Gas
4. Method of Production (Flowing or Artificial Lift)	To Flow		To Flow
5. Bottomhole Pressure	a. (Current) 457		a. 713
Oil Zones - Artificial Lift Estimated Current Gas & Oil - Flowing Measured Current All Gas Zones: Estimated Or Measured Original	b.(Original) 1230		b. 2946
6. Oil Gravity (~API) or Gas BT Content	1270		1236
7. Producing or Shut-In?	To be Completed		To be Completed
Production Marginal? (yes or no)	Yes (expected)		Yes (expected)
• If Shut-In give date and oil/gas/water rates of last production  Note For new zones with no production history applicant shall be required to attach production estimates and supporting data  • If Producing, date and oil/gas/water rates of recent test (within 60 days)	Date Rates  350 MCFD Anticipated 1st Yr average	Date Rates  Date Rates	Date Rates  330 MCFD Anticipated 1st Yr Average
8. Fixed Percentage Allocation Formula - % of each zone	Oil Gas %	Oil Gas %	Oil Gas %

9. If allocation formula is based upon something other than current or past production, or is based upon some other method, submit attachments with supporting data and/or explaining method and providing rate projections or other required data.

10. Are all working, overriding, and royalty interests identical in all commingled zones? Yes ☒ No ☐  
If not, have all working, overriding, and royalty interests been notified by certified mail? Yes ☒ No ☐  
Have all offset operators been given written notice of the proposed downhole commingling? Yes ☒ No ☐

11. Will cross-flow occur? ☒ Yes ☐ No If yes, are fluids compatible, will the formations not be damaged, will any cross-flowed production be recovered, and will the allocation formula be reliable. ☒ Yes ☐ No (If No, attach explanation)

12. Are all produced fluids from all commingled zones compatible with each others ☒ Yes ☐ No

13. Will the value of production be decreased by commingling? ☐ Yes ☒ No (If Yes, attach explanation)

14. If this well is on, or communitized with, state or federal lands, either the Commissioner of Public Lands or the United States Bureau of Land Management has been notified in writing of this application. ☒ Yes ☐ No

15. NMOCD Reference Cases for Rule 303(D) Exceptions: ORDER NO(S). R-10476 B NSL 3950

16. ATTACHMENTS

- \* C-102 for each zone to be commingled showing its spacing unit and acreage dedication.
- \* Production curve for each zone for at least one year. (If not available, attach explanation.)
- \* For zones with no production history, estimated production rates and supporting data.
- \* Data to support allocation method or formula.
- \* Notification list of all offset operators.
- \* Notification list of working, overriding and royalty interests for uncommon interest cases.
- \* Any additional statements, data, or documents required to support commingling.

I hereby certify that the information above is true and complete to the best of my knowledge and belief.

SIGNATURE Kay Maddox TITLE Regulatory Agent DATE 4/6/98

TYPE OR PRINT NAME Kay Maddox TELEPHONE NO. (915) 686-5798

### NORMALIZED MESAVERDE PRODUCTION

PROD. SINCE 1975: 20 MV WELLS LOCATED IN W 2/3 OF 28N-7W AND N/3 OF 27N-7W

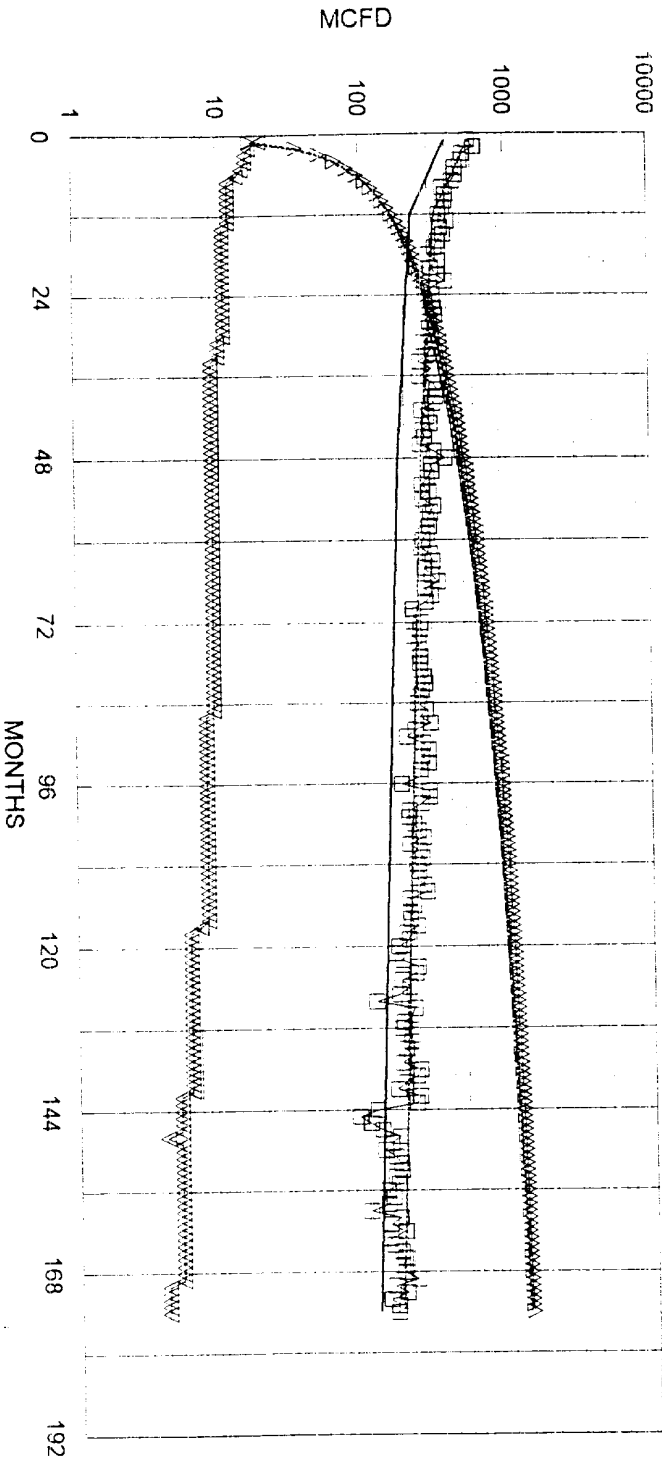

--- FIT MCFD      ( ) NORMALIZED MCFD      ^ NORM CUM MMCF  
v WELLS ON PRODUCTION      --- FIT CUM MMCF      --- RISKED MCFD

Expected Mesaverde Production - #145M, 156M, 199E, 214M, 215M, 249M  
Expected Avg. Rate for Yr. 1 = 452MCFD

CONSERVATION DIVISION  
PO BOX 2088  
Santa Fe, NM 87504-2088

WELL LOCATION AND ACCEGE DESCRIPTION PLAT

SPR Number	Pool Code	Pool Name
72319/71599		Blanco Mesaverde/Basin Dakota
Well Number	Property Name	Well Number
214V	SAN JUAN 23-7 UNIT	214V
Operator Name	Elevation	
CONOCO, INC.	6707	

10 Surface Location

Section No	Section	Township	Range	Lot Ion	Feet from the	North/South line	Feet from the	East/West line	County
4	4	27N	7W		870	South	270	East	ARIZONA

11 Bottom Hole Location If Different From Surface

Section No	Section	Township	Range	Lot Ion	Feet from the	North/South line	Feet from the	East/West line	County

Dedicated Acres	Joint or Infill	Consolidation Code	Order No.
E/320	Y	U	Non-Standard Location (Applied for)

NO ALLOWABLE WILL BE ASSIGNED TO THIS COMPLETION UNTIL ALL INTERESTS HAVE BEEN CONSOLIDATED OR A NON-STANDARD UNIT HAS BEEN APPROVED BY THE DIVISION

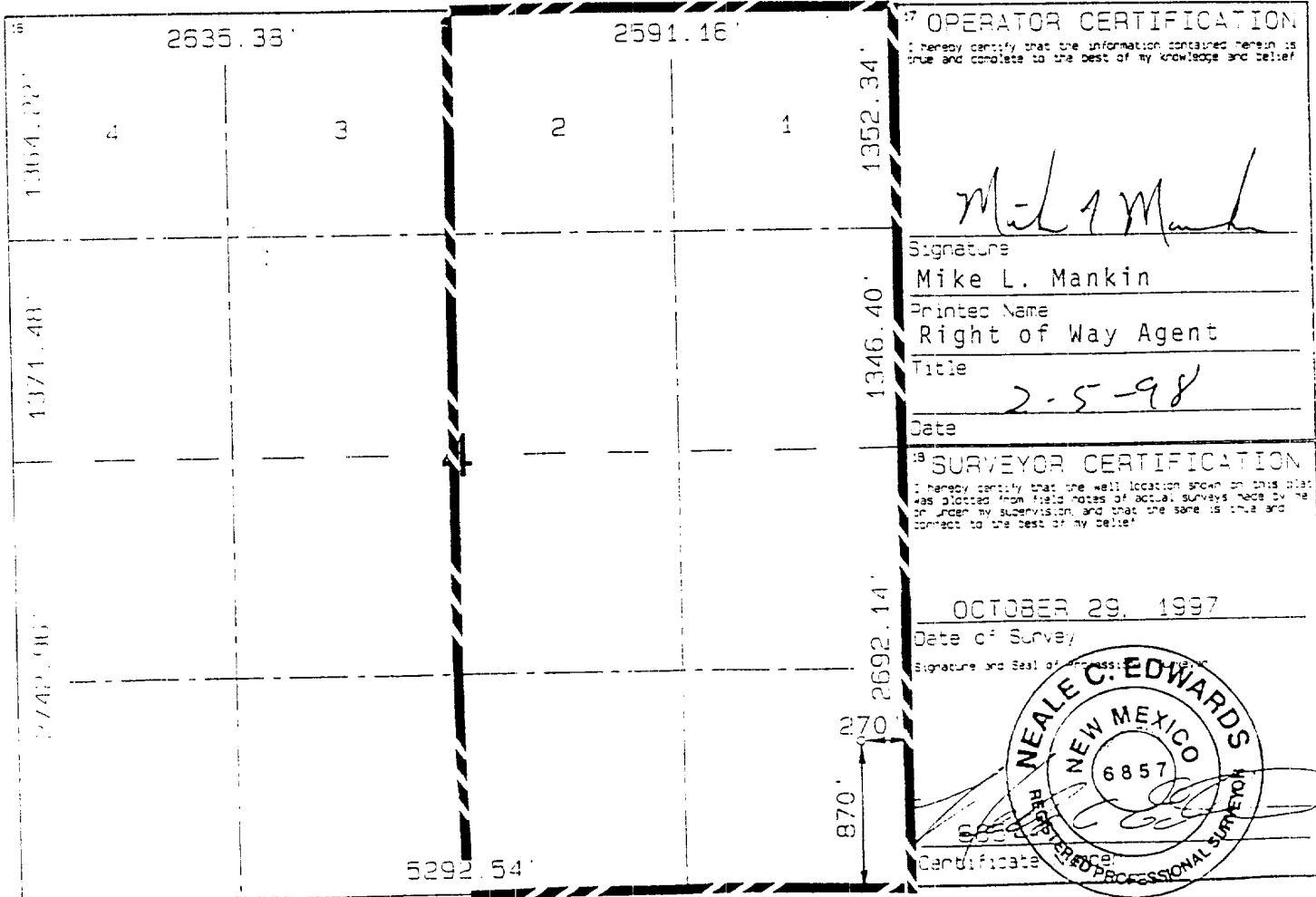

**UNITED STATES  
DEPARTMENT OF THE INTERIOR  
BUREAU OF LAND MANAGEMENT**

SUBMIT IN TRIPlicate  
Other instructions on  
reverse side

FORM APPROVED  
OMB NO. 1004-0136  
Expires February 28, 1995

**APPLICATION FOR PERMIT TO DRILL OR DEEPEN**

1. TYPE OF WORK DRILL <input checked="" type="checkbox"/> DEEPEN <input type="checkbox"/>			5. LEASE DESIGNATION AND SERIAL NO SF 078570	
2. NAME OF OPERATOR Conoco Inc. 5073			6. IF INDIAN, ALLOTTEE OR TRIBE NAME	
3. ADDRESS AND TELEPHONE NO 10 Desta Dr. Ste 430E, Midland, Tx. 79705-4500			7. UNIT AGREEMENT NAME 11-608 San Juan 28-7	
4. LOCATION OF WELL (Report location clearly and in accordance with any State requirements *) At surface 870' FSL & 270' FEL At proposed prod zone 870' FSL & 270' FEL			8. FARM OR LEASE NAME WELL NO 214M	
14. DISTANCE IN MILES AND DIRECTION FROM NEAREST TOWN OR POST OFFICE *			9. API WELL NO 30-639-25793	
5. DISTANCE FROM PROPOSED LOCATION TO NEAREST PROPERTY OR LEASE LINE, FT (Also to nearest drlg. unit line, if any)		16. NO OF ACRES IN LEASE	17. NO. OF ACRES ASSIGNED TO THIS WELL 320.17	
8. DISTANCE FROM PROPOSED LOCATION TO NEAREST WELL, DRILLING, COMPLETED, OR APPLIED FOR, ON THIS LEASE, FT.		19. PROPOSED DEPTH 777'	20. ROTARY OR CABLE TOOLS Rotary	
21. ELEVATIONS (Show whether DF, RT, GR, etc) 6707' GR		32. APPROX. DATE WORK WILL START 3/1/98		
23. PROPOSED CASING AND CEMENTING PROGRAM				
SIZE OF HOLE	GRADE, SIZE OF CASING	WEIGHT PER FOOT	SETTING DEPTH	QUANTITY OF CEMENT
12-1/4"	K-55, 9-5/8"	36#	250'	145 sxs, circ.
8-3/4"	K-55, 7"	23#	3565'	470 sxs, circ.
6-1/4"	K-55, 4-1/2"	9.5#	777'	530 sxs, toc @ 3400'

It is proposed to drill a vertical wellbore to the Blanco Mesaverde and Basin Dakota Pools. An NOS was filed 10/10/97. The well will be drilled and equipped according to the following additional attachments:

1. Well Location & Acreage Dedication Plat (C-102).
2. Proposed Well Plan Outline.
3. Cementing Plan.
4. Blowout Preventer Hookup.
5. Surface Use Plan with Production Facility layout.
6. Temporary Pipeline Tie Specifications.

**RECEIVED**  
FEB 27 1998  
**OIL CON. DIV.**  
DIST. 3

070 INFORMATION, NMA  
99 FEB -6 PM 3:04  
RECEIVED

This application includes ROW's for the well pad, access road, cathodic protection and pipeline.

DRILLING OPERATIONS AUTHORIZED ARE  
SUBJECT TO COMPLIANCE WITH ATTACHED  
"GENERAL REQUIREMENTS"

IN ABOVE SPACE DESCRIBE PROPOSED PROGRAM: If proposal is to deepen give data on present productive zone and proposed new productive zone. If proposal is to drill or deepen directionally, give pertinent data on subsurface locations and measured and true vertical depths. Give blowout preventer program, if any.

SIGNED Mike L. Mankin TITLE Right of Way Agent DATE 2-5-98

(This space for Federal or State office use)

PERMIT NO. \_\_\_\_\_ APPROVAL DATE FEB 24 1998

Application approval does not warrant or certify that the applicant holds legal or equitable title to those rights in the subject lease which would entitle the applicant to conduct operations thereon  
CONDITIONS OF APPROVAL IF ANY

APPROVED BY \_\_\_\_\_ TITLE \_\_\_\_\_ DATE 2/24/98

\*See Instructions On Reverse Side

Title 18 U.S.C. Section 1001, makes it a crime for any person knowingly and willfully to make to any department or agency of the United States any false, fictitious or fraudulent statements or representations as to any matter within its jurisdiction.

HEAD OFFICE FOR US (E) NMOCOD

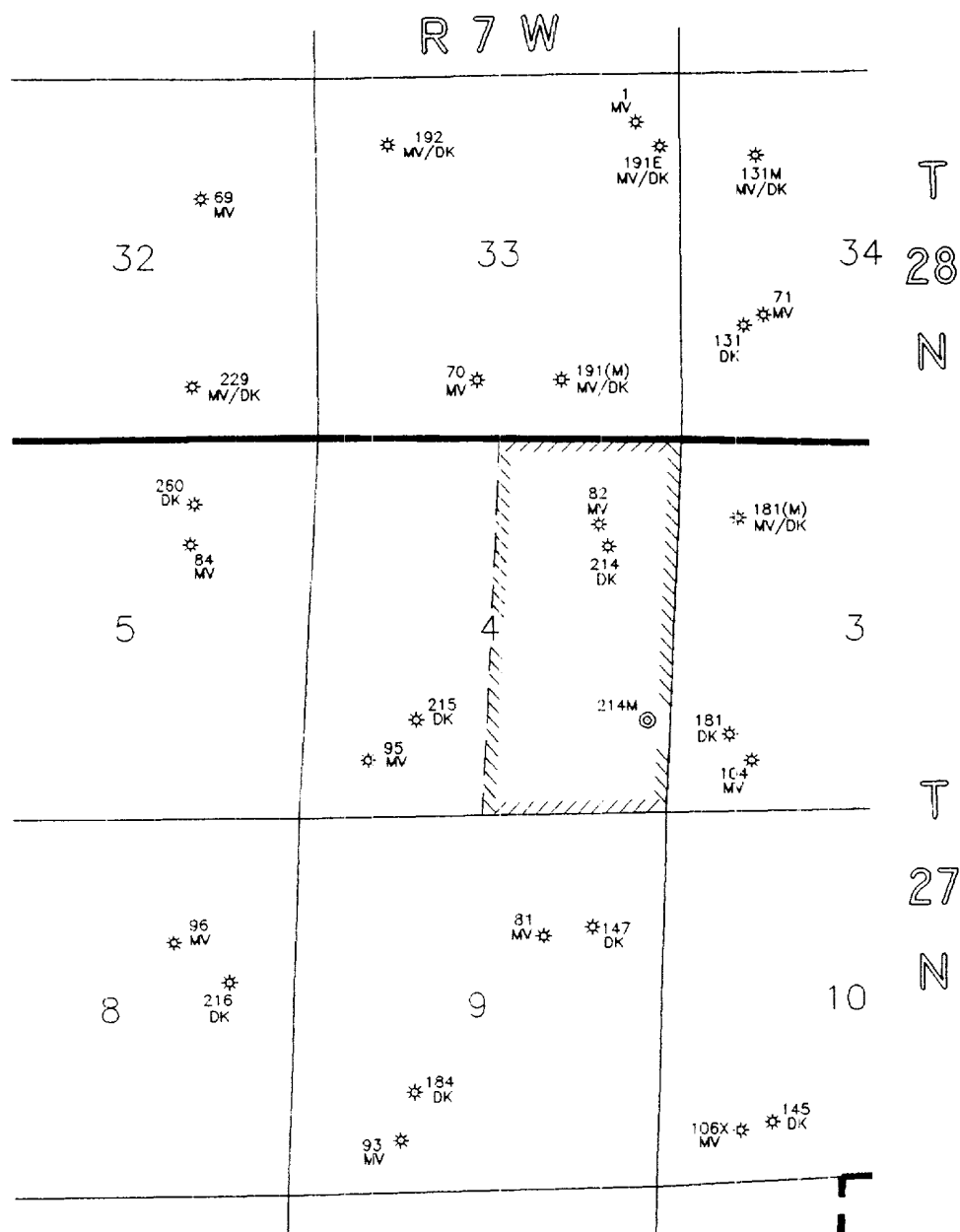

**SAN JUAN 28-7 UNIT  
RIO ARRIBA CO., N.M.**

NOTES		<div> <div>conoco</div> <div>EPNGNA MIDLAND DIVISION</div> </div>		
<p>CONOCO OPERATES ALL MESAVERDE AND DAKOTA WELLS WITHIN THE 28-7 UNIT.</p> <p>MAP SHOWS ONLY MESAVERDE AND DAKOTA WELLS</p>	DATE: 02/06/98	<div> <div>CONOCO 28-7 UNIT MESAVERDE &amp; DAKOTA PRODUCERS San Juan 28-7 Unit #214M Non-Standard Location</div> </div>		
	DRAWN BY: GLG			
	CHECKED BY:			
	APPROVED BY:			
	SCALE: 1" = 2640'	<div> <div>STATE API COUNTY</div> <div>039 \ 30</div> <div>DRAWING</div> <div>28-7_214</div> </div>		
	<div>STATE PLANE COORDINATES REFERRED TO NAD27 - N.M. WEST STATE PLANE COORDINATES ZONE - 3003</div>		<div>CONOCO INC. OFFICE 10 DESTA DRIVE WEST MIDLAND, TEXAS 79705</div>	

April 6, 1998

RE: Application C-107A to Downhole Comrningle

**Notification Of Offset Operators:**

Conoco, Inc. is the only offset operator