

UNITED STATES
DEPARTMENT OF THE INTERIOR
BUREAU OF LAND MANAGEMENT

APPLICATION FOR PERMIT TO DRILL OR DEEPEN

1a. TYPE OF WORK

DRILL ☒

DEEPEN ☐

b. TYPE OF WELL

OIL WELL ☐

GAS WELL ☒

OTHER ☐

SINGLE ZONE ☒

MULTIPLE ZONE ☐

2. NAME OF OPERATOR

Conoco Inc. 5073

a. ADDRESS AND TELEPHONE NO

10 Desta Dr. Ste 430E, Midland, Tx. 79705-4500

4. LOCATION OF WELL (Report location clearly and in accordance with any State requirements *)

At surface

1090' FNL & 980' FWL

At proposed prod. zone

1090' FNL & 980' FWL

14. DISTANCE IN MILES AND DIRECTION FROM NEAREST TOWN OR POST OFFICE*

5. LEASE DESIGNATION AND SERIAL NO

SF 078840

6. IF INDIAN, ALLOTTEE OR TRIBE NAME

7. UNIT AGREEMENT NAME

1660P San Juan 28-7 Unit

8. FARM OR LEASE NAME WELL NO

109M

9. API WELL NO

30-039-25794

10. FIELD AND POOL, OR WILDCAT

72319 B Mesaverde/Basin Dakota

11. SEC. T. R. M. OR BLK AND SURVEY OR AREA

D Sec.18, T27N, R7W

12. COUNTY OR PARISH

Rio Arriba

13. STATE

NM

5. DISTANCE FROM PROPOSED*

LOCATION TO NEAREST
PROPERTY OR LEASE LINE, FT.
(Also to nearest drlg. unit line, if Any)

16. NO OF ACRES IN LEASE

17. NO. OF ACRES ASSIGNED
TO THIS WELL

320.36

8. DISTANCE FROM PROPOSED LOCATION*
TO NEAREST WELL, DRILLING, COMPLETED,
OR APPLIED FOR, ON THIS LEASE, FT.

19. PROPOSED DEPTH

7494'

20. ROTARY OR CABLE TOOLS

Rotary

21. ELEVATIONS (Show whether DF, RT, GR, etc)

6554' GR

22. APPROX. DATE WORK WILL START*

3/15/98

This action is subject to technical and
procedural review pursuant to 43 CFR 3165.3
and appeal pursuant to 43 CFR 3165.4.

PROPOSED CASING AND CEMENTING PROGRAM

DRILLING OPERATIONS AUTHORIZED ARE
SUBJECT TO COMPLIANCE WITH ATTACHED
GENERAL REQUIREMENT

SIZE OF HOLE	GRADE, SIZE OF CASING	WEIGHT PER FOOT	SETTING DEPTH	GENERAL REQUIREMENT
12-1/4"	K-55, 9-5/8"	36#	250'	145 sxs, circ.
8-3/4"	K-55, 7"	23#	3247'	430 sxs, circ.
6-1/4"	K-55, 4-1/2"	9.5#	7494'	535 sxs, toc @ 3100'

It is proposed to drill a vertical wellbore to the Blanco Mesaverde and Basin Dakota Pools. An NOS was filed 10/13/97. The well will be drilled and equipped according to the following additional attachments:

1. Well Location & Acreage Dedication Plat (C-102).
2. Proposed Well Plan Outline.
3. Cementing Plan.
4. Blowout Preventer Hookup.
5. Surface Use Plan with Production Facility layout.
6. Pipeline Tie Specifications with plat.

This application includes ROW's for the well pad, access road, cathodic protection and pipeline.

RECEIVED
MAR - 2 1998
OIL CON. DIV.
DIST. 3

NO INFORMATION FOR
10/11/98

IN ABOVE SPACE DESCRIBE PROPOSED PROGRAM: If proposal is to deepen give data on present productive zone and proposed new productive zone. If proposal is to drill or deepen directionally, give pertinent data on subsurface locations and measured and true vertical depths. Give blowout preventer program, if any.

24. Jo Ann Johnson Property Analyst 2-12-98
SIGNED Jo Ann Johnson TITLE DATE

(This space for Federal or State office use)

PERMIT NO. _____ APPROVAL DATE FEB 25 1998

Application approval does not warrant or certify that the applicant holds legal or equitable title to those rights in the subject lease which would entitle the applicant to conduct operations thereon.

CONDITIONS OF APPROVAL, IF ANY:

APPROVED BY AS/Dunne W. Spencer TITLE _____ DATE FEB 25 1998

*See Instructions On Reverse Side

Title 18 U.S.C. Section 1001, makes it a crime for any person knowingly and willfully to make to any department or agency of the United States any false, fictitious or fraudulent statements or representations as to any matter within its jurisdiction.

OK

NMOCD

District II
PO Drawer 60, Artesia, NM 88211-0713

OIL CONSERVATION DIVISION
PO Box 2088
Santa Fe, NM 87504-2088

Submit to Appropriate District Office
State Lease - 4 Copies
Fee Lease - 3 Copies

District III
1000 Rio Brazos Rd., Aztec, NM 87410

District IV
PO Box 2088, Santa Fe, NM 87504-2088

50 FEB 13 PM 1:32 AMENDED REPORT

WELL LOCATION AND ACREAGE DEDICATION PLAT

*API Number 30-039-25794	*Pool Code 72319/71599	*Pool Name Blanco Mesaverde/Basin Dakota
*Property Code 016608	*Property Name SAN JUAN 28-7 UNIT	*Well Number 109M
*GRID No. 005073	*Operator Name CONOCO, INC.	*Elevation 6554'

10 Surface Location

UL or lot no. D	Section 18	Township 27N	Range 7W	Lot Idn	Feet from the 1090	North/South line North	Feet from the 980	East/West line West	County RIO ARriba
---------------------------	----------------------	------------------------	--------------------	---------	------------------------------	----------------------------------	-----------------------------	-------------------------------	-----------------------------

11 Bottom Hole Location If Different From Surface

UL or lot no.	Section	Township	Range	Lot Idn	Feet from the	North/South line	Feet from the	East/West line	County
---------------	---------	----------	-------	---------	---------------	------------------	---------------	----------------	--------

12 Dedicated Acres 320.36	13 Joint or Infill Y	14 Consolidation Code U	15 Order No.
-------------------------------------	--------------------------------	-----------------------------------	--------------

NO ALLOWABLE WILL BE ASSIGNED TO THIS COMPLETION UNTIL ALL INTERESTS HAVE BEEN CONSOLIDATED
OR A NON-STANDARD UNIT HAS BEEN APPROVED BY THE DIVISION

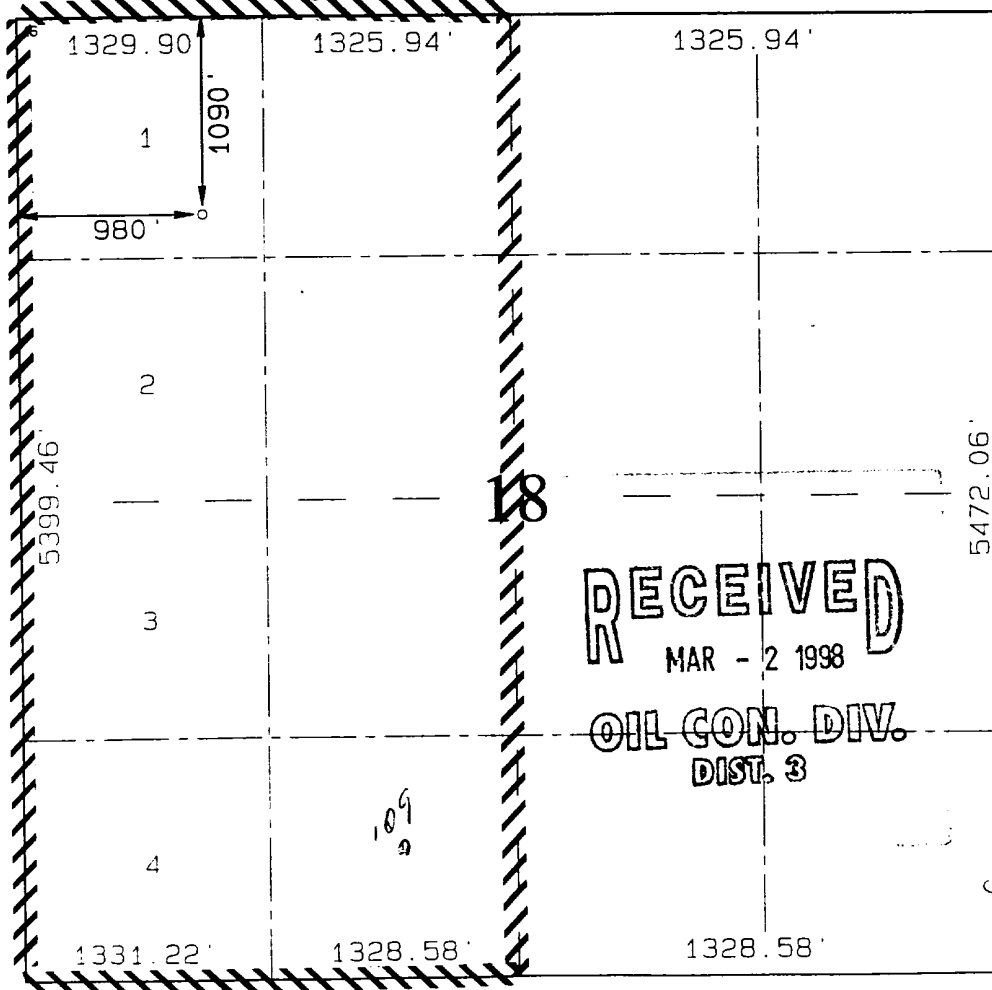

17 OPERATOR CERTIFICATION
I hereby certify that the information contained herein is true and complete to the best of my knowledge and belief

Mike L. Mankin
Signature
Mike L. Mankin
Printed Name
Right of Way Agent
Title
2-12-98
Date

18 SURVEYOR CERTIFICATION
I hereby certify that the well location shown on this plat was plotted from field notes of actual surveys made by me or under my supervision, and that the same is true and correct to the best of my belief.

OCTOBER 22, 1997
Date of Survey
Signature and Seal of Professional Surveyor
NEALE C. EDWARDS
NEW MEXICO
6857
REGISTERED PROFESSIONAL SURVEYOR
Certificate No. 6857

PROPOSED WELL PLAN OUTLINE

EST. GL = 6554

EST. KB = 6567

WELL NAME: SJ 28-7 UNIT No. 109M

LOCATION: SEC 18, T-27N, R-7W, RIO ARriba CO., NM

TVD IN	FORMATION TOPS & TYPE	DRILLING PROBLEMS	TYPE OF FORMATION EVALUATION	HOLE SIZE	CASING SIZE DEPTH	FRAC GRAD. psi/ft	FORMATION PRESSURE PSI	MUD WT TYPE	DAYS
1000 MD									
0				12-1/4"	9-5/8" 36# K-55 ST&C @ 250'		NORMAL	8.4 - 8.8# SPUD MUD	1
				8-3/4"	CWC CMT			8.4 - 9.0# GEL/WATER MAINTAIN MW AS LOW AS POSSIBLE	
1									
2	OJAM @ 2118' KRLD @ 2230'	POSSIBLE WATERFLOW					432 PSI		
	FRLD @ 2534'	POSSIBLE GAS FLOW					360 PSI	CONTROL FLUID LOSS PRIOR TO OJAM	
	PCCF @ 2947'	POSSIBLE LOST RETURNS POSSIBLE DIFFERENTIAL STICKING							
3	LEWS @ 3082'			8-3/4"	7" 23# K-55 LTC at 3247' (special drift)				5
				6-1/4"	CWC CMT			AIR/AIR MIST/GAS	
4	CHRA @ 3828'						400 PSI		
	CLFHMY @ 4582' MENF @ 4683'	PROBABLE LOST RETURNS IF FLUID IN HOLE				0.5	457 PSI		
5	PTLK @ 5147'								
	MNCS @ 5521'								
6	GLLP @ 6370'								
7	GRHN @ 7135' GRRS DKOT @ 7197' PAGU @ 7382'	POSSIBLE WATERFLOW POSSIBLE OVERPRESSURE IN DEEP DAKOTA	CASED HOLE LOGS	6-1/4"	4-1/2" 9.5# K-55 LTC @ 7494'	0.5	713 PSI BHT = 175 deg F	AIR/AIR MIST/GAS	10
	T.O. @ 7494'				TOC @ 3100'				
8	NOTE: PERMIT TO 7794'								

DATE 02/02/98

APPROVALS:

PREPARED BY: Ricky Joyce/Ted Kelly
DRILLING ENGINEER

RES. ENGINEER

PROD. ENGINEER

GEOLOGIST

DRILLING MGR.

10:30 AM

1090' FNL 980' FWL SEC 18, T27N, R7W
RIO ARriba COUNTY, NEW MEXICO

