

## DISTRICT I

P.O. Box 1980, Hobbs, NM 88241-1980

## DISTRICT II

811 South First St., Artesia, NM 88210-2835

## DISTRICT III

1000 Rio Brazos Rd. Aztec, NM 87410-1693

State of New Mexico  
Energy, Minerals and Natural Resources Department

## OIL CONSERVATION DIVISION

2040 S. Pacheco  
Santa Fe, New Mexico 87505-6429Form C-107-A  
New 3-12-96

## APPROVAL PROCESS :

☒ Administrative ☐ Hearing

## EXISTING WELLBORE

☐ YES ☒ NO

## APPLICATION FOR DOWNHOLE COMMINGLING

Burlington Resources Oil &amp; Gas Company

PO Box 4289, Farmington, NM 87499

Operator

Address

San Juan 27-4 Unit

38M

C 06-27N-04W

Rio Arriba

Lease

Well No.

Unit Ltr. - Sec - Twp - Rge

County

Spacing Unit Lease Types: (check 1 or more)

OGRID NO. 14538 Property Code 7452 API NO. 30-039-not assigned Federal , State (and/or) Fee

The following facts are submitted in support of downhole commingling:	Upper Zone	Intermediate Zone	Lower Zone
1. Pool Name and Pool Code	Blanco Mesaverde - 72319		Basin Dakota - 71599
2. Top and Bottom of Pay Section (Perforations)	will be supplied upon completion		will be supplied upon completion
3. Type of production (Oil or Gas)	gas		gas
4. Method of Production (Flowing or Artificial Lift)	flowing		flowing
5. Bottomhole Pressure Oil Zones - Artificial Lift: Estimated Current: Gas & Oil - Flowing: Measured Current All Gas Zones: Estimated or Measured Original	(Current) a. 603 psi (see attachment)  (Original) b. 1395 psi (see attachment)	a.  b.	a. 1268 psi (see attachment)  b. 3052 psi (see attachment)
6. Oil Gravity (API) or Gas BTU Content	BTU 1166		BTU 1076
7. Producing or Shut-In?	shut in		shut in
Production Marginal? (yes or no)	no		yes
* If Shut-In and oil/gas/water rates of last production  <small>Note: For new zones with no production history, applicant shall be required to attach production estimates and supporting data.</small>	Date: n/a Rates:	Date: Rates:	Date: n/a Rates:
* If Producing, give data and oil/gas/water of recent test (within 60 days)	Date: n/a Rates:	Date: Rates:	Date: n/a Rates:
8. Fixed Percentage Allocation Formula -% for each zone (total of %'s to equal 100%)	Oil: % Gas: % will be supplied upon completion	Oil: % Gas: %	Oil: % Gas: % will be supplied upon completion

9. If allocation formula is based upon something other than current or past production, or is based upon some other method, submit attachments with supporting data and/or explaining method and providing rate projections or other required data.

10. Are all working, overriding, and royalty interests identical in all commingled zones? ☐ Yes ☒ No  
If not, have all working, overriding, and royalty interests been notified by certified mail? ☒ Yes ☐ No  
Have all offset operators been given written notice of the proposed downhole commingling? ☒ Yes ☐ No

11. Will cross-flow occur? ☒ Yes ☐ No If yes, are fluids compatible, will the formations not be damaged, will any cross-flowed production be recovered, and will the allocation formula be reliable. ☒ Yes ☐ No (If No, attach explanation)

12. Are all produced fluids from all commingled zones compatible with each other? ☒ Yes ☐ No

13. Will the value of production be decreased by commingling? ☐ Yes ☒ No (If Yes, attach explanation)

14. If this well is on, or communitized with, state or federal lands, either the Commissioner of Public Lands or the United States Bureau of Land Management has been notified in writing of this application. ☒ Yes ☐ No

15. NMOCD Reference Cases for Rule 303(D) Exceptions: ORDER NO(S). \_\_\_\_\_

## 16. ATTACHMENTS:

- \* C-102 for each zone to be commingled showing its spacing unit and acreage dedication.
- \* Production curve for each zone for at least one year. (If not available, attach explanation.)
- \* For zones with no production history, estimated production rates and supporting data.
- \* Data to support allocation method or formula.
- \* Notification list of all offset operators.
- \* Notification list of working, overriding, and royalty interests for uncommon interest cases.
- \* Any additional statements, data, or documents required to support commingling.

I hereby certify that the information above is true and complete to the best of my knowledge and belief.

SIGNATURE Sean Woolverton TITLE: Reservoir Engineer DATE: 06-29-98

TYPE OR PRINT NAME Sean Woolverton TELEPHONE NO. ( 505 ) 326-9700

District I  
PO Box 1980, Hobbs, NM 88241-1980  
District II  
PO Drawer DD, Artesia, NM 88211-0719  
District III  
1000 Rio Hrazos Rd., Aztec, NM 87410  
District IV  
PO Box 2088, Santa Fe, NM 87504-2088

State of New Mexico  
Energy, Minerals & Natural Resources Department

OIL CONSERVATION DIVISION  
PO Box 2088  
Santa Fe, NM 87504-2088

Form C-1  
Revised February 21, 1998  
Instructions on back  
Submit to Appropriate District Office  
State Lease - 4 Copies  
Fee Lease - 3 Copies

☐ AMENDED REPORT

WELL LOCATION AND ACREAGE DEDICATION PLAT

1 API Number		2 Pool Code		3 Pool Name	
4 Property Code		5 Property Name <b>SAN JUAN 27-4 UNIT</b>			6 Well Number <b># 38M</b>
7 OGRID No.		8 Operator Name <b>BURLINGTON RESOURCES OIL &amp; GAS COMPANY</b>			9 Elevation <b>7341</b>

10 Surface Location

UL or lot no.	Section	Township	Range	Lot Idn	Feet from the	North/South line	Feet from the	East/West line	County
C	6	27 N	4 W		425	NORTH	1895	WEST	RIO ARRI

11 Bottom Hole Location If Different From Surface

UL or lot no.	Section	Township	Range	Lot Idn	Feet from the	North/South line	Feet from the	East/West line	County

12 Dedicated Acres 13 Joint or Infill 14 Consolidation Code 15 Order No.

NO ALLOWABLE WILL BE ASSIGNED TO THIS COMPLETION UNTIL ALL INTERESTS HAVE BEEN CONSOLIDATED  
OR A NON-STANDARD UNIT HAS BEEN APPROVED BY THE DIVISION

BLM Record	16				17 OPERATOR CERTIFICATION	
					I hereby certify that the information contained herein is true and complete to the best of my knowledge and belief.	
					Signature _____	
					Printed Name _____	
				Title _____		
				Date _____		
				18 SURVEYOR CERTIFICATION		
				I hereby certify that the well location shown on this plat was plotted from field notes of actual surveys made by me or under my supervision, and that the same is true and correct to the best of my belief.		
				February 16, 1998		
				Date of Survey		
				Signature and Seal of Professional Surveyor: _____		
				7016		
				Certificate Number		

San Juan 27-4 Unit #38M  
Expected Production Curve  
Blanco Mesaverde

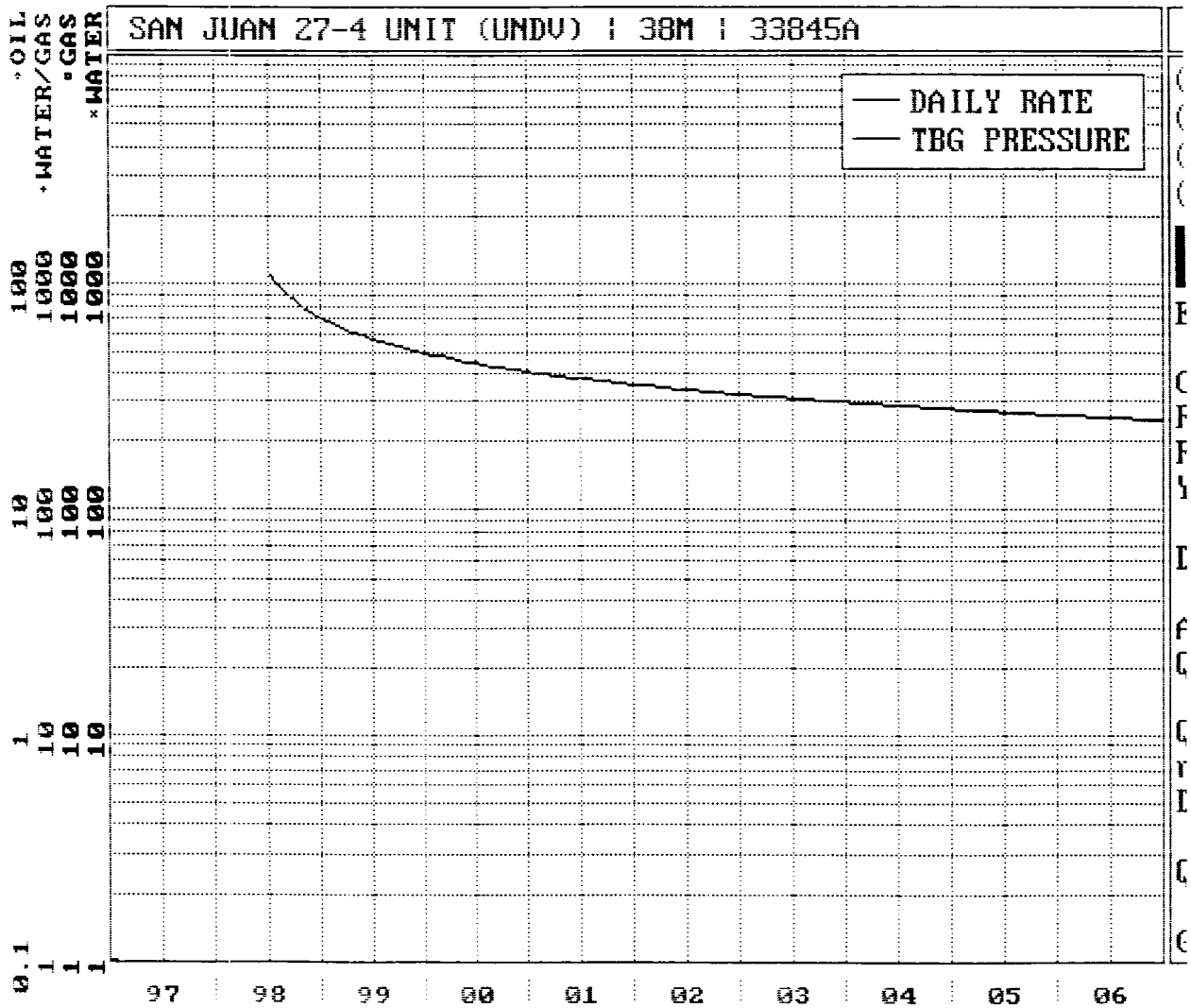

San Juan 27-4 Unit #38M  
Expected Production Curve  
Basin Dakota

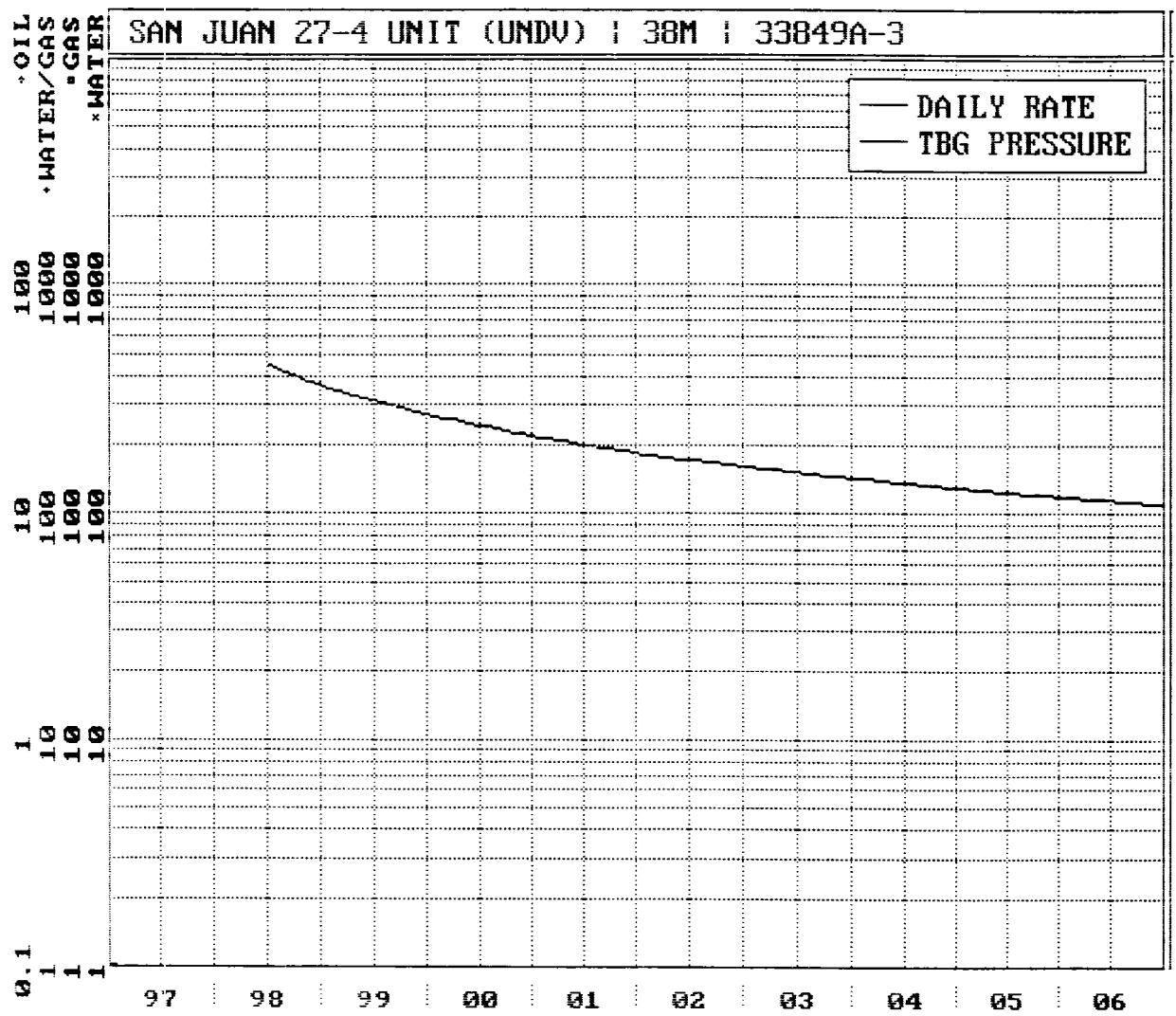

**SJ 27-4 Unit #38M**  
 Bottom Hole Pressures  
 Flowing and Static BHP  
 Cullender and Smith Method  
 Version 1.0 3/13/94

<b>Mesaverde</b>		<b>Dakota</b>	
<u><b>MV-Current</b></u>		<u><b>DK-Current</b></u>	
GAS GRAVITY	0.684	GAS GRAVITY	0.632
COND. OR MISC. (C/M)	C	COND. OR MISC. (C/M)	C
%N2	0.14	%N2	0.4
%CO2	1.03	%CO2	1.31
%H2S	0	%H2S	0
DIAMETER (IN)	2	DIAMETER (IN)	2.375
DEPTH (FT)	6347	DEPTH (FT)	8068
SURFACE TEMPERATURE (DEG F)	60	SURFACE TEMPERATURE (DEG F)	60
BOTTOMHOLE TEMPERATURE (DEG F)	137	BOTTOMHOLE TEMPERATURE (DEG F)	198
FLOWRATE (MCFPD)	0	FLOWRATE (MCFPD)	0
SURFACE PRESSURE (PSIA)	514	SURFACE PRESSURE (PSIA)	1053
BOTTOMHOLE PRESSURE (PSIA)	603.1	BOTTOMHOLE PRESSURE (PSIA)	1268.3
<u><b>MV-Original</b></u>		<u><b>DK-Original</b></u>	
GAS GRAVITY	0.684	GAS GRAVITY	0.632
COND. OR MISC. (C/M)	C	COND. OR MISC. (C/M)	C
%N2	0.14	%N2	0.4
%CO2	1.03	%CO2	1.31
%H2S	0	%H2S	0
DIAMETER (IN)	2	DIAMETER (IN)	2.375
DEPTH (FT)	6347	DEPTH (FT)	8068
SURFACE TEMPERATURE (DEG F)	60	SURFACE TEMPERATURE (DEG F)	60
BOTTOMHOLE TEMPERATURE (DEG F)	137	BOTTOMHOLE TEMPERATURE (DEG F)	198
FLOWRATE (MCFPD)	0	FLOWRATE (MCFPD)	0
SURFACE PRESSURE (PSIA)	1167	SURFACE PRESSURE (PSIA)	2509
BOTTOMHOLE PRESSURE (PSIA)	1395.2	BOTTOMHOLE PRESSURE (PSIA)	3052.1

Page No.: 1  
Print Time: Fri Jan 16 13:50:08 1998  
Property ID: 8440  
Property Name: SAN JUAN 27-4 UNIT | 15 | 52076A-1  
Table Name: K:\ARIES\RR98PDP\TEST.DBF

--DATE-- M SIWHP  
■■■■■■■■■■ ■■■■Psi■■■

San Juan 27-4 #38M  
Mesaverde Offset

07/09/58	1167.0	- original
08/26/58	1166.0	
06/14/59	697.0	
06/14/60	703.0	
06/13/61	671.0	
02/13/62	657.0	
06/01/63	560.0	
01/02/64	618.0	
07/29/65	581.0	
08/01/66	575.0	
08/04/67	613.0	
05/10/68	623.0	
06/09/70	579.0	
05/03/71	541.0	
05/30/72	535.0	
08/07/74	595.0	
04/13/81	570.0	
05/20/82	623.0	
10/21/86	684.0	
09/04/89	627.0	
03/18/91	621.0	
09/03/91	633.0	
05/31/93	514.0	- current

Page No.: 1  
Print Time: Fri Jan 16 13:49:56 1998  
Property ID: 1630  
Property Name: SAN JUAN 27-4 UNIT | 40 | 52231A-1  
Table Name: K:\ARIES\RR98PDP\TEST.DBF

--DATE-- M SIWHP  
■■■■■■■■■■ ■■■Psi■■■

09/20/68	2509.0	-original
05/29/69	1869.0	
06/09/70	1515.0	
05/03/71	1353.0	
05/30/72	1323.0	
05/16/73	1254.0	
06/23/75	1193.0	
07/06/77	1264.0	
06/06/85	1019.0	
09/29/93	1053.0	-current

San Juan 274 Unit # 38m

---

DL offset

San Juan 27-4 Unit = 38M  
Blanco Mesaverde/ Basin Dakota  
27N-4W-06D

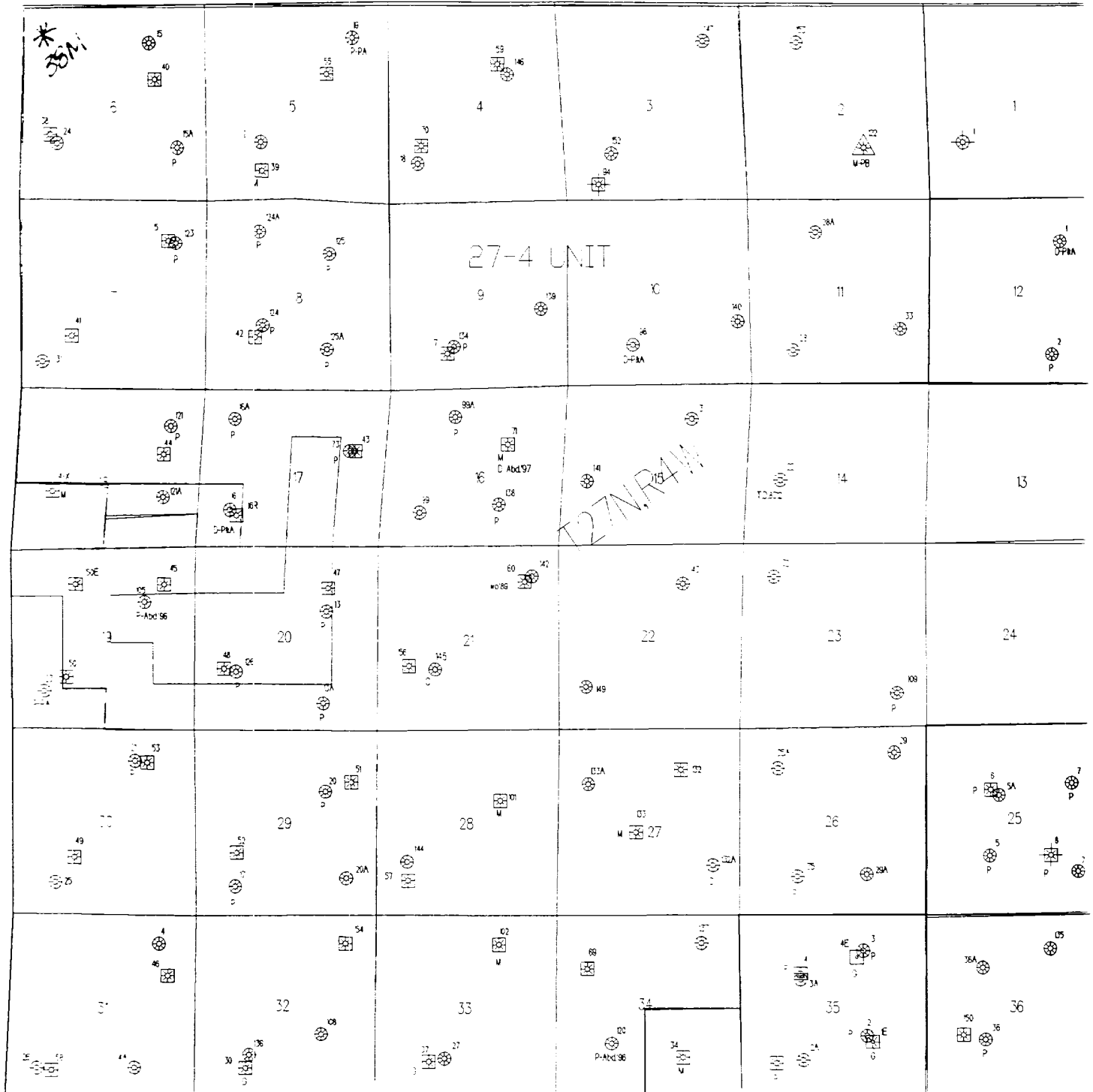



***BURLINGTON RESOURCES OIL AND GAS COMPANY***

**San Juan 27-4 Unit #38M**

**OFFSET OPERATOR/OWNER PLAT**

**Mesaverde / Dakota Formations Commingle Well**

**Township 27 North, Range 4 West**

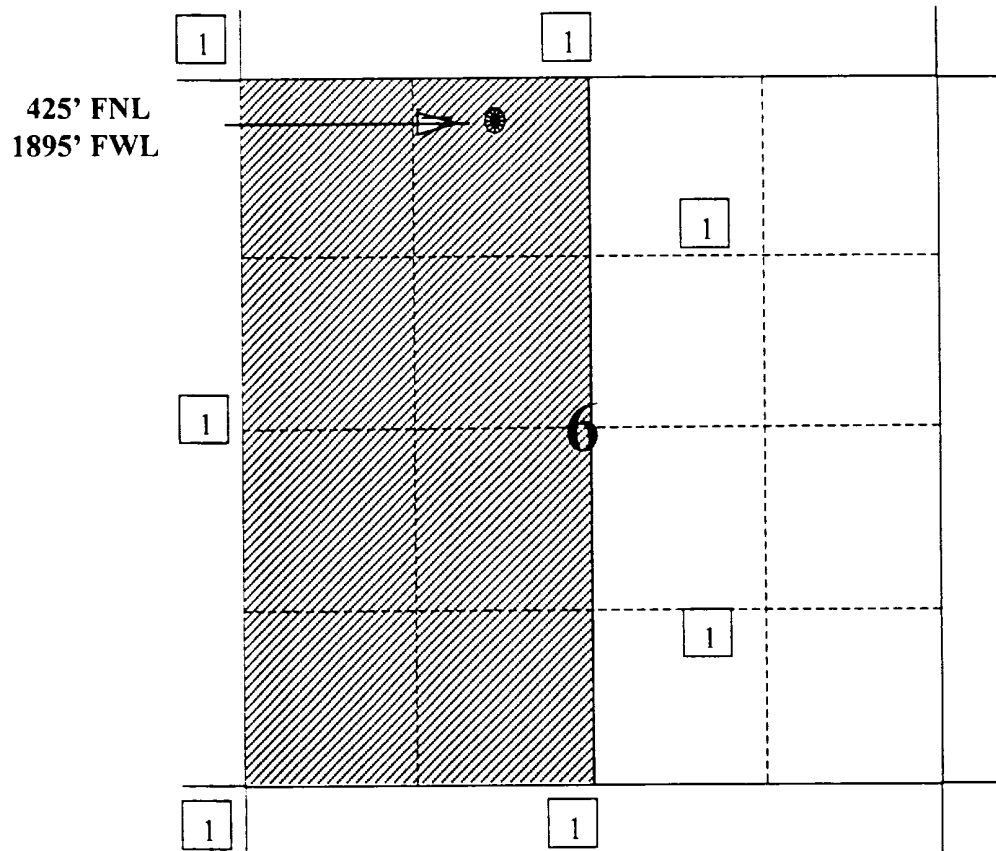

1) Burlington Resources