

UNITED STATES  
DEPARTMENT OF THE INTERIOR  
BUREAU OF LAND MANAGEMENT

APPLICATION FOR PERMIT TO DRILL OR DEEPEN

1. TYPE OF WORK DRILL <input checked="" type="checkbox"/> DEEPEN <input type="checkbox"/>		200 JUN -3 AM 9:33		5. LEASE DESIGNATION AND SERIAL NO. SF 080385
b. TYPE OF WELL OIL WELL <input type="checkbox"/> GAS WELL <input checked="" type="checkbox"/> OTHER <input type="checkbox"/> SINGLE ZONE <input type="checkbox"/> MULTIPLE ZONE <input checked="" type="checkbox"/>				6. IF INDIAN, ALLOTTEE OR TRIBE NAME
2. NAME OF OPERATOR 23710 Union Oil Company of California dba(Unocal)				7. UNIT AGREEMENT NAME 24862 Rincon Unit
3. ADDRESS AND TELEPHONE NO. P.O. Box 671, Midland TX.				8. FARM OR LEASE NAME, WELL NO. Rincon Unit 202M
4. LOCATION OF WELL (Report location clearly and in accordance with any State requirement) At surface 1980' FSL and 800' FB At proposed prod. zone Same as Surface				9. API WELL NO. 30-039-26468
14. DISTANCE IN MILES AND DIRECTION FROM NEAREST TOWN OR POST OFFICE 40 miles Southeast from Bloomfield NM.				10. FIELD AND POOL OR WILDCAT Basin Dakota/ Mesa Verde
15. DISTANCE FROM PROPOSED LOCATION TO NEAREST PROPERTY OR LEASE LINE FT (Also to nearest drg. Unit line, if any) 2640'	16. NO. OF ACRES IN LEASE 2645.09	17. NO. OF ACRES ASSIGNED TO THIS WELL 320 E/P		11. SEC., T., R., M., OR BLK AND SURVEY OR AREA I Sec. 27, T-27-N, R-7-W
18. DISTANCE FROM PROPOSED LOCATION TO NEAREST WELL, DRILLING, COMPLETED OR APPLIED FOR, ON THIS LEASE, FT 2640'	19. PROPOSED DEPTH 7631'	20. ROTARY OR CABLE TOOLS Rotary		12. COUNTY OR PARISH Rio Arriba
21. ELEVATIONS (Show whether DF, RT, GR, e) 6729' GR		22. APPROX DATE WORK WILL START July 15, 2000		13. STATE NM

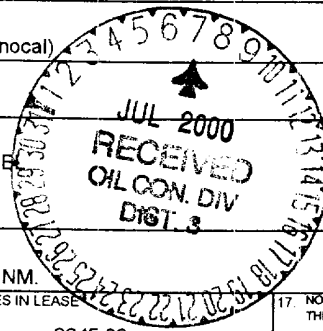

23. PROPOSED CASING AND CEMENTING PROGRAM				
SIZE OF HOLE	GRADE, SIZE OF CASING	WEIGHT PER FOOT	SETTING DEPTH	QUANTITY OF CEMENT
12-1/4"	H-40 9-5/8"	32.3#	350'	285 SACKS "B" TOC @ SURFACE
8-3/4"	K-55 7"	20#	2600'	300 SACKS TYPE III TOC @ SURFACE
6-1/4"	N-80 4-1/2"	11.6#	7631'	SACKS 65/35 POZ TYPE III TOC TIED INTO 7" CASI

This action is subject to technical and procedural review pursuant to 43 CFR 3165.3 and 43 CFR 3165.4. **"Expedited APD/ROW"**

DRILLING OPERATIONS AUTHORIZED ARE SUBJECT TO COMPLIANCE WITH ATTACHED "GENERAL REQUIREMENTS"

Unocal plans to drill the Rincon Unit 202M, and complete in the Mesa Verde and the Basin Dakota and downhole commingle the two formations.

BOP- One double gate BOP with 3-1/2" pipe and blind rams, one choke manifold with adjustable and positive chokes, an accumulator will hydraulically operate BOP with 1 1/2 times the necessary capacity to close the rams and retain a minimum of 200 psi above recharge. Rotating head will be utilized during the drilling of the 6-1/4" hole. (Schematics are attached)

We will have a fire suppression system in place, in the event that we have to flare while dust drilling the production hole.

IN ABOVE SPACE DESCRIBED PROGRAM If proposal is to deepen, give data on present productive zone and proposed new productive zone. If proposal is to drill or deepen directionally, give pertinent data on subsurface locations and measured and true vertical depths. Give blowout preventer program, if any

SIGNED Mike C. Phillips TITLE PERMIAN ROCKY MOUNTAIN DRILLING FOREMAN DATE 05/31/00  
MIKE C. PHILLIPS

(This space for Federal or State office use)

PERMIT NO. \_\_\_\_\_ APPROVAL DATE 7/3/00

Application approval does not warrant or certify that the applicant holds legal or equitable title to those rights in the subject lease which would entitle the application to conduct operations thereon  
CONDITIONS OF APPROVAL, IF ANY

APPROVED BY \_\_\_\_\_ TITLE \_\_\_\_\_ DATE 7/3/00

\*See Instructions On Reverse Side

Title 18 U.S.C. Section 1001, make it a crime for any person knowingly and willfully to make to any department or agency of the United States any false, fictitious or fraudulent statements or representations as to any matter within its jurisdiction.

*Signature*

NMOC

✓

Revised February 21, 1964

Instructions on back

Submit to Appropriate District Office

State Lease - 4 Copies:

Fee Lease - 3 Copies

☐ AMENDED REPORT

OIL CONSERVATION DIVISION  
PO Box 2088  
Santa Fe, NM 87504-2088

2001 JUN -3 AM 9:33

LOCATION PLATE, INM

## WELL LOCATION AND ACREAGE DEDICATION PLAT

' API Number 30039-26468		' Pool Code 71599 -	' Pool Name Basin, Dakota E 1/2 -
' Property Code 001510	' Property Name RINCON UNIT		' Well Number 202M
' OGRID No. 023710	' Operator Name UNION OIL COMPANY OF CALIFORNIA		' Elevation 6729 -

<sup>10</sup> Surface Location



UL or lot no.	Section	Township	Range	Lot Idn	Feet from the	North/South line	Feet from the	East/West line	County
I	27	27 N	7 W		1980	South	800	East	Rio Arriba

## 11 Bottom Hole Location If Different From Surface

UL or lot no.	Section	Township	Range	Lot Ida	Feet from the	North/South line	Feet from the	East/West line	County
---------------	---------	----------	-------	---------	---------------	------------------	---------------	----------------	--------

12 Dedicated Acres 320 <i>6/2</i>	13 Joint or Infill	14 Consolidation Code	15 Order No.
--------------------------------------	--------------------	-----------------------	--------------

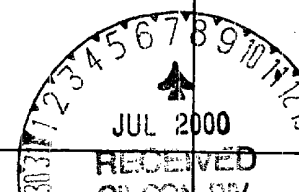
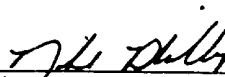
NO ALLOWABLE WILL BE ASSIGNED TO THIS COMPLETION UNTIL ALL INTERESTS HAVE BEEN CONSOLIDATED  
OR A NON-STANDARD UNIT HAS BEEN APPROVED BY THE DIVISION

<div style="display: flex; justify-content: space-between;"> <span>16</span> <span>S87°23'W</span> </div> <div style="display: flex; justify-content: space-between; margin-top: 100px;"> <span>B1.51cm.</span> <span>80.14cm.</span> <span>Fd.</span> </div> <div style="text-align: center; margin-top: 20px;">  </div> <div style="display: flex; justify-content: space-between; margin-top: 100px;"> <span></span> <span>84.00cm.</span> </div>	<div style="display: flex; justify-content: space-between;"> <span></span> <span>17 OPERATOR CERTIFICATION</span> </div> <p style="font-size: small;">I hereby certify that the information contained herein is true and complete to the best of my knowledge and belief</p> <div style="margin-top: 20px;">  </div> <div style="display: flex; justify-content: space-between;"> <span>Signature</span> <span>Mike Phillips</span> </div> <div style="display: flex; justify-content: space-between;"> <span>Printed Name</span> <span>Rky Mtn/Permian Basin Drlg Foreman</span> </div> <div style="display: flex; justify-content: space-between;"> <span>Title</span> <span></span> </div> <div style="display: flex; justify-content: space-between;"> <span>Date</span> <span>3/2/2000</span> </div>	<div style="display: flex; justify-content: space-between;"> <span></span> <span>18 SURVEYOR CERTIFICATION</span> </div> <p style="font-size: small;">I hereby certify that the well location shown on this plat was plotted from field notes of actual surveys made by me or under my supervision, and that the same is true and correct to the best of my belief.</p> <div style="margin-top: 20px;">  </div> <div style="display: flex; justify-content: space-between;"> <span>Date of Survey</span> <span>Feb. 2000</span> </div> <div style="display: flex; justify-content: space-between;"> <span>Signature and Seal of Professional Surveyor</span> <span></span> </div> <div style="display: flex; justify-content: space-between; margin-top: 20px;"> <span>William S. Mahke II</span> <span></span> </div> <div style="display: flex; justify-content: space-between;"> <span>Certificate Number</span> <span>8466</span> </div>
<div style="display: flex; justify-content: space-between;"> <span></span> <span>S89°10'W</span> </div> <div style="display: flex; justify-content: space-between; margin-top: 100px;"> <span>N0°19'E</span> <span>79.93cm.</span> <span>Fd.</span> </div>	<div style="display: flex; justify-content: space-between;"> <span>27</span> <span></span> </div> <div style="display: flex; justify-content: space-between; margin-top: 100px;"> <span>800'</span> <span>1980'</span> </div> <div style="text-align: center; margin-top: 20px;">  </div>	<div style="display: flex; justify-content: space-between;"> <span></span> <span></span> </div> <div style="display: flex; justify-content: space-between; margin-top: 100px;"> <span>N0°21'E</span> <span></span> </div>

District I  
PO Box 1980, Hobbs, NM 88241-1980  
District II  
PO Drawer DD, Artesia, NM 88211-0719  
District III  
1000 Rio Brazos Rd., Aztec, NM 87410  
District IV  
PO Box 2088, Santa Fe, NM 87504-2088

State of New Mexico  
Energy, Minerals & Natural Resources Department

OIL CONSERVATION DIVISION  
PO Box 2088  
Santa Fe, NM 87504-2088

Form C-102  
Revised February 21, 1994  
Instructions on back  
Submit to Appropriate District Office  
State Lease - 4 Copies  
Fee Lease - 3 Copies

200 JUN -8 AM 9:23

AMENDED REPORT

WELL LOCATION AND ACREAGE DEDICATION PLAT, NM

<sup>1</sup> API Number 30039-26468	<sup>2</sup> Pool Code 72319 -	<sup>3</sup> Pool Name Blanco Mesa Verde E 1/2 -
<sup>4</sup> Property Code 011510	<sup>5</sup> Property Name RINCON UNIT	<sup>6</sup> Well Number 202M
<sup>7</sup> OGRID No. 023710	<sup>8</sup> Operator Name UNION OIL COMPANY OF CALIFORNIA	<sup>9</sup> Elevation 6729 -

<sup>10</sup> Surface Location

UL or lot no.	Section	Township	Range	Lot Idn	Feet from the	North/South line	Feet from the	East/West line	County
I	27	27 N	7 W		1980	South	800	East	Rio Arriba

<sup>11</sup> Bottom Hole Location If Different From Surface

UL or lot no.	Section	Township	Range	Lot Idn	Feet from the	North/South line	Feet from the	East/West line	County

<sup>12</sup> Dedicated Acres 320 E	<sup>13</sup> Joint or Infill	<sup>14</sup> Consolidation Code	<sup>15</sup> Order No.
--	-------------------------------	----------------------------------	-------------------------

NO ALLOWABLE WILL BE ASSIGNED TO THIS COMPLETION UNTIL ALL INTERESTS HAVE BEEN CONSOLIDATED  
OR A NON-STANDARD UNIT HAS BEEN APPROVED BY THE DIVISION

<div><p>16</p><p>587°23'W</p><p>80.14cm. Fd.</p><p>202</p><p>84.00cm.</p><p>Unit Boundaries</p><p>SEC.</p><p>27</p><p>54°08'38.5</p><p>70°19'E</p><p>800'</p><p>1980'</p><p>79.93cm. Fd.</p><p>589°10'W</p></div>	<div><p><sup>17</sup> OPERATOR CERTIFICATION</p><p>I hereby certify that the information contained herein is true and complete to the best of my knowledge and belief</p><p><i>Mike Phillips</i></p><p>Signature</p><p>Mike Phillips</p><p>Printed Name</p><p>Rky Mtn/Perm Basin Drilling Foreman</p><p>Title</p><p>3/2/2000</p><p>Date</p></div>
	<div><p><sup>18</sup> SURVEYOR CERTIFICATION</p><p>I hereby certify that the well location shown on this plat was plotted from field notes of actual surveys made by me or under my supervision, and that the same is true and correct to the best of my belief.</p><p>20 Feb 2000</p><p>Date of Survey</p><p><i>William H. Mahoke II</i></p><p>Signature</p><p>NEW MEXICO</p><p>REGISTERED PROFESSIONAL SURVEYOR</p><p>#8466</p><p>William H. Mahoke II</p><p>Certificate Number 8466</p></div>

UNION OIL COMPANY OF CALIFORNIA  
RINCON UNIT WELLS  
RINCON FIELD  
RIO ARriba COUNTY, NEW MEXICO

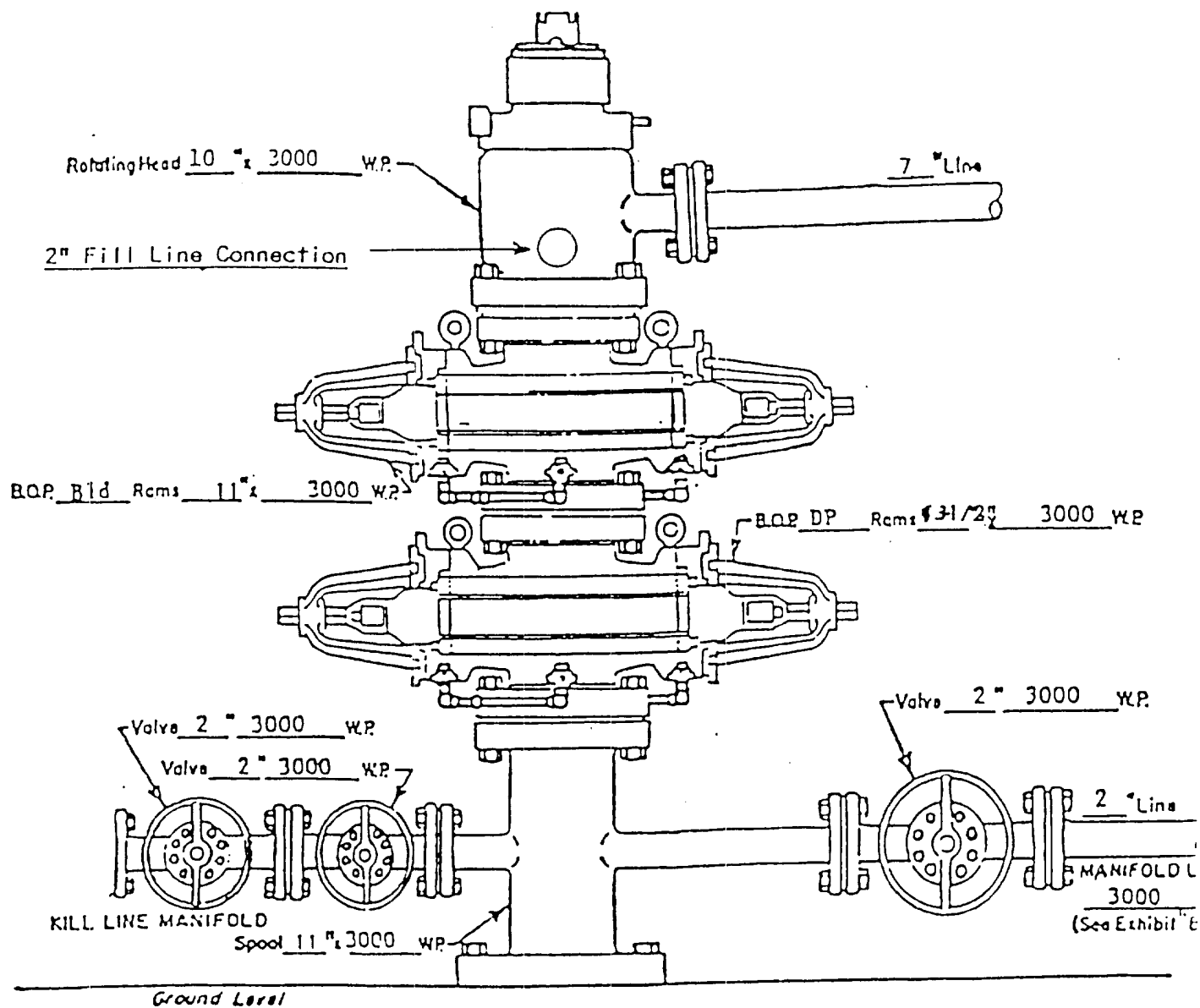

WELL HEAD B.O.P.  
3000 #W.P.

☐ Manual  
☒ Hydraulic

NOTE: Although 3000 psi BOP equipment will be used, equipment determination and line sizing are based on the requirements for 2000 psi BOP equipment due to the known drilling and reservoir conditions.

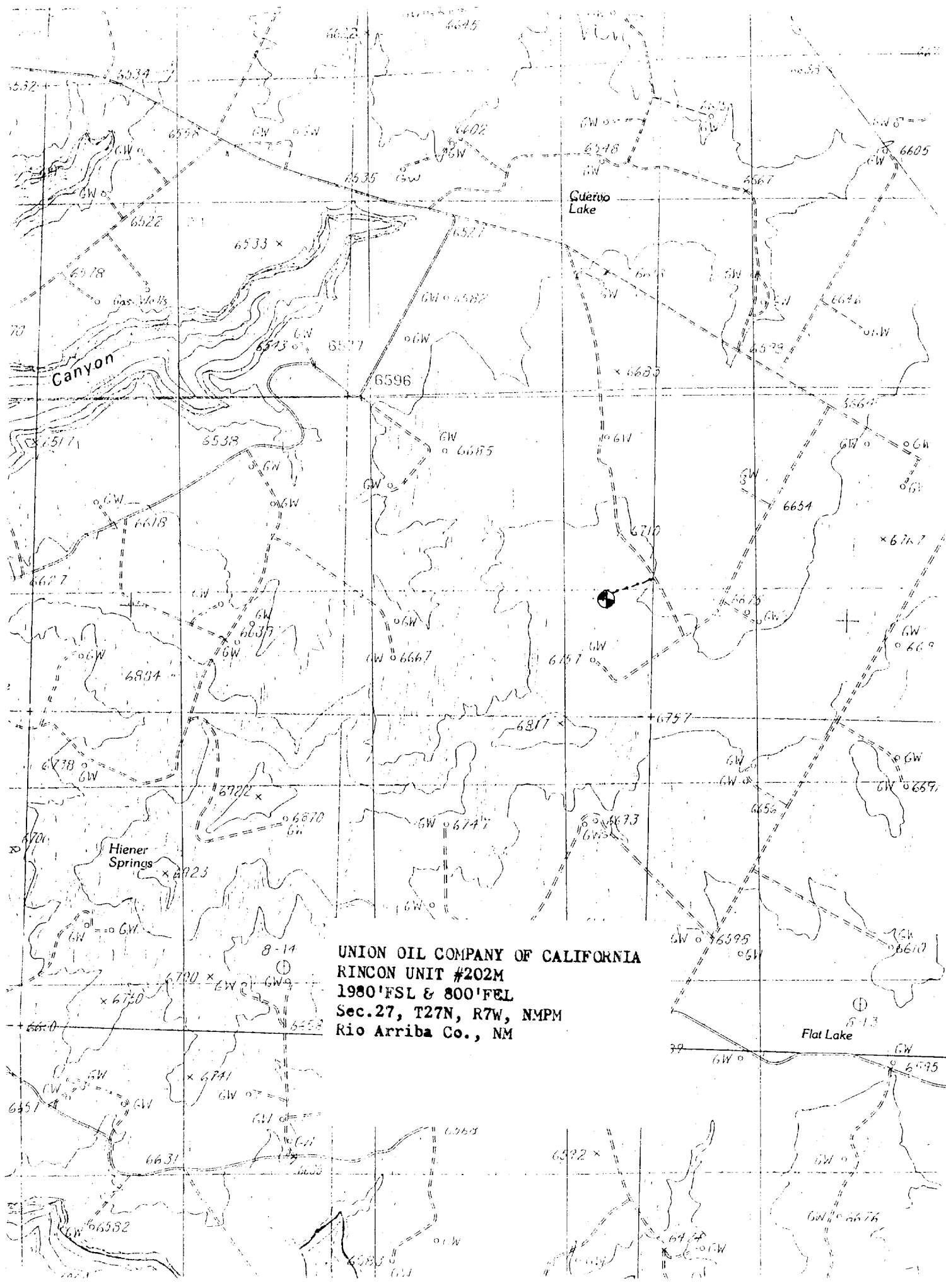

UNION OIL COMPANY OF CALIFORNIA  
RINCON UNIT #202M  
1980'FSL & 800'FEL  
Sec.27, T27N, R7W, NMPM  
Rio Arriba Co., NM