

(SUBMIT IN TRIPLICATE)

UNITED STATES
DEPARTMENT OF THE INTERIOR
GEOLOGICAL SURVEY

Land Office New Mexico
Lease No. 013654
Unit Rincon Unit

RECEIVED

FEB 4 1958

SUNDRY NOTICES AND REPORTS ON WELLS

NOTICE OF INTENTION TO DRILL.....	<input checked="" type="checkbox"/>	SUBSEQUENT REPORT OF WATER SHUT-OFF.....	
NOTICE OF INTENTION TO CHANGE PLANS.....		SUBSEQUENT REPORT OF SHOOTING OR ACIDIZING.....	
NOTICE OF INTENTION TO TEST WATER SHUT-OFF.....		SUBSEQUENT REPORT OF ALTERING CASING.....	
NOTICE OF INTENTION TO RE-DRILL OR REPAIR WELL.....		SUBSEQUENT REPORT OF RE-DRILLING OR REPAIR.....	
NOTICE OF INTENTION TO SHOOT OR ACIDIZE.....		SUBSEQUENT REPORT OF ABANDONMENT.....	
NOTICE OF INTENTION TO PULL OR ALTER CASING.....		SUPPLEMENTARY WELL HISTORY.....	
NOTICE OF INTENTION TO ABANDON WELL.....			

(INDICATE ABOVE BY CHECK MARK NATURE OF REPORT, NOTICE, OR OTHER DATA)

February 4, 1958

Well No. 105 is located 1650 ft. from SW line and 990 ft. from E line of sec. 17

SE Sec. 17 (1/4 Sec. and Sec. No.) 27N (Twp.) 6W (Range) N.M.P.M. (Meridian)

South Blanco (Field) Rio Arriba (County or Subdivision) New Mexico (State or Territory)

The elevation of the derrick floor above sea level is 6601 ft.

DETAILS OF WORK

(State names of and expected depths to objective sands; show sizes, weights, and lengths of proposed casings; indicate mudding jobs, cementing points, and all other important proposed work)

It is intended to drill a well thru the Pictured Cliff formation using rotary tools and to perforate and water fracture possible producing zones. Estimated Total Depth 3326'.

Casing Program:

8 5/8" at 120' with 125 sacks regular cement circulated to surface.
5 1/2" at 3326' with 75 sacks regular cement, 75 sacks cement.

The SE/4 of Section 17 is dedicated to this well.

SE/4: NE 013654 (NESE/4); SW 019052 (W/2SE/4, SESE/4)

I understand that this plan of work must receive approval in writing by the Geological Survey before operations may be commenced

Company El Paso Natural Gas Company

Address Box 997

Farmington, New Mexico

Original Signed D. C. Johnston

By

Title Petroleum Engineer

NEW MEXICO OIL CONSERVATION COMMISSION

Well Location and Acreage Dedication Plat

Section A.

Date **JANUARY 31, 1958**

Operator **EL PASO NATURAL GAS COMPANY** Lease **RINCON UNIT** NM **013654**
 Well No. **105** Unit Letter **I** Section **17** Township **27 N** Range **6 W** NMPM
 Located **1650** Feet From **SOUTH** Line **990** Feet From **EAST** Line
 County **RIO ARRIBA** G. L. Elevation **6611** Dedicated Acreage **160** Acres
 Name of Producing Formation **PICTURED CLIFF** Part **SO. BLANCO P.C.**

1. Is the Operator the only owner in the dedicated acreage outlined on the plat below?
 Yes ☒ No ☐
2. If the answer to question one is "no", have the interests of all the owners been consolidated by communitization agreement or otherwise? Yes ☐ No ☐ If answer is "yes", Type of Consolidation.
3. If the answer to question two is "no", list all the owners and their respective interests below:

Owner

Description



RECEIVED
FEB 4 1958
 U. S. GEOLOGICAL SURVEY
 FARMINGTON, NEW MEXICO

Section B.

Note: All distances must be from outer boundaries of section.

This is to certify that the information in Section A above is true and complete to the best of my knowledge and belief.

El Paso Natural Gas Company
 (Operator)
Original Signed D. C. Johnston
 (Representative)
Box 997
 (Address)
Farmington, New Mexico

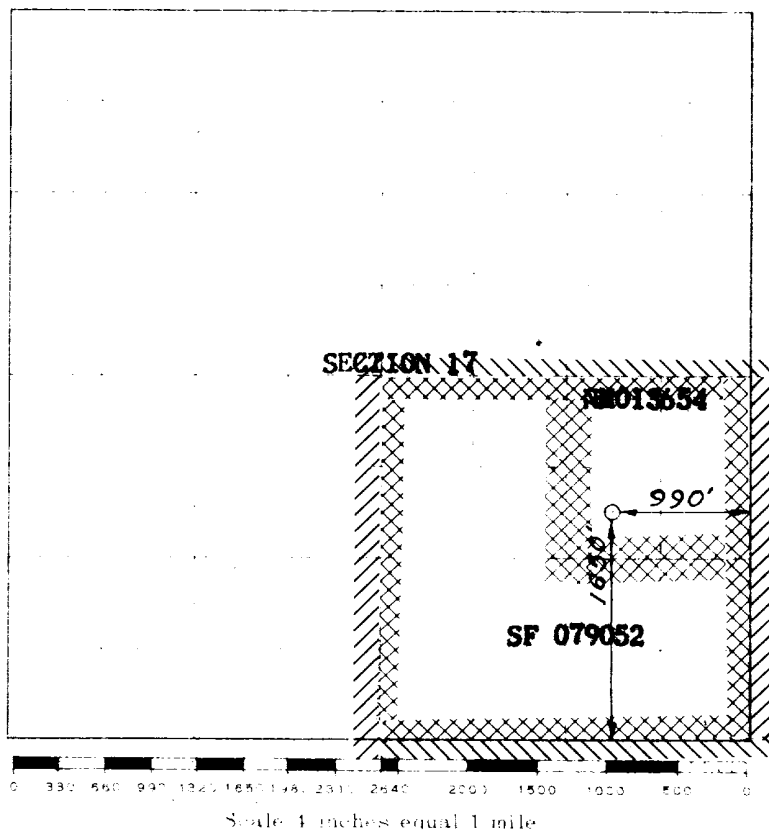

Scale 1 inch equal 1 mile

This is to certify that the above plat was prepared from field notes of actual surveys made by me or under my supervision and that the same are true and correct to the best of my knowledge and belief.

(Seal)

Date Surveyed

OCTOBER 25, 1957

Farmington, New Mexico

David O. Wilson
 Registered Professional Engineer and/or Land Surveyor