



COPY TO D.C.C.

IN REPLY REFER TO:

UNITED STATES
DEPARTMENT OF THE INTERIOR
GEOLOGICAL SURVEY
P. O. Box 965
Farmington, New Mexico

June 20, 1956

El Paso Natural Gas Company
Box 997
Farmington, New Mexico

Re: Santa Fe 080213

Gentlemen:

Receipt is acknowledged of your "Notice of Intention to Drill" dated June 18, 1956 covering your well No. 75 Rincon Unit in NW 1/4 sec. 34, T. 27 N., R. 7 W., N. M. P. M., Rio Arriba County, New Mexico, Se. Blanco pool.

Your proposed work is hereby approved subject to compliance with the provisions of the "Oil and Gas Operating Regulations" revised May 25, 1942, a copy of which will be sent to you on request, and subject to the following conditions:

1. Drilling operations so authorized are subject to the attached sheet for general conditions of approval.
2. Furnish copies of all logs.

Very truly yours,

(Orig. Sgd.) P. T. McGrath

P. T. McGrath
District Engineer

PTMcGrath:ac



UNITED STATES
DEPARTMENT OF THE INTERIOR
GEOLOGICAL SURVEY



1914

TO THE DIRECTOR, GEOLOGICAL SURVEY, WASHINGTON, D. C.

FROM THE CHIEF OF THE DISTRICT OF COLUMBIA, WASHINGTON, D. C.

SUBJECT: [Illegible]

[Illegible]

[Illegible]

[Illegible]

[Illegible]

[Illegible]



(SUBMIT IN TRIPLICATE)

UNITED STATES
DEPARTMENT OF THE INTERIOR
GEOLOGICAL SURVEY

Land Office Las Alamos
Lease No. 183213
Unit Mineral Unit

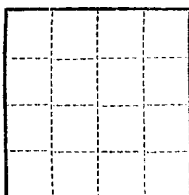

SUNDRY NOTICES AND REPORTS ON WELLS

NOTICE OF INTENTION TO DRILL.....	<input checked="" type="checkbox"/>	SUBSEQUENT REPORT OF WATER SHUT-OFF.....	
NOTICE OF INTENTION TO CHANGE PLANS.....		SUBSEQUENT REPORT OF SHOOTING OR ACIDIZING.....	
NOTICE OF INTENTION TO TEST WATER SHUT-OFF.....		SUBSEQUENT REPORT OF ALTERING CASING.....	
NOTICE OF INTENTION TO RE-DRILL OR REPAIR WELL.....		SUBSEQUENT REPORT OF RE-DRILLING OR REPAIR.....	
NOTICE OF INTENTION TO SHOOT OR ACIDIZE.....		SUBSEQUENT REPORT OF ABANDONMENT.....	
NOTICE OF INTENTION TO PULL OR ALTER CASING.....		SUPPLEMENTARY WELL HISTORY.....	
NOTICE OF INTENTION TO ABANDON WELL.....			

(INDICATE ABOVE BY CHECK MARK NATURE OF REPORT, NOTICE, OR OTHER DATA)

June 18, 1950

Well No. 75 is located 1850 ft. from N line and 1850 ft. from W line of sec. 34
34 section 34 R7N T7N R7N
 (1/4 Sec. and Sec. No.) (Twp.) (Range) (Meridian)
Blanco San Arriba New Mexico
 (Field) (County or Subdivision) (State or Territory)

The elevation of the derrick floor above sea level is 6754 ft.

DETAILS OF WORK

(State names of and expected depths to objective sands; show sizes, weights, and lengths of proposed casings; indicate mudding jobs, cementing points, and all other important proposed work)

It is intended to drill a well thru the Pictured Cliff formation using rotary tools and to perforate and water fracture possible producing zones. Estimated T.D. 3135'.

Casing Program:

9 5/8" at 120' with 125 sacks regular cement circulated to surface.
5 1/2" at 3135' with 75 sacks regular cement, 75 sacks iron.

The NW/4 of Section 34 is dedicated to this well.
NW/4, 183213.

I understand that this plan of work must receive approval in writing by the Geological Survey before operations may be commenced.

Company El Paso Natural Gas Company

Address Box 947
Farmington, New Mexico

By [Signature]
Title Petroleum Engineer



2011年11月11日

1. 11月11日，星期一，晴。
2. 11月12日，星期二，晴。
3. 11月13日，星期三，晴。
4. 11月14日，星期四，晴。
5. 11月15日，星期五，晴。
6. 11月16日，星期六，晴。
7. 11月17日，星期日，晴。

8. 11月18日，星期一，晴。
9. 11月19日，星期二，晴。
10. 11月20日，星期三，晴。
11. 11月21日，星期四，晴。
12. 11月22日，星期五，晴。
13. 11月23日，星期六，晴。
14. 11月24日，星期日，晴。

15. 11月25日，星期一，晴。
16. 11月26日，星期二，晴。
17. 11月27日，星期三，晴。
18. 11月28日，星期四，晴。
19. 11月29日，星期五，晴。
20. 11月30日，星期六，晴。

2011年11月31日

NEW MEXICO
OIL CONSERVATION COMMISSION

WELL LOCATION AND/OR GAS PRODRATION PLAT

DATE APRIL 24, 1956

BY EL PASO NATURAL GAS COMPANY RINCON UNIT SF 080213

SECTION 75 34 27-N 7-W

1850 NORTH 1850 WEST

RIO ARriba 6746

PICTURED CLIFF SO. BLANCO 160
(1882 PLAT)

Note: All dimensions are from outer boundaries of section.

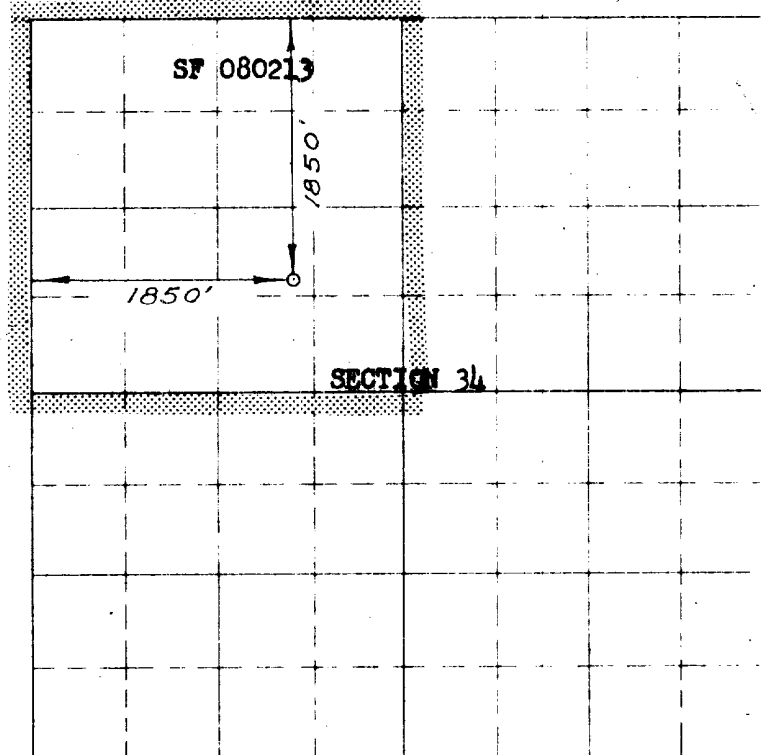

Scale: 4 inches equal 1 mile

This is to certify that the above plat was prepared from field notes of actual surveys made by me or under my supervision and that the same are true and correct to the best of my knowledge and belief.

Date Surveyed APRIL 17, 1956

C. O. Walker
Registered Professional Engineer and Land Surveyor

(Seal)

Farmington, New Mexico

NOTE

This section of form is to be used for gas wells only



1. Is this well a Dual Comp.
Yes _____ No _____
2. If the answer to Question 1 is yes, are there any other dually completed wells within the dedicated acreage.
Yes _____ No _____

Name Well Walker
Position Petroleum Engineer
Representing El Paso Natural Gas Co.
Address Box 997, Farmington, N.M.

