

UNITED STATES  
DEPARTMENT OF THE INTERIOR  
GEOLOGICAL SURVEY

## APPLICATION FOR PERMIT TO DRILL, DEEPEN, OR PLUG BACK

## 1a. TYPE OF WORK

DRILL ☒DEEPEN ☐PLUG BACK ☐

## b. TYPE OF WELL

OIL  
WELL ☐GAS  
WELL ☒

OTHER

SINGLE  
ZONE ☒MULTIPLE  
ZONE ☐

## 2. NAME OF OPERATOR

PAN AMERICAN PETROLEUM CORPORATION

## 3. ADDRESS OF OPERATOR

P. O. Box 480, Farmington, New Mexico

## 4. LOCATION OF WELL (Report location clearly and in accordance with any State requirements.\*)

At surface 1750 FWL and 1480 FWL

At proposed prod. zone Same

## 14. DISTANCE IN MILES AND DIRECTION FROM NEAREST TOWN OR POST OFFICE\*

44 miles southeast of Blanco, New Mexico

## 15. DISTANCE FROM PROPOSED\*

LOCATION TO NEAREST  
PROPERTY OR LEASE LINE, FT.  
(Also to nearest drilg. unit line, if any)

890'

## 18. DISTANCE FROM PROPOSED LOCATION\*

TO NEAREST WELL, DRILLING, COMPLETED,  
OR APPLIED FOR, ON THIS LEASE, FT.

None

## 16. NO. OF ACRES IN LEASE

320

## 19. PROPOSED DEPTH

7900

17. NO. OF ACRES ASSIGNED  
TO THIS WELL

320

## 20. ROTARY OR CABLE TOOLS

Rotary

## 21. ELEVATIONS (Show whether DF, RT, GR, etc.)

Report Later

## 22. APPROX. DATE WORK WILL START\*

November 20, 1964

## 23.

## PROPOSED CASING AND CEMENTING PROGRAM

SIZE OF HOLE	SIZE OF CASING	WEIGHT PER FOOT	SETTING DEPTH	QUANTITY OF CEMENT
13-3/4"	10-3/4"	32.75#	350	200 Sacks (Circulate)
9-7/8"	7-5/8"	26.4#	3600	1000 Sacks (Circulate)
6-3/4"	4-1/2"	10.5#	7900	450 Sacks (Two-Stage Cementing Tool at Base of Mesaverde)

Completion will be as indicated upon reaching total depth.  
Copies of location plat are attached.  
Copies of any logs run will be furnished upon completion of well.

Verbally approved November 18, 1964, R. C. Baier to F. H. Hollingsworth.

RECEIVED

NOV 23 1964

U. S. GEOLOGICAL SURVEY  
FARMINGTON, N. M.

IN ABOVE SPACE DESCRIBE PROPOSED PROGRAM: If proposal is to deepen or plug back, give data on present productive zone and proposed new productive zone. If proposal is to drill or deepen directionally, give pertinent data on subsurface locations and measured and true vertical depths. Give blowout preventer program, if any.

## 24. Fred L. Nabors, District Engineer

ORIGINAL SIGNED BY  
F. H. HOLLINGSWORTH

SIGNED

TITLE

DATE November 18, 1964

(This space for Federal or State office use)

PERMIT NO.

APPROVAL DATE

APPROVED BY

TITLE

CONDITIONS OF APPROVAL, IF ANY:

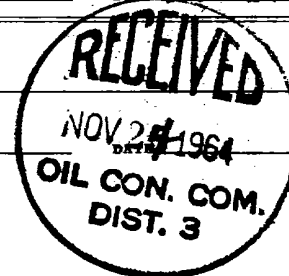

\*See Instructions On Reverse Side

## NEW MEXICO OIL CONSERVATION COMMISSION

Well Location and Acreage Dedication Plat

Section A.

Date NOVEMBER 18, 1964

Operator PAN AMERICAN PETROLEUM CORPORATION Lease SAN JUAN 27-5 UNIT  
 Well No. 96 Unit Letter F Section 15 Township 27 NORTH Range 5 WEST NMPM  
 Located 1750 Feet From NORTH Line, 1480 Feet From WEST Line  
 County RIO ARriba G. L. Elevation REPORT LATER Dedicated Acreage 320 Acres  
 Name of Producing Formation DAKOTA Pool BASIN DAKOTA

1. Is the Operator the only owner in the dedicated acreage outlined on the plat below?

Yes X No \_\_\_\_\_

2. If the answer to question one is "no", have the interests of all the owners been consolidated by communitization agreement or otherwise? Yes \_\_\_\_\_ No \_\_\_\_\_. If answer is "yes", Type of Consolidation.

3. If the answer to question two is "no", list all the owners and their respective interests below:

OwnerLand Description

Section B.

This is to certify that the information  
 in Section A above is true and complete  
 to the best of my knowledge and belief.

PAN AMERICAN PETROLEUM CORP.F. H. Hollingsworth (Operator)F. H. Hollingsworth  
(Representative)P. O. Box 480

(Address)

Farmington, New Mexico

Note: All distances must be from our standard of section.

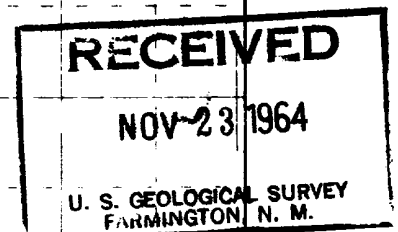
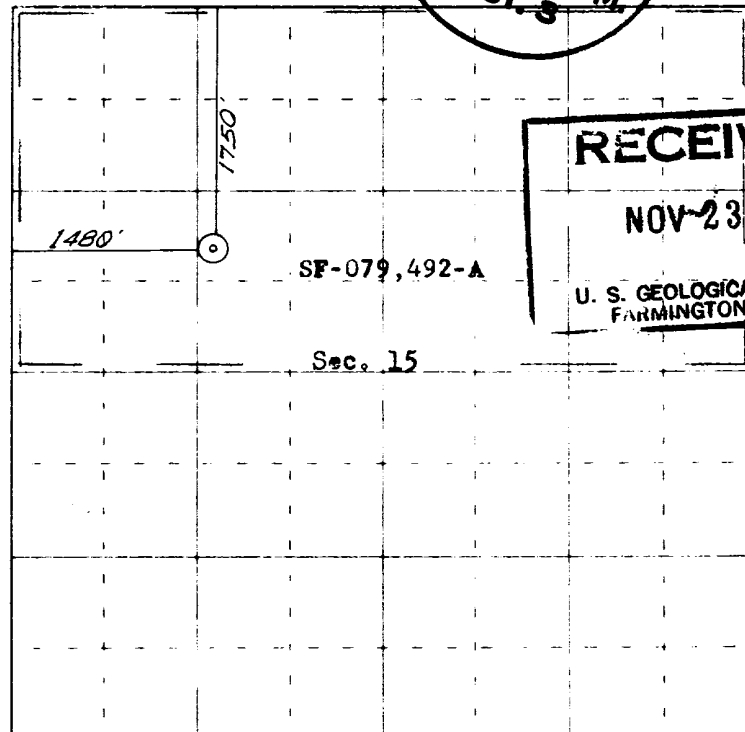

Ref: GLO plat dated 8 February 1884



(Seal)

Farmington, New Mexico

Date Surveyed November 14, 1964

James P. Lease  
 Registered Professional Engineer and or Land Surveyor  
 James P. Lease, N. Mex. Reg. No. 1463  
 San Juan Engineering Company