

(SUBMIT IN TRIPLICATE)

UNITED STATES
DEPARTMENT OF THE INTERIOR
GEOLOGICAL SURVEY

Budget Bureau No. 47-R158.4.
Form Approved.

Land Office Santa Fe
Lease No. 079394
Unit San Juan 27-5 Unit
14-08-001-950

SUNDRY NOTICES AND REPORTS ON WELLS

NOTICE OF INTENTION TO DRILL	<input checked="" type="checkbox"/>	SUBSEQUENT REPORT OF WATER SHUT-OFF
NOTICE OF INTENTION TO CHANGE PLANS		SUBSEQUENT REPORT OF SHOOTING OR ACIDIZING
NOTICE OF INTENTION TO TEST WATER SHUT-OFF		SUBSEQUENT REPORT OF ALTERING CASING
NOTICE OF INTENTION TO RE-DRILL OR REPAIR WELL		SUBSEQUENT REPORT OF RE-DRILLING OR REPAIR
NOTICE OF INTENTION TO SHOOT OR ACIDIZE		SUBSEQUENT REPORT OF ABANDONMENT
NOTICE OF INTENTION TO PULL OR ALTER CASING		SUPPLEMENTARY WELL HISTORY
NOTICE OF INTENTION TO ABANDON WELL		

RECEIVED
AUG 13 1962
U. S. GEOLOGICAL SURVEY
FARMINGTON, NEW MEXICO

(INDICATE ABOVE BY CHECK MARK NATURE OF REPORT, NOTICE, OR OTHER DATA)

August 13, 1962

Well No. 71(PM) is located 1190 ft. from (N) line and 797 ft. from (E) line of sec. 28

NE/4 Sec. 28
(1/4 Sec. and Sec. No.)

27N
(Twp.)

5W
(Range)

N.M.P.M.
(Meridian)

So. Blanco P.C. & Blanco M.V. Rio Arriba
(Field) (County or Subdivision)

New Mexico
(State or Territory)

The elevation of the derrick floor above sea level is 6464 ft.

DETAILS OF WORK

(State names of and expected depths to objective sands; show sizes, weights, and lengths of proposed casings; indicate mudlogging jobs, cementing points, and all other important proposed work)

It is intended to mud drill a well with rotary tools to approximately 3405', set intermediate casing, then gas drill thru the Mesa Verde formation. Possible producing zones in the Pictured Cliffs and Mesa Verde formations will be perforated and fractured. The well will then be dually completed. Est. T. D. 5580'.

Casing Program:

- 10 3/4" @ 120' w/100 sks. cement circulated to surface.
- 7 5/8" @ 3405' w/160 sks. to cover Ojo Alamo.
- 5 1/2" at 5580' w/175 sks. to cover top of liner.

The E/2 of Section 28 is dedicated to this well.

I understand that this plan of work must receive approval in writing by the Geological Survey before operations may be commenced.

Company El Paso Natural Gas Company

Address Box 990

Farmington, New Mexico

By

D. W. Meekins

Title Petroleum Engineer

NEW MEXICO OIL CONSERVATION COMMISSION

Well Location and Acreage Dedication Plat

Section A.

Date **AUGUST 2, 1962**

Operator **EL PASO NATURAL GAS COMPANY** Lease **SAN JUAN 27-5 UNIT** **SF079394**
 Well No. **71 (PM)** Unit Letter **A** Section **28** Township **27-N** Range **5-W** NMPM
 Located **1190** Feet From **NORTH** Line, **797** Feet From **EAST** Line
 County **RIO ARRIBA** G. L. Elevation **6454** Dedicated Acreage **320** Acres
 Name of Producing Formation **PICTURED CLIFFS & MESA VERDE** Pool **SO BLANCO P.C. & BLANCO M.V.**

1. Is the Operator the only owner in the dedicated acreage outlined on the plat below?
 Yes ☒ No ☐
2. If the answer to question one is "no", have the interests of all the owners been consolidated by communitization agreement or otherwise? Yes ☐ No ☐ If answer is "yes", Type of Consolidation.
3. If the answer to question two is "no", list all the owners and their respective interests below:

Owner

Land Description

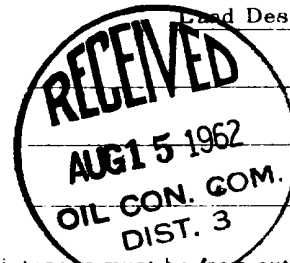

RECEIVED
AUG 13 1962

U. S. GEOLOGICAL SURVEY
 FARMINGTON, NEW MEXICO

Section B.

This is to certify that the information in Section A above is true and complete to the best of my knowledge and belief.

El Paso Natural Gas CompanyOriginal Signed ^(Operator) **D. W. Meehan**

(Representative)

Box 990

(Address)

Farmington, New Mexico

Note: All distances must be from outer boundaries of section

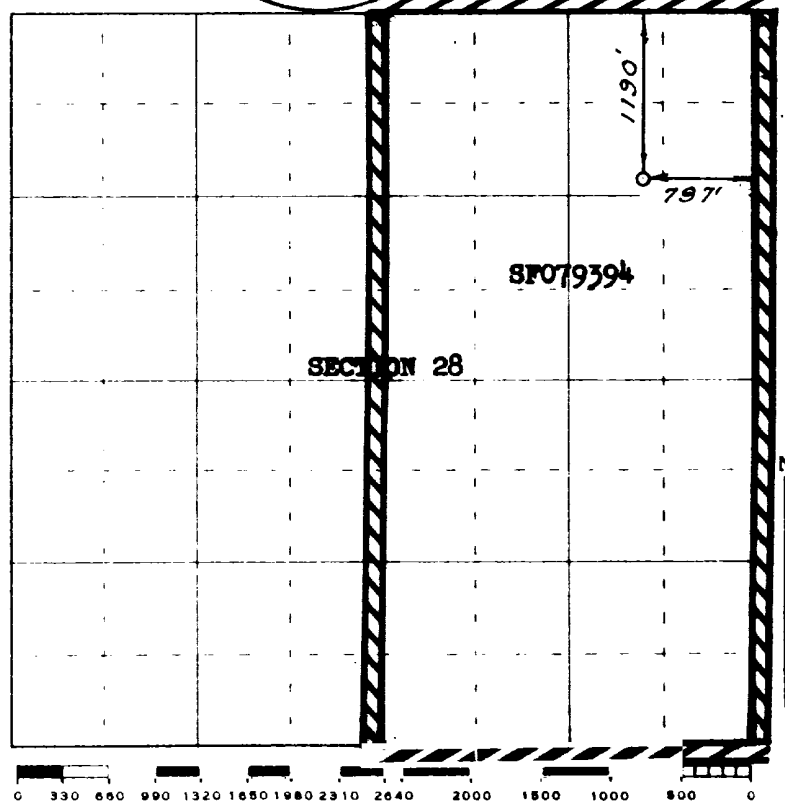

0 330 660 990 1320 1650 1980 2310 2640 2000 1500 1000 500 0

Scale 4 inches equal 1 mile

This is to certify that the above plat was prepared from field notes of actual surveys made by me or under my supervision and that the same are true and correct to the best of my knowledge and belief.

(Seal)

Date Surveyed

AUGUST 1, 1962

David O. Kilmer
 Registered Professional Engineer and/or Land Surveyor

Farmington, New Mexico

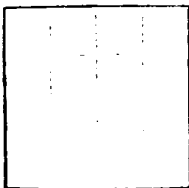

(SUBMIT IN TRIPLICATE)
UNITED STATES
DEPARTMENT OF THE INTERIOR
GEOLOGICAL SURVEY

Budget Bureau No. 42-R358.4.
Form Approved.

Land Office **Santa Fe**
Lease No. **079394**
Unit **San Juan 27-5 Unit**

SUNDRY NOTICES AND REPORTS ON WELLS

RECEIVED

NOTICE OF INTENTION TO DRILL	SUBSEQUENT REPORT OF WATER SHUT-OFF
NOTICE OF INTENTION TO CHANGE PLANS	SUBSEQUENT REPORT OF SHOOTING OR ACIDIZING
NOTICE OF INTENTION TO TEST WATER SHUT-OFF	SUBSEQUENT REPORT OF ALTERING CASING
NOTICE OF INTENTION TO RE-DRILL OR REPAIR WELL	SUBSEQUENT REPORT OF RE-DRILLING OR REPAIR
NOTICE OF INTENTION TO SHOOT OR ACIDIZE	SUBSEQUENT REPORT OF ABANDONMENT
NOTICE OF INTENTION TO PULL OR ALTER CASING	SUPPLEMENTARY WELL HISTORY
NOTICE OF INTENTION TO ABANDON WELL	Pictured Cliff Dedication

MAR 12 1963

U. S. GEOLOGICAL SURVEY
FARMINGTON, NEW MEXICO

XX

INDICATE ABOVE BY CHECK MARK NATURE OF REPORT, NOTICE, OR OTHER DATA

March 7

1963

Well No. **71(PM)** is located **1190** ft. from **N** line and **797** ft. from **E** line of sec. **28**

NE/4 Section 28

So. Blanco Pictured Cliff
Blanco Mesa Verde

27-N
(Twp.)

5-W
(Range)

N.M.P.M.
(Meridian)

Rio Arriba
(County or Subdivision)

New Mexico
(State or Territory)

The elevation of the derrick floor above sea level is **6464** ft.

DETAILS OF WORK

(State names of and expected depths to objective sands; show sizes, weights, and lengths of proposed casings; indicate mudding jobs, cementing points, and all other important proposed work.)

The attached plat is being re-issued to show Pictured Cliffs dedication.



I understand that this plan of work must receive approval in writing by the Geological Survey before operations may be commenced.

Company **El Paso Natural Gas Company**

Address **Box 990**

Farmington, New Mexico

By

Title **Petroleum Engineer**

NEW MEXICO OIL CONSERVATION COMMISSION

Well Location and Acreage Dedication Plat

Section A.

Date **AUGUST 2, 1962**

Operator **EL PASO NATURAL GAS COMPANY** Lease **SAN JUAN 27-5 UNIT** SF079394
 Well No. **71 (PM)** Unit Letter **A** Section **28** Township **27-N** Range **5-W** NMPM
 Located **1190** Feet From **NORTH** Line, **797** Feet From **EAST** Line
 County **RIO ARriba** G. L. Elevation **6454** Dedicated Acreage **320 & 160** Acres
 Name of Producing Formation **PICTURED CLIFFS & MESA VERDE** Pool **SO BLANCO P.C. & BLANCO M.V.**

1. Is the Operator the only owner in the dedicated acreage outlined on the plat below?

Yes ☒ No ☐2. If the answer to question one is "no", have the interests of all the owners been consolidated by communitization agreement or otherwise? Yes ☐ No ☐ If answer is "yes", Type of Consolidation.

3. If the answer to question two is "no", list all the owners and their respective interests below:

Owner

Land Description

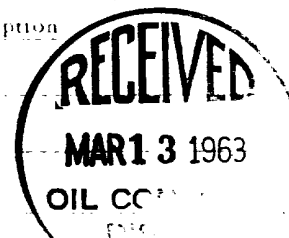

Section B.

This is to certify that the information in Section A above is true and complete to the best of my knowledge and belief.

El Paso Natural Gas Company

(Operator)

(Representative)

Box 990

(Address)

Farmington, New Mexico

Note: All distances must be from outer boundaries of section.

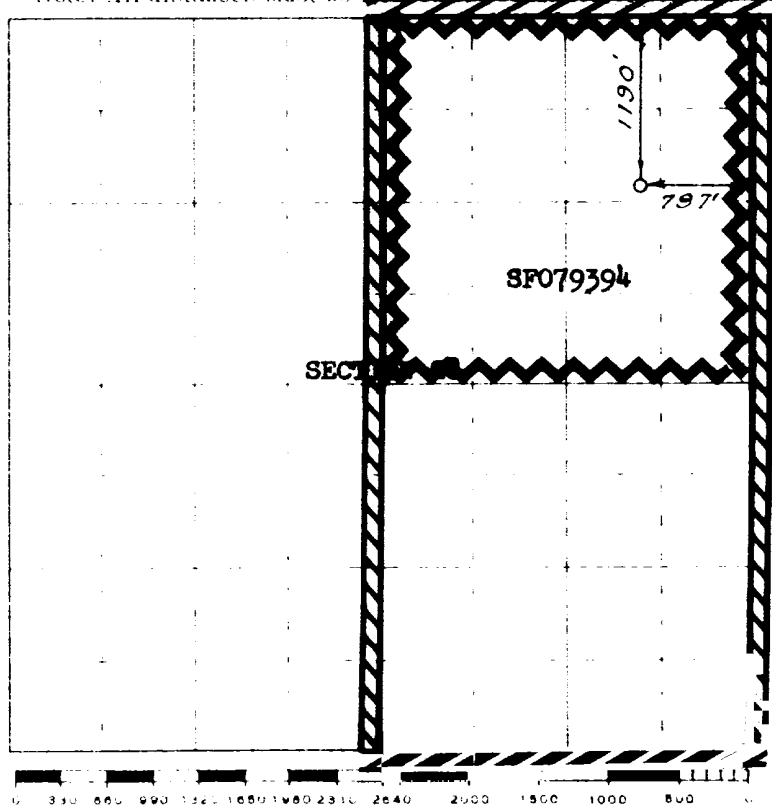

Scale 4 inches equal 1 mile

NOTE: REISSUED TO SHOW PICTURED**CLIFF DEDICATION.****3-6-63**

This is to certify that the above plat was prepared from field notes of actual surveys made by me or under my supervision and that the same are true and correct to the best of my knowledge and belief.

(Seal)

Date Surveyed

AUGUST 1, 1962

Farmington, New Mexico

David C. Kline, Jr.
 Registered Professional Engineer and/or Land Surveyor