

(SUBMIT IN TRIPLICATE)

UNITED STATES
DEPARTMENT OF THE INTERIOR
GEOLOGICAL SURVEY

Budget Bureau No. 42-R358.4.
Form Approved.

Land Office Santa Fe

Lease No. 079365

Unit San Juan 28-6 Unit

SUNDRY NOTICES AND REPORTS ON WELLS

NOTICE OF INTENTION TO DRILL	X	SUBSEQUENT REPORT OF WATER SHUT-OFF
NOTICE OF INTENTION TO CHANGE PLANS		SUBSEQUENT REPORT OF SHOOTING OR ACIDIZING
NOTICE OF INTENTION TO TEST WATER SHUT-OFF		SUBSEQUENT REPORT OF ALTERING CASING
NOTICE OF INTENTION TO RE-DRILL OR REPAIR WELL		SUBSEQUENT REPORT OF RE-DRILLING OR REPAIR
NOTICE OF INTENTION TO SHOOT OR ACIDIZE		SUBSEQUENT REPORT OF ABANDONMENT
NOTICE OF INTENTION TO PULL OR ALTER CASING		SUPPLEMENTARY WELL HISTORY
NOTICE OF INTENTION TO ABANDON WELL		

(INDICATE ABOVE BY CHECK MARK NATURE OF REPORT, NOTICE, OR OTHER DATA)

October 18, 1962

Well No. 111 is located 890 ft. from S line and 790 ft. from W line of sec. 15.

SW/4 Sec. 15
(1/4 Sec. and Sec. No.)

27N
(Twp.)

6W
(Range)

N.M.P.M.
(Meridian)

Basin Dakota
(Field)

Rio Arriba
(County or Sub-division)

New Mexico
(State or Territory)

The elevation of the derrick floor above sea level is 6511 ft.

DETAILS OF WORK

(State names of and expected depths to objective sands; show sizes, weights, and lengths of proposed casings; indicate mudding jobs, cementing points, and all other important proposed work)

It is intended to mad drill a well with rotary tools thru the Dakota formation and to perforate and fracture possible producing zones. Est. T. D. 7675'.

Casing Program:

9 5/8" @ 300' w/210 sks. cement circulated to surface.
4 1/2" @ 7675' w/2 & 3 stage collars. Set second stage collar 50' - 100' below base of Mesa Verde, 3rd stage 50' - 100' below base of Pictured Cliffs. Cement first stage w/212 sacks to cover 200' above Greenhorn. Second stage w/190 sks. to cover 100' above Cliff House. Third stage w/140 sks. to cover Ojo Alamo.

The W/2 of Section 15 is dedicated to this well.

I understand that this plan of work must receive approval in writing by the Geological Survey before operations may be commenced.

Company El Paso Natural Gas Company

Address Box 990

Farmington, New Mexico

By H. E. M. amdy
Title Petroleum Engineer

[illegible]

Well Location and Acreage Dedication Plat

Section A.

Date **OCTOBER 16, 1962**

Operator **EL PASO NATURAL GAS COMPANY** Lease **SAN JUAN 28-6 UNIT** **SF079365**
 Well No. **111** Unit Letter **M** Section **15** Township **27-N** Range **6-W** NMPM
 Located **890** Feet From **SOUTH** Line **790** Feet From **WEST** Line
 County **RIO ARriba** G. L. Elevation **6501** Dedicated Acreage **320** Acres
 Name of Producing Formation **DAKOTA** Pool **BASIN DAKOTA**

1. Is the Operator the only owner in the dedicated acreage outlined on the plat below?

Yes ☒ No ☐2. If the answer to question one is "no", have the interests of all the owners been consolidated by communitization agreement or otherwise? Yes ☐ No ☐ If answer is "yes", Type of Consolidation.

3. If the answer to question two is "no", list all the owners and their respective interests below:

Owner

Land Description

Section B.

This is to certify that the information in Section A above is true and complete to the best of my knowledge and belief.

El Paso Natural Gas Company

(Operator)

ORIGINAL SIGNED H.E. McANALLY

(Representative)

Box 990

(Address)

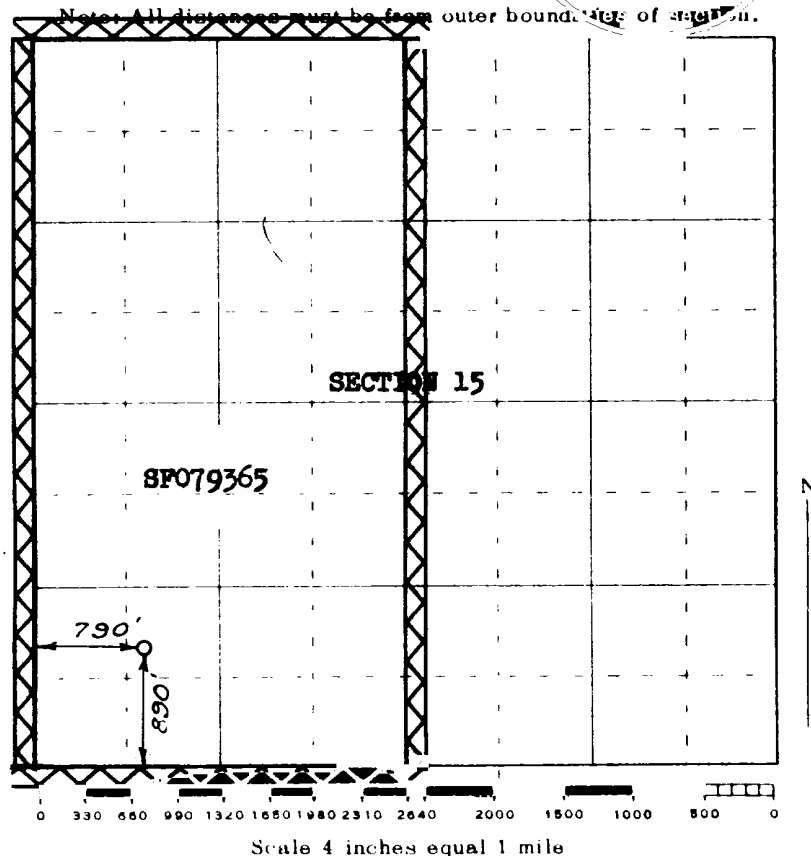
Farmington, New Mexico

This is to certify that the above plat was prepared from field notes of actual surveys made by me or under my supervision and that the same are true and correct to the best of my knowledge and belief.

(Seal)

Date Surveyed **SEPTEMBER 25, 1962**

David O. Kilburn
 Registered Professional Engineer and/or Land Surveyor

Farmington, New Mexico

[illegible]