

(SUBMIT IN TRIPLICATE)

Indian Agency _____

UNITED STATES
DEPARTMENT OF THE INTERIOR
GEOLOGICAL SURVEY

Navajo

Allottee _____

Lease No. 14-20-601-2091

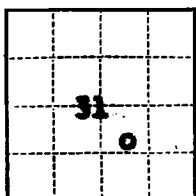

17W

SUNDRY NOTICES AND REPORTS ON WELLS

NOTICE OF INTENTION TO DRILL	XX	SUBSEQUENT REPORT OF WATER SHUT-OFF	
NOTICE OF INTENTION TO CHANGE PLANS		SUBSEQUENT REPORT OF SHOOTING OR ACIDIZING	
NOTICE OF INTENTION TO TEST WATER SHUT-OFF		SUBSEQUENT REPORT OF ALTERING CASING	
NOTICE OF INTENTION TO REDRILL OR REPAIR WELL		SUBSEQUENT REPORT OF REDRILLING OR REPAIR	
NOTICE OF INTENTION TO SHOOT OR ACIDIZE		SUBSEQUENT REPORT OF ABANDONMENT	
NOTICE OF INTENTION TO PULL OR ALTER CASING		SUPPLEMENTARY WELL HISTORY	
NOTICE OF INTENTION TO ABANDON WELL			

(INDICATE ABOVE BY CHECK MARK NATURE OF REPORT, NOTICE, OR OTHER DATA)

December 23, 1963

Well No. 1-31 is located 1900 ft. from XX line and 1900 ft. from E line of sec. 31

NW 22 Sec. 31 26 North 17 West N.M.P.M.

(1/4 Sec. and Sec. No.) (Twp.) (Range) (Meridian)

Wildcat San Juan New Mexico

(Field) (County or Subdivision) (State or Territory)

The elevation of the derrick floor above sea level is 5509 ft. 5494' G.L.

DETAILS OF WORK

(State names of and expected depths to objective sands; show sizes, weights, and lengths of proposed casings; indicate mudding jobs, cementing points, and all other important proposed work)

Compass Exploration, Inc., proposes to drill a well at the above location to test the oil and/or gas potential of all formations through the Gallup formation at an approximate total depth of 2200'. The following drilling procedure will be followed:

- 1) Drill to 250'. Run 250' of 8-5/8" surface casing and cement with sufficient cement to circulate.
- 2) Drill with air or gas to total depth.
- 3) If water is encountered to the extent that air or gas drilling is unfeasible, the hole will be mudded up.
- 4) Run Gamma Ray induction log.
- 5) If commercial production is encountered, 4-1/2" casing will be run, cemented and a conventional completion will be effected.

I understand that this plan of work must receive approval in writing by the Geological Survey before operations may be commenced.

Company Compass Exploration, Inc.Address 101 University BoulevardDenver, Colorado 80206By P. J. FarrellyTitle Manager of Exploration and Production12-21-63 - Verbal
Approval U.S.G.S.

NEW MEXICO OIL CONSERVATION COMMISSION

Well Location and Acreage Dedication Plat

SECTION A.

Date December 27, 1963

Operator Compass Exploration, Inc. Lease Blanea
Well No. 1-31 Unit Letter J Section 31 Township 26 North Range 17 West NMPM
Located 1980 Feet From South Line, 1980 Feet From East Line
County San Juan G. L. Elevation 5474 Dedicated Acreage _____ Acres
Name of Producing Formation _____ Pool _____

1. Is the Operator the only owner* in the dedicated acreage outlined on the plat below? Yes _____ No _____
2. If the answer to question One is "No," have the interests of all the owners been consolidated by communitization agreement or otherwise? Yes _____ No _____ If answer is "Yes," Type of Consolidation _____
3. If the answer to question Two is "No," list all the owners and their respective interests below:

OWNER

LAND DESCRIPTION

SECTION B.

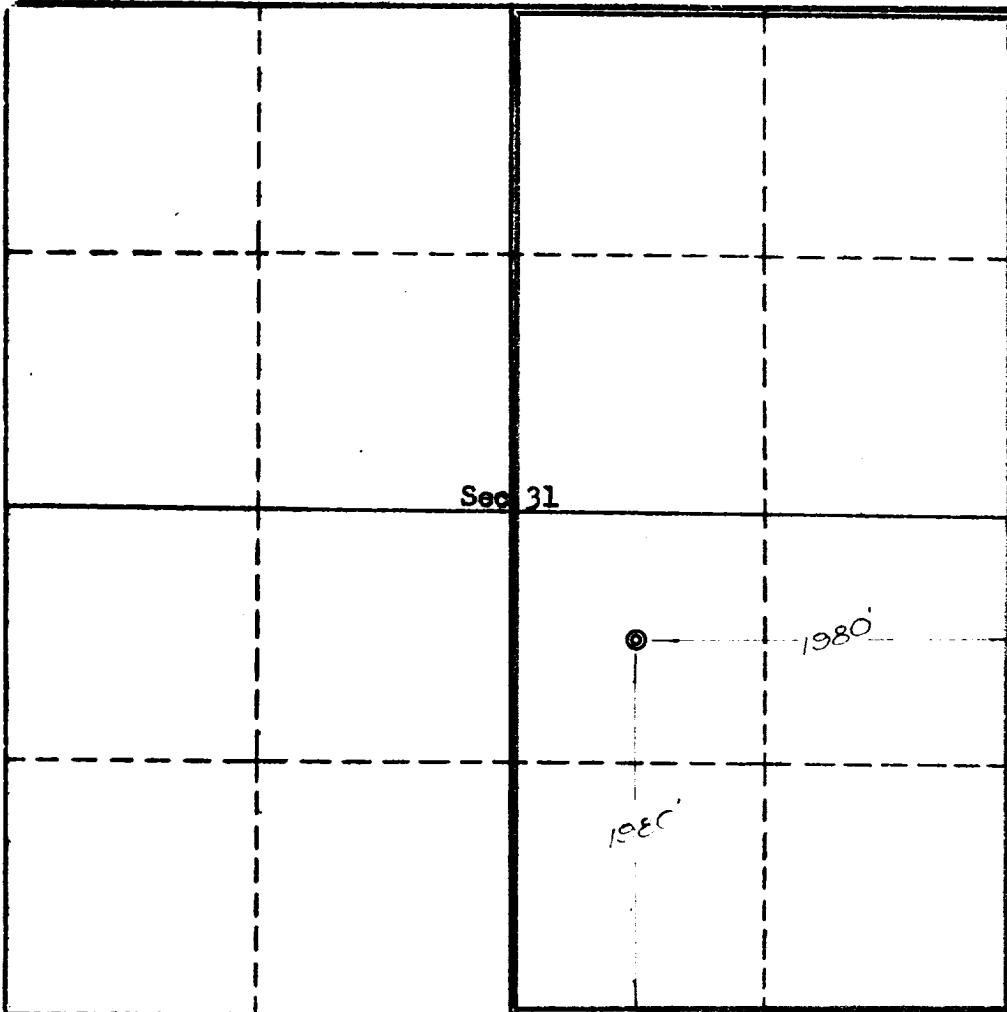

This is to certify that the information in Section A above is true and complete to the best of my knowledge and belief.

Compass Exploration, Inc.

(OPERATOR)

E. C. Ellis
E. C. Ellis (REPRESENTATIVE)

Farmington, New Mexico

(ADDRESS)

This is to certify that the well location shown on the plat in Section B was plotted from field notes of actual surveys made by me or under my supervision and that the same is true and correct to the best of my knowledge and belief.

Date Surveyed Dec. 20, 1963

Four States Engineering Co.

FARMINGTON, NEW MEXICO

Carl F. Teetsch
REGISTERED ENGINEER OR
LAND SURVEYOR

Certificate No. 3602