

(SUBMIT IN TRIPLICATE)

UNITED STATES
DEPARTMENT OF THE INTERIOR
GEOLOGICAL SURVEY

Land Office Santa Fe
Lease No. _____
Unit Nickson

SUNDRY NOTICES AND REPORTS ON WELLS

NOTICE OF INTENTION TO DRILL		SUBSEQUENT REPORT OF WATER SHUT-OFF	
NOTICE OF INTENTION TO CHANGE PLANS	<input checked="" type="checkbox"/>	SUBSEQUENT REPORT OF SHOOTING OR ACIDIZING	
NOTICE OF INTENTION TO TEST WATER SHUT-OFF		SUBSEQUENT REPORT OF ALTERING CASING	
NOTICE OF INTENTION TO RE-DRILL OR REPAIR WELL		SUBSEQUENT REPORT OF RE-DRILLING OR REPAIR	
NOTICE OF INTENTION TO SHOOT OR ACIDIZE		SUBSEQUENT REPORT OF ABANDONMENT	
NOTICE OF INTENTION TO PULL OR ALTER CASING		SUPPLEMENTARY WELL HISTORY	
NOTICE OF INTENTION TO ABANDON WELL			

(INDICATE ABOVE BY CHECK MARK NATURE OF REPORT, NOTICE, OR OTHER DATA)

RECEIVED
JUL 7 1961
U. S. GEOLOGICAL SURVEY
FARMINGTON, NEW MEXICO

Well No. 1 is located 790 ft. from N line and 1966 ft. from E line of sec. 35
(Range) (Township) (Section)
Ballard (Field) San Juan (Subdivision) New Mexico (Territory)

The elevation of the derrick floor above sea level is 7018 ft.

DETAILS OF WORK

(State names of and expected depths to objective sands; show sizes, weights, and lengths of proposed casings; indicate mudding jobs, cementing points, and all other important proposed work)

Cement 8 and 5/8" casing at 100' with 75 sacks. Drill to total depth of 2700'. Estimated top of Pictured Cliffs at 2600'. Cement 4 1/2" casing at 2700' with 100 sacks. Perforate and sand-water free Pictured Cliffs. Swab well in.

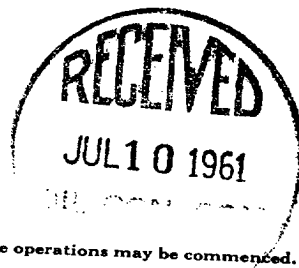

I understand that this plan of work must receive approval in writing by the Geological Survey before operations may be commenced.

Company Mountain States Petroleum Corporation

Address P. O. Box 1741

Farmington, New Mexico

By Mark A. Cole
Geologist
Red Clay for NSL

NEW MEXICO OIL CONSERVATION COMMISSION

Well Location and Acreage Dedication Plat

Sec A.

Date July 7, 1961

Operator MOUNTAIN STATES PETROLEUM CORPORATION Lease Nichols
 Well No. 790 Unit Letter N Section 35 Township 26 NORTH Range 8 WEST NMPM
 Located 790 Feet From the SOUTH Line, 1966 Feet From the WEST Line
 County SAN JUAN G. L. Elevation 7011.0 Dedicated Acreage 160 Acres
 Name of Producing Formation Nichols Pool Ballard

1. Is the Operator the only owner in the dedicated acreage outlined on the plat below?

Yes X No

2. If the answer to question one is "no", have the interests of all the owners been consolidated by communitization agreement or otherwise? Yes No. If answer is "yes", Type of Consolidation.

3. If the answer to question two is "no", list all the owners and their respective interests below:

Owner

Land Description



Section B.

Note: All distances must be from outer boundaries of section.

This is to certify that the information in Section A above is true and complete to the best of my knowledge and belief.

Mountain States Pet. Co.

(Operator)

Jack A. Cole

(Representative)

P.O. Box 1741, Farmington, N.M.

(Address)

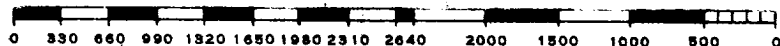
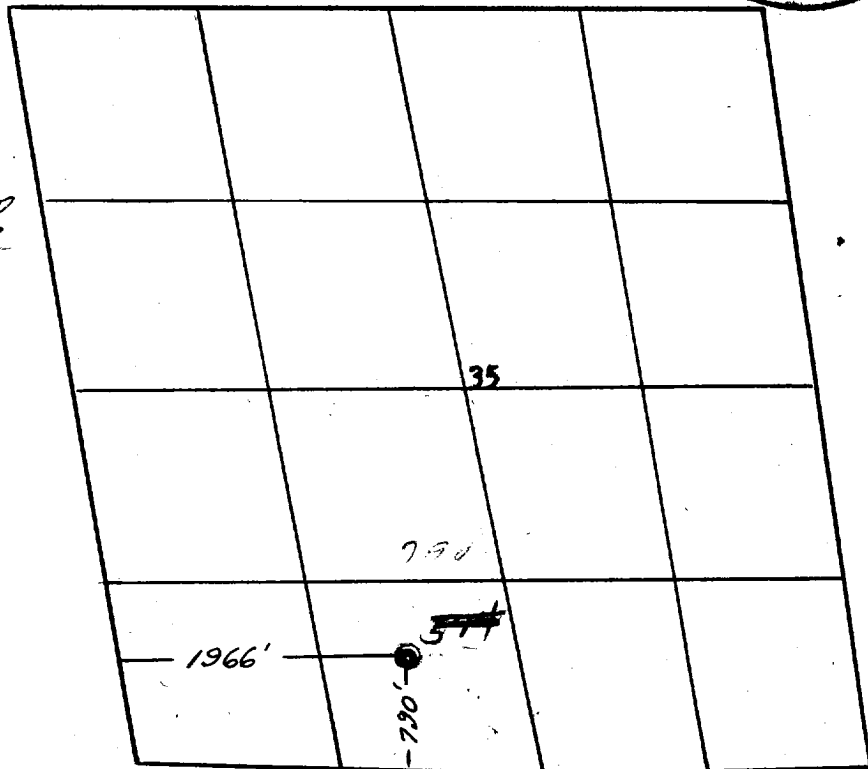

Scale 4 inches equal 1 mile

This is to certify that the above plat was prepared from field notes of actual surveys made by me or under my supervision and that the same are true and correct to the best of my knowledge and belief.

(Seal)

Date Surveyed 28 June 1961

James P. Lease
 Registered Professional Engineer and/or Land Surveyor
 James P. Lease N. Mex. Reg. No. 1463

Farmington, New Mexico

