

Well Location and Acreage Dedication Plat

Section A.

Date **AUGUST 24, 1962**

Operator **EL PASO NATURAL GAS COMPANY** Lease **HUERFANO B-9096-14**
 Well No. **134** Unit Letter **J** Section **36** Township **26-N** Range **10-W** NMPM
 Located **1650** Feet From **SOUTH** Line, **1650** Feet From **EAST** Line
 County **SAN JUAN** G. L. Elevation **6699** Dedicated Acreage **320** Acres
 Name of Producing Formation **DAKOTA** Pool **BASIN DAKOTA**

1. Is the Operator the only owner in the dedicated acreage outlined on the plat below?

Yes _____ No **x** _____2. If the answer to question one is "no", have the interests of all the owners been consolidated by communitization agreement or otherwise? Yes **x** No _____. If answer is "yes", Type of Consolidation.**Communitization Agreement.**

3. If the answer to question two is "no", list all the owners and their respective interests below:

Owner

Land Description



Section B.

This is to certify that the information in Section A above is true and complete to the best of my knowledge and belief.

~~El Paso Natural Gas Company~~

(Operator)

ORIGINAL SIGNED **H.E. McANALLY**

(Representative)

Box 990

(Address)

Farmington, New Mexico

Note: All distances must be from outer boundaries of section.

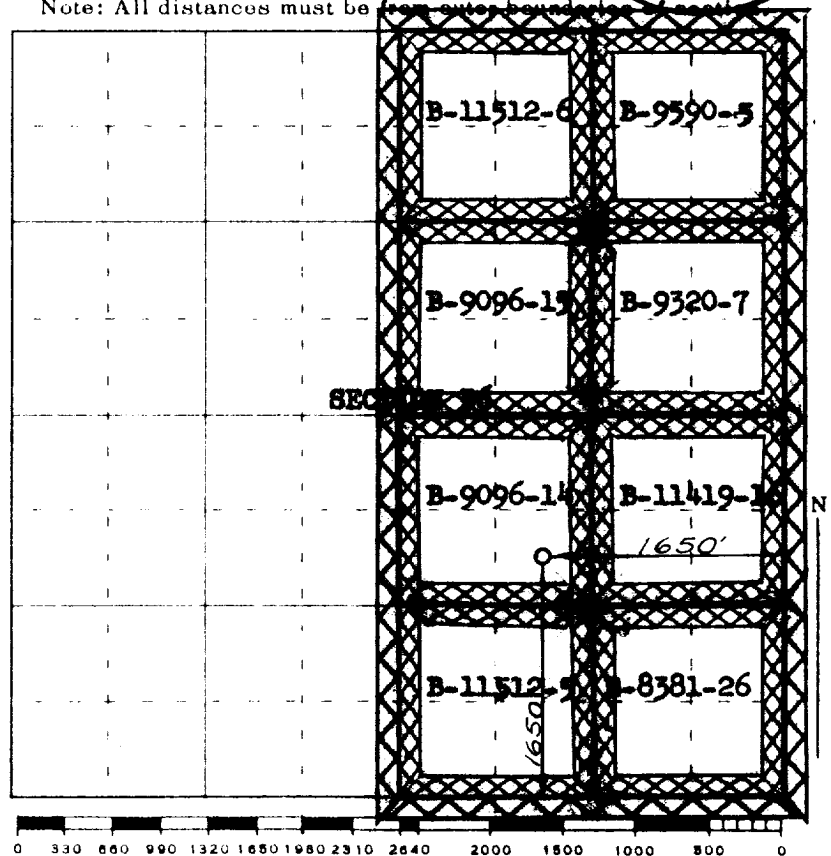

Scale 4 inches equal 1 mile

This is to certify that the above plat was prepared from field notes of actual surveys made by me or under my supervision and that the same are true and correct to the best of my knowledge and belief.

(Seal)

Date Surveyed **AUGUST 20, 1962**

Paul A. Kilmer
 Registered Professional Engineer and/or Land Surveyor

Farmington, New Mexico