

(SUBMIT IN TRIPLICATE)

UNITED STATES  
DEPARTMENT OF THE INTERIOR  
GEOLOGICAL SURVEY

Land Office Santa Fe  
Lease No. 081028-A  
Unit Sullivan

SUNDRY NOTICES AND REPORTS ON WELLS

NOTICE OF INTENTION TO DRILL.....	<input checked="" type="checkbox"/>	SUBSEQUENT REPORT OF WATER SHUT-OFF.....	
NOTICE OF INTENTION TO CHANGE PLANS.....		SUBSEQUENT REPORT OF SHOOTING OR ACIDIZING.....	
NOTICE OF INTENTION TO TEST WATER SHUT-OFF.....		SUBSEQUENT REPORT OF ALTERING CASING.....	
NOTICE OF INTENTION TO RE-DRILL OR REPAIR WELL.....		SUBSEQUENT REPORT OF RE-DRILLING OR REPAIR.....	
NOTICE OF INTENTION TO SHOOT OR ACIDIZE.....		SUBSEQUENT REPORT OF ABANDONMENT.....	
NOTICE OF INTENTION TO PULL OR ALTER CASING.....		SUPPLEMENTARY WELL HISTORY.....	
NOTICE OF INTENTION TO ABANDON WELL.....			

(INDICATE ABOVE BY CHECK MARK NATURE OF REPORT, NOTICE, OR OTHER DATA)

August 8, 1957

Well No. 3-D is located 1650 ft. from N line and 1650 ft. from W line of sec. 26  
SW Sec. 26 (1/4 Sec. and Sec. No.) 26N 13W N.M.F.M.  
Bisti (Field) San Juan (County or Subdivision) New Mexico (State or Territory)

The elevation of the derrick floor above sea level is 6193 ft.

DETAILS OF WORK

(State names of and expected depths to objective sands; show sizes, weights, and lengths of proposed casings; indicate mudding jobs, cementing points, and all other important proposed work)

It is intended to drill a well thru the Gallup formation using rotary tools, and to perforate and sand-oil fracture possible producing zones. Estimated total depth 5160'.

Casing Program:

10 3/4" at 120' with 125 sacks regular cement circulated to surface.  
5 1/2" at 5160' with 150 sacks regular cement, 150 sacks sand.

The NE1/4 of Section 26 is dedicated to this well.  
SF 081028-A (NE1/4).

I understand that this plan of work must receive approval in writing by the Geological Survey before operations are commenced.

Company El Paso Natural Gas Products Company

Address Box 997

Farmington, New Mexico

By Original Signed EWELL R. WALSH

Title Petroleum Engineer

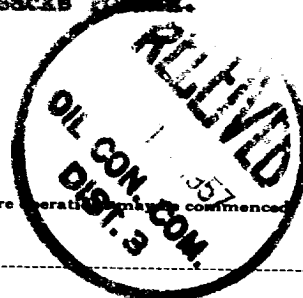

## Well Location and Acreage Dedication Plat

Section A.

Date **AUGUST 6, 1957**

Operator **EL PASO NATURAL GAS PRODUCTS COMPANY** Lease **SULLIVAN "D"** SF **081028**  
 Well No. **3** Unit Letter **K** Section **26** Township **26-N** Range **13-W** NMPM **-A**  
 Located **1650** Feet From **SOUTH** Line, **1650** Feet From **WEST** Line  
 County **SAN JUAN** G. L. Elevation **6183** Dedicated Acreage **40** Acres  
 Name of Producing Formation **GALLUP** Pool **BISTI ~~MEMPHIS~~**

1. Is the Operator the only owner in the dedicated acreage outlined on the plat below?  
 Yes ☒ No ☐
2. If the answer to question one is "no", have the interests of all the owners been consolidated by communitization agreement or otherwise? Yes ☐ No ☐ If answer is "yes", Type of Consolidation:
3. If the answer to question two is "no", list all the owners and their respective interests below:

Owner

Land Description

**RECEIVED****AUG 11 1957**

**U. S. GEOLOGICAL SURVEY**  
**FARMINGTON, NEW MEXICO**

Section B.

Note: All distances must be from outer boundaries of section.

This is to certify that the information in Section A above is true and complete to the best of my knowledge and belief.

**El Paso Natural Gas Products Co.**

Operator

*W. H. Walsh*

(Representative)

**Box 997**

(Address)

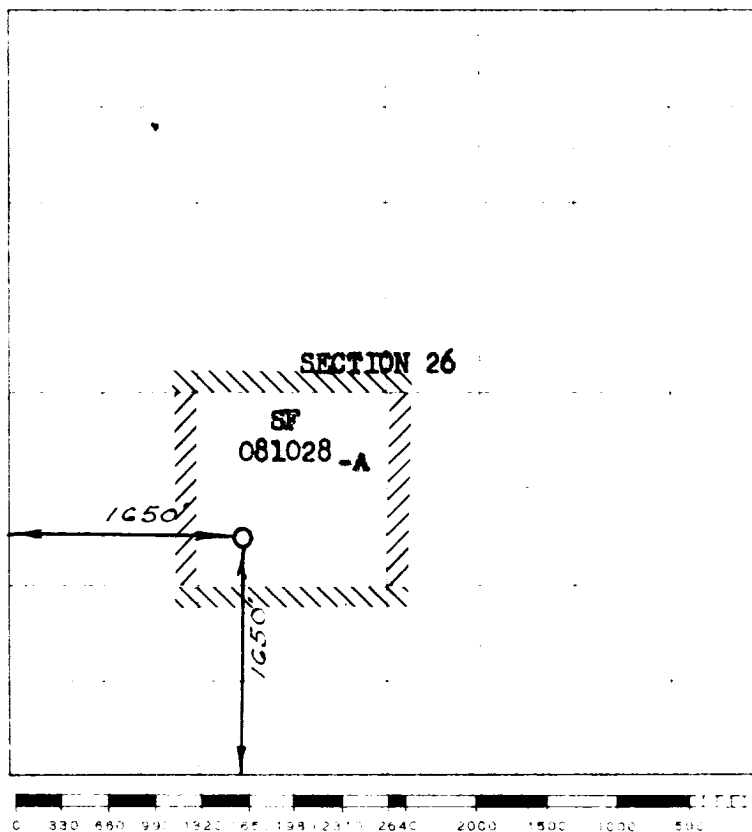
**Farmington, New Mexico**

This is to certify that the above plat was prepared from field notes of actual survey made by me or under my supervision and that the same are true and correct to the best of my knowledge and belief.

(Seal)

Date Surveyed **AUGUST 25, 1957***B. O. Walker*

Registered Professional Engineer and/or Land Surveyor

Farmington, New Mexico

**NOTE: THIS PLAT IS RE-ISSUED DUE TO LOCATION MOVE.**