

NEW MEXICO OIL CONSERVATION COMMISSION
Well Location and Acreage Dedication Plat

Section A.

Date January 22, 1959

Operator THE SKELLY OIL COMPANY Lease L. L. Davis
Well No. 1 Unit Letter A Section 26 Township 26 NORTH Range 11 WEST NMPM
Located 990 Feet From the NORTH Line, 990 Feet From the EAST Line
County SAN JUAN G. L. Elevation 6370 DF Dedicated Acreage 320 Acres
Name of Producing Formation Dakota Pool Undesignated

1. Is the Operator the only owner* in the dedicated acreage outlined on the plat below?
Yes X No .
2. If the answer to question one is "no," have the interests of all the owners been consolidated by communitization agreement or otherwise? Yes No . If answer is "yes," Type of Consolidation
3. If the answer to question two is "no," list all the owners and their respective interests below:
Ref: GLO Plat dated 5 August 1932

Owner

Land Description

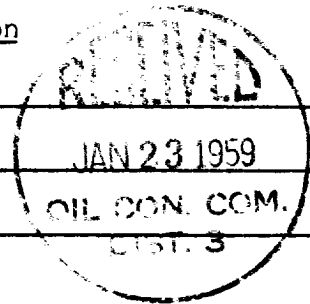

Section B

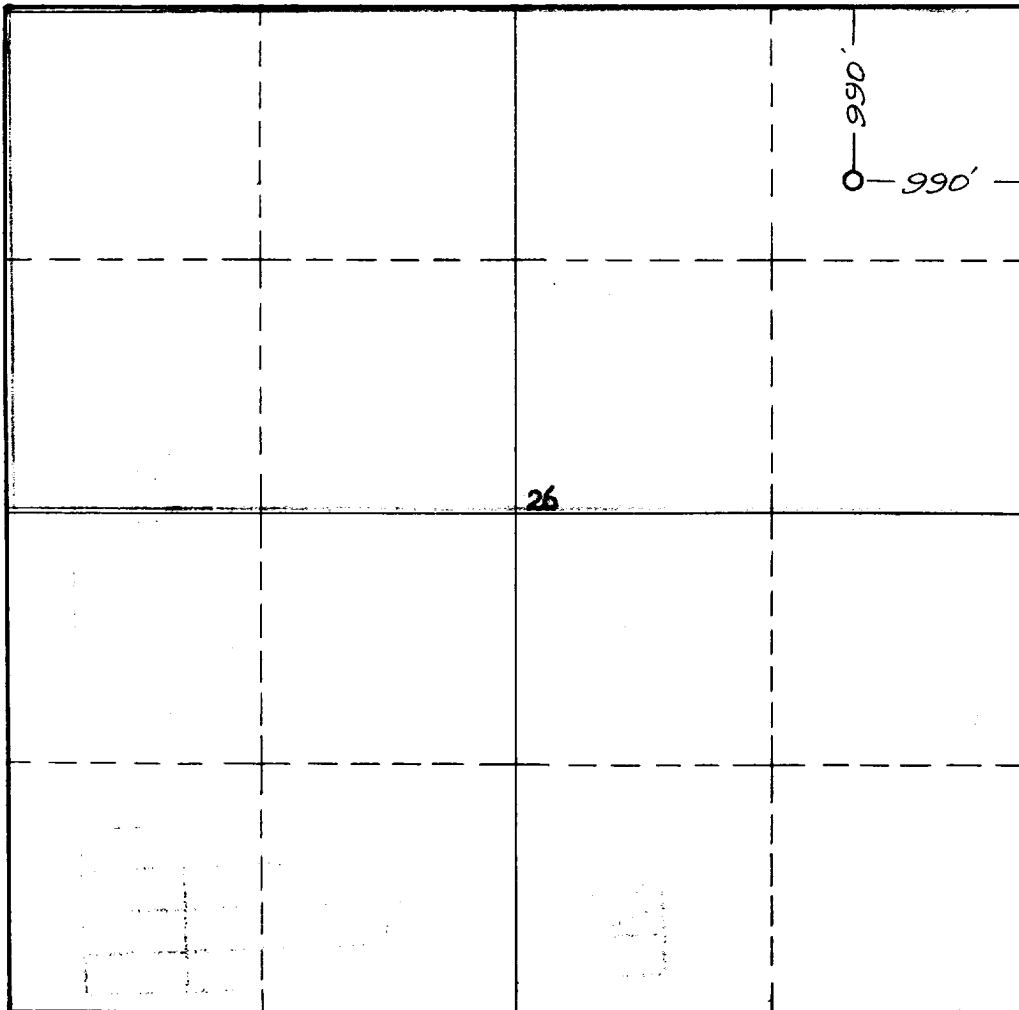

This is to certify that the information in Section A above is true and complete to the best of my knowledge and belief.

Skelly Oil Company
(Operator)

(Representative)

Box 426, Farmington, New Mexico
Address

This is to certify that the well location shown on the plat in Section B was plotted from field notes of actual surveys made by me or under my supervision and that the same is true and correct to the best of my knowledge and belief.

Date Surveyed 10 Sept. 1957

James P. Leese
Registered Professional
Engineer and/or Land Surveyor.

James P. Leese

Certificate No. 1463

(See instructions for completing this form on the reverse side)

OIL CONSERVATION COMMISSION		
AZTEC DISTRICT OFFICE		
No. Copies Furnished		2
DISTRIBUTION		
	NO. FURNISHED	
Director	/	
Secretary	/	
Production Office		
State Land Office		
U. S. G. S.		
Transporter		
File	/	✓