

(SUBMIT IN TRIPLICATE)

UNITED STATES
DEPARTMENT OF THE INTERIOR
GEOLOGICAL SURVEY

Land Office Santa Fe
Lease No. NE 629492
Unit A. L. Duff

SUNDRY NOTICES AND REPORTS ON WELLS

NOTICE OF INTENTION TO DRILL	<input checked="" type="checkbox"/>	SUBSEQUENT REPORT OF WATER SHUT-OFF
NOTICE OF INTENTION TO CHANGE PLANS		SUBSEQUENT REPORT OF SHOOTING OR ACIDIZING
NOTICE OF INTENTION TO TEST WATER SHUT-OFF		SUBSEQUENT REPORT OF ALTERING CASING
NOTICE OF INTENTION TO RE-DRILL OR REPAIR WELL		SUBSEQUENT REPORT OF RE-DRILLING OR REPAIR
NOTICE OF INTENTION TO SHOOT OR ACIDIZE		SUBSEQUENT REPORT OF ABANDONMENT
NOTICE OF INTENTION TO PULL OR ALTER CASING		SUPPLEMENTARY WELL HISTORY
NOTICE OF INTENTION TO ABANDON WELL		

(INDICATE ABOVE BY CHECK MARK NATURE OF REPORT, NOTICE, OR OTHER DATA)

September 26, 1956

A. L. Duff
Well No. 1 is located 660 ft. from S line and 1900 ft. from E line of sec. 19

SE/4 Section 19 26N 13W N.M.P.M.
(1/4 Sec. and Sec. No.) (Twp.) (Range) (Meridian)
Wildcat San Juan New Mexico
(Field) (County or Subdivision) (State or Territory)

The elevation of the derrick floor above sea level is _____ ft.

DETAILS OF WORK

(State names of and expected depths to objective sands; show sizes, weights, and lengths of proposed casings; indicate mudding jobs, cementing points, and all other important proposed work)

It is our intention to drill well No. 1 to approximately 5400' to test the Gallup formation. Our casing program is as follows:

200' of 9-5/8" OD casing, cemented with 200 sks. of regular cement - circulated.
5400' of 5-1/2" OD casing, cemented with 300 sks. of regular cement.

The designated drilling unit is the SE/4 SE/4 of Section 19-26N-13W, San Juan County, New Mexico.

I understand that this plan of work must receive approval in writing by the Geological Survey before operations may be commenced

Company Stelly Oil Company

Address Box 426, Farmington, New Mexico

By P. E. Cooper

Title District Foreman



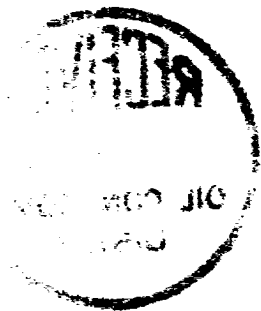

NEW MEXICO
OIL CONSERVATION COMMISSION

Form C-128

Well Location and/or Gas Proration Plat

Date September 26, 1956

Operator SKELLY OIL COMPANY Lease A. L. DUFF

Well No. 1 Section 19 Township 26 NORTH Range 13 WES T. NMPM

Located 660 Feet From the SOUTH Line, 1980 Feet From the EAST Line,

SAN JUAN County, New Mexico. G. L. Elevation _____

Name of Producing Formation Gallup Pool Undesignated Dedicated Acreage 1.40

(Note: All distances must be from outer boundaries of Section)

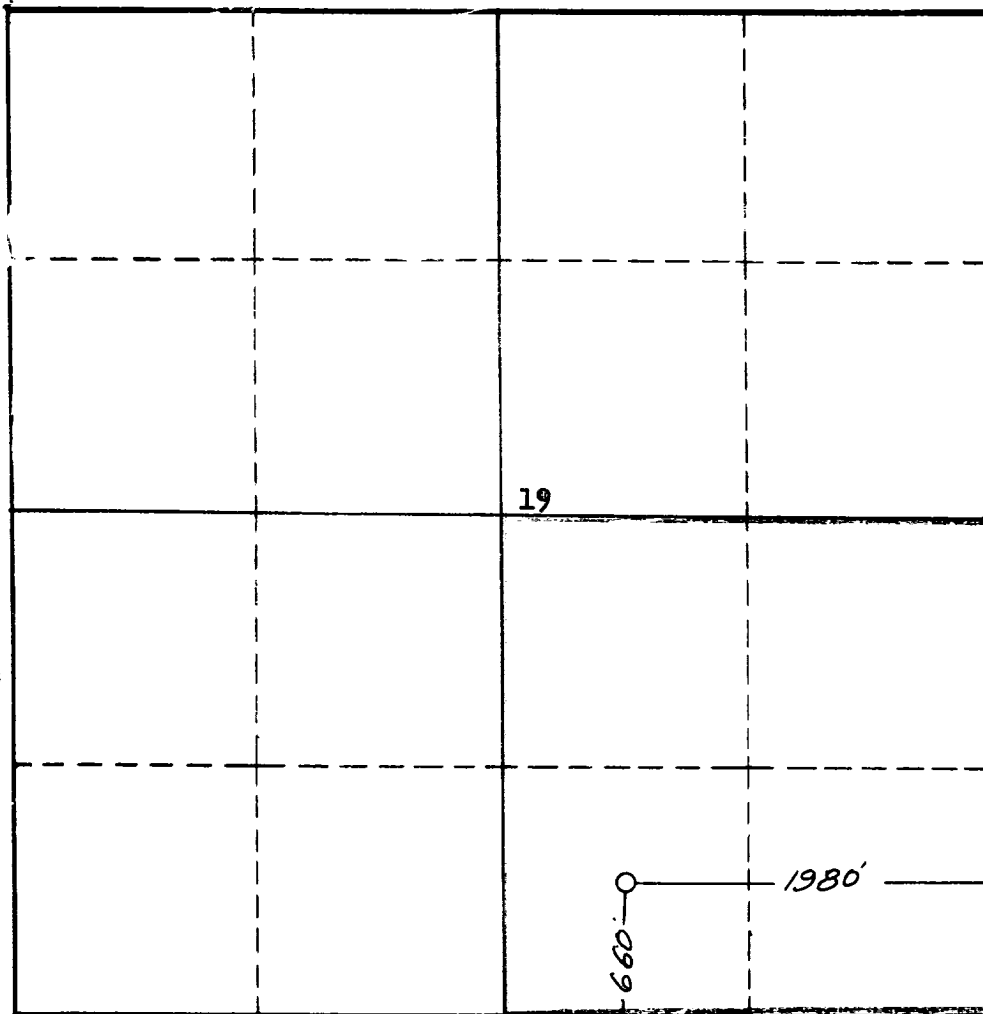

NOTE

This section of
form is to be
used for gas
wells only.



SCALE: 1"=1000'

1. Is this Well a Dual Comp. ? Yes No.
2. If the answer to Question 1 is yes, are there any other dually completed wells within the dedicated acreage? Yes No.

Name J. E. Cooper
Position Assistant Foreman
Representing Skelly Oil Company
Address Box 454, Farmington, New Mexico

This is to certify that the above plat was prepared from field notes of actual surveys made by me or under my supervision and that the same are true and correct to the best of my knowledge and belief.

Date Surveyed 24 SEPTEMBER 1956
James P. Leese
Registered Professional Engineer and/or
Land Surveyor James P. Leese
N. Mex. Reg. No. 1463