

NEW MEXICO OIL CONSERVATION COMMISSION
Santa Fe, New Mexico

NOTICE OF INTENTION TO DRILL OR RECOMPLETE

AUG 3 1955

OIL CON. COM.
DIST. 3

Notice must be given to the District Office of the Oil Conservation Commission and approval obtained before drilling or recompletion begins. If changes in the proposed plan are considered advisable, a copy of this notice showing such changes will be returned to the sender. Submit this notice in QUINTUPLICATE. One copy will be returned following approval. See additional instructions in Rules and Regulations of the Commission.

Farmington, New Mexico
(Place)

August 5, 1955
(Date)

OIL CONSERVATION COMMISSION
SANTA FE, NEW MEXICO

Gentlemen:

You are hereby notified that it is our intention to commence the (Drilling) (~~Recompletion~~) of a well to be known as

El Paso Natural Gas Company
(Company or Operator)

Thompson
(Lease)

Well No. 1-A, in P (Unit). The well is

located 845 feet from the South line and 1100 feet from the

East line of Section 24, T. 26N, R. 9W, NMPM.

(GIVE LOCATION FROM SECTION LINE) Wildcat Pool, San Juan County

If State Land the Oil and Gas Lease is No. Fee

If patented land the owner is Chester E. Thompson

Address.....

We propose to drill well with drilling equipment as follows: Rotary tools to top of Pictured Cliff Formation and cable tools thru formation.

The status of plugging bond is Statewide

Drilling Contractor Company tools

We intend to complete this well in the Pictured Cliff formation at an approximate depth of 1988 feet.

D	C	B	A
E	F	G	H
L	K	J	I
M	N	O	X P

Elev. 6247'GR, 6257'DF

CASING PROGRAM

We propose to use the following strings of Casing and to cement them as indicated:

Size of Hole	Size of Casing	Weight per Foot	New or Second Hand	Depth	Sacks Cement
<u>13 3/4"</u>	<u>9 5/8"</u>	<u>25.4#</u>	<u>New</u>	<u>120'</u>	<u>125</u>
<u>8 3/4"</u>	<u>5 1/2"</u>	<u>15.50#</u>	<u>New</u>	<u>1913'</u>	<u>150</u>

If changes in the above plans become advisable we will notify you immediately.

ADDITIONAL INFORMATION (If recompletion give full details of proposed plan of work.) It is proposed to sandoil fracture the entire Pictured Cliff formation.

The SE 1/4 of Section 24 is dedicated to this well.
(SE/4) Thompson Fee.

AUG 8 1955

Approved....., 19.....
Except as follows:

Sincerely yours,

El Paso Natural Gas Company
(Company or Operator)

By E. J. Coel
Petroleum Engineer

Position..... Send Communications regarding well to

Name E. J. Coel

Address Box 997, Farmington, New Mexico

OIL CONSERVATION COMMISSION

By A. R. Kerechick
Title PETROLEUM ENGINEER DIST. NO. 3

COMPANY EL PASO NATURAL GAS COMPANY

Well Name & No. THOMPSON # 1-A Lease No. FREE

Location 845' FROM THE SOUTH LINE AND 1100' FROM THE EAST LINE.

Section in NW SE SE

Sec. 24, T. 26 N., R. 9 W., T. 26 N., R. 9 W., SAN JUAN COUNTY, NEW MEXICO

Ground Elevation 6246.9 UNGRADED

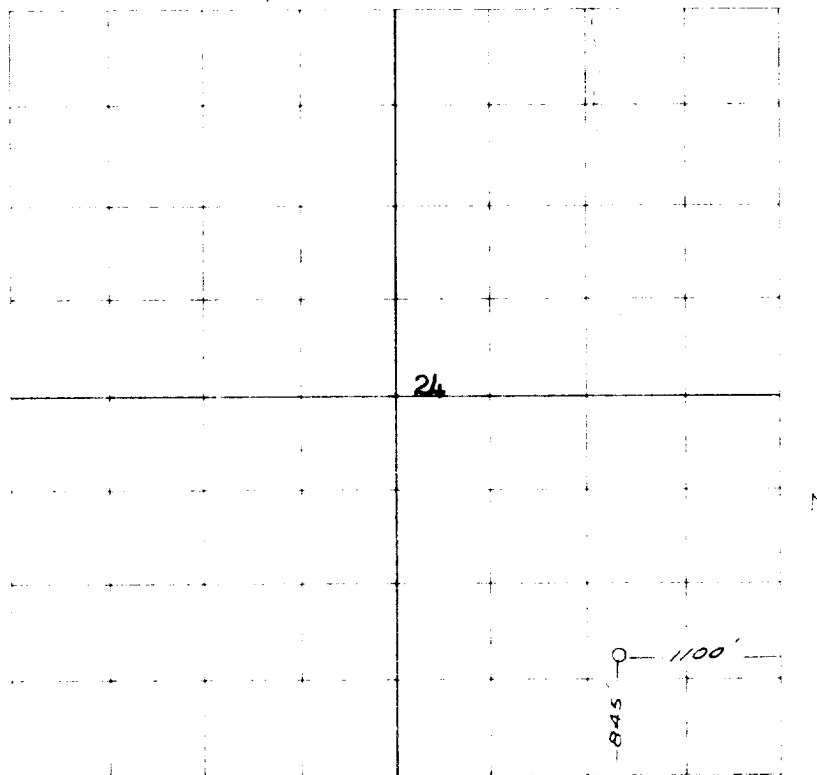

Scale -- 4 inches = one mile

Surveyed 22 JULY, 1955

This is to certify that the above plat was prepared from field notes of actual surveys made by me or under my supervision and that the same are true and correct to the best of my knowledge and belief.



James P. Leese
JAMES P. LEESE
LAND SURVEYOR
N. MEX. REG. NO. 1463

160 ACRES, SE/4 SECTION (PLAT)

OIL CONSERVATION COMMISSION		
AZTEC DISTRICT OFFICE		
No. Copies Received <u>6</u>		
DISTRIBUTION		
	NO. FURNISHED	
Operator	<u>2</u>	
Santa Fe	<u>1</u>	
Proration Office		
State Land Office		
U. S. G. S.	<u>2</u>	
Transporter		
File	<u>1</u>	<input checked="" type="checkbox"/>