

## Section A.

8/8/62

Operator SOUTHWEST PRODUCTION COMPANY Lease Davis Federal SP-078227  
 Well No. \_\_\_\_\_ Unit Letter L Section 24 Township 26 NORTH Range 11 WEST NMPM  
 Located 1850 Feet From the SOUTH Line, 790 Feet From the WEST Line  
 County SAN JUAN G. L. Elevation 6341.0 Dedicated Acreage 8/320 Acres  
 Name of Producing Formation Dakota & Gallup Pool Basin Dakota & Gallegos Gallup

1. Is the Operator the only owner in the dedicated acreage outlined on the plat below?  
 Yes \_\_\_\_\_ No \_\_\_\_\_
2. If the answer to question one is "no", have the interests of all the owners been consolidated by communitization agreement or otherwise? Yes \_\_\_\_\_ No \_\_\_\_\_. If answer is "yes", Type of Consolidation.

3. If the answer to question two is "no", list all the owners and their respective interests below:

Owner

Land Description

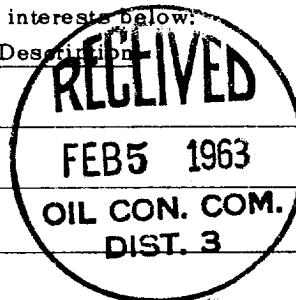

## Section B.

Note: All distances must be from outer boundaries of section.

This is to certify that the information in Section A above is true and complete to the best of my knowledge and belief.

**Southwest Production Company**

(Operator)

Original signed by  
Carl W. Smith

**207 Petr. Club Plaza**  
(Representative)

**Farmington, New Mexico**  
(Address)

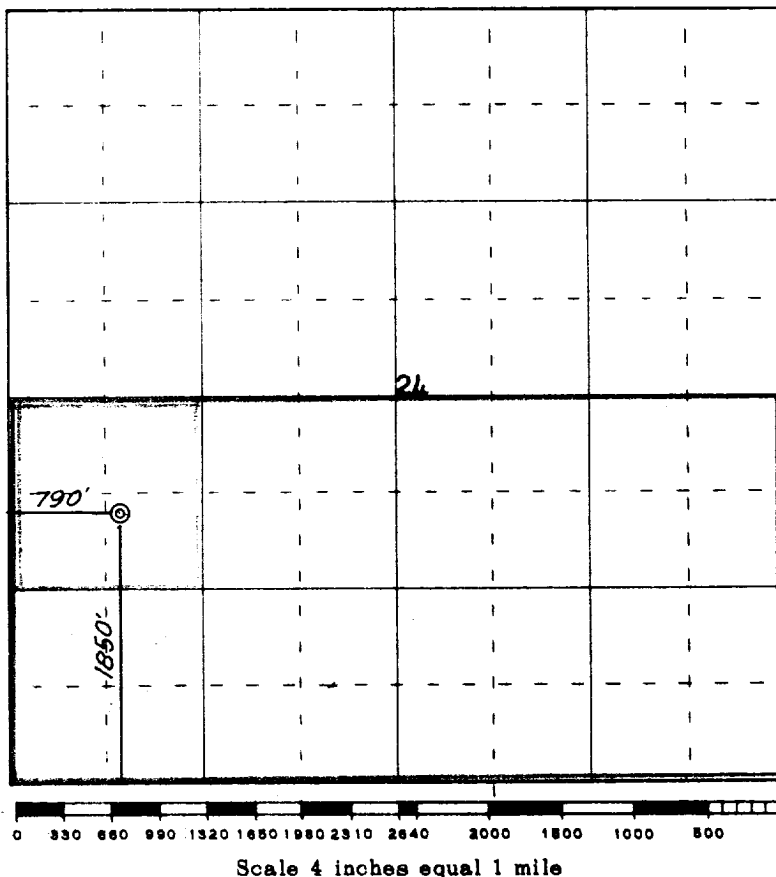

This is to certify that the above plat was prepared from field notes of actual surveys made by me or under my supervision and that the same are true and correct to the best of my knowledge and belief.

(Seal)

Date Surveyed June 16, 1962

Farmington, New Mexico

*James P. Leese*  
 Registered Professional Engineer and/or Land Surveyor  
 James P. Leese N. Mex. Reg. No. 1463  
 San Juan Engineering Co.