

NEW MEXICO OIL CONSERVATION COMMISSION
Well Location and Acreage Dedication Plat

Section A.

Date 4 FEBRUARY 1958

Operator SKELLY OIL COMPANY Lease A. L. DUFF
Well No. 5 Unit Letter F Section 20 Township 26 NORTH Range 13 WEST NMPM
Located 1980 Feet From THE NORTH Line, 1980 Feet From THE WEST Line
County SAN JUAN G. L. Elevation _____ Dedicated Acreage 80 Acres
Name of Producing Formation Gallup Pool Blat 1 - Ext

1. Is the Operator the only owner* in the dedicated acreage outlined on the plat below?
Yes x No _____.
2. If the answer to question one is "no," have the interests of all the owners been consolidated by communitization agreement or otherwise? Yes _____ No _____. If answer is "yes," Type of Consolidation _____
3. If the answer to question two is "no," list all the owners and their respective interests below:

REF. GLO Plat dated 19 July 1915

Owner

Land Description

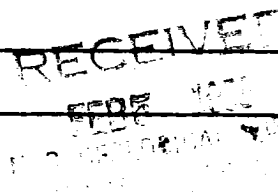
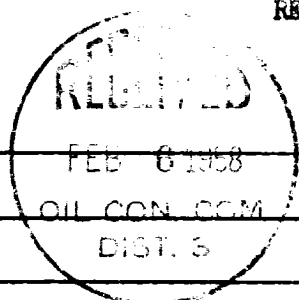

Section B

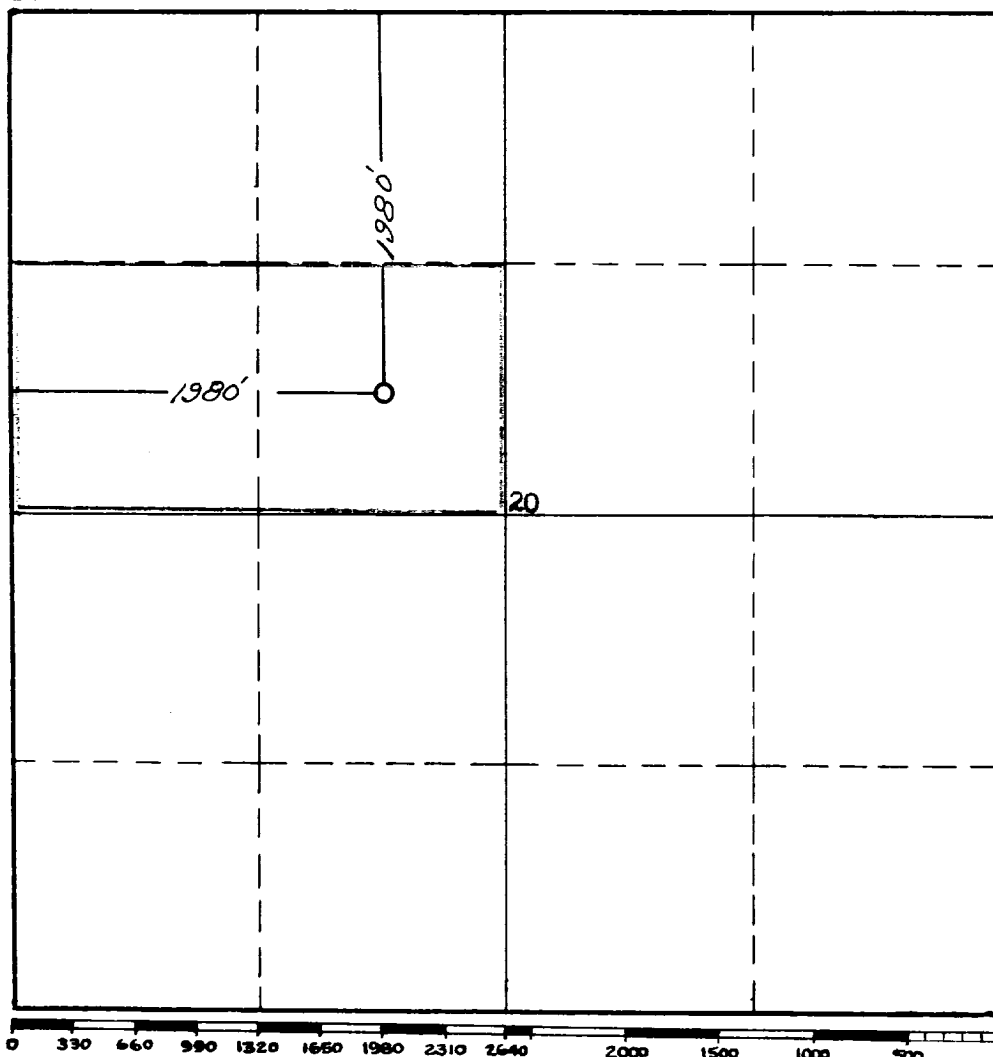

This is to certify that the information in Section A above is true and complete to the best of my knowledge and belief.

SKELLY OIL COMPANY

(Operator)

(Signed) E. S. Cooper

(Representative)

Box 426, Farmington, New Mexico
Address

This is to certify that the well location shown on the plat in Section B was plotted from field notes of actual surveys made by me or under my supervision and that the same is true and correct to the best of my knowledge and belief.

Date Surveyed 6 DECEMBER 1957

James P. Leese
Registered Professional
Engineer and/or Land Surveyor.

JAMES P. LEESE

Certificate No. 1463

(See instructions for completing this form on the reverse side)

INSTRUCTIONS FOR COMPLETION:

1. Operator shall furnish and certify to the information called for in Section A.
2. Operator shall outline the dedicated acreage for both oil and gas wells on the plat in Section B.
3. A registered professional engineer or land surveyor registered in the State of New Mexico or approved by the Commission shall show on the plat the location of the well and certify this information in the space provided.
4. All distances shown on the plat must be from the outer boundaries of Section.
5. If additional space is needed for listing owners and their respective interests as required in question 3, Section A, please use space below

OIL CONSERVATION COMMISSION		
ATTACHED TO NOT OFFICE		
PLAT NO.	3	
DATE		
SECTION		
TOWNSHIP		
RANGE		
U. S. G. S.	1	
Transported		
Filed	1	✓

* "Owner" means the person who has the right to drill into and to produce from any pool and to appropriate the production either for himself or for himself and another. (65-3-29 (e) NMSA 1953 Comp.)