

(SUBMIT IN TRIPLICATE)

UNITED STATES  
DEPARTMENT OF THE INTERIOR  
GEOLOGICAL SURVEY

Land Office Santa Fe  
Lease No. N.M. 013492  
Unit A. L. Duff

SUNDRY NOTICES AND REPORTS ON WELLS

NOTICE OF INTENTION TO DRILL.....	<input checked="" type="checkbox"/>	SUBSEQUENT REPORT OF WATER SHUT-OFF.....
NOTICE OF INTENTION TO CHANGE PLANS.....		SUBSEQUENT REPORT OF SHOOTING OR ACIDIZING.....
NOTICE OF INTENTION TO TEST WATER SHUT-OFF.....		SUBSEQUENT REPORT OF ALTERING CASING.....
NOTICE OF INTENTION TO RE-DRILL OR REPAIR WELL.....		SUBSEQUENT REPORT OF RE-DRILLING OR REPAIR.....
NOTICE OF INTENTION TO SHOOT OR ACIDIZE.....		SUBSEQUENT REPORT OF ABANDONMENT.....
NOTICE OF INTENTION TO PULL OR ALTER CASING.....		SUPPLEMENTARY WELL HISTORY.....
NOTICE OF INTENTION TO ABANDON WELL.....		

(INDICATE ABOVE BY CHECK MARK NATURE OF REPORT, NOTICE, OR OTHER DATA)

April 16, 1958

A. L. Duff  
Well No. 8 is located 1980 ft. from (N) line and 660 ft. from (E) line of sec. 19  
S/2-NE/4 26N 13W N.M.P.M.  
(1/4 Sec. and Sec. No.) (Twp.) (Range) (Meridian)  
Battle (Gallup) San Juan New Mexico  
(Field) (County or Subdivision) (State or Territory)

The elevation of the derrick floor above sea level is ..... ft.

DETAILS OF WORK

(State names of and expected depths to objective sands; show sizes, weights, and lengths of proposed casings; indicate mudding jobs, cementing points, and all other important proposed work)

It is our intention to drill Well No. 8 to an approximate depth of 5300' to test the Gallup formation. Our casing program is as follows:

250' of 10-3/4" OD casing, 32.75# BW H-40, cemented with 250 sacks cement, to be circulated.

5300' of 5-1/2" OD casing, 14#, SS J-55, cemented with 250 sacks cement.

The designated drilling unit is the S/2-NE/4 of Section 19-26N-13W, San Juan County, New Mexico.

I understand that this plan of work must receive approval in writing by the Geological Survey before operations may be commenced.

Company .....

Address .....

By (Signed) P. E. Gosper

Title District Superintendent

NEW MEXICO OIL CONSERVATION COMMISSION  
Well Location and Acreage Dedication Plat

Section A.

Date April 16, 1958

Operator SKELLY OIL COMPANY Lease A. L. DUFF  
Well No. 8 Unit Letter H Section 19 Township 26 NORTH Range 13 WEST NMPM  
Located 1980 Feet From THE NORTH Line, 660 Feet From THE EAST Line  
County SAN JUAN G. L. Elevation \_\_\_\_\_ Dedicated Acreage 80 Acres  
Name of Producing Formation Callup Pool Bisti 2XT

1. Is the Operator the only owner\* in the dedicated acreage outlined on the plat below?  
Yes X No \_\_\_\_\_.
2. If the answer to question one is "no," have the interests of all the owners been consolidated by communitization agreement or otherwise? Yes \_\_\_\_\_ No \_\_\_\_\_. If answer is "yes," Type of Consolidation \_\_\_\_\_
3. If the answer to question two is "no," list all the owners and their respective interests below:  
REF. GLO Plat dated: 19 July 1915

Owner

Land Description

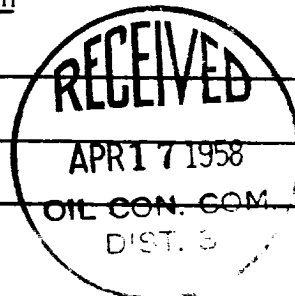

Section B

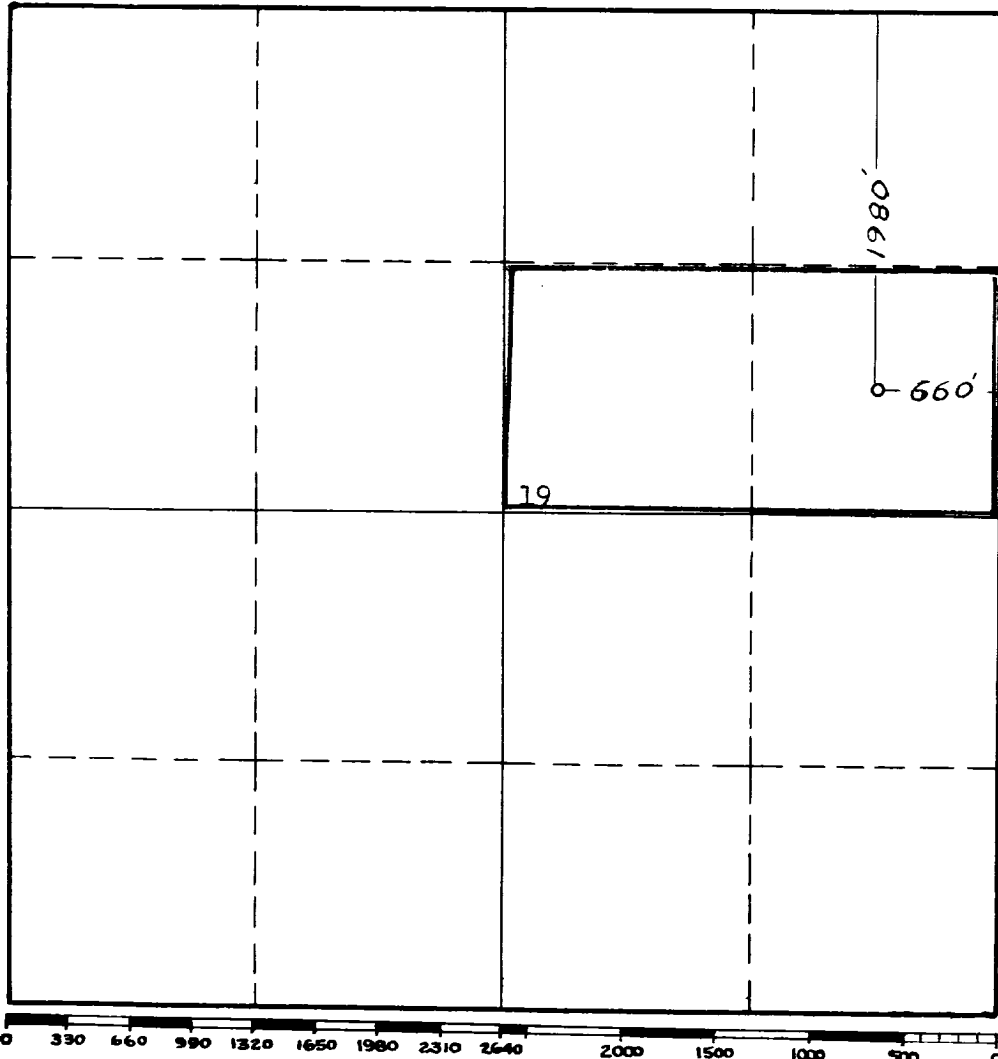

This is to certify that the information in Section A above is true and complete to the best of my knowledge and belief.

**SKELLY OIL COMPANY**

(Operator)

(Signed) P. E. Cosper

(Representative)

**Box 426, Farmington, New Mexico**

Address

This is to certify that the well location shown on the plat in Section B was plotted from field notes of actual surveys made by me or under my supervision and that the same is true and correct to the best of my knowledge and belief.

Date Surveyed 14 APRIL 1958

James P. Leese  
Registered Professional  
Engineer and/or Land Surveyor.

JAMES P. LEESE

Certificate No. 1463