

		X

(SUBMIT IN TRIPLICATE)

UNITED STATES  
DEPARTMENT OF THE INTERIOR  
GEOLOGICAL SURVEY

Land Office Santa Fe  
Lease No. SF-078899-A  
Unit Western Pool Unit

SUNDRY NOTICES AND REPORTS ON WELLS

NOTICE OF INTENTION TO DRILL	X	SUBSEQUENT REPORT OF WATER SHUT-OFF	RECEIVED MAR 20 1961 U. S. GEOLOGICAL SURVEY FARMINGTON, NEW MEXICO
NOTICE OF INTENTION TO CHANGE PLANS		SUBSEQUENT REPORT OF SHOOTING OR ACIDIZING	
NOTICE OF INTENTION TO TEST WATER SHUT-OFF		SUBSEQUENT REPORT OF ALTERING CASING	
NOTICE OF INTENTION TO RE-DRILL OR REPAIR WELL		SUBSEQUENT REPORT OF RE-DRILLING OR REPAIR	
NOTICE OF INTENTION TO SHOOT OR ACIDIZE		SUBSEQUENT REPORT OF ABANDONMENT	
NOTICE OF INTENTION TO PULL OR ALTER CASING		SUPPLEMENTARY WELL HISTORY	
NOTICE OF INTENTION TO ABANDON WELL			

(INDICATE ABOVE BY CHECK MARK NATURE OF REPORT, NOTICE, OR OTHER DATA)

VERBAL APPROVAL OBTAINED USGS MARCH 20, 1961.

March 20, 1961

Well No. 1-C is located 990 ft. from ~~S~~<sup>N</sup> line and 990 ft. from ~~S~~<sup>E</sup> line of sec. 20  
NE/4 NE/4 Section 20 26N 11W NMPM  
(1/4 Sec. and Sec. No.) (Twp.) (Range) (Meridian)  
Basin Dakota San Juan New Mexico  
(Field) (County or Subdivision) (State or Territory)

The elevation of the derrick floor above sea level is 6191 ft.

DETAILS OF WORK

(State names of and expected depths to objective sands; show sizes, weights, and lengths of proposed casings; indicate mudding jobs, cementing points, and all other important proposed work)

It is intended to drill a well through the Dakota Formation using rotary tools and mud circulation. Possible productive intervals will be perforated and sand/oil fractured. Estimated Total Depth 6180'.

Casing Program:

9-5/8" at 160' with 125 sacks cement circulated to surface  
5-1/2" at 6180' with 200 sacks cement.

The E/2 of Section 20 is dedicated to this well.

E/2 Section 20 SF-078899-A

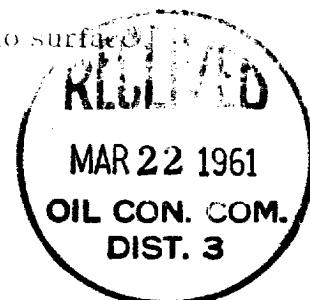

I understand that this plan of work must receive approval in writing by the Geological Survey before operations may be commenced.

Company El Paso Natural Gas Products Company  
Address Post Office Box 1560  
Farmington, New Mexico  
ORIGINAL SIGNED BY: JOSEPH E. KREGER  
By [Signature]  
Title Petroleum Engineer

## NEW MEXICO OIL CONSERVATION COMMISSION

## Well Location and Acreage Dedication Plat

## SECTION A.

Date **March 20, 1961**

Operator **El Paso Natural Gas Products Company** Lease **Western Pool Unit SF-078899-A**  
 Well No. **1-C** Unit Letter **A** Section **20** Township **26 North** Range **11 West** NMPM  
 Located **990** Feet From **North** Line, **990** Feet From **East** Line  
 County **San Juan** G. L. Elevation **6181** Dedicated Acreage **330** Acres  
 Name of Producing Formation **Dakota** Pool **Basin Dakota**

1. Is the Operator the only owner\* in the dedicated acreage outlined on the plat below? Yes \_\_\_\_\_ No **X**
2. If the answer to question One is "No," have the interests of all the owners been consolidated by communitization agreement or otherwise? Yes **X** No \_\_\_\_\_. If answer is "Yes," Type of Consolidation  
**Communitization Agreement**
3. If the answer to question Two is "No," list all the owners and their respective interests below:

OWNER

LAND DESCRIPTION

## SECTION B.

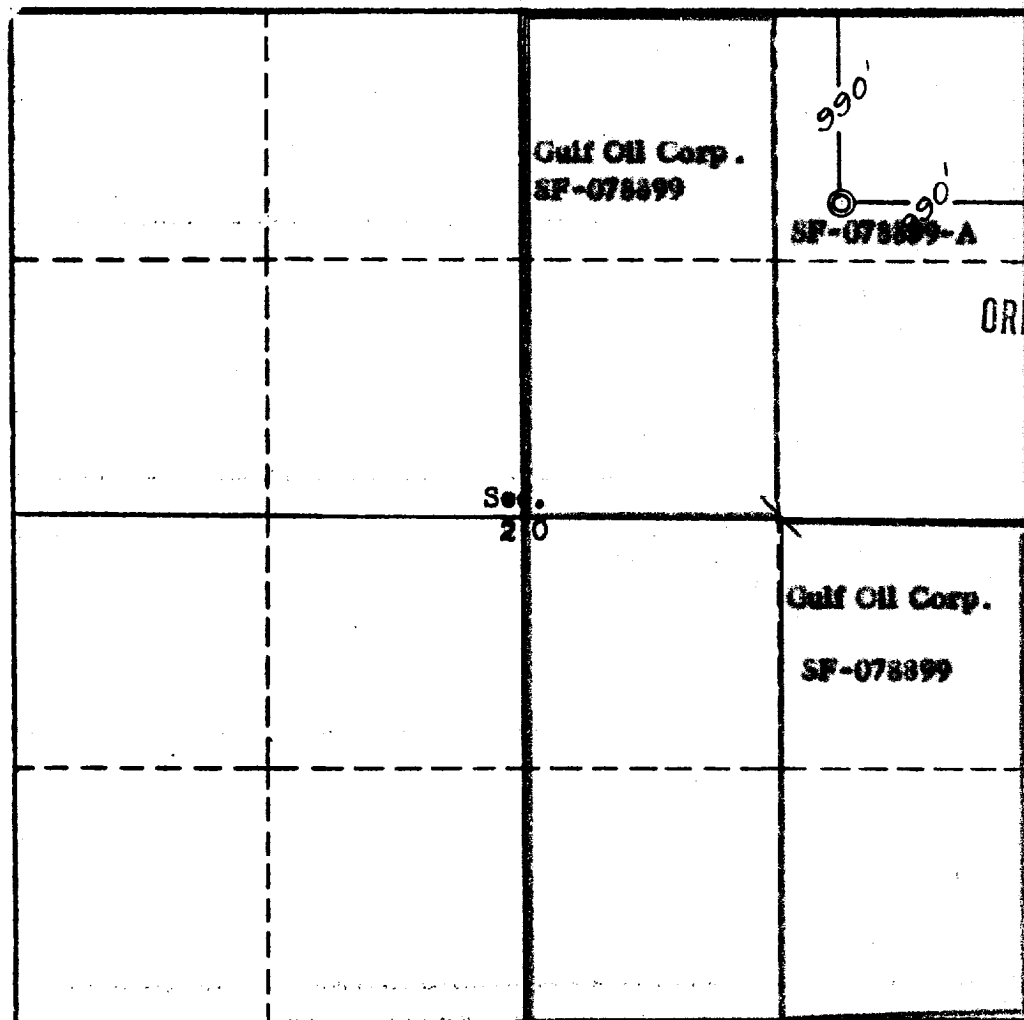

This is to certify that the information in Section A above is true and complete to the best of my knowledge and belief.

**El Paso Natural Gas Products Co.**

(OPERATOR)

ORIGINAL SIGNED BY: **JOSEPH E. KREGER**

(REPRESENTATIVE)

**Box 1560, Farmington, New Mexico**

(ADDRESS)

This is to certify that the well location shown on the plat in Section B was plotted from field notes and actual survey made by me and my supervisor and that the same is true and correct to the best of my knowledge and belief.

Date Surveyed **Mar. 15, 1961****Four States Engineering Co.**  
FARMINGTON, NEW MEXICO

**E. T. Eckel**  
REGISTERED ENGINEER OR  
LAND SURVEYOR

Certificate No. **1545**