

(SUBMIT IN TRIPLICATE)

Indian Agency Navajo

UNITED STATES  
DEPARTMENT OF THE INTERIOR  
GEOLOGICAL SURVEY

Allottee

Lease No. 14-20-603-2081

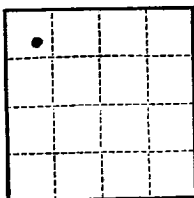

Sec. 2

SUNDRY NOTICES AND REPORTS ON WELLS

NOTICE OF INTENTION TO DRILL	<input checked="" type="checkbox"/>	SUBSEQUENT REPORT OF WATER SHUT-OFF	<b>RECEIVED</b> NOV 24 1958 U.S. GEOLOGICAL SURVEY FARMINGTON NEW MEXICO
NOTICE OF INTENTION TO CHANGE PLANS	<input type="checkbox"/>	SUBSEQUENT REPORT OF SHOOTING OR ACIDIZING	
NOTICE OF INTENTION TO TEST WATER SHUT-OFF	<input type="checkbox"/>	SUBSEQUENT REPORT OF ALTERING CASING	
NOTICE OF INTENTION TO REDRILL OR REPAIR WELL	<input type="checkbox"/>	SUBSEQUENT REPORT OF REDRILLING OR REPAIR	
NOTICE OF INTENTION TO SHOOT OR ACIDIZE	<input type="checkbox"/>	SUBSEQUENT REPORT OF ABANDONMENT	
NOTICE OF INTENTION TO PULL OR ALTER CASING	<input type="checkbox"/>	SUPPLEMENTARY WELL HISTORY	
NOTICE OF INTENTION TO ABANDON WELL	<input type="checkbox"/>		

(INDICATE ABOVE BY CHECK MARK NATURE OF REPORT, NOTICE, OR OTHER DATA)

November 21, 1958

Navajo Tribal 2  
Well No. 1 is located 926 ft. from N line and 811 ft. from W line of sec. 2  
NE/4, NE/4, Sec. 2 26 N 15 W R2N  
(1/4 Sec. and Sec. No.) (Twp.) (Range) (Meridian)  
Wildcat San Juan County New Mexico  
(Field) (County or Subdivision) (State or Territory)

The elevation of the derrick floor above sea level is \_\_\_\_\_ ft. Will report later

DETAILS OF WORK

(State names of and expected depths to objective sands; show sizes, weights, and lengths of proposed casings; indicate mudding jobs, cementing points, and all other important proposed work)

Notice is hereby given of intention to drill the Navajo Tribal #1. 9 5/8" surface casing will be set at approximately 300 feet and if the well is productive 5 1/2" casing will be set at total depth. It is estimated that the total depth of this well will be approximately 5000 feet.



I understand that this plan of work must receive approval in writing by the Geological Survey before operations may be commenced.

Company Standard Oil Company of Texas

Address Box 1581

Farmington, New Mexico

By

*[Signature]*

Title

Field Foreman

10-1-1

10-1-1

10-1-1

10-1-1

10-1-1

10-1-1

10-1-1

10-1-1

10-1-1

10-1-1

10-1-1

10-1-1

10-1-1



10-1-1

10-1-1

10-1-1

10-1-1

NEW MEXICO OIL CONSERVATION COMMISSION  
Well Location and Acreage Dedication Plat

Section A.

Date 11-21-58

Operator Standard Oil Co. of Texas Lease Navajo Tribal 2 (14-20-603-2081)  
Well No. 1 Unit Letter D Section 2 Township 26N Range 15W NMPM  
Located 926 Feet From North Line, 811 Feet From West Line  
County San Juan G. L. Elevation - Dedicated Acreage 40 Acres  
Name of Producing Formation Gallup Pool Wildcat

1. Is the Operator the only owner\* in the dedicated acreage outlined on the plat below?  
Yes X No       .
2. If the answer to question one is "no," have the interests of all the owners been consolidated by communitization agreement or otherwise? Yes        No       . If answer is "yes," Type of Consolidation
3. If the answer to question two is "no," list all the owners and their respective interests below:

Owner

Land Description

**RECEIVED**

NOV 24 1958

U. S. GEOLOGICAL SURVEY  
FARMINGTON, NEW MEXICO

Section B

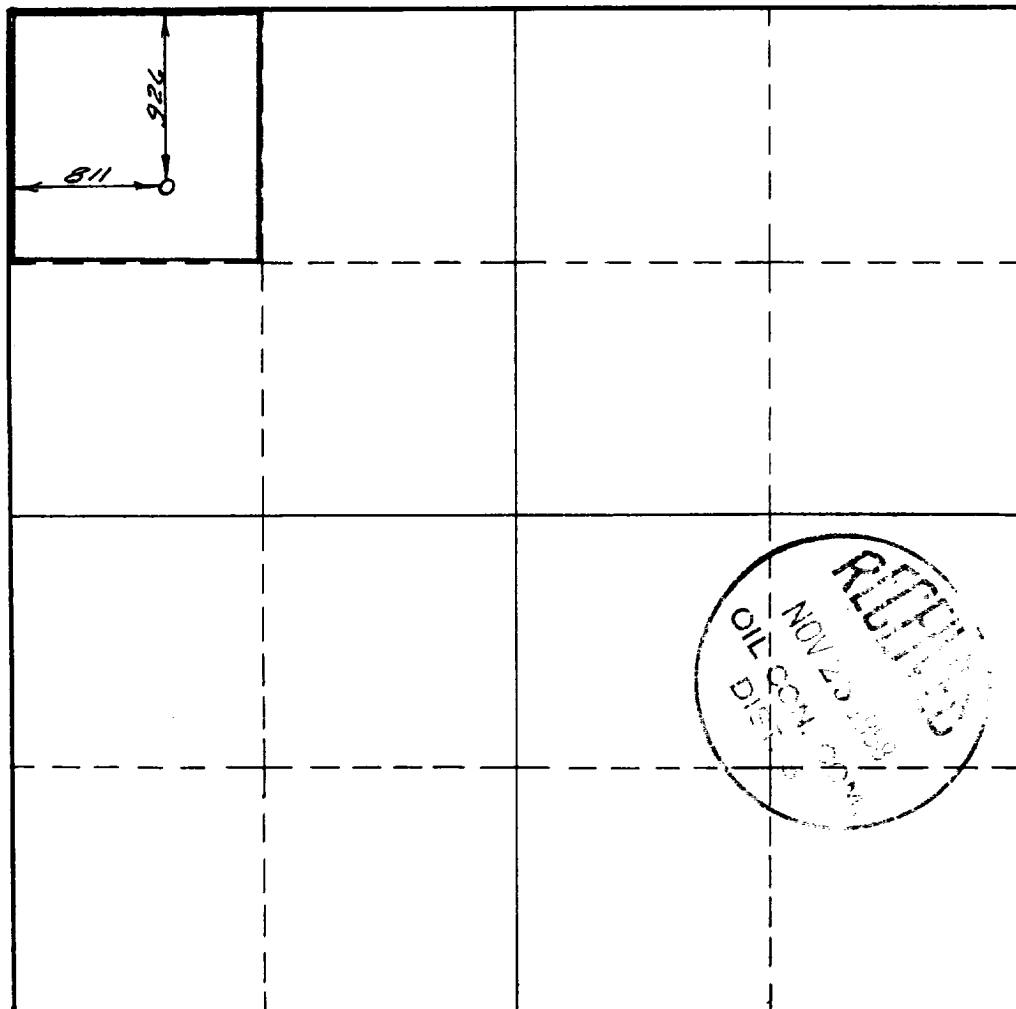

This is to certify that the information in Section A above is true and complete to the best of my knowledge and belief.

Standard Oil Co. of Texas  
(Operator)

W. L. Hart  
(Representative)

Box 1581, Farmington, N.M.  
Address

This is to certify that the well location shown on the plat in Section B was plotted from field notes of actual surveys made by me or under my supervision and that the same is true and correct to the best of my knowledge and belief.

Date Surveyed 11-20-58

Bern P. Simpson  
Registered Professional  
Engineer and/or Land Surveyor.

Certificate No. 13417

(See instructions for completing this form on the reverse side)

INSTRUCTIONS FOR COMPLETION:

1. Operator shall furnish and certify to the information called for in Section A.
2. Operator shall outline the dedicated acreage for both oil and gas wells on the plat in Section B.
3. A registered professional engineer or land surveyor registered in the State of New Mexico or approved by the Commission shall show on the plat the location of the well and certify this information in the space provided.
4. All distances shown on the plat must be from the outer boundaries of Section.
5. If additional space is needed for listing owners and their respective interests as required in question 3, Section A, please use space below

\* "Owner" means the person who has the right to drill into and to produce from any pool and to appropriate the production either for himself or for himself and another. (65-3-29 (e) NMSA 1953 Comp.)