

(SUBMIT IN TRIPLICATE)

 UNITED STATES
 DEPARTMENT OF THE INTERIOR
 GEOLOGICAL SURVEY
Land Office Santa FeLease No. NE 00044

Unit _____

SUNDRY NOTICES AND REPORTS ON WELLS

NOTICE OF INTENTION TO DRILL	<input checked="" type="checkbox"/>	SUBSEQUENT REPORT OF WATER SHUT-OFF	<input type="checkbox"/>
NOTICE OF INTENTION TO CHANGE PLANS	<input type="checkbox"/>	SUBSEQUENT REPORT OF SHOOTING OR ACIDIZING	<input type="checkbox"/>
NOTICE OF INTENTION TO TEST WATER SHUT-OFF	<input type="checkbox"/>	SUBSEQUENT REPORT OF ALTERING CASING	<input type="checkbox"/>
NOTICE OF INTENTION TO RE-DRILL OR REPAIR WELL	<input type="checkbox"/>	SUBSEQUENT REPORT OF RE-DRILLING OR REPAIR	<input type="checkbox"/>
NOTICE OF INTENTION TO SHOOT OR ACIDIZE	<input type="checkbox"/>	SUBSEQUENT REPORT OF ABANDONMENT	<input type="checkbox"/>
NOTICE OF INTENTION TO PULL OR ALTER CASING	<input type="checkbox"/>	SUPPLEMENTARY WELL HISTORY	<input type="checkbox"/>
NOTICE OF INTENTION TO ABANDON WELL	<input type="checkbox"/>		

(INDICATE ABOVE BY CHECK MARK NATURE OF REPORT, NOTICE, OR OTHER DATA)

July 1

 Well No. 42-2 is located 1350 ft. from N line and 1400 ft. from W line of sec. 9

<u>NE 1/4 Sec. 9</u> (1/4 Sec. and Sec. No.)	<u>27N</u> (Twp.)	<u>6W</u> (Range)	<u>R.M.P.M.</u> (Meridian)
<u>South House Pictured Cliff</u> (Field)	<u>San Juan</u> (County or Subdivision)	<u>New Mexico</u> (State or Territory)	

Ground Level

The elevation of the ~~datum~~ above sea level is 6000 ft.

DETAILS OF WORK

(State names of and expected depths to objective sands; show sizes, weights, and lengths of proposed casings; indicate mudding jobs, cementing points, and all other important proposed work)

It is proposed to drill with rotary tools to a depth of 150+ feet, set 9-5/8" casing and cement to surface with 100 sand, plus up-sink. It is then proposed to drill through the Pictured Cliff Formation, ~~re-sink~~ log and run 7" production casing. It is then proposed to run production 7" casing opposite the Pictured Cliff Formation and to stimulate the producing zone with a sandwater free. The proposed drilling unit is the NE 1/4 of Section 9 (150 acres)

I understand that this plan of work must receive approval in writing by the Geological Survey before operations may be commenced.

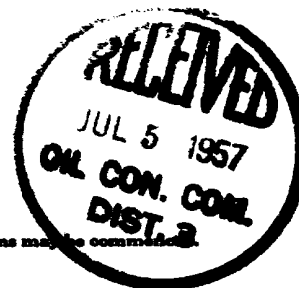
Company PERO FUELING CORPORATIONAddress P.O. Box 1410Albuquerque, New MexicoBy Frank D. Gahan, Jr.Title Vice President

0103 000 1 000 000

UNITED STATES
DEPARTMENT OF THE INTERIOR
BUREAU OF LAND MANAGEMENT

CONFIDENTIAL

[illegible]

2011-12-15

... ..

[illegible]

JAN 16 1960

1. The following information was obtained from the file:

RECEIVED 10 10 1964

Abstract: The authors describe the development of a new method for the determination of the concentration of the active substance in the plasma of patients with epilepsy. The method is based on the use of a new type of chromatographic column, which allows the separation of the active substance from the plasma components. The results of the study show that the method is highly sensitive and specific, and can be used for the determination of the concentration of the active substance in the plasma of patients with epilepsy.

1. The first group of people who are interested in the results of the study are the researchers themselves. They want to know how well the study was conducted and whether the results are reliable and valid. They also want to know how the study was funded and whether there were any conflicts of interest.

1. The first step in the process is to identify the problem or issue that needs to be addressed. This involves gathering information and understanding the context of the problem.

7. State of release of the ship, cargo and passengers at all places in North America.

[illegible]

100

4-11-68

1999, 2000, 2001, 2002, 2003, 2004, 2005, 2006, 2007, 2008, 2009, 2010, 2011, 2012, 2013, 2014, 2015, 2016, 2017, 2018, 2019, 2020, 2021, 2022, 2023, 2024, 2025, 2026, 2027, 2028, 2029, 2030, 2031, 2032, 2033, 2034, 2035, 2036, 2037, 2038, 2039, 2040, 2041, 2042, 2043, 2044, 2045, 2046, 2047, 2048, 2049, 2050, 2051, 2052, 2053, 2054, 2055, 2056, 2057, 2058, 2059, 2060, 2061, 2062, 2063, 2064, 2065, 2066, 2067, 2068, 2069, 2070, 2071, 2072, 2073, 2074, 2075, 2076, 2077, 2078, 2079, 2080, 2081, 2082, 2083, 2084, 2085, 2086, 2087, 2088, 2089, 2090, 2091, 2092, 2093, 2094, 2095, 2096, 2097, 2098, 2099, 2100, 2101, 2102, 2103, 2104, 2105, 2106, 2107, 2108, 2109, 2110, 2111, 2112, 2113, 2114, 2115, 2116, 2117, 2118, 2119, 2120, 2121, 2122, 2123, 2124, 2125, 2126, 2127, 2128, 2129, 2130, 2131, 2132, 2133, 2134, 2135, 2136, 2137, 2138, 2139, 2140, 2141, 2142, 2143, 2144, 2145, 2146, 2147, 2148, 2149, 2150, 2151, 2152, 2153, 2154, 2155, 2156, 2157, 2158, 2159, 2160, 2161, 2162, 2163, 2164, 2165, 2166, 2167, 2168, 2169, 2170, 2171, 2172, 2173, 2174, 2175, 2176, 2177, 2178, 2179, 2180, 2181, 2182, 2183, 2184, 2185, 2186, 2187, 2188, 2189, 2190, 2191, 2192, 2193, 2194, 2195, 2196, 2197, 2198, 2199, 2200, 2201, 2202, 2203, 2204, 2205, 2206, 2207, 2208, 2209, 2210, 2211, 2212, 2213, 2214, 2215, 2216, 2217, 2218, 2219, 2220, 2221, 2222, 2223, 2224, 2225, 2226, 2227, 2228, 2229, 2230, 2231, 2232, 2233, 2234, 2235, 2236, 2237, 2238, 2239, 2240, 2241, 2242, 2243, 2244, 2245, 2246, 2247, 2248, 2249, 2250, 2251, 2252, 2253, 2254, 2255, 2256, 2257, 2258, 2259, 2260, 2261, 2262, 2263, 2264, 2265, 2266, 2267, 2268, 2269, 2270, 2271, 2272, 2273, 2274, 2275, 2276, 2277, 2278, 2279, 2280, 2281, 2282, 2283, 2284, 2285, 2286, 2287, 2288, 2289, 2290, 2291, 2292, 2293, 2294, 2295, 2296, 2297, 2298, 2299, 2300, 2301, 2302, 2303, 2304, 2305, 2306, 2307, 2308, 2309, 2310, 2311, 2312, 2313, 2314, 2315, 2316, 2317, 2318, 2319, 2320, 2321, 2322, 2323, 2324, 2325, 2326, 2327, 2328, 2329, 2330, 2331, 2332, 2333, 2334, 2335, 2336, 2337, 2338, 2339, 2340, 2341, 2342, 2343, 2344, 2345, 2346, 2347, 2348, 2349, 2350, 2351, 2352, 2353, 2354, 2355, 2356, 2357, 2358, 2359, 2360, 2361, 2362, 2363, 2364, 2365, 2366, 2367, 2368, 2369, 2370, 2371, 2372, 2373, 2374, 2375, 2376, 2377, 2378, 2379, 2380, 2381, 2382, 2383, 2384, 2385, 2386, 2387, 2388, 2389, 2390, 2391, 2392, 2393, 2394, 2395, 2396, 2397, 2398, 2399, 2400, 2401, 2402, 2403, 2404, 2405, 2406, 2407, 2408, 2409, 2410, 2411, 2412, 2413, 2414, 2415, 2416, 2417, 2418, 2419, 2420, 2421, 2422, 2423, 2424, 2425, 2426, 2427, 2428, 2429, 2430, 2431, 2432, 2433, 2434, 2435, 2436, 2437, 2438, 2439, 2440, 2441, 2442, 2443, 2444, 2445, 2446, 2447, 2448, 2449, 2450, 2451, 2452, 2453, 2454, 2455, 2456, 2457, 2458, 2459, 2460, 2461, 2462, 2463, 2464, 2465, 2466, 2467, 2468, 2469, 2470, 2471, 2472, 2473, 2474, 2475, 2476, 2477, 2478, 2479, 2480, 2481, 2482, 2483, 2484, 2485, 2486, 2487, 2488, 2489, 2490, 2491, 2492, 2493, 2494, 2495, 2496, 2497, 2498, 2499, 2500, 2501, 2502, 2503, 2504, 2505, 2506, 2507, 2508, 2509, 2510, 2511, 2512, 2513, 2514, 2515, 2516, 2517, 2518, 2519, 2520, 2521, 2522, 2523, 2524, 2525, 2526, 2527, 2528, 2529, 2530, 2531, 2532, 2533, 2534, 2535, 2536, 2537, 2538, 2539, 2540, 2541, 2542, 2543, 2544, 2545, 2546, 2547, 2548, 2549, 2550, 2551, 2552, 2553, 2554, 2555, 2556, 2557, 2558, 2559, 2560, 2561, 2562, 2563, 2564, 2565, 2566, 2567, 2568, 2569, 2570, 2571, 2572, 2573, 2574, 2575, 2576, 2577, 2578, 2579, 2580, 2581, 2582, 2583, 2584, 2585, 2586, 2587, 2588, 2589, 2590, 2591, 2592, 2593, 2594, 2595, 2596, 2597, 2598, 2599, 2600, 2601, 2602, 2603, 2604, 2605, 2606, 2607, 2608, 2609, 2610, 2611, 2612, 2613, 2614, 2615, 2616, 2617, 2618, 2619, 2620, 2621, 2622, 2623, 2624, 2625, 2626, 2627, 2628, 2629, 2630, 2631, 2632, 2633, 2634, 2635, 2636, 2637, 2638, 2639, 2640, 2641, 2642, 2643, 2644, 2645, 2646, 2647, 2648, 2649, 2650, 2651, 2652, 2653, 2654, 2655, 2656, 2657, 2658, 2659, 2660, 2661, 2662, 2663, 2664, 2665, 2666, 2667, 2668, 2669, 2670, 2671, 2672, 2673, 2674, 2675, 2676, 2677, 2678, 2679, 2680, 26

NO 100

[illegible]

CONFIDENTIAL

10. The Commission has been informed that the Government of the Republic of the Philippines has agreed to accept the findings and recommendations of the Commission.

NEW MEXICO
OIL CONSERVATION COMMISSION

Form C-128

Well Location and/or Gas Proration Plat

Date July 1, 1957

Operator PUBCO PETROLEUM CO. Lease PUBCO FEDERAL

Well No. #9-2 Section 9 Township 27 N Range 8 W NMPM

Located 1740 Feet From north Line, 1480 Feet From west Line,

San Juan County, New Mexico. G. L. Elevation 6024

Name of Producing Formation Pictured Cliff Pool South Blanco Dedicated Acreage N $\frac{1}{4}$ (160 ac)

(Note: All distances must be from outer boundaries of Section)

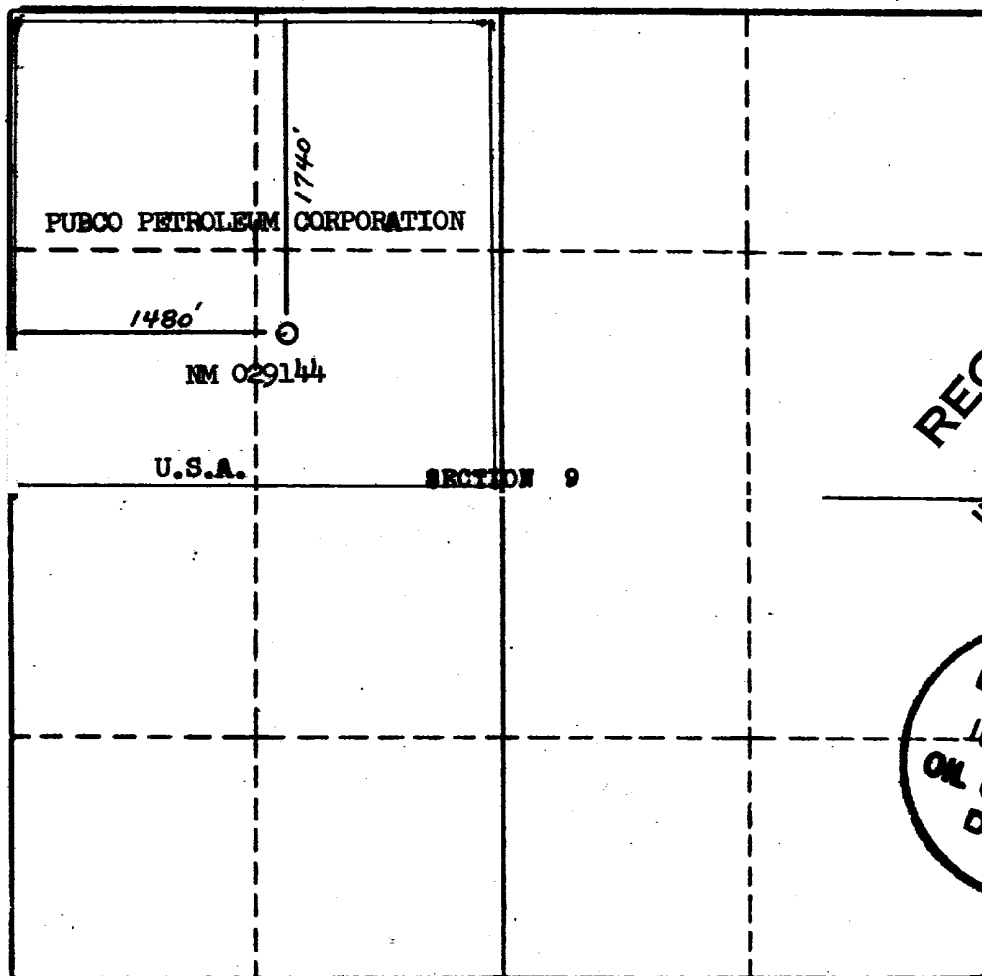

Scale—1 Inch Equals 1000 Feet

1. Is this Well a Dual Comp.? Yes..... No. X
2. If the answer to Question 1 is yes, are there any other dually completed wells within the dedicated acreage? Yes..... No.....

Name Frank D. Gorman, Jr.
Position Vice President
Representing Pubco Petroleum Corporation
Address Box 1419, Albuquerque, New Mexico

This is to certify that the above plat was prepared from field notes of actual surveys made by me under my supervision and that the same are true and correct to the best of my knowledge and belief.

Date Surveyed April 12, 1957

Stephen H. Kinney
STEPHEN H. KINNEY,
Registered Professional Engineer and Land Surveyor

RECEIVED
JUL 3 1957
U.S. GEOLOGICAL SURVEY
FARMINGTON, NEW MEXICO

RECEIVED
JUL 5 1957
OIL CON. COM.
DIST. 3