



Southern

Rockies

Business

Unit

May 8, 1996

Mr. William J. LeMay, Director
New Mexico Oil Conservation Division
2040 S. Pacheco Street
P. O. Box 6429
Santa Fe, NM 87505

**Application for Exception to Rule 303-C - Downhole Commingling
Schwerdtfeger A #5 Well
Unit O Section 6-T27N-R8W
Blanco Mesaverde, Otero Chacra and Basin Dakota Pools
San Juan County, New Mexico**

RECEIVED
MAY 20 1996
OIL CON. DIV.
DIST. 3

Enclosed please find an administrative application form (C-107-A) and attachments for downhole commingling for the captioned well. By copy of this application by certified mail, return receipt requested, Amoco is notifying all offset operators in the formations captioned above as well as all affected interest owners if the ownership of those formations is not common. The Division Director may approve the proposed downhole commingling in the absence of a valid objection from any offset operator or any interest owner in those instances where ownership is not common in the zones to be commingled within 20 days after the receipt of the application if, in his opinion, waste will not result thereby, and correlative rights will not be violated.

Should there be questions concerning this matter, please contact me at (303) 830-5344.

Sincerely,

Pamela W. Staley

Enclosures

cc: Mark Rothenberg
Patty Haeefe
Wellfile
Proration File
Frank Chavez, Supervisor
NMOCD District III
1000 Rio Brazos Road
Aztec, NM 87410

Duane Spencer
Bureau of Land Management
1235 La Plata Hwy.
Farmington, NM 87401

DISTRICT II
811 South First St., Artesia, NM 88210-2835

DISTRICT III
1000 Rio Brazos Rd. Aztec, NM 87410-1593

OIL CONSERVATION DIVISION

2040 S. Pacheco
Santa Fe, New Mexico 87505-6429

APPROVAL PROCESS:

☒ Administrative ☐ Hearing

EXISTING WELLBORE
☒ YES ☐ NO

APPLICATION FOR DOWNHOLE COMMINGLING

Amoco Production Company

P.O. Box 800 Denver, CO 80201

Operator Schwerdtfeger A	5	Address O-6-27N-8W	San Juan
Lease	Well No.	Unit Ltr. - Sec Twp - Rge	County

Spacing Unit Lease Types (check 1 or more)

OGRID NO 000778 Property Code 001031 API NO. 3004511888 Federal ☒ State ☐ (and/or) Fee ☐

The following facts are submitted in support of downhole commingling	Upper Zone	Intermediate Zone	Lower Zone
1. Pool Name and Pool Code	OTERO CHACRA 82329	BLANCO MESAVERDE 72319	BASIN DAKOTA 71599
2. Top and Bottom of Pay Section (Perforations)	3868' - 3895'	4920' - 5526'	7303' - 7493'
3. Type of production (Oil or Gas)	GAS	GAS	GAS
4. Method of Production (Flowing or Artificial Lift)	FLOWING	FLOWING	FLOWING
5. Bottomhole Pressure Oil Zones - Artificial Lift Gas & Oil - Flowing All Gas Zones Estimated Current Measured Current Estimated or Measured Original	a (Current) 520 PSI (EST)	a 595 PSI (EST)	a 467 PSI
	b (Original) 1021 PSI (EST)	b 1226 PSI (EST)	b 2503 PSI
6. Oil Gravity (° API) or Gas BTU Content	1150 BTU	1190 BTU / 49 DEG API	1186 BTU / 59 DEG API
7. Producing or Shut-In?	PRODUCING	PRODUCING	PRODUCING
Production Marginal? (yes or no)	YES	YES	YES
• If Shut-In, give data and oil/gas/water rates of last production Note: For new zones with no production history, applicant shall be required to attach production estimates and supporting data. • If Producing, give date and oil/gas/water rates of recent test (within 60 days)	Date: Rates	Date: Rates	Date: Rates
	(EST) 22 MCFD 0 BCPD 0 BWPD	(EST) 52 MCFD 0.5 BCPD 0 BWPD	4/96 70 MCFD 2.0 BCPD 0 BWPD
8. Fixed Percentage Allocation Formula -% for each zone	Oil 0 % Gas 15 %	Oil 20 % Gas 36 %	Oil 80 % Gas 49 %

9. If allocation formula is based upon something other than current or past production, or is based upon some other method, submit attachments with supporting data and/or explaining method and providing rate projections or other required data.
10. Are all working, overriding, and royalty interests identical in all commingled zones? ☒ Yes ☐ No
If not, have all working, overriding, and royalty interests been notified by certified mail? ☐ Yes ☐ No
Have all offset operators been given written notice of the proposed downhole commingling? ☒ Yes ☐ No
11. Will cross-flow occur? ☐ Yes ☒ No If yes, are fluids compatible, will the formations not be damaged, will any cross-flowed production be recovered, and will the allocation formula be reliable. ☐ Yes ☐ No (If No, attach explanation)
12. Are all produced fluids from all commingled zones compatible with each other? ☒ Yes ☐ No
13. Will the value of production be decreased by commingling? ☐ Yes ☒ No (If Yes, attach explanation)
14. If this well is on, or communized with, state or federal lands, either the Commissioner of Public Lands or the United States Bureau of Land Management has been notified in writing of this application. ☒ Yes ☐ No SF-079319
15. NMOC Reference Cases for Rule 303(D) Exceptions: ORDER NO(S) _____
16. ATTACHMENTS:
- C-102 for each zone to be commingled showing its spacing unit and acreage dedication.
 - Production curve for each zone for at least one year. (If not available, attach explanation.)
 - For zones with no production history, estimated production rates and supporting data.
 - Data to support allocation method or formula.
 - Notification list of all offset operators.
 - Notification list of working, overriding, and royalty interests for uncommon interest cases.
 - Any additional statements, data, or documents required to support commingling.

I hereby certify that the information above is true and complete to the best of my knowledge and belief.

SIGNATURE Pamela W. Staley TITLE REGULATORY AFFAIRS REP DATE 5/7/96
TYPE OR PRINT NAME PAMELA W. STALEY TELEPHONE NO. (303) 830-5344

District I
PO Box 10, Hobbs, NM 88241-1980
District II
811 South First, Artesia, NM 88210
District III
1000 Rio Brazos Rd., Aztec, NM 87410
District IV
2040 South Pacheco, Santa Fe, NM 87505

State of New Mexico
Energy, Minerals & Natural Resources Department

Form C-102
Revised October 18, 1994
Instructions on back
Submit to Appropriate District Office
State Lease - 4 Copies
Fee Lease - 3 Copies

OIL CONSERVATION DIVISION
2040 South Pacheco
Santa Fe, NM 87505

RECEIVED
MAIL ROOM
56 FEB 20 PM 1:18

☐ AMENDED REPORT

WELL LOCATION AND ACREAGE DEDICATION PLAT

1 API Number 3004511888		2 Pool Code 82329		3 Pool Name Otero Chacara	
4 Property Code 1031	5 Property Name Schwerdtfeger A			6 Well Number 5	
7 OGRID No. 000778	8 Operator Name Amoco Production Company			9 Elevation 6760'	

10 Surface Location

UL or lot no.	Section	Township	Range	Lot Idn	Feet from the	North/South line	Feet from the	East/West line	County
(1)	6	27N	8W		1190	South	1530	East	San Juan

11 Bottom Hole Location If Different From Surface

UL or lot no.	Section	Township	Range	Lot Idn	Feet from the	North/South line	Feet from the	East/West line	County
12 Dedicated Acres 160		13 Joint or Infill		14 Consolidation Code		15 Order No.			

NO ALLOWABLE WILL BE ASSIGNED TO THIS COMPLETION UNTIL ALL INTERESTS HAVE BEEN CONSOLIDATED
OR A NON-STANDARD UNIT HAS BEEN APPROVED BY THE DIVISION

16					17 OPERATOR CERTIFICATION I hereby certify that the information contained herein is true and complete to the best of my knowledge and belief. Signature <u>Patty Haebele</u> Printed Name <u>Patty Haebele</u> Title <u>Staff Assistant</u> Date <u>2/8/96</u>
					18 SURVEYOR CERTIFICATION I hereby certify that the well location shown on this plat was plotted from field notes of actual surveys made by me or under my supervision, and that the same is true and correct to the best of my belief. <u>12-3-95</u> Date of Survey Signature and Seal of Professional Surveyor: on file <u>2463</u> Certificate Number

District I
PO Box 1980, Hobbs, NM 88241-1980
District II
811 South First, Artesia, NM 88210
District III
1000 Rio Grande Rd., Aztec, NM 87410
District IV
2040 South Pacheco, Santa Fe, NM 87505

State of New Mexico
Energy, Minerals & Natural Resources Department

OIL CONSERVATION DIVISION
2040 South Pacheco
Santa Fe, NM 87505

Form C-102
Revised October 18, 1994
Instructions on back
Submit to Appropriate District Office
State Lease - 4 Copies
Fee Lease - 3 Copies

96 FEB 20 PM 1:18

☐ AMENDED REPORT

WELL LOCATION AND ACREAGE DEDICATION PLAT

API Number 3004511888	Pool Code 72319	Pool Name Blanco Mesaverde
Property Code 1031	Property Name Schwerdtfeger A	Well Number 5
OGRID No. 000778	Operator Name Amoco Production Company	Elevation 6760'

10 Surface Location

UL or lot no.	Section	Township	Range	Lot Idn	Feet from the	North/South line	Feet from the	East/West line	County
0	6	27N	8W		1190	South	1530	East	San Juan

11 Bottom Hole Location If Different From Surface

UL or lot no.	Section	Township	Range	Lot Idn	Feet from the	North/South line	Feet from the	East/West line	County

Dedicated Acres 320.08	Joint or Infill	Consolidation Code	Order No.
---------------------------	-----------------	--------------------	-----------

NO ALLOWABLE WILL BE ASSIGNED TO THIS COMPLETION UNTIL ALL INTERESTS HAVE BEEN CONSOLIDATED
OR A NON-STANDARD UNIT HAS BEEN APPROVED BY THE DIVISION

16									

17 OPERATOR CERTIFICATION

I hereby certify that the information contained herein is true and complete to the best of my knowledge and belief.

Signature Patty Haefele
Patty Haefele

Printed Name
Staff Assistant

Title

Date 2/8/96

18 SURVEYOR CERTIFICATION

I hereby certify that the well location shown on this plat was plotted from field notes of actual surveys made by me or under my supervision, and that the same is true and correct to the best of my belief.

12-3-65

Date of Survey

Signature and Seal of Professional Surveyor:

on file

Certificate Number 2463

NEW MEXICO OIL CONSERVATION COMMISSION
WELL LOCATION AND ACREAGE DEDICATION AT

Form 1-17
Supersedes C-128
Effective 4-1-61

All distances must be from the outer boundaries of the Section

Operator TENNECO OIL COMPANY		Lease SCHWERDTFEGGER "A"		Well No. 5
Unit Letter Xp 0	Section 6	Range 27 North	Range 8 West	County San Juan
Actual Footage Location of Well:				
1190	feet from the South	1530	feet from the East	Line
Ground Level Elev. 6760 ungraded	Producing Formation Basin Dakota	Pool Basin Dakota	Dedicated Acreage: E/2 3/4 Acres	

- Outline the acreage dedicated to the subject well by colored pencil or hachure marks on the plat below. **320.84**
- If more than one lease is dedicated to the well, outline each and identify the ownership thereof (both as to working interest and royalty).
- If more than one lease of different ownership is dedicated to the well, have the interests of all owners been consolidated by communitization, unitization, force-pooling, etc?

☐ Yes ☐ No If answer is "yes," type of consolidation _____

If answer is "no," list the owners and tract descriptions which have actually been consolidated. (Use reverse side of this form if necessary.) _____

No allowable will be assigned to the well until all interests have been consolidated (by communitization, unitization, forced-pooling, or otherwise) or until a non-standard unit, eliminating such interests, has been approved by the Commission.

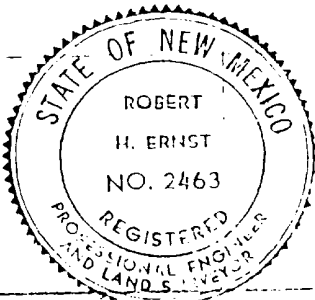
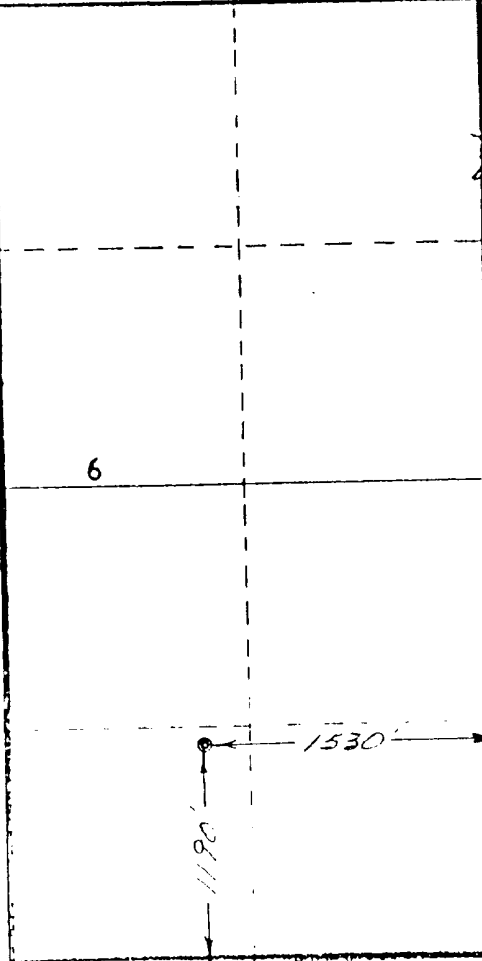
		Section 6	
			
			

CERTIFICATION

I hereby certify that the information contained herein is true and complete to the best of my knowledge and belief.

Harold C. Nichols

Name **Harold C. Nichols**
Position **Sr. Production Clerk**
Company **Tenneco Oil Company**
Date **December 6, 1965**

I hereby certify that the well location shown on this plat was plotted from field notes of actual surveys made by me or under my supervision, and that the same is true and correct to the best of my knowledge and belief.

3 December 1965

Robert H. Ernst
ROBERT H. ERNST

P. Reg. No. 2463

SCHWERTFEGER A 5

Operator- AMOCO PRODUCTION CO

300451188800DK

0062708-005 DK

APC_WI - 1.0000000

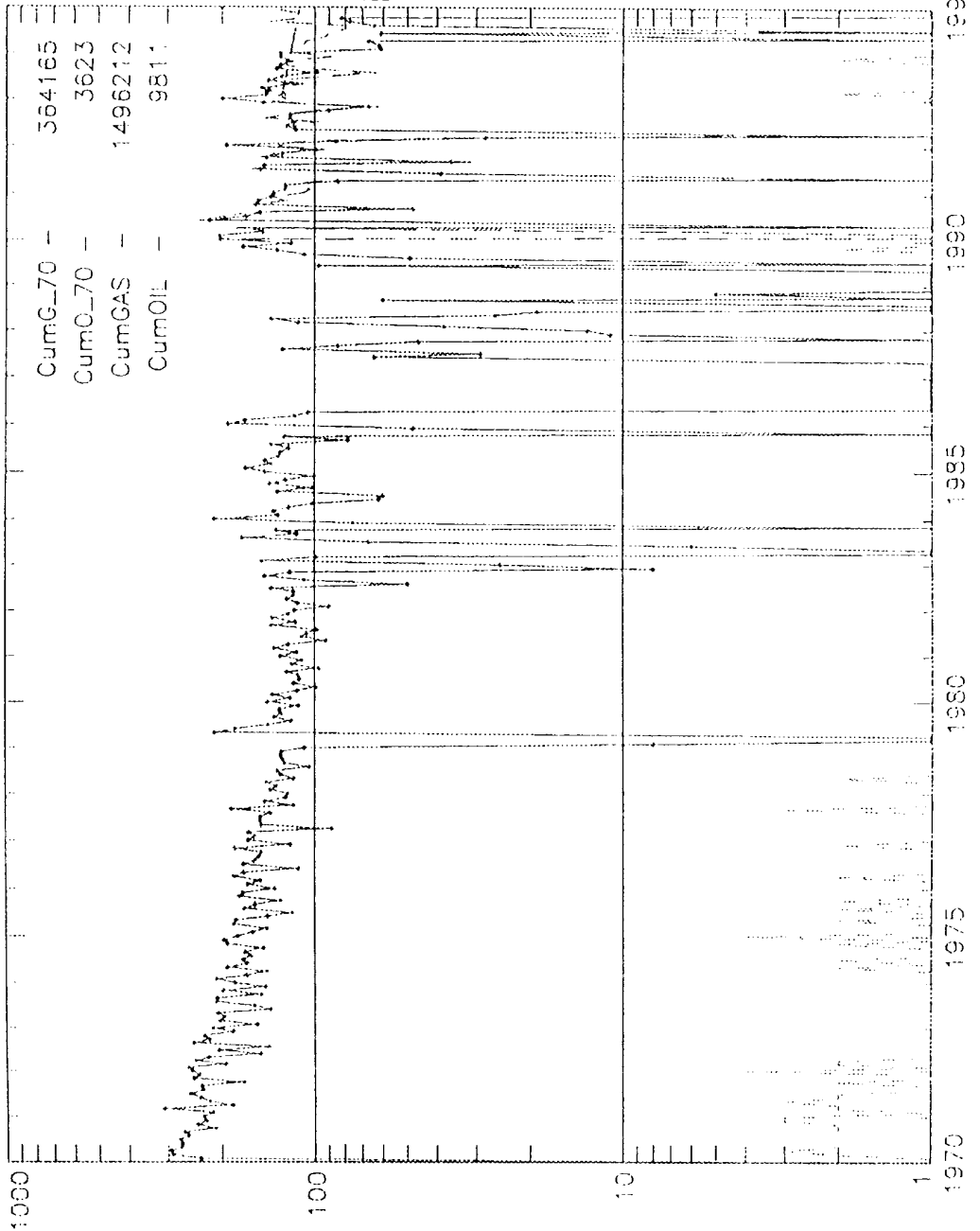

OFFSET WELLS USED TO ESTIMATE PRODUCTION ALLOCATIONS

MESAVERDE OFFSETS

Schwerdtfeger A LS #11	G-6-27-8	37 MCFD	0.5 BOPD
Schwerdtfeger A LS #12	N-6-27-8	67 MCFD	0.5 BOPD
Average		52 MCFD	0.5 BOPD

CHACRA OFFSETS

Blanco #25	E-12-27-9	34 MCFD	0 BOPD
Schwerdtfeger A LS A1	C-36-28-9	10 MCFD	0 BOPD
Average		22 MCFD	0 BOPD

OFFSET OPERATORS

Schwerdtfeger A5

Meridian Oil, Inc.

P.O. Box 4289

Farmington, NM 87499