

(SUBMIT IN TRIPLICATE)

UNITED STATES
DEPARTMENT OF THE INTERIOR
GEOLOGICAL SURVEY

Land Office Santa Fe

Lease No. 078430

Unit _____

SUNDRY NOTICES AND REPORTS ON WELLS

NOTICE OF INTENTION TO DRILL.....	<input checked="" type="checkbox"/>	SUBSEQUENT REPORT OF WATER SHUT-OFF.....	
NOTICE OF INTENTION TO CHANGE PLANS.....		SUBSEQUENT REPORT OF SHOOTING OR ACIDIZING.....	
NOTICE OF INTENTION TO TEST WATER SHUT-OFF.....		SUBSEQUENT REPORT OF ALTERING CASING.....	
NOTICE OF INTENTION TO RE-DRILL OR REPAIR WELL.....		SUBSEQUENT REPORT OF RE-DRILLING OR REPAIR.....	
NOTICE OF INTENTION TO SHOOT OR ACIDIZE.....		SUBSEQUENT REPORT OF ABANDONMENT.....	
NOTICE OF INTENTION TO PULL OR ALTER CASING.....		SUPPLEMENTARY WELL HISTORY.....	
NOTICE OF INTENTION TO ABANDON WELL.....			

(INDICATE ABOVE BY CHECK MARK NATURE OF REPORT, NOTICE, OR OTHER DATA)

MAR 10 1961

Consolidated-Hale
Well No. 2-15 is located 990 ft. from N line and 1650 ft. from W line of sec. 15.

SW - NE - NW of 15 26N 8W N.M.P.M.
(1/4 Sec. and Sec. No.) (Twp.) (Range) (Meridian)

Basin - Dakota San Juan New Mexico
(Field) (County or Subdivision) (State or Territory)

The elevation of the ~~surface~~ ^{ground} above sea level is 7060 ft.

DETAILS OF WORK

(State names of and expected depths to objective sands; show sizes, weights, and lengths of proposed casings; indicate mudding jobs, cementing points, and all other important proposed work)

1. Drill 15" hole with rotary and set and cement 9 5/8" casing. @ 200'
2. Drill 8 3/4" hole thru Dakota @ about 7300' T.D.
3. Run 5 1/2" casing to T.D. and cement opposite Dakota and Pictured Cliffs.
4. Selectively frac and dually complete in Pictured Cliffs and Dakota.
5. Rotary method with mud circulation will be utilized.

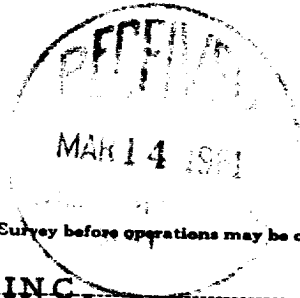

I understand that this plan of work must receive approval in writing by the Geological Survey before operations may be commenced.

Company CONSOLIDATED OIL & GAS, INC.

Address Suite 2112 Tower Building

1700 Broadway

Denver 2, Colorado

By J. B. Ladd
Title Vice President

NUMBER OF COPIES RECEIVED	
DISTRIBUTION	
SANTA FE	
FILE	
U.S.G.S.	
LAND OFFICE	
TRANSPORTER	OIL
	GAS
PRORATOR OFFICE	
OPERATOR	

NEW MEXICO OIL CONSERVATION COMMISSION
WELL LOCATION AND ACREAGE DEDICATION PLAT
 SEE INSTRUCTIONS FOR COMPLETING THIS FORM ON THE REVERSE SIDE

FORM C-128
 Revised 5/1/57

SECTION A					
Operator CONSOLIDATED OIL AND GAS, INC.			Lease Consolidated - Hale		Well No. 3-15
Unit Letter C	Section 25	Township 26 NORTH	Range 8 WEST	County SAN JUAN	
Actual Footage Location of Well: 990 feet from the NORTH line and 1650 feet from the WEST line					
Ground Level Elev. 7060.0	Producing Formation Pic. Cliffs - Dakota		Pool Basin Dakota		Dedicated Acreage: 320 Acres

Ref: GLO plat dated 1956

1. Is the Operator the only owner in the dedicated acreage outlined on the plat below? YES NO . ("Owner" means the person who has the right to drill into and to produce from any pool and to appropriate the production either for himself or for himself and another. (65-3-29 (e) NMSA 1935 Comp.)
2. If the answer to question one is "no," have the interests of all the owners been consolidated by communitization agreement or otherwise? YES NO . If answer is "yes," Type of Consolidation _____
3. If the answer to question two is "no," list all the owners and their respective interests below:

Owner	Land Description

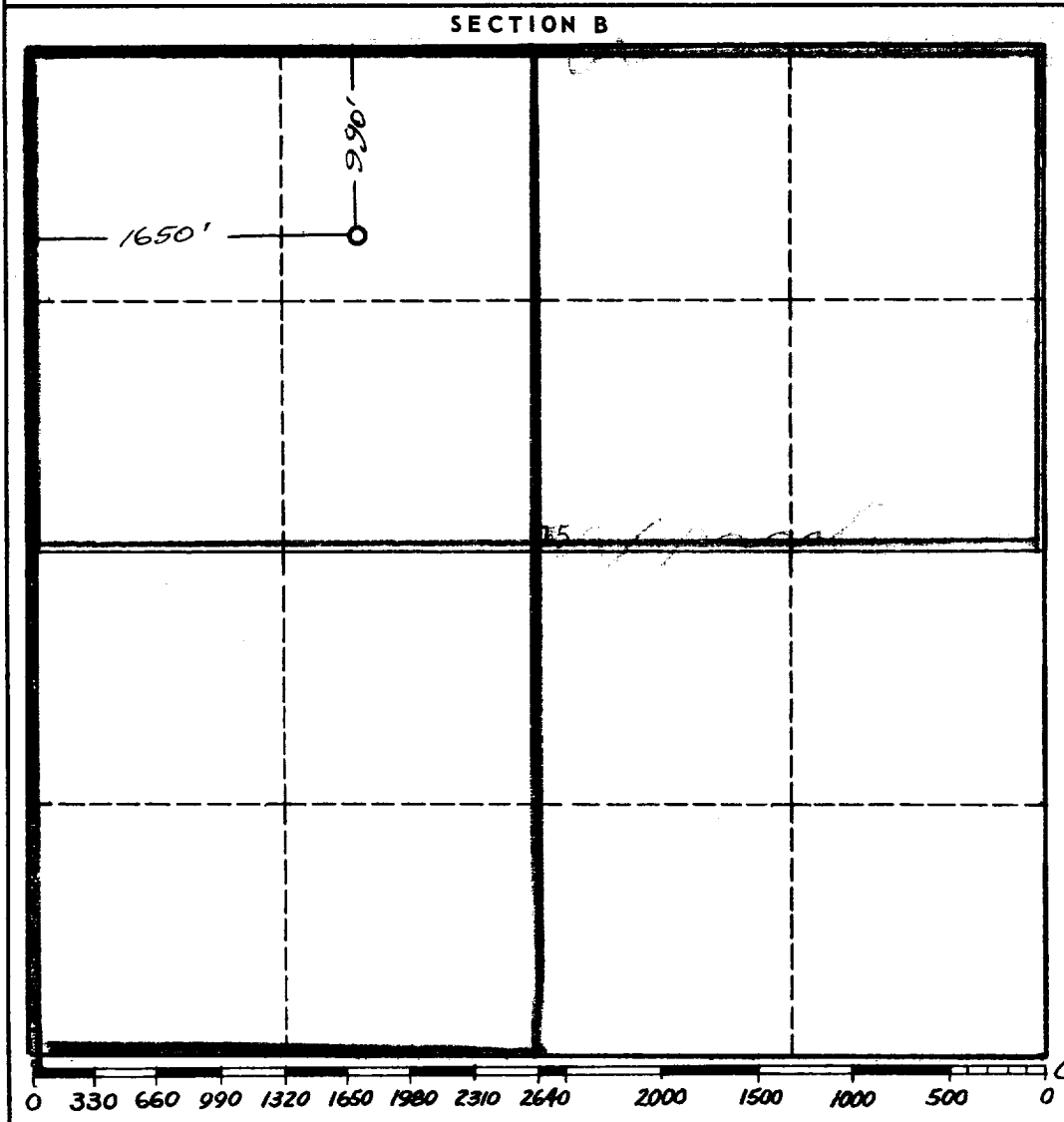
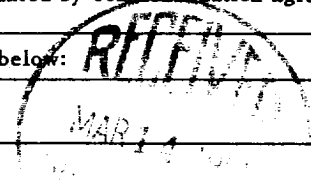

CERTIFICATION

I hereby certify that the information in SECTION A above is true and complete to the best of my knowledge and belief.

Name	J. B. Ladd
Position	Vice President
Company	Consolidated Oil & Gas, Inc.
Date	March , 1961

I hereby certify that the well location shown on the plat in SECTION B was plotted from field notes of actual surveys made by me or under my supervision, and that the same is true and correct to the best of my knowledge and belief.

Date Surveyed	25 February 1961
Registered Professional Engineer and/or Land Surveyor	<i>James P. Leese</i> James P. Leese
Certificate No.	1463

INSTRUCTIONS FOR COMPLETION OF FORM C-128

1. Operator shall furnish and certify to the information called for in Section A.
2. Operator shall outline the dedicated acreage for *both* oil and gas wells on the plat in Section B.
3. A registered professional engineer or land surveyor registered in the State of New Mexico or approved by the Commission shall show on the plat the location of the well and certify this information in the space provided.
4. All distances shown on the plat must be from the outer boundaries of the Section.
5. If additional space is needed for listing owners and their respective interests as required in question 3 of Section A, please use space below.