

NO. OF COPIES RECEIVED	7
DISTRIBUTION	
SANTA FE	1
FILE	1
U.S.G.S.	2
LAND OFFICE	1
OPERATOR	2

NEW MEXICO OIL CONSERVATION COMMISSION

30-045-22790
Form C-101
Revised 1-1-65

5A. Indicate Type of Lease	
STATE <input checked="" type="checkbox"/>	FEE <input type="checkbox"/>
5. State Oil & Gas Lease No.	
E 3148 - 7	

APPLICATION FOR PERMIT TO DRILL, DEEPEN, OR PLUG BACK

1a. Type of Work		7. Unit Agreement Name	
b. Type of Well DRILL <input checked="" type="checkbox"/> DEEPEN <input type="checkbox"/> PLUG BACK <input type="checkbox"/>		8. Farm or Lease Name	
OIL WELL <input type="checkbox"/> GAS WELL <input checked="" type="checkbox"/> OTHER <input type="checkbox"/>		Chaco Wash	
2. Name of Operator		9. Well No.	
Hixon Development Company		1	
3. Address of Operator		10. Field and Pool, or Wildcat	
P. O. Box 2810, Farmington, New Mexico		NIPP - PC ext ✓	
4. Location of Well		12. County	
UNIT LETTER O LOCATED 790 FEET FROM THE South LINE		San Juan	
AND 1850 FEET FROM THE East LINE OF SEC. 32 TWP. 26N RGE. 12W NMPM			
19. Proposed Depth		19A. Formation	20. Rotary or C.T.
1275'		Pictured Cliffs	Rotary
21. Elevations (Show whether DF, RT, etc.)	21A. Kind & Status Plug. Bond	21B. Drilling Contractor	22. Approx. Date Work will start
6102' GLE		L & B Speed Drill	January 1, 1978

23.

PROPOSED CASING AND CEMENT PROGRAM

SIZE OF HOLE	SIZE OF CASING	WEIGHT PER FOOT	SETTING DEPTH	SACKS OF CEMENT	EST. TOP
7 7/8"	5 1/2"	15.5#	34'	5	Surface
4 3/4"	2 7/8"	6.5#	1275'	75	Surface

It is proposed to drill a 7 7/8" surface and 4 3/4" hole with minimum mud to test the Pictured Cliffs formation. Completion evaluation will be based on an IES open hole log. It is not planned to have a BOP on well while drilling. Will install master valve and stripper head while completing. EPNG has been assigned as gas purchaser for this well.

APPROVAL VALID
FOR 60 DAYS UNLESS
DRILLING COMMENCED
EXPIRES 2-12-78

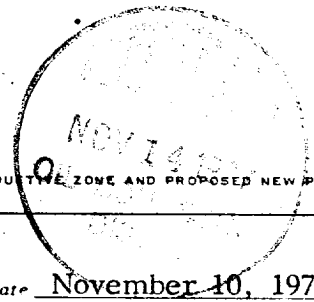

IN ABOVE SPACE DESCRIBE PROPOSED PROGRAM: IF PROPOSAL IS TO DEEPEN OR PLUG BACK, GIVE DATA ON PRESENT PRODUCTION ZONE AND PROPOSED NEW PRODUCTION ZONE. GIVE BLOWOUT PREVENTER PROGRAM, IF ANY.

I hereby certify that the information above is true and complete to the best of my knowledge and belief.

Signed Wesley H. Crocker Petroleum Engineer Date November 10, 1977

(This space for State Use)

APPROVED BY AR Kendrick TITLE SUPERVISOR DIST. 4 DATE NOV 14 1977

CONDITIONS OF APPROVAL, IF ANY:

**NEW MEXICO OIL CONSERVATION COMMISSION
WELL LOCATION AND ACREAGE DEDICATION PLAT**

Form C-102
Supersedes C-128
Effective 1-1-65

All distances must be from the outer boundaries of the Section.

Operator Hixon Development Company			Lease Chaco Wash		Well No. 1
Unit Letter 0	Section 32	Township 26 North	Range 12 West	County San Juan	
Actual Footage Location of Well: 790 feet from the South line and 1850 feet from the East line					
Ground Level Elev. 6102	Producing Formation Pictured Cliffs		Pool NIPP - PC <i>ext</i>		Dedicated Acreage: 160 Acres

1. Outline the acreage dedicated to the subject well by colored pencil or hachure marks on the plat below.
2. If more than one lease is dedicated to the well, outline each and identify the ownership thereof (both as to working interest and royalty).
3. If more than one lease of different ownership is dedicated to the well, have the interests of all owners been consolidated by communitization, unitization, force-pooling, etc?

☒ Yes ☐ No If answer is "yes," type of consolidation Communitization

If answer is "no," list the owners and tract descriptions which have actually been consolidated. (Use reverse side of this form if necessary.) _____

No allowable will be assigned to the well until all interests have been consolidated (by communitization, unitization, forced-pooling, or otherwise) or until a non-standard unit, eliminating such interests, has been approved by the Commission.

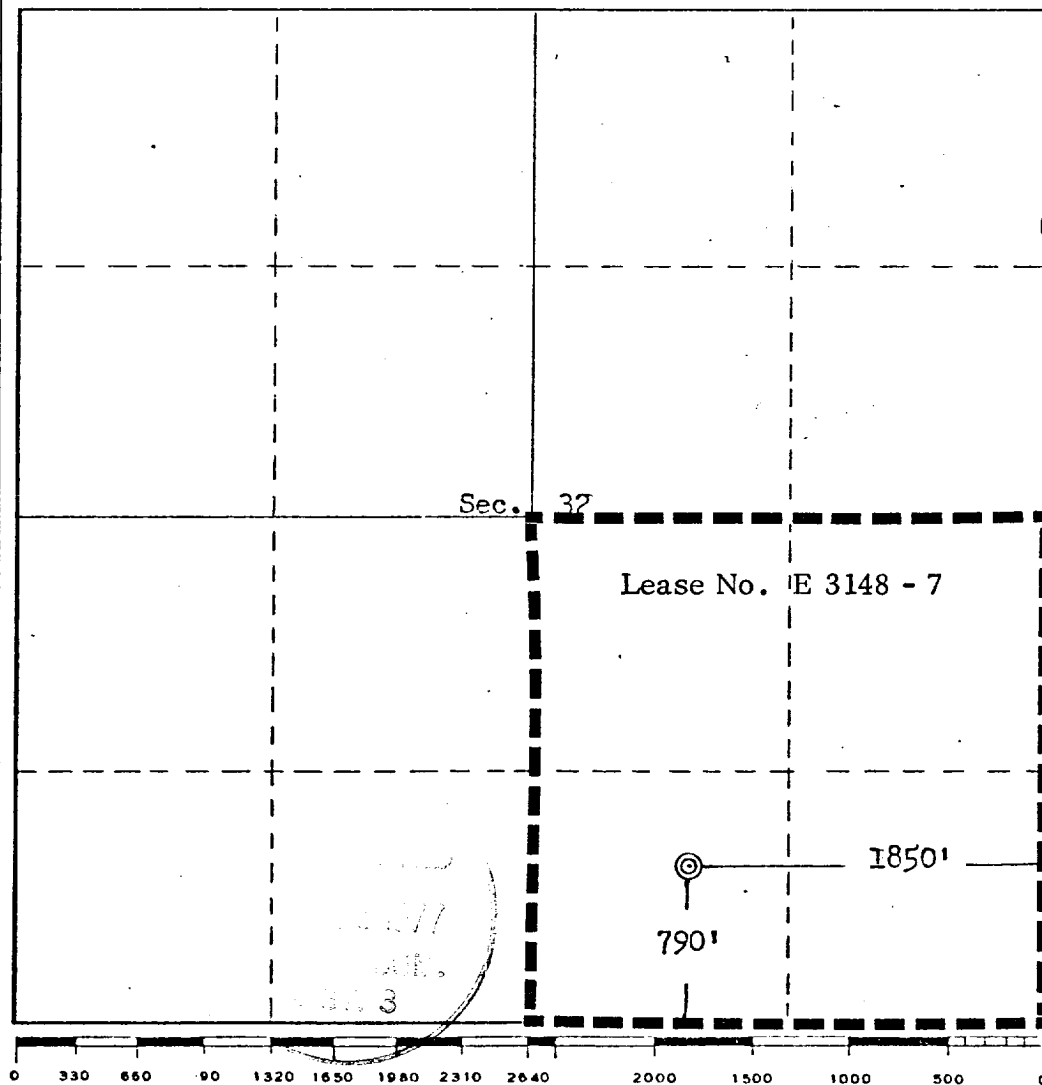

CERTIFICATION

I hereby certify that the information contained herein is true and complete to the best of my knowledge and belief.

Aldrich L. Kuchera
Name

Aldrich L. Kuchera

Position

Petroleum Engineer

Company

Hixon Development Company

Date

November 10, 1977

I hereby certify that the well location shown on this plat was plotted from field notes of actual surveys made by me or under my supervision, and that the same is true and correct to the best of my knowledge and belief.

Date Surveyed

November 5, 1977

Registered Professional Engineer
and/or Land Surveyor

Edgar L. Risenhoover

Certificate No. **5979**

Edgar L. Risenhoover, L.S.