

UNITED STATES  
DEPARTMENT OF THE INTERIOR  
GEOLOGICAL SURVEY

SUNDRY NOTICES AND REPORTS ON WELLS

(Do not use this form for proposals to drill or to deepen or plug back to a different reservoir. Use Form 9-331-C for such proposals.)

1. oil ☐ well ☐ gas ☒ well ☐ other

2. NAME OF OPERATOR  
DIETRICH EXPLORATION

3. ADDRESS OF OPERATOR 602 Midland Savings Bldg.  
444 17th St., Denver, Colorado 80202

4. LOCATION OF WELL (REPORT LOCATION CLEARLY. See space 17 below.)  
AT SURFACE: 1850' N and 1850' E  
AT TOP PROD. INTERVAL: same  
AT TOTAL DEPTH: same

16. CHECK APPROPRIATE BOX TO INDICATE NATURE OF NOTICE, REPORT, OR OTHER DATA

REQUEST FOR APPROVAL TO:

TEST WATER SHUT-OFF ☐

FRACTURE TREAT ☐

SHOOT OR ACIDIZE ☐

REPAIR WELL ☐

PULL OR ALTER CASING ☐

MULTIPLE ZONES ☐

CHANGE ZONES ☐

ABANDON\* ☐ CHANGE OF PLANS ☐

17. DESCRIBE PROPOSED OR COMPLETED OPERATIONS (Clearly state all pertinent details, and give pertinent dates, including estimated date of starting any proposed work. If well is directionally drilled, give subsurface locations and measured and true vertical depths for all markers and zones pertinent to this work.)

The above operator proposes to move the location from 1850' N and 1700' E to the above mentioned distances.

5. LEASE  
NOO 114-20-8376

6. IF INDIAN, ALLOTTEE OR TRIBE NAME  
USK YE NI TAH BLACKIE

7. UNIT AGREEMENT NAME

8. FARM OR LEASE NAME  
DIETRICH EXPLORATION 28G

9. WELL NO.  
1

10. FIELD OR WILDCAT NAME  
WAW P.C. - FRUITLAND

11. SEC., T., R., M. OR BLK. AND SURVEY OR AREA  
SEC. 28-T26N, R12W

12. COUNTY OR PARISH  
SAN JUAN

14. API NO.

13. STATE  
NEW MEXICO

15. ELEVATIONS (SHOW DF. KDB. AND WD)  
6064

(NOTE: Report results of multiple completion or zone change on Form 9-330.)

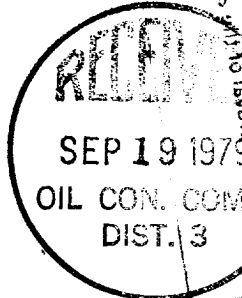

Subsurface Safety Valve: Manu. and Type

18. I hereby certify that the foregoing is true and correct

SIGNED John Alexander TITLE

AGENT

DATE

(This space for Federal or State office use)

DATE

APPROVED BY  
CONDITIONS OF APPROVAL, IF ANY:

\*See Instructions on Reverse Side

NEW MEXICO OIL CONSERVATION COMMISSION  
WELL LOCATION AND ACREAGE DEDICATION PLAT

Form C-102  
Supersedes C-128  
Effective 1-1-65

All distances must be from the outer boundaries of the Section.

Operator <b>DIETRICH EXPLORATION</b>			Lease <b>28- G</b>		Well No. <b>1</b>
Unit Letter <b>G</b>	Section <b>28</b>	Township <b>26 NORTH</b>	Range <b>12 WEST</b>	County <b>SAN JUAN</b>	
Actual Footage Location of Well: <b>1850</b> feet from the <b>NORTH</b> line and <b>1850</b> feet from the <b>EAST</b> line					
Ground Level Elev: <b>6064</b>	Producing Formation <b>PICTURED CLIFFS</b>		Pool <b>WAW PICTURED CLIFF-FRUITLAND</b>		Dedicated Acreage: <b>160</b> Acres

- Outline the acreage dedicated to the subject well by colored pencil or hatchure marks on the plat below.
- If more than one lease is dedicated to the well, outline each and identify the ownership thereof (both as to working interest and royalty).
- If more than one lease of different ownership is dedicated to the well, have the interests of all owners been consolidated by communitization, unitization, force-pooling, etc?

☐ Yes ☐ No If answer is "yes," type of consolidation \_\_\_\_\_

If answer is "no," list the owners and tract descriptions which have actually been consolidated. (Use reverse side of this form if necessary.) \_\_\_\_\_

No allowable will be assigned to the well until all interests have been consolidated (by communitization, unitization, forced-pooling, or otherwise) or until a non-standard unit, eliminating such interests, has been approved by the Commission.

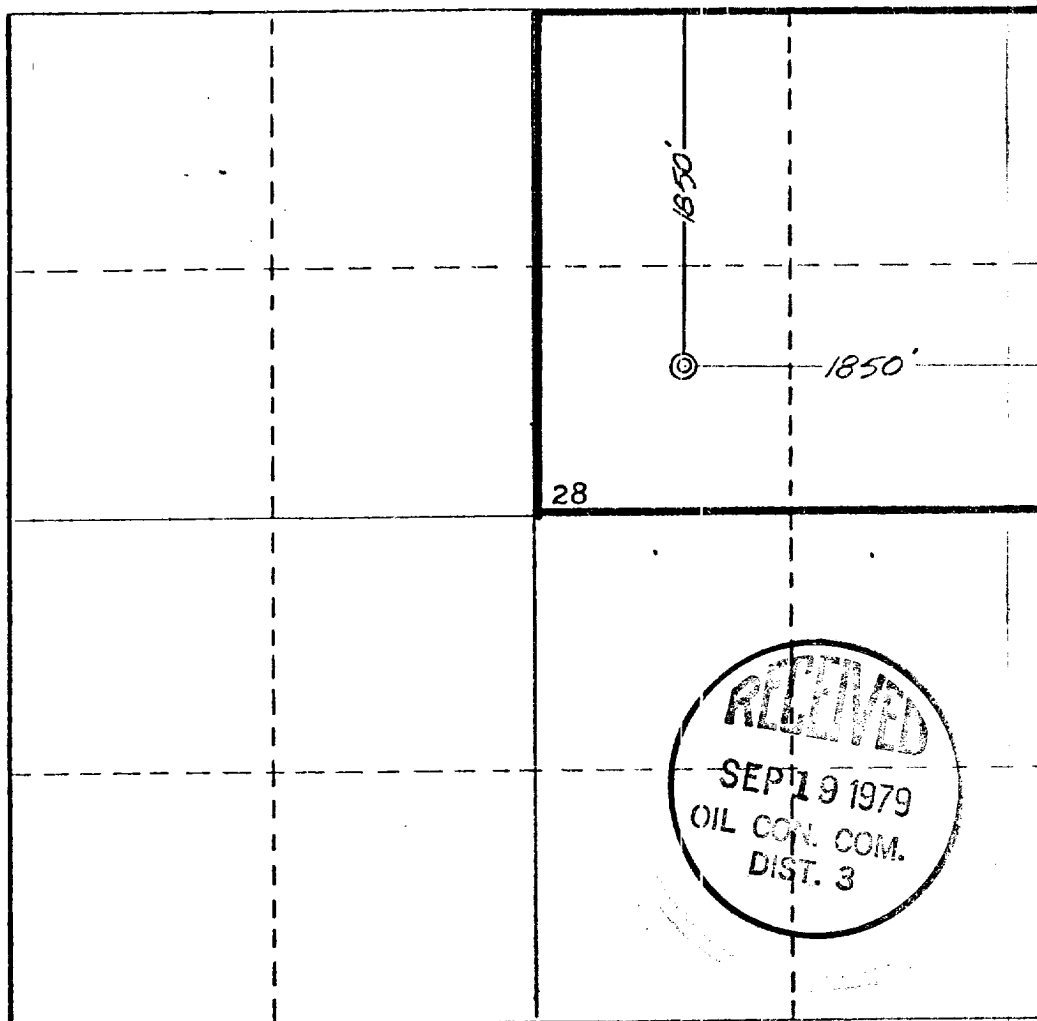

**CERTIFICATION**

I hereby certify that the information contained herein is true and complete to the best of my knowledge and belief.

*John Alexander*  
Name  
**JOHN ALEXANDER**

Position  
**AGENT**

Company  
**DIETRICH EXPLORATION**

Date  
**August 30, 1979**

I hereby certify that the well location shown on this plat was plotted in the field by actual surveys made by me or under my supervision, and that the same is true and correct to the best of my knowledge and belief.

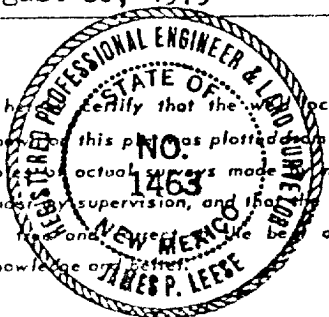

Date Surveyed  
**July 25, 1979**

Registered Professional Engineer and Land Surveyor

*James P. Leese*  
**James P. Leese**

Certificate No.  
**1463**

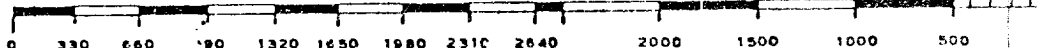

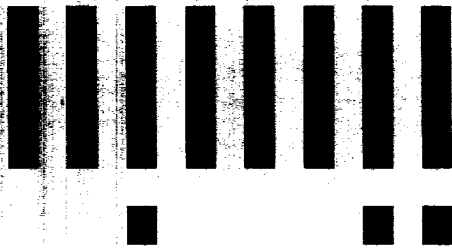

**LTR**



**Job separation sheet**

UNITED STATES  
DEPARTMENT OF THE INTERIOR  
GEOLOGICAL SURVEY

SUNDRY NOTICES AND REPORTS ON WELLS

(Do not use this form for proposals to drill or to deepen or plug back to a different reservoir. Use Form 9-331-C for such proposals.)

1. oil well ☐ gas well ☒ other ☐

2. NAME OF OPERATOR  
Dietrich Exploration Company, Inc.

3. ADDRESS OF OPERATOR 602 Midland Savings Bldg.  
444 17th Street, Denver, Colorado 80202

4. LOCATION OF WELL (REPORT LOCATION CLEARLY. See space 17 below.)  
AT SURFACE: 1850' FNL and 1850 FEL  
AT TOP PROD. INTERVAL: same  
AT TOTAL DEPTH: same

16. CHECK APPROPRIATE BOX TO INDICATE NATURE OF NOTICE, REPORT, OR OTHER DATA

REQUEST FOR APPROVAL TO:		SUBSEQUENT REPORT OF:	
TEST WATER SHUT-OFF	<input type="checkbox"/>		<input type="checkbox"/>
FRACTURE TREAT	<input type="checkbox"/>		<input type="checkbox"/>
SHOOT OR ACIDIZE	<input type="checkbox"/>		<input type="checkbox"/>
REPAIR WELL	<input type="checkbox"/>		<input type="checkbox"/>
PULL OR ALTER CASING	<input type="checkbox"/>		<input type="checkbox"/>
MULTIPLE COMPLETE	<input type="checkbox"/>		<input type="checkbox"/>
CHANGE ZONES	<input type="checkbox"/>		<input type="checkbox"/>
ABANDON*	<input type="checkbox"/>		<input type="checkbox"/>
(other) CHANGE OF PLANS			

5. LEASE  
N00-14-20-8376

6. IF INDIAN, ALLOTTEE OR TRIBE NAME  
USK YE NI TAH BLACKIE

7. UNIT AGREEMENT NAME

8. FARM OR LEASE NAME  
Dietrich Exploration 28G

9. WELL NO.

10. FIELD OR WILDCAT NAME  
WAW PC - Fruitland

11. SEC., T., R., M., OR BLK. AND SURVEY OR AREA  
Sec. 28, T26N, R12W

12. COUNTY OR PARISH  
San Juan

13. STATE  
New Mexico

14. API NO.

15. ELEVATIONS (SHOW DF, KDB, AND WD)  
6064

(NOTE: Report results of multiple completion or zone change on Form 9-330.)

17. DESCRIBE PROPOSED OR COMPLETED OPERATIONS (Clearly state all pertinent details, and give pertinent dates, including estimated date of starting any proposed work. If well is directionally drilled, give subsurface locations and measured and true vertical depths for all markers and zones pertinent to this work.)\*

Double Ram 6" 900 series B.O.P.'s will be used and tested as follows:

The attached schematic shows the type of blowout preventer to be used while drilling. The unit will be tested to 800 psi prior to drilling from under surface pipe by pressuring through casing valves with blind ram closed. This procedure will be repeated with the pipe rams closed on a joint of drill pipe. Operation of the hydraulic system will be checked daily.

Subsurface Safety Valve: Manu. and Type \_\_\_\_\_ Set @ \_\_\_\_\_ Ft.

18. I hereby certify that the foregoing is true and correct

SIGNED John Alexander TITLE Agent DATE September 17, 1979  
(This space for Federal or State office use)

APPROVED BY \_\_\_\_\_ TITLE \_\_\_\_\_ DATE \_\_\_\_\_  
CONDITIONS OF APPROVAL, IF ANY:

\*See Instructions on Reverse Side

WMOCC



SHAFER TOOL WORKS

ATTACHMENT TO POINT 5  
6" 20 SERIES API

# SHAFER HYDRAULIC BLOWOUT PREVENTERS

(Patented)

TYPE LWS PREVENTERS—8", 3000 lb. & 5000 lb.—10", 5000 lb.  
12", 3000 lb.—13 5/8", 5000 lb.—16", 3000 lb.

## PARTS AND DIMENSIONAL ILLUSTRATIONS

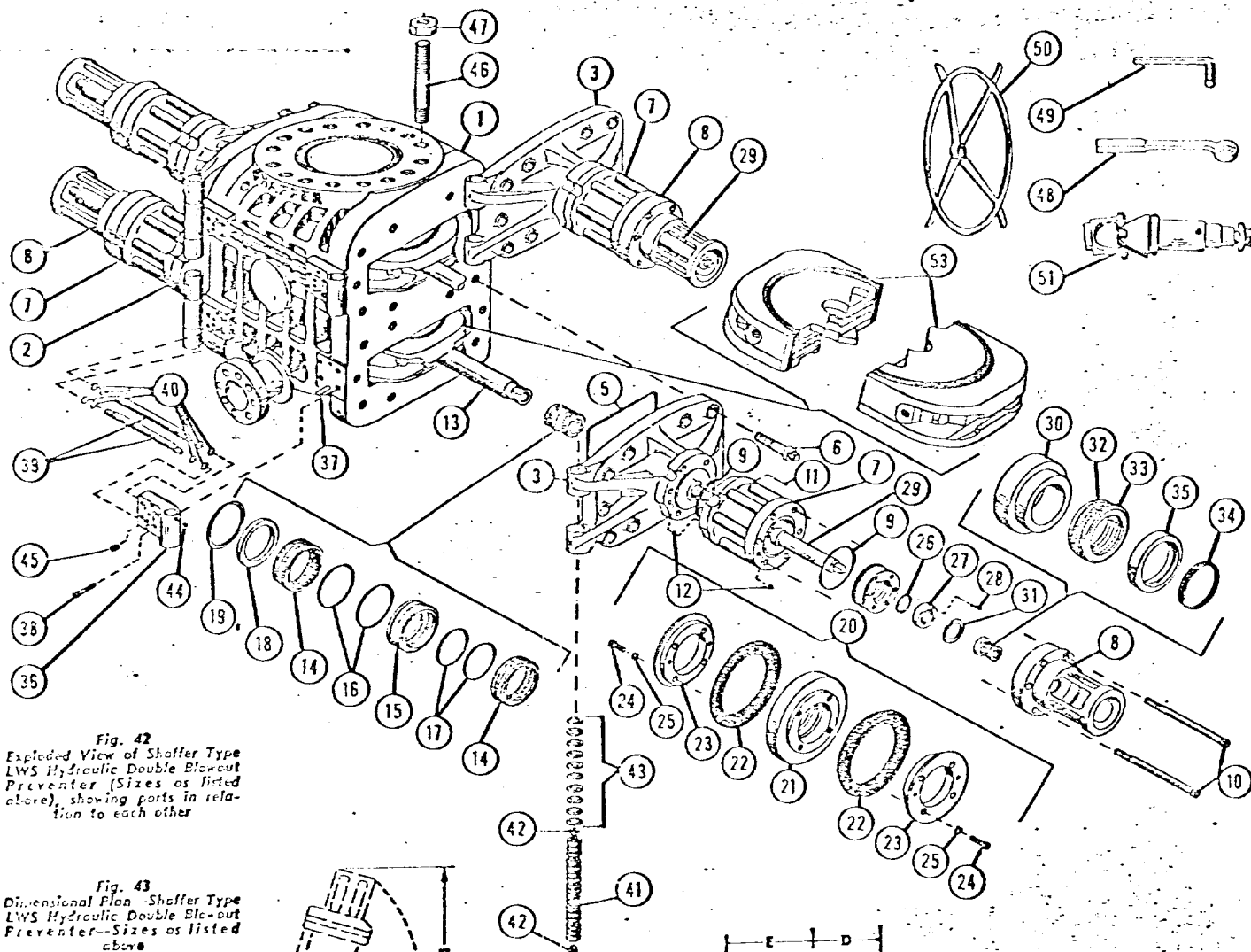

Fig. 42  
Exploded View of Shaffer Type  
LWS Hydraulic Double Blowout  
Preventer (Sizes as listed  
above), showing parts in rela-  
tion to each other

Fig. 43  
Dimensional Plan—Shaffer Type  
LWS Hydraulic Double Blowout  
Preventer—Sizes as listed  
above

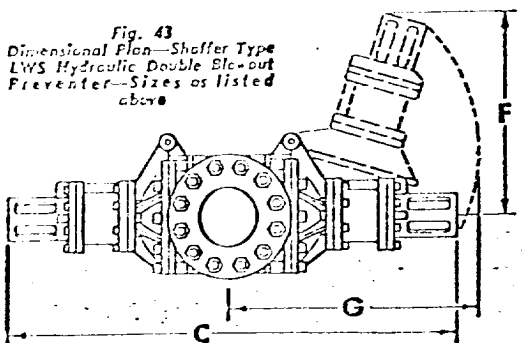
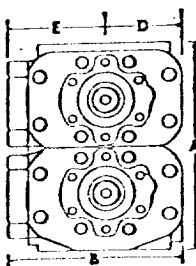

Fig. 44  
Dimensional End Elevation—  
Shaffer Type LWS Hydraulic  
Double Blowout Preventer—  
Sizes as listed above



### STANDARD ACCESSORIES

- (50) 4 Hand Wheels
- (48) 1 Door Wrench
- (49) 1 Cylinder & Cylinder Head Wrench
- (51) 4 Universal Joints

### DIMENSIONAL AND ENGINEERING DATA ON ABOVE SIZES OF TYPE LWS PREVENTERS

Refer to Figs. 43 and 44

Refer to Figs. 45 and 46																					
Size	Max. Service Press. Rating psi	Test Press. psi	Vertical Port	Max. Port Size	Approx. Weight lbs.		A				B	C	D	E	F	G	Closing Ratio	Opening Ratio	U.S. Gals. Field To Close Rams	U.S. Gals. Field To Open Rams	
					Studded Flange		Height				Width	Length	Center To Front	Center To Rear	Door Open To Close Rams	Door Open To Close Rams					
					Single	Double	Studded Flange	Polished Flange	Studded Flange	Polished Flange											
8"	2,000	6,000	9"	7"	.....	3,900	.....	.....	22 1/4"	41 1/4"	25 3/4"	76 1/4"	11 1/4"	14 1/4"	22"	46"	5.6 to 1	1.89 to 1	2.75	2.2	
8"	2,000	10,000	9"	7"	.....	3,900	.....	.....	22 1/4"	41 1/4"	25 3/4"	76 1/4"	11 1/4"	14 1/4"	22"	46"	5.6 to 1	1.89 to 1	2.75	2.2	
10"	5,000	10,000	11"	8 1/2"	5,500	7,000	34 3/4"	24 3/4"	23"	23"	25 3/4"	82 3/4"	12 1/4"	16 1/4"	22"	46"	5.5 to 1	1.5 to 1	3.25	2.7	
12"	2,500	6,000	12 1/2"	10 1/2"	.....	6,300	.....	.....	24 1/4"	47 3/4"	31 1/4"	82 3/4"	13 1/4"	18 1/4"	27"	52"	5.55 to 1	1.59 to 1	2.55	2.9	
12"	5,000	10,000	12 1/2"	10 1/2"	6,500	9,700	32 3/4"	32 3/4"	26"	45 1/4"	32 3/4"	92 3/4"	14 1/4"	18 1/4"	41"	54"	5.5 to 1	1.5 to 1	2.55	2.9	
16"	2,500	6,000	12 1/2"	12 1/2"	.....	8,500	.....	.....	33"	51"	55 1/4"	100 3/4"	16 1/4"	20 1/4"	32"	60"	5.55 to 1	1.59 to 1	3.6	3.2	