

UNITED STATES  
DEPARTMENT OF THE INTERIOR  
GEOLOGICAL SURVEY

## APPLICATION FOR PERMIT TO DRILL, DEEPEN, OR PLUG BACK

## 1a. TYPE OF WORK

DRILL ☒DEEPEN ☐PLUG BACK ☐

## b. TYPE OF WELL

OIL  
WELL ☐GAS  
WELL ☒OTHER ☐SINGLE  
ZONE ☒MULTIPLE  
ZONE ☐

## 2. NAME OF OPERATOR

DOME PETROLEUM CORP.

## 3. ADDRESS OF OPERATOR

501 Airport Drive, Suite 107, Farmington, New Mexico 87401

## 4. LOCATION OF WELL (Report location clearly and in accordance with any State requirements.)\*

At surface

790' FSL, 790' FWL

At proposed prod. zone

## 14. DISTANCE IN MILES AND DIRECTION FROM NEAREST TOWN OR POST OFFICE\*

25 miles south of Farmington, New Mexico

## 15. DISTANCE FROM PROPOSED\*

LOCATION TO NEAREST  
PROPERTY OR LEASE LINE, FT.  
(Also to nearest drlg. unit line, if any)

## 16. NO. OF ACRES IN LEASE

156.49

## 18. DISTANCE FROM PROPOSED LOCATION\*

TO NEAREST WELL, DRILLING, COMPLETED,  
OR APPLIED FOR, ON THIS LEASE, FT.

## 19. PROPOSED DEPTH

1500'

17. NO. OF ACRES ASSIGNED  
TO THIS WELL

156.49

## 20. ROTARY OR CABLE TOOLS

ROTARY

## 21. ELEVATIONS (Show whether DF, RT, GR, etc.)

6049' GR

## 22. APPROX. DATE WORK WILL START\*

September 15, 1979

## PROPOSED CASING AND CEMENTING PROGRAM

SIZE OF HOLE	SIZE OF CASING	WEIGHT PER FOOT	SETTING DEPTH	QUANTITY OF CEMENT
8 3/4"	7"	20#	90'	60 SACKS (CIRCULATED)
5"	2 7/8"	6.5#	1500'	BY CALIPER LOG

Move in rotary tools. Drill 8 3/4" hole to 90'. Set 90' of new 7" casing and cement as above. Wait on cement 12 hrs. Install 6" 600 series Blowout Preventer and test. Drill 5" hole to 1500'. No abnormal temperatures or pressures are anticipated. Mud system will be Gel-chem weighing 8.5-9.2#/gal. W.L. 8-10 cc and viscosity of 30-50 sec/quart. Logging program will be IES, FPC/CNL, with GR caliper log. If commercial, 2 7/8" casing will be run and cemented as above. If non-commercial, plug and abandonment will follow U.S.G.S. specifications. The geologic name of the surface formation is Ojo Alamo. The estimated tops of important geologic markers:

FARMINGTON	310
FRUITLAND	789
PICTURED CLIFF	1139

The above formations could be either water-bearing or gas.  
Gas under this lease is not committed to a contract.

IN ABOVE SPACE DESCRIBE PROPOSED PROGRAM: If proposal is to deepen or plug back, give data on present productive zone and proposed new productive zone. If proposal is to drill or deepen directionally, give pertinent data on subsurface locations and measured and true vertical depths. Give blowout preventer program, if any.

24.

SIGNED

*H.D. Hollingsworth*  
H.D. HOLLINGSWORTH

TITLE DRILLING FOREMAN

(This space for Federal or State office use)

PERMIT NO.

APPROVAL DATE

APPROVED BY

TITLE

CONDITIONS OF APPROVAL, IF ANY

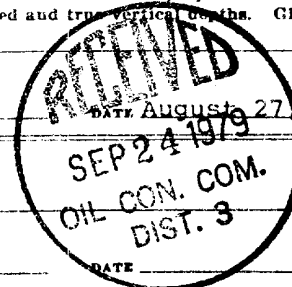

30-045-23802

5. LEASE DESIGNATION AND SERIAL NO.  
NOO-C-14-20-7474

6. IF INDIAN, ALLOTTEE OR TRIBE NAME  
NAVAJO

7. UNIT AGREEMENT NAME

8. FARM OR LEASE NAME  
DOME NAVAJO 18-26-12

9. WELL NO.  
1

10. FIELD AND POOL, OR WILDCAT  
WAW FRUITLAND-PICTURED CLIFF

11. SEC., T., R., M., OR BLK.  
AND SURVEY OR AREA  
SEC. 18, T26N, R12W

12. COUNTY OR PARISH  
SAN JUAN

13. STATE  
NEW MEXICO

Nmoc

## OIL CONSERVATION DIVISION

STATE OF NEW MEXICO  
ENERGY AND MINERALS DEPARTMENTP. O. BOX 2088  
SANTA FE, NEW MEXICO 87501Form C-107  
Revised 10-1-78

All distances must be from the outer boundaries of the Section.

Operator <b>DOMO PETROLEUM CORPORATION</b>		Lease <b>DOMO-NAVAJO 18-26-12</b>		Well No. <b>1</b>
Unit Letter <b>M</b>	Section <b>18</b>	Township <b>26N</b>	Range <b>12W</b>	County <b>San Juan</b>

Actual Footage Location of Well:



<b>790</b> feet from the <b>South</b> line and <b>790</b> feet from the <b>West</b> line	Ground Level Elev. <b>6049</b>	Producing Formation <b>PICTURED CLIFF</b>	Pool <b>WAW FRUITLAND-PICTURED CLIFF</b>	Dedicated Acreage: <b>160</b> Acres
--	-----------------------------------	--	---	--

1. Outline the acreage dedicated to the subject well by colored pencil or hachure marks on the plat below.
2. If more than one lease is dedicated to the well, outline each and identify the ownership thereof (both as to working interest and royalty).
3. If more than one lease of different ownership is dedicated to the well, have the interests of all owners been consolidated by communitization, unitization, force-pooling, etc?

☐ Yes ☐ No If answer is "yes," type of consolidation \_\_\_\_\_

If answer is "no," list the owners and tract descriptions which have actually been consolidated. (Use reverse side of this form if necessary.) \_\_\_\_\_

No allowable will be assigned to the well until all interests have been consolidated (by communitization, unitization, forced-pooling, or otherwise) or until a non-standard unit, eliminating such interests, has been approved by the Commission.

Sec.	
18	
	
	

## CERTIFICATION

I hereby certify that the information contained herein is true and complete to the best of my knowledge and belief.

*H. D. Hollingsworth*  
Name  
H. D. HOLLINGSWORTH  
Position  
DRILLING FOREMAN  
Company  
DOMO PETROLEUM CORPORATION  
Date  
August 20, 1979

I hereby certify that the well location shown on this plat was plotted from field notes of actual surveys made by me or under my supervision, and that the same is true and correct to the best of my knowledge and belief.

Date Surveyed  
August 20, 1979  
Registered Professional Engineer  
and/or Land Surveyor  
*Fred B. Kerr, Jr.*  
Fred B. KERR, JR.  
Certificate No. 3350



E. C. GENT  
VICE PRESIDENT

# DOME PETROLEUM CORP.

SUITE 1500, COLORADO STATE BANK BLDG.  
1600 BROADWAY  
DENVER, COLORADO 80202

TELEPHONE  
(303) 861-1230

## DEVELOPMENT PLAN FOR SURFACE USE

Dome Navajo 18-26-12 #1  
790' FSL, 790' FWL  
Sec. 18, T26N, R12W  
San Juan County, NM.

### 1. EXISTING ROADS

The main road to the location is that from Farmington toward Bisti (Bisti Highway), leaving this road approximately 23 miles south of Farmington and using existing side roads to the location.

### 2. PLANNED ACCESS ROADS

The access road, to be routed as shown on the attached map, will be 18' wide with adequate ditch and water bars.

### 3. EXISTING WELLS

Existing wells within one mile of location are shown on the attached topographic map.

### 4. LOCATION OF PROPOSED FACILITIES

Development of commercial gas production will require separation facilities on the location pad. Equipment and pits will be fenced as required for protection of livestock and wildlife. Above ground facilities will be painted brown or grey to blend in with the surrounding area as specified by the BLM. The disturbed areas no longer needed for operations after well completion will be restored to natural contour and reseeded.

### 5. LOCATION AND TYPE OF WATER SUPPLY

To be hauled from El Paso Natural Gas Co. water pit at Chaco Gas Plant, approximately 3 miles east.

### 6. SOURCE OF CONSTRUCTION MATERIALS

Not applicable.

### 7. METHOD OF HANDLING WASTE MATERIALS

All garbage and trash that can be burned shall be burned. All trash that cannot be burned will be contained in a trash pit and covered with a minimum of 24 inches of dirt. All drilling waste such as cuttings, overflows of oil, water and drilling fluids will be contained in the reserve pit and buried with adequate cover upon completion of operations. The reserve pit will be fenced until cleanup operations are commenced. Toilet facilities will be provided.

### 8. ANCILLARY FACILITIES

No camps or airstrips are proposed for this location.

9. WELL SITE LAYOUT

See attached diagram.

10. PLANS FOR RESTORATION OF SURFACE

Cleanup of the location will commence immediately following the removal of the drilling equipment. The reserve pit will be fenced until restoration operations are commenced. The location will be returned to original contour if the well is not productive. Both the road and location will be reseeded in accordance with BLM specifications.

11. OTHER INFORMATION

Topography consists of rolling hills with very sandy soil. Vegetation is composed of Snake Weed, Mormon Tea, Yucca, Prickly Pear and Blue Gramma.

12. LEASEE'S OR OPERATOR'S REPRESENTATIVE

Dome Petroleum Corporation  
H. D. Hollingsworth  
501 Airport Drive, Suite 107  
Farmington, New Mexico 87401  
Phone: 505-325-2897 Office  
505-327-1548 Home

13. CERTIFICATION

I hereby certify that I, or persons under my direct supervision, have inspected the proposed drill site and access route; that I am familiar with the conditions which presently exist; that the statements made in the plan are, to the best of my knowledge, true and correct; and that the work associated with the operations proposed herein will be performed by Dome Petroleum Corporation and its contractors and sub-contractors in conformity with this plan and the terms and conditions under which it is approved.

H. D. Hollingsworth  
H. D. Hollingsworth, Drilling Foreman  
Dome Petroleum Corporation

August 20, 1979

HDH/clp

# BLOWOUT PREVENTERS

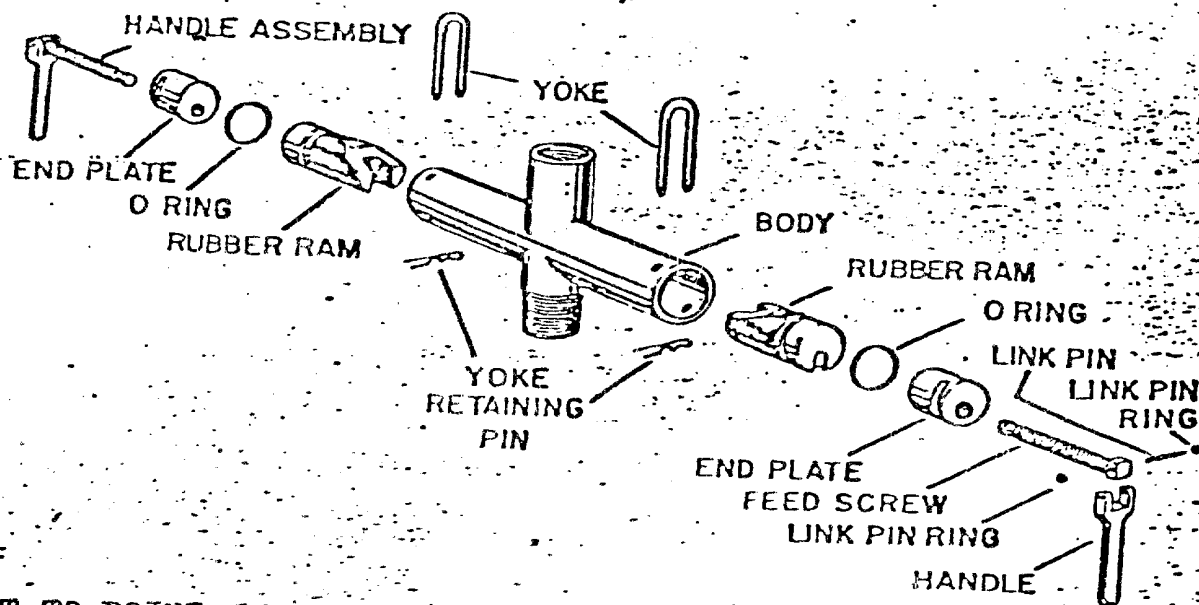

ASSEMBLY TO POINT 5  
SERIES 6" 600

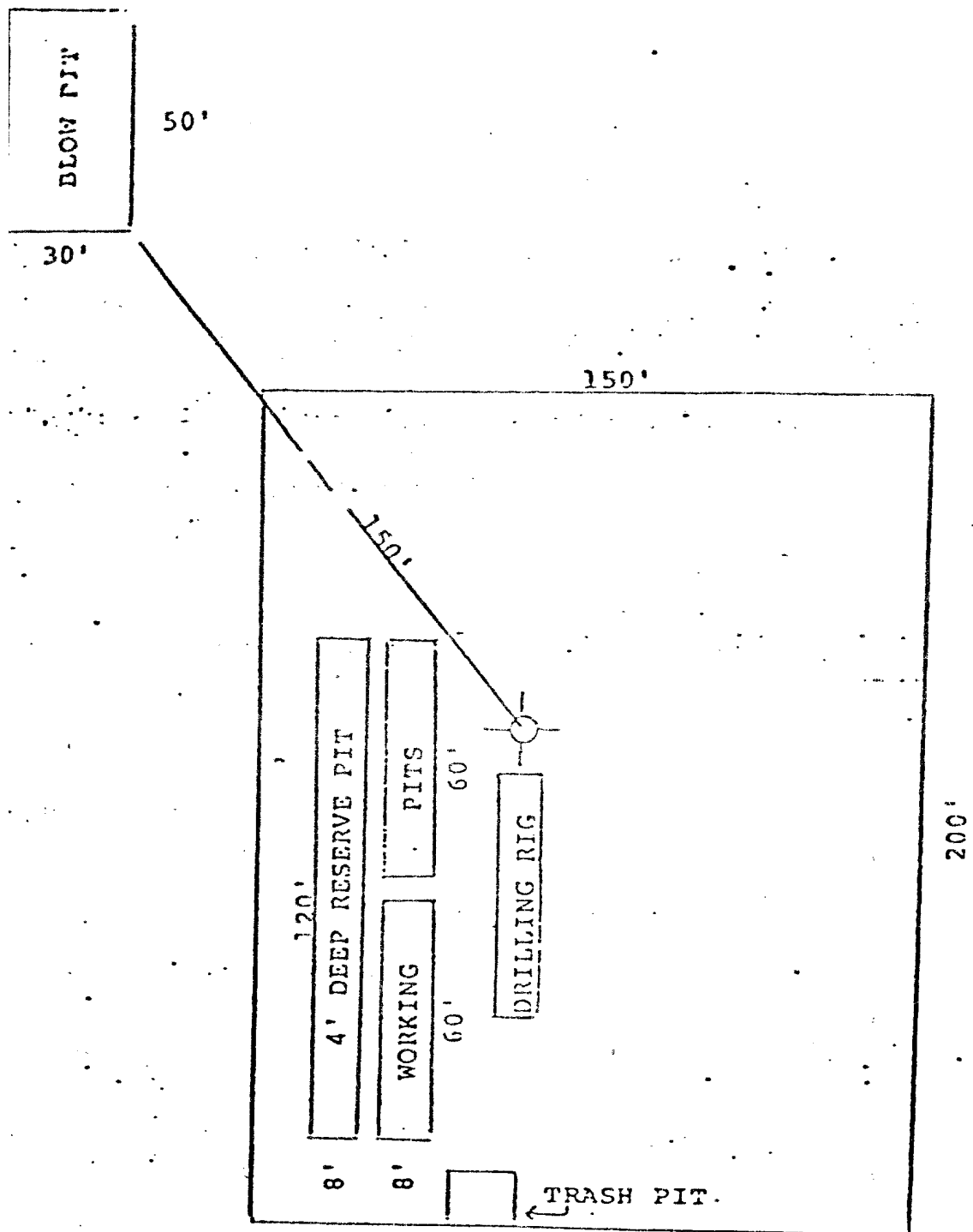

· DOME PETROLEUM CORP.

SUITE 1500, COLORADO STATE BANK BLDG.

1600 BROADWAY

DENVER, COLORADO 80202

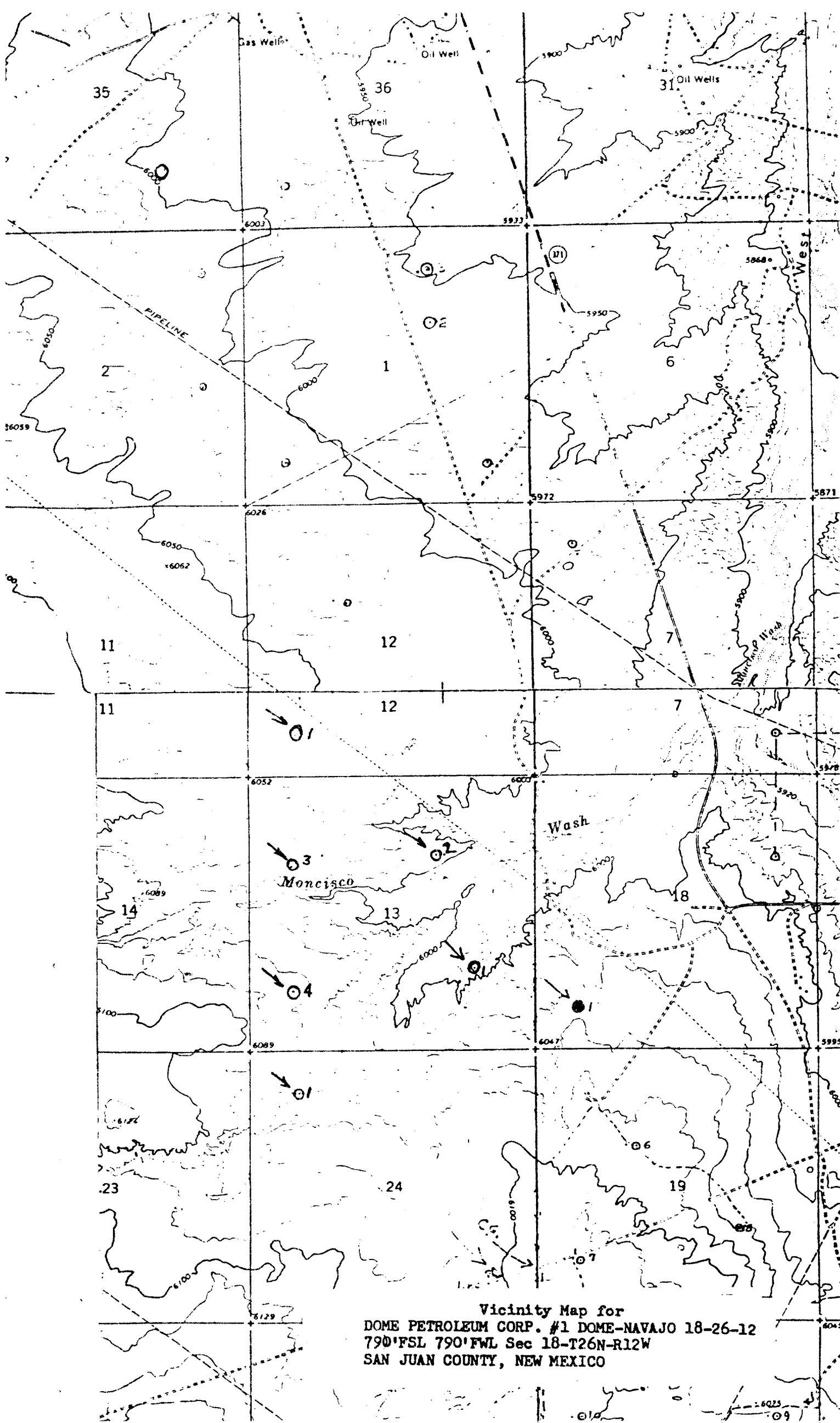

Vicinity Map for  
DOME PETROLEUM CORP. #1 DOME-NAVAJO 18-26-12  
790' FSL 790' FWL Sec 18-T26N-R12W  
SAN JUAN COUNTY, NEW MEXICO