

30-045-24298

NO. OF COPIES RECEIVED	6
DISTRIBUTION	
SANTA FE	1
FILE	1
U.S.G.S.	2
LAND OFFICE	1
OPERATOR	1

NEW MEXICO OIL CONSERVATION COMMISSION

Form C-101
Revised 1-4-65

5A. Indicate Type of Lease	
STATE <input checked="" type="checkbox"/>	FEE <input type="checkbox"/>
5. State Oil & Gas Lease No.	
LG3571	

APPLICATION FOR PERMIT TO DRILL, DEEPEN, OR PLUG BACK

1a. Type of Work		7. Unit Agreement Name	
b. Type of Well OIL WELL <input type="checkbox"/> GAS WELL <input checked="" type="checkbox"/> OTHER <input type="checkbox"/>		8. Farm or Lease Name	
DRILL <input checked="" type="checkbox"/> DEEPEN <input type="checkbox"/> PLUG BACK <input type="checkbox"/>		State 16	
2. Name of Operator		9. Well No.	
TENNECO OIL COMPANY		16-1E	
3. Address of Operator		10. Field and Pool, or Wildcat	
720 SOUTH COLORADO BOULEVARD, DENVER, COLORADO		Basin Dakota	
4. Location of Well		12. County	
UNIT LETTER P LOCATED 1110 FEET FROM THE South LINE		San Juan	
AND 1050 FEET FROM THE East LINE OF SEC. 16 TWP. 26N RGE. 8W NMPM		E 320	
19. Proposed Depth		19A. Formation	20. Rotary or C.T.
6980		Dakota	Rotary
21. Elevations (Show whether DF, RT, etc.)	21A. Kind & Status Plug. Bond	21B. Drilling Contractor	22. Approx. Date Work will start
6564GR	Blanket	4-Corners	ASAP

PROPOSED CASING AND CEMENT PROGRAM

SIZE OF HOLE	SIZE OF CASING	WEIGHT PER FOOT	SETTING DEPTH	SACKS OF CEMENT	EST. TOP
13 1/4"	9 5/8"	36#	+ 500'	circulate to surface	
7 7/8"	4 1/2"	10.5# & 11.6#	+ 6980	circulate to surface	

See Attached

APPROVAL VALID
FOR 90 DAYS UNLESS
DRILLING COMMENCED,

EXPIRES 7-23-80

The gas is dedicated



IN ABOVE SPACE DESCRIBE PROPOSED PROGRAM: IF PROPOSAL IS TO DEEPEN OR PLUG BACK, GIVE DATA ON PRESENT PRODUCTIVE ZONE AND PROPOSED NEW PRODUCTIVE ZONE. GIVE BLOWOUT PREVENTER PROGRAM, IF ANY

I hereby certify that the information above is true and complete to the best of my knowledge and belief.

Signed Martin J. Human Title Staff Production Analyst Date 4/21/80

(This space for State Use)

APPROVED BY Frank S. C. [Signature] TITLE SUPERVISOR DISTRICT # 3DATE APR 24 1980

CONDITIONS OF APPROVAL, IF ANY:

OIL CONSERVATION DIVISION

STATE OF NEW MEXICO
ENERGY AND MINERALS DEPARTMENTP. O. BOX 2088
SANTA FE, NEW MEXICO 87501Form C-102
Revised 10-1-78

All distances must be from the outer boundaries of the Section.

Operator TENNECO OIL COMPANY		Lease STATE 16		Well No. 1-E
Unit Letter P	Section 16	Township 26N	Range 8W	County San Juan
Actual Footage Location of Well: 1110 feet from the South line and 1050 feet from the East line				
Ground Level Elev. 6564	Producing Formation Dakota	Pool Basin Dakota	Dedicated Acreage: 320.00 Acres	

1. Outline the acreage dedicated to the subject well by colored pencil or hatchure marks on the plat below.
2. If more than one lease is dedicated to the well, outline each and identify the ownership thereof (both as to working interest and royalty).
3. If more than one lease of different ownership is dedicated to the well, have the interests of all owners been consolidated by communitization, unitization, force-pooling, etc?

☐ Yes ☐ No If answer is "yes," type of consolidation _____

If answer is "no," list the owners and tract descriptions which have actually been consolidated. (Use reverse side of this form if necessary.) _____

No allowable will be assigned to the well until all interests have been consolidated (by communitization, unitization, forced-pooling, or otherwise) or until a non-standard unit, eliminating such interests, has been approved by the Commission.

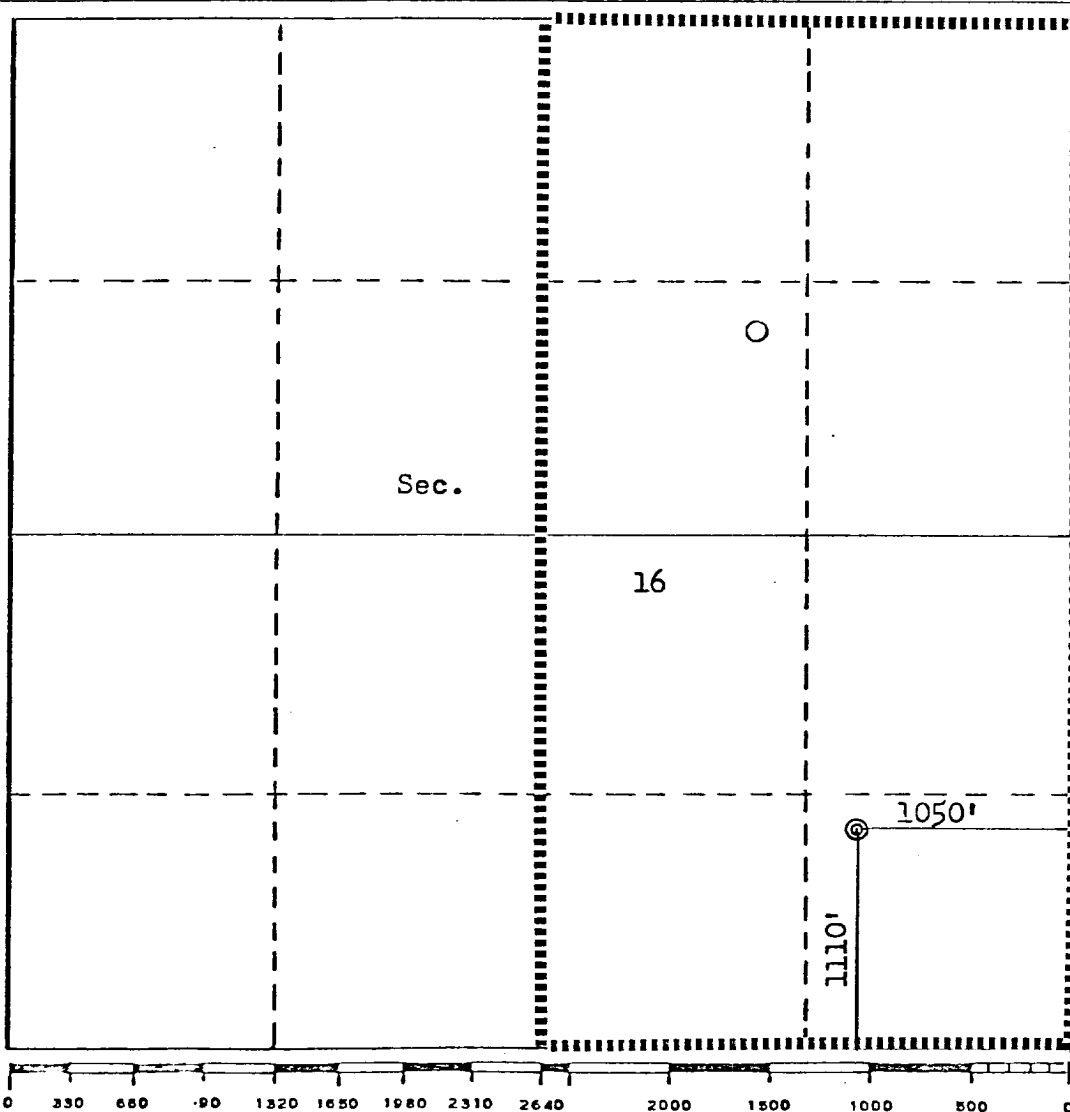

CERTIFICATION

I hereby certify that the information contained herein is true and complete to the best of my knowledge and belief.

M Lee Freeman
Name

M Lee Freeman

Position

Staff Production Analyst

Company

Tenneco Oil Company

Date

April 21, 1980

I hereby certify that the well location shown on this plat was plotted from field notes of actual surveys made by me or under my supervision, and that the same is true and correct to the best of my knowledge and belief.

APR 24 1980
OIL CON. COM.
DIST. 3

Date Surveyed

March 26, 1980

Registered Professional Engineer
and/or Land Surveyor

Fred B. Kerr Jr.
Fred B. Kerr Jr.

Certificate No.

3950

TENNECO OIL COMPANY
ROCKY MOUNTAIN DIVISION
PENTHOUSE, 720 SOUTH COLORADO BOULEVARD
DENVER, COLORADO 80222

DRILLING PROCEDURE

DATE: March 24, 1980

LEASE: State

WELL NO.: 16-1E

LOCATION: 1650' FSL, 990' FEL
Section 16, T 26N, R 8W
San Juan County, New Mexico

ELEVATION: 6580', Est. G.L.

TOTAL DEPTH: 6980'

PROJECTED HORIZON: Dakota

SUBMITTED BY:

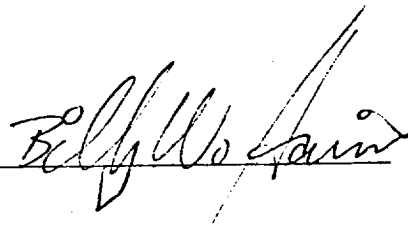

DATE:

3/25/80

APPROVED BY: _____

DATE: _____

BWH:ms

CC: Administration
DSB Well File
Field File

ESTIMATED FORMATION TOPS

Pictured Cliffs	2370'	(Gas)
Cliffhouse	3930'	(Water)
Menefee	4040'	
Point Lookout	4666'	(Water)
Mancos	4780'	
Greenhorn	6640'	(Water)
Dakota	6720'	(Gas)
T.D.	6980'	

DRILLING, CASING, AND CEMENT PROGRAM

1. MIRURT.
2. Drill a 13-1/4" hole to \pm 500'. Run 9-5/8", 36#, K-55, ST&C to T.D.
3. Cement surface casing to surface with Class "B" cement containing 2% CaCl₂.
4. Cut off casing and weld on casing head. Pressure test weld to 1000 psig. NU BOP's and manifold. Pressure test casing, BOP's, and manifold to 1000 psig 40 30 minutes. Pick up drilling assembly, TIH, and pressure test pipe rams to 1000 psig for 15 minutes.
5. Drill out shoe and reduce hole diameter to 7-7/8". Mud up and drill to T.D.
6. Log open hole as requested by the Wellsite Geological Engineer.
7. If productive, run 4-1/2", 10.5# & 11.6#, K-55, ST&C production casing as per casing design.
8. Cement production casing with 50/50 pozmix and tail in with 150 sx Class "B".
9. If non-productive, plug and abandon as per appropriate regulatory agency requirements.
10. Rig down, MORT.

MUD PROGRAM

0-500' Spud mud.
500-3200' Low solids, fresh water mud. (Water and Benex.)
3200-T.D. Low solids, fresh water mud w/sufficient viscosity to clean hole and w/10-15% lost circulation material, recommended prior to and during drilling of the Mesa Verde.

EVALUATION

Cores and DST's: None.

Deviation Surveys:

1. Survey surface hole at 100' intervals. Maximum allowable deviation at 500' is 1-1/2°.
2. From surface to total depth, deviation surveys must be taken every 500' or each trip, whichever is first. This may entail running the TOTCO on wireline. Record each survey on the IADC Drilling Report Sheet. Maximum allowable change in deviation is 1° per 100'. Maximum deviation allowable is 5°.

Samples: As requested by Wellsite Geological Engineer.

Logs: Mesa Verde to surface: SP/Induction/GR; FDC/CNL/GR
T.D. to Mesa Verde: SP/Induction/GR; FDC/CNL/GR

BLOWOUT EQUIPMENT

From 500' to T.D. as per USGS requirements.

Preventers must be checked for operation every 24 hours with each check recorded on the IADC Drilling Report Sheet.

REPORTS

Drilling reports for the past 24 hours will include depth, footage, time distribution, activity breakdown, mud properties, bit record, bottom hole assembly, daily and cumulative mud costs, plus any other pertinent information, will be called into Tenneco Oil Company, Denver, Colorado, between 7:30 a.m. and 8:00 a.m.

1. 303-758-7130 (Office) Don Barnes
303-758-7287 (Office) Don Barnes' private line, Monday-Friday (before 7:45 a.m.)
303-936-0704 (Home) Don Barnes, weekends and holidays.
2. George Ramsey (Home) 303-771-5154.
3. John Owen (Home) 303-795-0221.

The yellow sheet of the IADC Report is to be filled out completely. The original copy of the drilling time recorder, and copies of any invoices from this well, signed and received for Tenneco Oil Company, will be mailed daily to:

TENNECO OIL COMPANY
ROCKY MOUNTAIN DIVISION
PENTHOUSE, 720 SOUTH COLORADO BOULEVARD
DENVER, COLORADO 80222

ATTENTION: Drilling Department

IN CASE OF EMERGENCY, NOTIFY THE FOLLOWING:

1. Mr. Don Barnes, Division Drilling Engineer.
2. Mr. George E. Ramsey, Jr., Drilling Engineers Supervisor
3. Mr. John W. Owen, Project Drilling Engineer.
4. Mr. Mike Lacey, Division Production Manager (Home 303-979-0509).

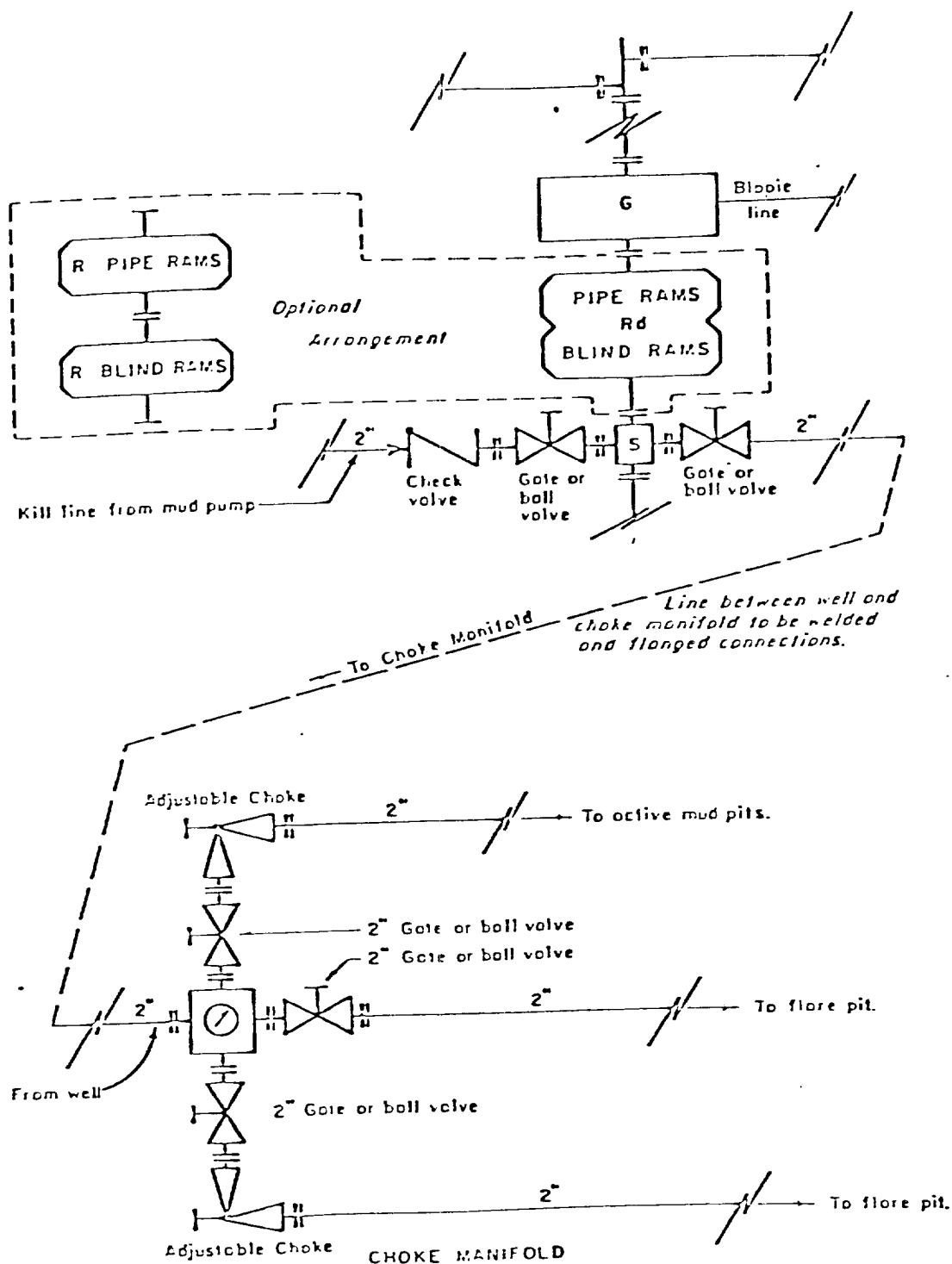

All equipment to be 3,000 psi working pressure except as noted.

- Rd Double ram type preventer with two sets of rams.
- R Single ram type preventer with one set of rams.
- S Drilling spool with side outlet connections for choke and kill lines.
- G Rotating head 150 psi working pressure minimum

ARRANGEMENT C

TENNECO OIL COMPANY
ROCKY MOUNTAIN DIVISION
REQUIRED MINIMUM
BLOWOUT PREVENTER AND
CHOKES MANIFOLD

10 L COM FIELD

TO
NWY
44

Vicinity Map for
TENNECO OIL COMPANY #1-E STATE 16
1110'FSL 1050'FEL Sec. 16-T26N-R8W
SAN JUAN COUNTY, NEW MEXICO

TENNECO OIL COMPANY #1-E STATE 16
1110'FSL 1050'FEL Sec 16-T26N-R8W
SAN JUAN COUNTY, NEW MEXICO

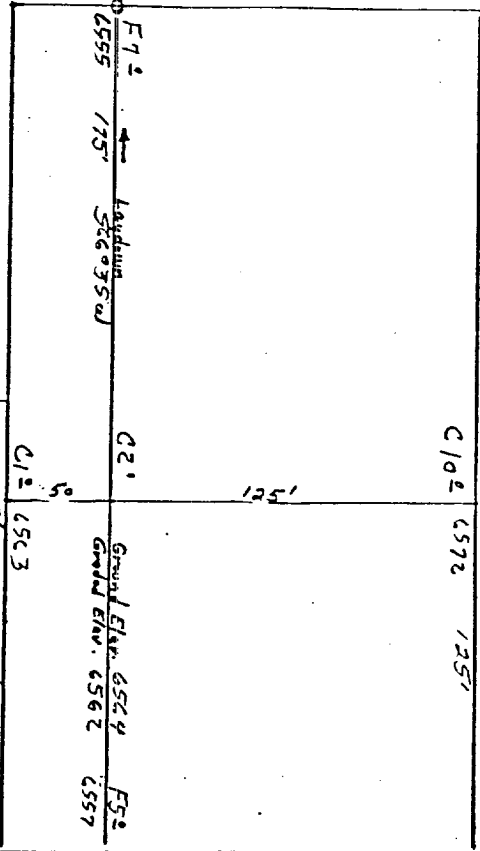

Vert. 1:30'	A-A' &	Horiz. 1"=100'
6570		
6560		
6550		

	B. B'	E
6570		
6560		
6550		

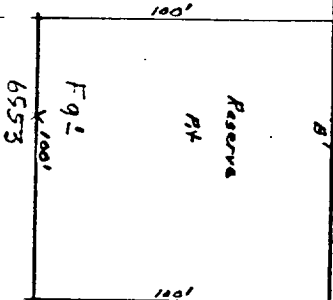

$\text{Year} : \underline{1790}$	C - C'	d	Morale : $\underline{1^{st}} 800$

[illegible]