

UNITED STATES
DEPARTMENT OF THE INTERIOR
BUREAU OF LAND MANAGEMENT

APPLICATION FOR PERMIT TO DRILL, DEEPEN, OR PLUG BACK

1a. TYPE OF WORK

DRILL ☒

DEEPEN ☐

PLUG BACK ☐

b. TYPE OF WELL

OIL
WELL ☐

GAS
WELL ☒

OTHER

SINGLE
ZONE ☒

MULTIPLE
ZONE ☐

2. NAME OF OPERATOR

Merrion Oil & Gas Corporation

3. ADDRESS OF OPERATOR

P. O. Box 840, Farmington, New Mexico 87499

4. LOCATION OF WELL (Report location clearly and in accordance with any State requirements.)*
At surface

1850' FSL & 1840' FWL (NE/SW)

At proposed prod. zone

14. DISTANCE IN MILES AND DIRECTION FROM NEAREST TOWN OR POST OFFICE*

20 miles South of Farmington, New Mexico

15. DISTANCE FROM PROPOSED*

LOCATION TO NEAREST
PROPERTY OR LEASE LINE, FT.
(Also to nearest drig. unit line, if any)

750'

18. DISTANCE FROM PROPOSED LOCATION*
TO NEAREST WELL, DRILLING, COMPLETED,
OR APPLIED FOR, ON THIS LEASE, FT.

3800'

16. NO. OF ACRES IN LEASE

~~480~~ 640

19. PROPOSED DEPTH

1370'

17. NO. OF ACRES ASSIGNED
TO THIS WELL

~~5~~ 320

20. ROTARY OR CABLE TOOLS

Rotary

21. ELEVATIONS (Show whether DF, RT, GR, etc.) This action is subject to technical and
procedural review pursuant to 43 CFR 3165.3
and appeal pursuant to 43 CFR 3165.4.

6109' GL

22. APPROX. DATE WORK WILL START*

June, 1990

23.

PROPOSED CASING AND CEMENTING PROGRAM

DRILLING OPERATIONS AUTHORIZED ARE
SUBJECT TO COMPLIANCE WITH ATTACHED
"GENERAL REQUIREMENTS"

SIZE OF HOLE	SIZE OF CASING	WEIGHT PER FOOT	SETTING DEPTH	QUANTITY OF CEMENT
9-3/4"	7"	20 lb/ft	100'	50 sx (59 cu.ft.)
6-1/4"	4-1/2"	10.5 lb/ft	1370'	130 sx (242 cu.ft.)

Propose to drill 9-3/4" surface hole to 100' KB. Will set approximately 100 ft. of 7", J-55, 20 lb/ft surface casing at 100 ft KB with 50 sx (59 cu.ft.) of Class "B" with 2% CaCl₂. Top of cement at the surface. Wait on cement 10 hours. Nipple up BOPs. Pressure test casing to 600 psi for 30 minutes. Drill 6-1/4" hole to total depth at 1,370 ft. Will run open hole logs. If well appears productive will set 4-1/2", J-55, 10.5 lb/ft production casing at total depth with 85 sx of Class "B" with 2% D-79 (175 cu.ft.) followed by 55 sx (67 cu.ft.) of Class "H" with 2% gel. Estimated top of cement at the surface. Will perforate and stimulate as necessary to test well. Additional program details attached.

holding title to the lease or title to the lease.

RECEIVED
JUL 31 1990

IN ABOVE SPACE DESCRIBE PROPOSED PROGRAM: If proposal is to deepen or plug back, give data on present productive well and proposed new productive zone. If proposal is to drill or deepen directionally, give pertinent data on subsurface locations and measured and true vertical depth. Give flowout preventer program, if any.

24.

SIGNED

Steven S. Dunn

TITLE Operations Manager

DATE APRIL 27, 1990

(This space for Federal or State office use)

PERMIT NO.

APPROVAL DATE

APPROVED
AS AMENDED

APPROVED BY

TITLE

APPROVED
JUL 24 1990
AREA MANAGER

CONDITIONS OF APPROVAL, IF ANY:

NMOOD

*See Instructions On Reverse Side

Submit to Appropriate
District Office
State Lease - 4 copies
Fee Lease - 3 copies

State of New Mexico
Energy, Minerals and Natural Resources Department

Form C-182
Revised 1-1-80

OIL CONSERVATION DIVISION

DISTRICT I
P.O. Box 1980, Hobbs, NM 88240

P.O. Box 2088

Santa Fe, New Mexico 87504-2088

DISTRICT II
P.O. Drawer DD, Artesia, NM 88210

DISTRICT III
1000 Rio Brazos Rd., Aztec, NM 87410

WELL LOCATION AND ACREAGE DEDICATION PLAT

All Distances must be from the outer boundaries of the section

Operator MERRION OIL & GAS CORPORATION			Lease HICKMAN		Well No. 9
Unit Letter K	Section 15	Township 26 N	Range 12 W	County San Juan	
Actual Footage Location of Well: 1850 feet from the South line and 1840 feet from the West line					
Ground level Elev. 6109	Producing Formation Fruitland		Pool Basin		Dedicated Acreage: 320 Acres
<p>1. Outline the acreage dedicated to the subject well by colored pencil or hatchure marks on the plat below.</p> <p>2. If more than one lease is dedicated to the well, outline each and identify the ownership thereof (both as to working interest and royalty).</p> <p>3. If more than one lease of different ownership is dedicated to the well, have the interest of all owners been consolidated by communitization, unitization, force-pooling, etc.?</p> <p><input type="checkbox"/> Yes <input type="checkbox"/> No If answer is "yes" type of consolidation _____</p> <p>If answer is "no" list the owners and tract descriptions which have actually been consolidated. (Use reverse side of this form if necessary.) _____</p> <p>No allowable will be assigned to the well until all interests have been consolidated (by communitization, unitization, forced-pooling, or otherwise) or until a non-standard unit, unitizing such interest, has been approved by the Division.</p>					

0 330 660 990 1320 1650 1980 2310 2640 2000 1500 1000 500 0

N 89°55'W

79.98 ch.

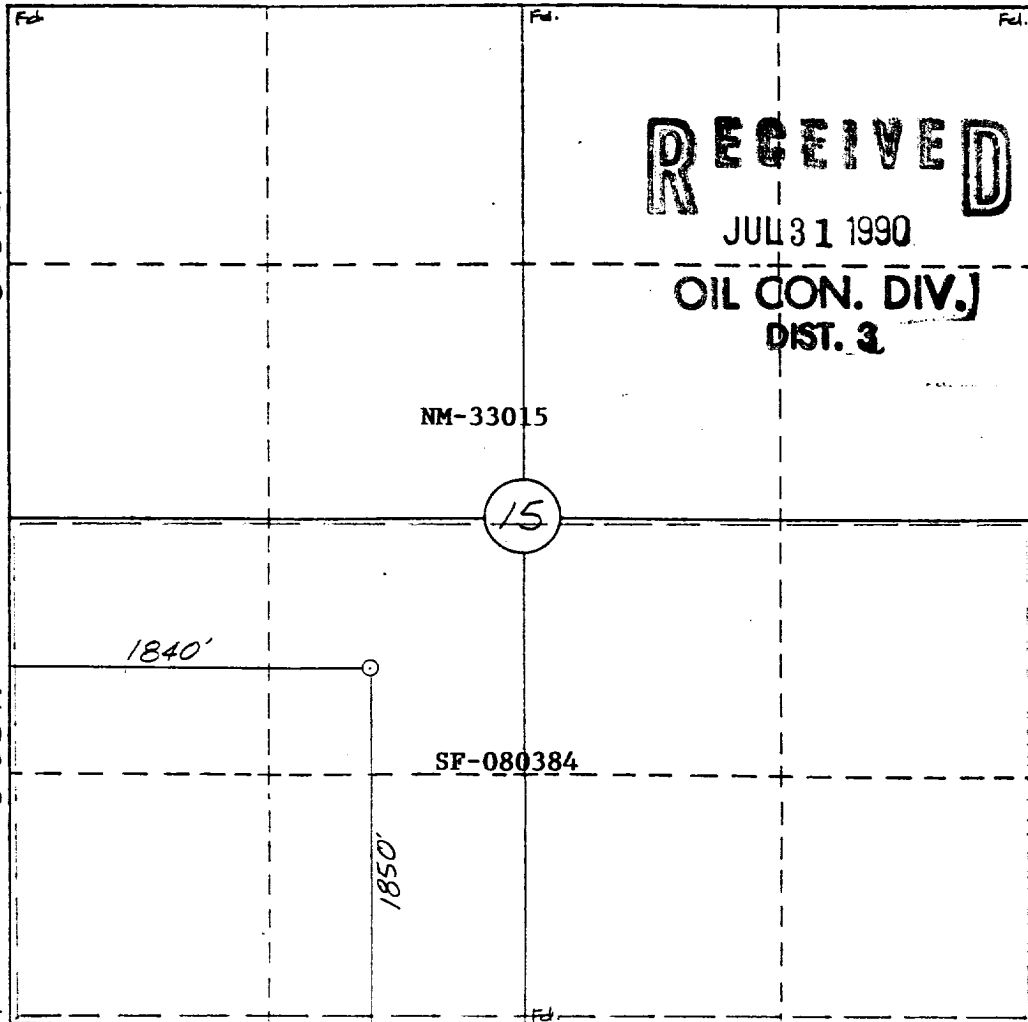

OPERATOR CERTIFICATION

I hereby certify that the information contained herein is true and complete to the best of my knowledge and belief.

Signature

Printed Name

Steven S. Dunn

Position

Operations Manager

Company

Merrion Oil & Gas Corp.

Date

APRIL 27, 1990

SURVEYOR CERTIFICATION

I hereby certify that the well location shown on this plat was plotted from field notes of actual surveys made by me or under my supervision, and that the same is true and correct to the best of my knowledge and belief.

4-12-90

Date Surveyed

William F. Mahrke II

Signature & Seal of Professional Surveyor

Certificate No.

8466

UNITED STATES
DEPARTMENT OF THE INTERIOR
GEOLOGICAL SURVEY

