

(SUBMIT IN TRIPLICATE)

UNITED STATES
DEPARTMENT OF THE INTERIOR
GEOLOGICAL SURVEY

Land Office Santa Fe
Lease No. 078498
Unit San Juan 28-7 Unit
14-08-001-499

SUNDRY NOTICES AND REPORTS ON WELLS

NOTICE OF INTENTION TO DRILL.....	<input checked="" type="checkbox"/>	SUBSEQUENT REPORT OF WATER SHUT-OFF.....	
NOTICE OF INTENTION TO CHANGE PLANS.....		SUBSEQUENT REPORT OF SHOOTING OR ACIDIZING.....	
NOTICE OF INTENTION TO TEST WATER SHUT-OFF.....		SUBSEQUENT REPORT OF ALTERING CASING.....	
NOTICE OF INTENTION TO RE-DRILL OR REPAIR WELL.....		SUBSEQUENT REPORT OF RE-DRILLING OR REPAIR.....	
NOTICE OF INTENTION TO SHOOT OR ACIDIZE.....		SUBSEQUENT REPORT OF ABANDONMENT.....	
NOTICE OF INTENTION TO PULL OR ALTER CASING.....		SUPPLEMENTARY WELL HISTORY.....	
NOTICE OF INTENTION TO ABANDON WELL.....			

(INDICATE ABOVE BY CHECK MARK NATURE OF REPORT, NOTICE, OR OTHER DATA)

January 29, 1957

Well No. 77 (14) is located 000 ft. from S line and 1400 ft. from W line of sec. 32

SW Section 32 (1/4 Sec. and Sec. No.) 28N (Twp.) 7W (Range) 1337N (Meridian)

So. Blanco Ext. & Blanco (Field) Rio Arriba (County or Subdivision) New Mexico (State or Territory)

The elevation of the derrick floor above sea level is 6736 ft.

DETAILS OF WORK

(State names of and expected depths to objective sands; show sizes, weights, and lengths of proposed casings; indicate mudding jobs, cementing points, and all other important proposed work)

It is intended to drill & dual complete a well in the Pictured Cliffs formation & Mesa Verde formation. Mud circulation will be used thru the Pictured Cliffs formation & set intermediate casing. Gas circulation will be used thru the Mesa Verde & a production liner will be set. Possible productive intervals will be perforated & fractured. Estimated Total Depth 5665'.

Casing Program:

10 3/4" at 170' with 125 sacks cement circulated to the surface.

7 5/8" at 3465' with 250 sacks cement.

5 1/2" liner at 5665' with 300 sacks cement.

The W/2 of Section 32 is dedicated to the Mesa Verde.

The SW 1/4 of Section 32 is dedicated to the Pictured Cliffs.

W/2 SW 078498.

I understand that this plan of work must receive approval in writing by the Geological Survey before operations may be commenced.

Company El Paso Natural Gas Company

Address Box 997

Farmington, New Mexico

By W. F. Corvett

Title Petroleum Engineer





NEW MEXICO
OIL CONSERVATION COMMISSION

Form OC-129

WELL LOCATION AND/OR GAS PRORATION PLAT

DATE JANUARY 22, 1957

APPROPRIATE EL PASO NATURAL GAS COMPANY SAN JUAN 28-7 UNIT SF 078498

WELL OF 77 (PM) SECTION 32 TOWNSHIP 28-N RANGE 7-W NMPN

RODENT 800 FEET FROM SOUTH 1460 FEET FROM WEST

RIO ARRIBA

N.V. & P.C.

SO. BLANCO EXT. P.C.
BLANCO N.V.

6726
155.36 AC.
315.36 AC.
(1917 PLAT)

Note: All points are located from corner boundaries of section.

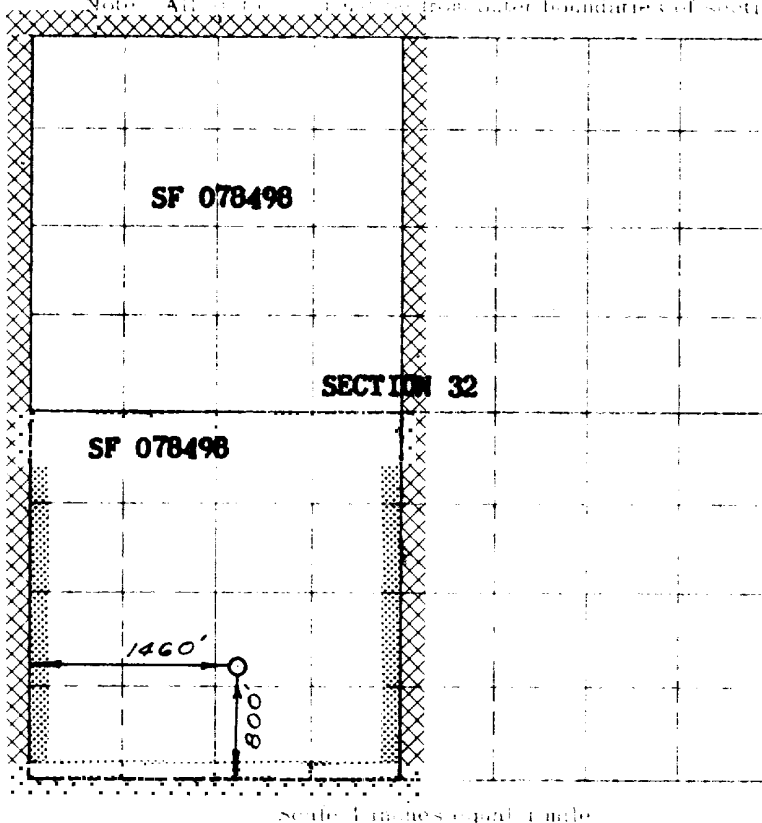

JAN 22 1957
RECEIVED
OIL CONSERVATION COMMISSION

NOTE

This section of
form is to be used
for gas wells only

This is to certify that the above plat was prepared from
field notes of actual surveys made by me or under my
supervision and that the same are true and correct to the
best of my knowledge and belief.

Date Surveyed DECEMBER 27, 1956

W. F. Walker
Registered Professional Engineer and/or Land Surveyor

1. Is this well a Dual Comp.

Yes X No

2. If the answer to Question 1
is yes, are there any other dually
completed wells within the
dedicated acreage.

Yes No X

Name W. F. Walker

Position Petroleum Engineer

Representing El Paso Natural Gas Co.

Address Box 997, Farmington, N.M.

(Seal)