

(SUBMIT IN TRIPLICATE)

Land Office

Lease No. CF-079294

Unit 28-7 (San Juan)

UNITED STATES
DEPARTMENT OF THE INTERIOR
GEOLOGICAL SURVEY

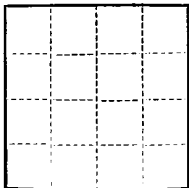

SUNDRY NOTICES AND REPORTS ON WELLS

NOTICE OF INTENTION TO DRILL	<input checked="" type="checkbox"/>	SUBSEQUENT REPORT OF WATER SHUT-OFF
NOTICE OF INTENTION TO CHANGE PLANS	<input type="checkbox"/>	SUBSEQUENT REPORT OF SHOOTING OR ACIDIZING
NOTICE OF INTENTION TO TEST WATER SHUT-OFF	<input type="checkbox"/>	SUBSEQUENT REPORT OF ALTERING CASING
NOTICE OF INTENTION TO RE-DRILL OR REPAIR WELL	<input type="checkbox"/>	SUBSEQUENT REPORT OF RE-DRILLING OR REPAIR
NOTICE OF INTENTION TO SHOOT OR ACIDIZE	<input type="checkbox"/>	SUBSEQUENT REPORT OF ABANDONMENT
NOTICE OF INTENTION TO PULL OR ALTER CASING	<input type="checkbox"/>	SUPPLEMENTARY WELL HISTORY
NOTICE OF INTENTION TO ABANDON WELL	<input type="checkbox"/>	

(INDICATE ABOVE BY CHECK MARK NATURE OF REPORT, NOTICE, OR OTHER DATA)

August 10, 1953

(San Juan 28-7)

Well No. 10 is located 990 ft. from SW line and 1120 ft. from W line of sec. 36

SW 1/4 Section 36

(1/4 Sec. and Sec. No.)

28N

(Twp.)

7W

(Range)

M1PM

(Meridian)

Blanco Mesa Verde

(Field)

Rio Arriba

(County or Subdivision)

New Mexico

(State or Territory)

The elevation of the derrick floor above sea level is 6119 ft.

DETAILS OF WORK

(State names of and expected depths to objective sands; show sizes, weights, and lengths of proposed casings; indicate mudding jobs, cementing points, and all other important proposed work)

It is proposed to drill with rotary mud to the top of the Mesa Verde formation, estimated to be at a depth of 4700 ± and thereafter to drill with gas through the Mesa Verde formation on to the top of the Mancos shale, final TD estimated to be 5400 ±. It is further proposed to shoot the entire mesa Verde section with solid nitro-glycerine. Tentative casing program is as follows:

10 3/4" surface casing, 190' - 250'
7" casing 400 ± cement w/200-300 lbs

The W/2 of the section is the designated drilling unit.

A blanket drilling bond has been approved



I understand that this plan of work must receive approval in writing by the Geological Survey before operations may be commenced.

Company Putco Development, Inc.

Address P.O. Box 1360

Albuquerque, New Mexico

By Frank D. Gorham Jr.

Title Vice President

Company..... Pubco Development, Inc.

Lease..... Pubco Appel..... Well No... Fed... #2

Sec..... 36....., T..... 28 N....., R..... 7 W....., N.M.P.M.....

Location..... 990' from the South line and 1120' from the West line.

Elevation..... 6111 Ungraded ground.....

Rio Arriba County

New Mexico

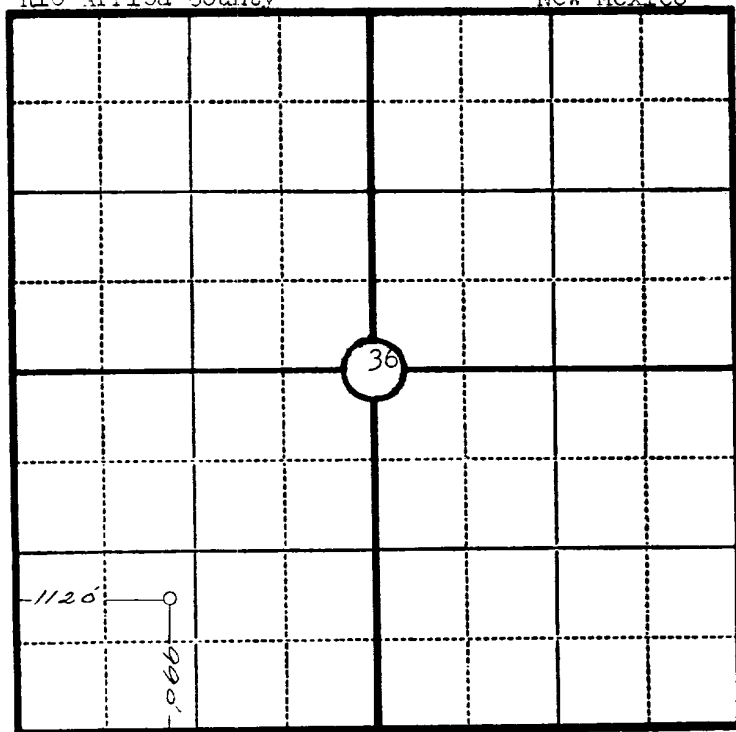

Scale—4 inches equal 1 mile.

This is to certify that the above plat was prepared from field notes of actual surveys made by me or under my supervision and that the same are true and correct to the best of my knowledge and belief.

Ernest V. Echohawk

Seal:

Registered Professional Engineer and Land Surveyor.

Ernest V. Echohawk
N. Mex. Reg. No. 1545

Surveyed..... August 3....., 19.....53