

NEW MEXICO OIL CONSERVATION COMMISSION
Santa Fe, New Mexico

NOTICE OF INTENTION TO DRILL OR RECOMPLETE

Notice must be given to the District Office of the Oil Conservation Commission and approval obtained before drilling or recompletion begins. If changes in the proposed plan are considered advisable, a copy of this notice showing such changes will be returned to the sender. Submit this notice in QUINTUPLICATE. One copy will be returned following approval. See additional instructions in Rules and Regulations of the Commission.

Farmington, New Mexico

(Place)

May 29, 1956

(Date)

OIL CONSERVATION COMMISSION
SANTA FE, NEW MEXICO

Gentlemen:

You are hereby notified that it is our intention to commence the (Drilling) (~~Recompletion~~) of a well to be known as

El Paso Natural Gas Company

(Company or Operator)

San Juan 28-5 Unit

(Lease)

15

M
(Unit)

located **990** feet from the **South** line and **860** feet from the

West

line of Section **34**, T. **28N**, R. **5W**, NMPM.

(GIVE LOCATION FROM SECTION LINE)

Blanco

Pool,

Rio Arriba

County

If State Land the Oil and Gas Lease is No.

Forrest B. Miller

If patented land the owner is.

Address.

We propose to drill well with drilling equipment as follows: **Rotary tools, using gas circulation to drill from the Lewis thru the Mesa Verde form.**

The status of plugging bond is **Statewide**

Drilling Contractor **Great Western Drlg. Co.**

We intend to complete this well in the **Mesa Verde** formation at an approximate depth of **5855** feet.

CASING PROGRAM

We propose to use the following strings of Casing and to cement them as indicated:

Size of Hole	Size of Casing	Weight per Foot	New or Second Hand	Depth	Setting Cement
13 3/4"	10 3/4"	32.75#	New	170'	245
8 3/4"	7 5/8"	26.4	New	3895'	250
6 1/4"	5 1/2"	15.50	New	3855'	150

If changes in the above plans become advisable we will notify you immediately.

ADDITIONAL INFORMATION (If recompletion give full details of proposed plan of work.) **Possible productive zones in the Mesa Verde will be perforated and fractured. The S/4 of Section 34 is dedicated to this well. S/2 Forrest B. Miller (SW/4), SF 079522 (N/2SW/4, S/2SE), F&W Fee (SESE).**

Approved.....
Except as follows:

Sincerely yours,

El Paso Natural Gas Company

(Company or Operator)

By.....

Petroleum Engineer

Send Communications regarding well to

Name **E. J. Cook**

Address **Box 997, Farmington, N.M.**

OIL CONSERVATION COMMISSION

By.....

Title **Oil and Gas Inspector Dist. #3.**

NEW MEXICO
OIL CONSERVATION COMMISSION

Form O-128

WELL LOCATION AND/OR GAS PRORATION PLAT

DATE MAY 17, 1956

OPERATOR EL PASO NATURAL GAS COMPANY LEASE SAN JUAN 28-5 UNIT FEE

WELL NO. 15 SECTION 34 TOWNSHIP 28-N RANGE 5-W NMPM

DEPT. 990 FEET FROM SOUTH LINE 860 FEET FROM WEST LINE

RIO ARRIBA COUNTY, NEW MEXICO ELEVATION 6625

SECTION MESA VERDE TOWN BLANCO STATE ACRES 343.6
(1917 PLAT)

Note: All distances must be from outer boundaries of section.

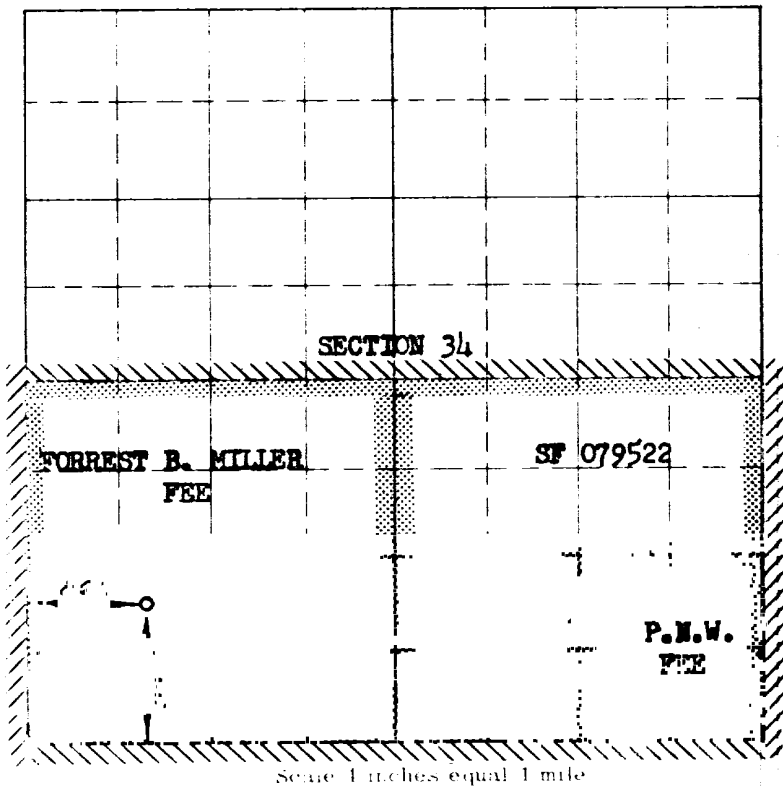

NOTE

This section of
form is to be used
for gas wells only

This is to certify that the above plat was prepared from
field notes of actual surveys made by me or under my
supervision and that the same are true and correct to the
best of my knowledge and belief.

Date Surveyed MAY 11, 1956

C. O. Walker
Registered Professional Engineer and ~~Surveyor~~ and Surveyor

1. Is this well a Dual Comp.

Yes _____ No X

2. If the answer to Question 1
is yes, are there any other dually
completed wells within the
dedicated acreage.

Yes _____ No _____

Name J. W. Boyd

Position Petroleum Engineer

Representing El Paso Natural Gas Co.

Address Box 997, Farmington, N.M.

(Seal)

Farmington, New Mexico

OIL CONSERVATION COMMISSION

AZTEC DISTRICT OFFICE

No. Copies Received

5

DISTRIBUTION

	NO. FURNISHED	
Operator	1	
Santa Fe	1	
Proration Office		
State Land Office		
U. S. G. S.	2	
Transporter		
File	1	✓