

## NEW MEXICO OIL CONSERVATION COMMISSION

## Well Location and Acreage Dedication Plat

## Section A.

Date August 23, 1962

Operator STANDARD OIL COMPANY OF TEXAS Lease JICARILLA 4-26  
 Well No. 1 Unit Letter F Section 26 Township 28 NORTH Range 1 WEST NMPM  
 Located 1785 Feet From the NORTH Line 1840 Feet From the WEST Line  
 County RIO ARriba G. L. Elevation 7203.0 Dedicated Acreage 1.00 Acres  
 Name of Producing Formation Gallup Pool San Juan (Nueces)

1. Is the Operator the only owner in the dedicated acreage outlined on the plat below?

Yes ☒ No ☐2. If the answer to question one is "no", have the interests of all the owners been consolidated by communitization agreement or otherwise? Yes ☐ No ☐ If answer is "yes", Type of Consolidation.

3. If the answer to question two is "no", list all the owners and their respective interests below:

Owner

Land Description

RECEIVED

1962

## Section B.

Note: All distances must be from outer boundaries of section.

This is to certify that the information  
 in Section A above is true and complete  
 to the best of my knowledge and belief.

Standard Oil Co. of Texas & div. of  
California Oil Company

(Operator)  
D. L. F. 111  
(Representative)

301 N. 1st St.  
(Address)

El Paso, Texas

Ref. GLO Plat Dated 25 June 1892

RECEIVED  
 AUG 27 1962  
 N. COM.  
 T. 3

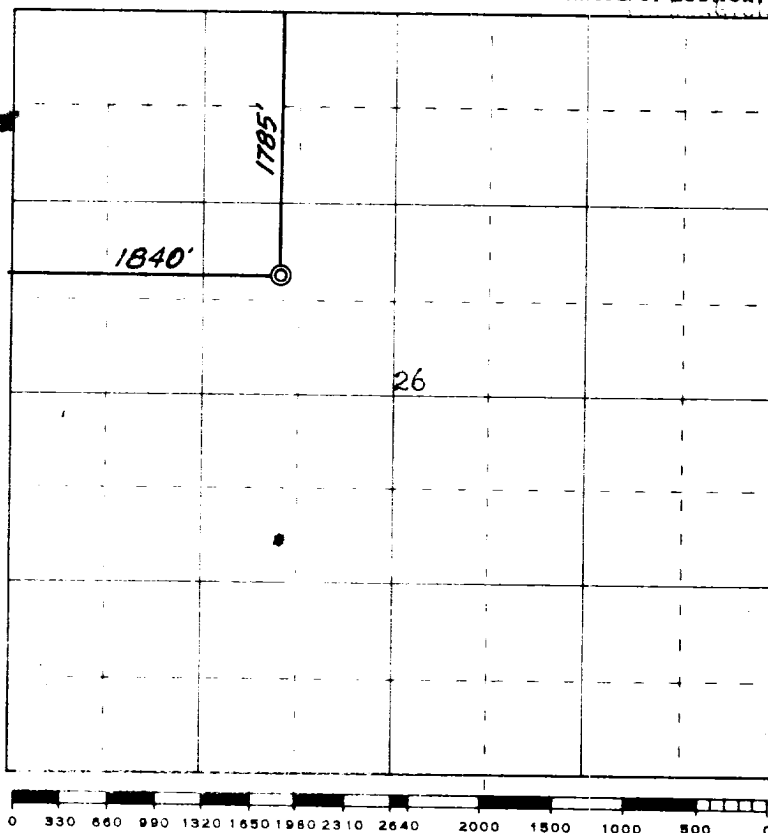

This is to certify that the above plat was prepared from field notes of actual surveys made by me or under my supervision and that the same are true and correct to the best of my knowledge and belief.

Date Surveyed 19 July 1962

James P. Leese  
 Registered Professional Engineer and/or Land Surveyor  
 James P. Leese N. Mex. Reg. No. 1463