

NEW MEXICO OIL CONSERVATION COMMISSION

Santa Fe, New Mexico

Form C-101
Revised (12/1/55)

NOTICE OF INTENTION TO DRILL

Notice must be given to the District Office of the Oil Conservation Commission and approval obtained before drilling or recompletion begins. If changes in the proposed plan are considered advisable, a copy of this notice showing such changes will be returned to the sender. Submit this notice in QUINTUPLICATE. One copy will be returned following approval. See additional instructions in Rules and Regulations of the Commission. If State Land submit 6 Copies Attach Form C-128 in triplicate to first 3 copies of form C-101

Farmington, New Mexico

(Place)

March 3, 1961

(Date)

OIL CONSERVATION COMMISSION
SANTA FE, NEW MEXICO

Gentlemen:

You are hereby notified that it is our intention to commence the Drilling of a well to be known as

El Paso Natural Gas Company

(Company or Operator)

San Juan 28-5 Unit

(Lease)

Well No. 52in G

(Unit)

The well is

located 1650 feet from the North line and 1550 feet from theEastline of Section 33, T. 28-N, R. 5-W, NMPM.

(GIVE LOCATION FROM SECTION LINE)

Blanco

Pool,

Rio Arriba

County

If State Land the Oil and Gas Lease is No.

If patented land the owner is Mangum

Address

We propose to drill well with drilling equipment as follows: Rotary tools, using gas circulation to drill from the Lewis thru the M. V. formationThe status of plugging bond is Statewide

Drilling Contractor

RECEIVED

MAR 6 1961

We intend to complete this well in the Mesa Verdeformation at an approximate depth of 5800'

CASING PROGRAM

We propose to use the following strings of Casing and to cement them as indicated:

Size of Hole	Size of Casing	Weight per Foot	New or Second Hand	Depth	Sacks Cement
13 3/4"	9 5/8"	32.3	New	120	100
8 3/4"	7"	23	New	3670	80
6 1/4"	2 7/8"	6.4	New	5800	120

If changes in the above plans become advisable we will notify you immediately.

ADDITIONAL INFORMATION (If recompletion give full details of proposed plan of work.)

Possible productive intervals in the Mesa Verde will be perforated and fractured.**The N/2 of Section 33 is dedicated to this well.**Approved 3-6-61, 19 61
Except as follows:

Sincerely yours,

El Paso Natural Gas Company

(Company or Operator)

By ORIGINAL SIGNED J.J. TILLERSONPosition Petroleum Engineer

Send Communications regarding well to

Name E. S. OberlyAddress Box 990, Farmington, N.M.

OIL CONSERVATION COMMISSION

By James C. [Signature]

NEW MEXICO OIL CONSERVATION COMMISSION

Well Location and Acreage Dedication Plat

Section A.

Date **FEBRUARY 21, 1961**

Operator **EL PASO NATURAL GAS COMPANY** Lease **SAN JUAN 28-5 UNIT** **FEE**
 Well No. **52** Unit Letter **G** Section **33** Township **28-N** Range **5-W** NMPM
 Located **1650** Feet From **NORTH** Line **1550** East From **EAST** Line
 County **RIO ARriba** G. L. Elevation **6601** Dedication Acreage **320** Acres
 Name of Producing Formation **MESA VERDE** Pool **BLANCO MESA VERDE**

1. Is the Operator the only owner in the dedicated acreage outlined on this plat below?
 Yes ☒ No ☐
2. If the answer to question one is "no", have the interests of all the owners been consolidated by communitization agreement or otherwise? Yes ☒ No ☐ If answer is "yes", Type of Consolidation:
Unit Agreement

3. If the answer to question two is "no", list all the owners and their respective interests below:

Owner

Land Description



Section B.

This is to certify that the information in Section A above is true and complete to the best of my knowledge and belief.

El Paso Natural Gas Company'

Operator:
ORIGINAL SIGNED J.J. TILLERSON
Box 990 Representative:
Farmington, New Mexico

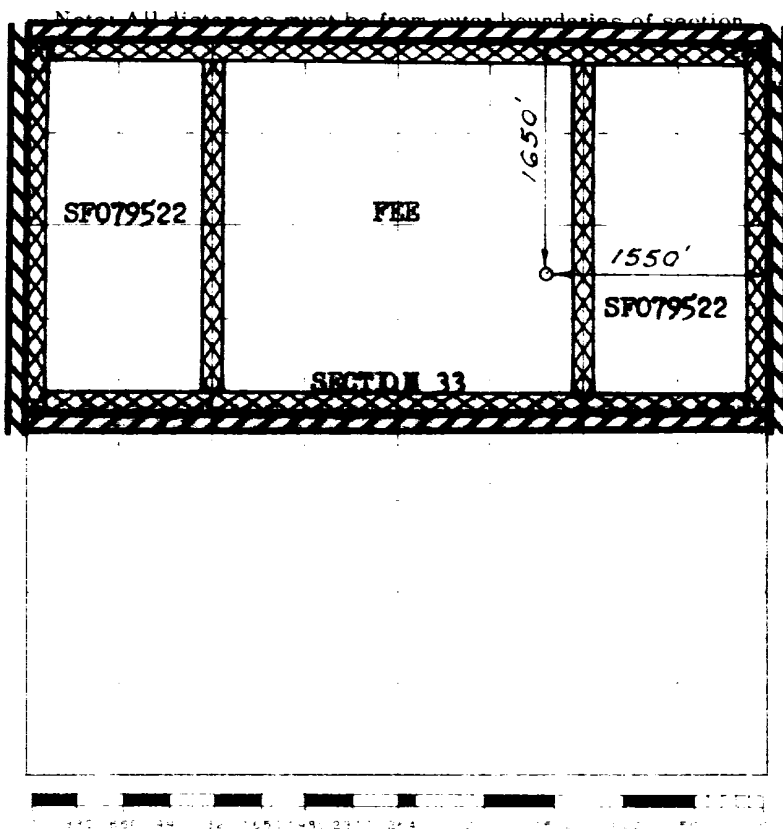

Scale: 1 inch equals 1 mile

This is to certify that the above plat was prepared from the notes of actual surveys made by me or under my supervision, and that the same are true and correct to the best of my knowledge and belief.

(Seal)

Date Surveyed

FEBRUARY 9, 1961

David O. Kilness
 Registered Professional Engineer and/or Land Surveyor

Farmington, New Mexico