

(SUBMIT IN TRIPLICATE)

UNITED STATES
DEPARTMENT OF THE INTERIOR
GEOLOGICAL SURVEY

Land Office Santa Fe
Lease No. 078496-A
Unit San Juan 28-7 Unit
14-08-001-459

SUNDRY NOTICES AND REPORTS ON WELLS

NOTICE OF INTENTION TO DRILL.....	<input checked="" type="checkbox"/>	SUBSEQUENT REPORT OF WATER SHUT-OFF.....	
NOTICE OF INTENTION TO CHANGE PLANS.....		SUBSEQUENT REPORT OF SHOOTING OR ACIDIZING.....	
NOTICE OF INTENTION TO TEST WATER SHUT-OFF.....		SUBSEQUENT REPORT OF ALTERING CASING.....	
NOTICE OF INTENTION TO RE-DRILL OR REPAIR WELL.....		SUBSEQUENT REPORT OF RE-DRILLING OR REPAIR.....	
NOTICE OF INTENTION TO SHOOT OR ACIDIZE.....		SUBSEQUENT REPORT OF ABANDONMENT.....	
NOTICE OF INTENTION TO PULL OR ALTER CASING.....		SUPPLEMENTARY WELL HISTORY.....	
NOTICE OF INTENTION TO ABANDON WELL.....			

(INDICATE ABOVE BY CHECK MARK NATURE OF REPORT, NOTICE, OR OTHER DATA)

March 19, 1958

Well No. 921(24) is located 836 ft. from (N) line and 1544 ft. from (E) line of sec. 34

NE Sec. 34 28N 7W N.M.P.M.
(1/4 Sec. and Sec. No.) (Twp.) (Range) (Meridian)
Blanco M.V., Co. Blanco P.C. Rio Arriba New Mexico
(Field) (County or Subdivision) (State or Territory)

The elevation of the derrick floor above sea level is 6089 ft.

DETAILS OF WORK

(State names of and expected depths to objective sands; show sizes, weights, and lengths of proposed casings; indicate mudding jobs, cementing points, and all other important proposed work)

It is intended to drill & ~~and~~ complete a well in the Pictured Cliffs formation & Mesa Verde formation. Mud circulation will be used thru the Pictured Cliffs formation & set intermediate casing. Gas circulation will be used thru the Mesa Verde & a production liner will be set. Possible productive intervals will be perforated & fractured. Estimated Total Depth 5088'.

Casing Program:

- 10 3/4" at 170' with 125 sacks cement circulated to the surface.
- 7 5/8" at 2893' with 250 sacks cement.
- 5 1/2" liner at 5088' with 300 sacks cement.

The NE/4 of Section 34 is dedicated to the Mesa Verde.
The E/2 of Section 34 is dedicated to the Pictured Cliffs.

E/2: Santa Fe 078496-A

I understand that this plan of work must receive approval in writing by the Geological Survey before operations may be commenced.

Company El Paso Natural Gas Company

Address Box 997
Farmington, New Mexico

By Original Signed D. C. Johnson
Title Petroleum Engineer

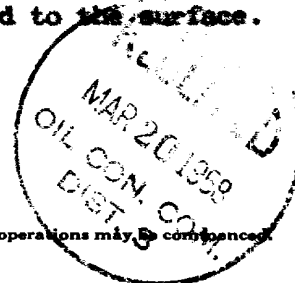

NEW MEXICO OIL CONSERVATION COMMISSION

Well Location and Acreage Dedication Plat

Section A.

Date **MARCH 17, 1958**

Operator **EL PASO NATURAL GAS COMPANY** Lease **SAN JUAN 28-7 UNIT** SF **078496-A**
 Well No. **91 (PM)** Unit Letter **B** Section **34** Township **28-N** Range **7-W** NMPM
 Located **836** Feet From **NORTH** Line **1544** Feet From **EAST** Line
 County **RIO ARriba** G. L. Elevation **6079** Indiv. Acreage **321.87 & 160** Acre
 Name of Producing Formation **MESA VERDE & PICTURED CLIFF** Pool **BLANCO M.V. & SO. BLANCO P.C.**

1. Is the Operator the only owner in the dedicated acreage outlined on this plat below?
 Yes ☒ No ☐
2. If the answer to question one is "No", have the interests of all the owners been acquired fully by contract, purchase agreement or otherwise? Yes ☐ No ☐ If answer is "Yes", Please give explanation.
3. If the answer to question two is "No", list all the owners and their respective interests in the

Owner

Land Description

RECORDED
 MARCH 18 1958
 U. S. GEOLOGICAL SURVEY
 FARMINGTON, NEW MEXICO

Section B.

This is to certify that the information in Section A above is true and complete to the best of my knowledge and belief.

El Paso Natural Gas Company
 (Operator)
Original Signed D. C. Johnston
 (Representative)
Box 997
 (Address)
Farmington, New Mexico

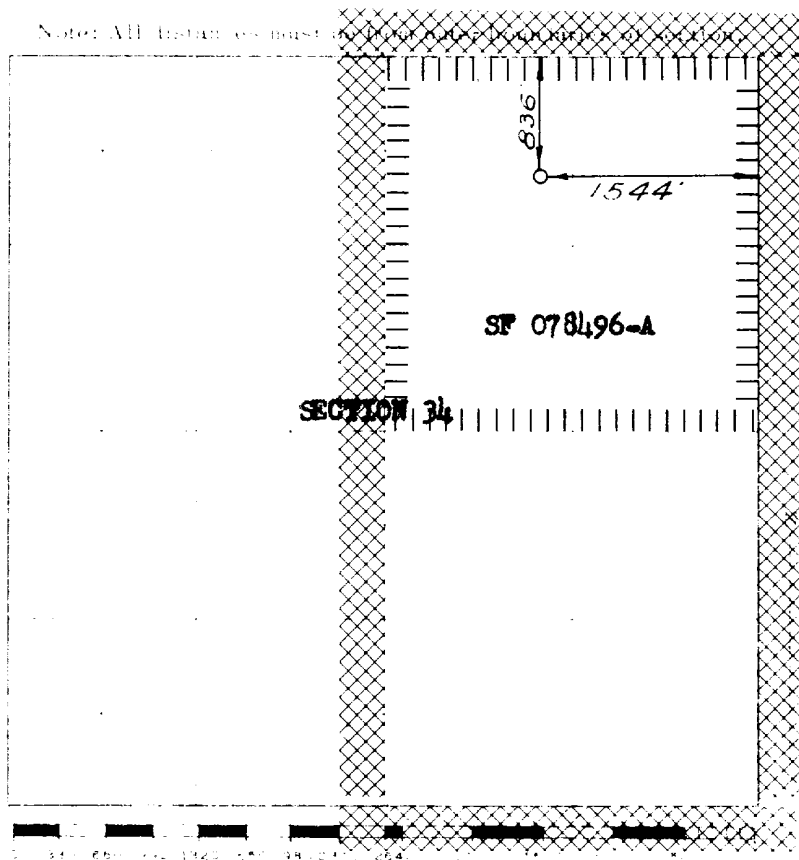

Scale: 1 inch = equal 1 mile

This is to certify that the above plat was prepared from all notes and surveys made by me or under my supervision and that the same are true and correct to the best of my knowledge and belief.

(Seal)

Date Signed **FEBRUARY 10, 1958**

David O. Vilmer
 Registered Professional Engineer and Surveyor

Farmington, New Mexico