

(SUBMIT IN TRIPLICATE)

UNITED STATES
DEPARTMENT OF THE INTERIOR
GEOLOGICAL SURVEY

Land Office Santa Fe

Lease No. 079730

Unit San Juan 28-4 Unit
14-03-001-933

SUNDRY NOTICES AND REPORTS ON WELLS

NOTICE OF INTENTION TO DRILL.....	<input checked="" type="checkbox"/>	SUBSEQUENT REPORT OF WATER SHUT-OFF.....	
NOTICE OF INTENTION TO CHANGE PLANS.....		SUBSEQUENT REPORT OF SHOOTING OR ACIDIZING.....	
NOTICE OF INTENTION TO TEST WATER SHUT-OFF.....		SUBSEQUENT REPORT OF ALTERING CASING.....	
NOTICE OF INTENTION TO RE-DRILL OR REPAIR WELL.....		SUBSEQUENT REPORT OF RE-DRILLING OR REPAIR.....	
NOTICE OF INTENTION TO SHOOT OR ACIDIZE.....		SUBSEQUENT REPORT OF ABANDONMENT.....	
NOTICE OF INTENTION TO PULL OR ALTER CASING.....		SUPPLEMENTARY WELL HISTORY.....	
NOTICE OF INTENTION TO ABANDON WELL.....			

(INDICATE ABOVE BY CHECK MARK NATURE OF REPORT, NOTICE, OR OTHER DATA)

June 12, 1959

Well No. 24-26(MD) is located 920 ft. from S line and 1675 ft. from W line of sec. 26

SW Sec. 26 (1/4 Sec. and Sec. No.) 26N (Twp.) 4W (Range) N.M.P.M. (Meridian)

Blanco M. V. & Wildeat Dakota (Field) Rio Arriba (County or Subdivision) New Mexico (State or Territory)

The elevation of the derrick floor above sea level is 7280 ft.

DETAILS OF WORK

(State names of and expected depths to objective sands; show sizes, weights, and lengths of proposed casings; indicate mudding jobs, cementing points, and all other important proposed work)

It is intended to drill & dual complete a well in the Dakota formation & Mesa Verde formation. Mud circulation will be used thru the Pictured Cliffs and set intermediate casing. Gas circulation will be used thru the middle of the Greenhorn formation & 7" liner will be set. Mud circulation will be used thru the Dakota formation & production liner will be set. Possible productive intervals will be perforated and fractured. Est. T. D. 8695'.

Casing Program:

- 13 3/8" at 300' w/450 sks. cement circulated to surface.
- 9 5/8" at 4484' w/860 sks. cement in two stages.
- 7" at 8250' w/600 sks. cement.
- 5" at 8695' w/200 sks. cement.

The S/2 of Section 26 is dedicated to the Mesa Verde formation.
The S/2 of Section 26 is dedicated to the Dakota formation.

I understand that this plan of work must receive approval in writing by the Geological Survey before operations may be commenced.

Company El Paso Natural Gas Company

Address Box 997

Farmington, New Mexico

By ORIGINAL SIGNED J.J. TILLERSON

Title Petroleum Engineer

NEW MEXICO OIL CONSERVATION COMMISSION

Well Location and Acreage Dedication Plat

Section A.

Date **JUNE 12, 1959**

Operator **EL PASO NATURAL GAS COMPANY** Lease **SAN JUAN 28-4 UNIT** SF **079730**
 Well No. **24-26(MD)** Unit Letter **N** Section **26** Township **28-N** Range **4-W** NMDM
 Located **920** Feet From **SOUTH** Line, **1675** Feet From **WEST** Line
 County **RIO ARriba** G. L. Elevation **7270** Dedicated Acreage **320 & 320** Acres
 Name of Producing Formation **MESA VERDE AND DAKOTA** Pool **BLANCO MV & WILDCAT DAKOTA**

1. Is the Operator the only owner in the dedicated acreage outlined on the plat below?
 Yes _____ No **X**
2. If the answer to question one is "no", have the interests of all the owners been consolidated by communitization agreement or otherwise? Yes **X** No _____. If answer is "yes", Type of Consolidation.

Unit Agreement

3. If the answer to question two is "no", list all the owners and their respective interests below:

Owner

Land Description



Section B.

Note: All distances must be from outer boundaries of section.

This is to certify that the information in Section A above is true and complete to the best of my knowledge and belief.

El Paso Natural Gas Company
 (Operator)
ORIGINAL SIGNED J.J. TILLERSON
 (Representative)

Box 997
 (Address)

Farmington, New Mexico

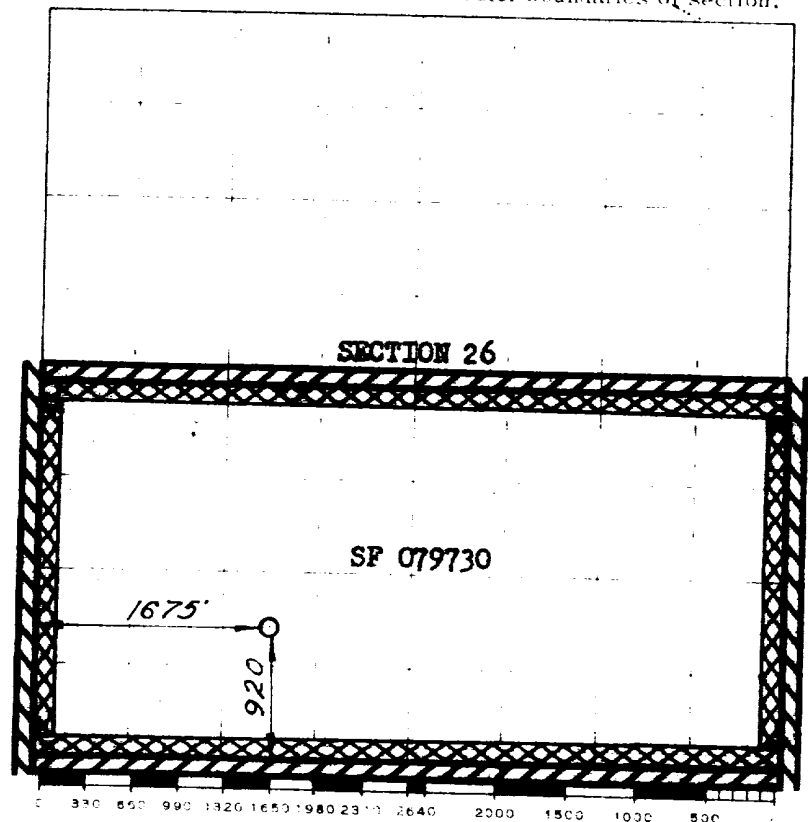

Scale 4 inches equal 1 mile

This is to certify that the above plat was prepared from field notes of actual surveys made by me or under my supervision and that the same are true and correct to the best of my knowledge and belief.

(Seal)

Date Surveyed **MAY 27, 1959**

C. O. Walker
 Registered Professional Engineer and/or Land Surveyor

Farmington, New Mexico