

LTR

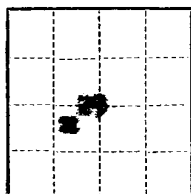

Job separation sheet



5- 1000
1- L.C. Tracy
2- 12 Page
1- 111a

(SUBMIT IN TRIPLICATE)

UNITED STATES
DEPARTMENT OF THE INTERIOR
GEOLOGICAL SURVEY

Land Office Santa Fe

Lease No. 37 0790-30

Unit 22-6

114-01-001-302

SUNDRY NOTICES AND REPORTS ON WELLS

NOTICE OF INTENTION TO DRILL.....	<input checked="" type="checkbox"/>	SUBSEQUENT REPORT OF WATER SHUT-OFF.....	
NOTICE OF INTENTION TO CHANGE PLANS.....		SUBSEQUENT REPORT OF SHOOTING OR ACIDIZING.....	
NOTICE OF INTENTION TO TEST WATER SHUT-OFF.....		SUBSEQUENT REPORT OF ALTERING CASING.....	
NOTICE OF INTENTION TO RE-DRILL OR REPAIR WELL.....		SUBSEQUENT REPORT OF RE-DRILLING OR REPAIR.....	
NOTICE OF INTENTION TO SHOOT OR ACIDIZE.....		SUBSEQUENT REPORT OF ABANDONMENT.....	
NOTICE OF INTENTION TO PULL OR ALTER CASING.....		SUPPLEMENTARY WELL HISTORY.....	
NOTICE OF INTENTION TO ABANDON WELL.....			

(INDICATE ABOVE BY CHECK MARK NATURE OF REPORT, NOTICE, OR OTHER DATA)

September 6, 1956

Well No. 91-28 is located 1735 ft. from S line and 1745 ft. from W line of sec. 29

12-14 20 20N 6E 10-11
(1/4 Sec. and Sec. No.) (Twp.) (Range) (Meridian)

Elmore Map Verde Mo Apache New Mexico
(Field) (County or Subdivision) (State or Territory)

Graded Ground

The elevation of the derrick floor above sea level is 5497.3 ft.

DETAILS OF WORK

(State names of and expected depths to objective sands; show sizes, weights, and lengths of proposed casings; indicate mudding jobs, cementing points, and all other important proposed work)

Propose to drill to 175', set 10 3/4" 80 csg. cemented with 175
oz 41 gal, then drill to 3405', set 7 5/8" 61 csg. cemented with 190 oz 85 and
20 oz cement on bottom, then drill to 3630', (total depth) set 5 1/7" csg. cemented
with 190 oz cement. Surf. and line the Cliff House, Mesquite, and Point
Lockhart separately, each with approx. 40,000 gals wt.-s. Clean out to total depth,
set tubing and complete well. 5/2 sec. 29, 320 acres dedicated to this well.

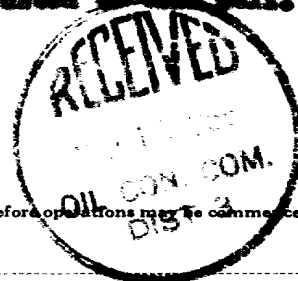

I understand that this plan of work must receive approval in writing by the Geological Survey before operations may be commenced.

Company Pacific Northwest Pipeline Corp.

Address 4021 N. Broadway

Farmington, New Mexico

By Original signed by T. A. Dugan

Title District Engineer

NEW MEXICO
OIL CONSERVATION COMMISSION

Form C-128

Well Location and/or Gas Proration Plat

Date September 4, 1956

Operator PACIFIC NORTHWEST PIPELINE CORPORATION Lease San Juan 22-6

Well No. 22-29 Section 29 Township 28 NORTH Range 6 WEST NMPM

Located 1735 Feet From the SOUTH Line, 1745 Feet From the WEST Line,

RIO ARRIBA County, New Mexico. G. L. Elevation 6497.3 UNGRADED.

Name of Producing Formation Mesa Verde Pool Elm Dedicated Acreage 320

(Note: All distances must be from outer boundaries of Section)

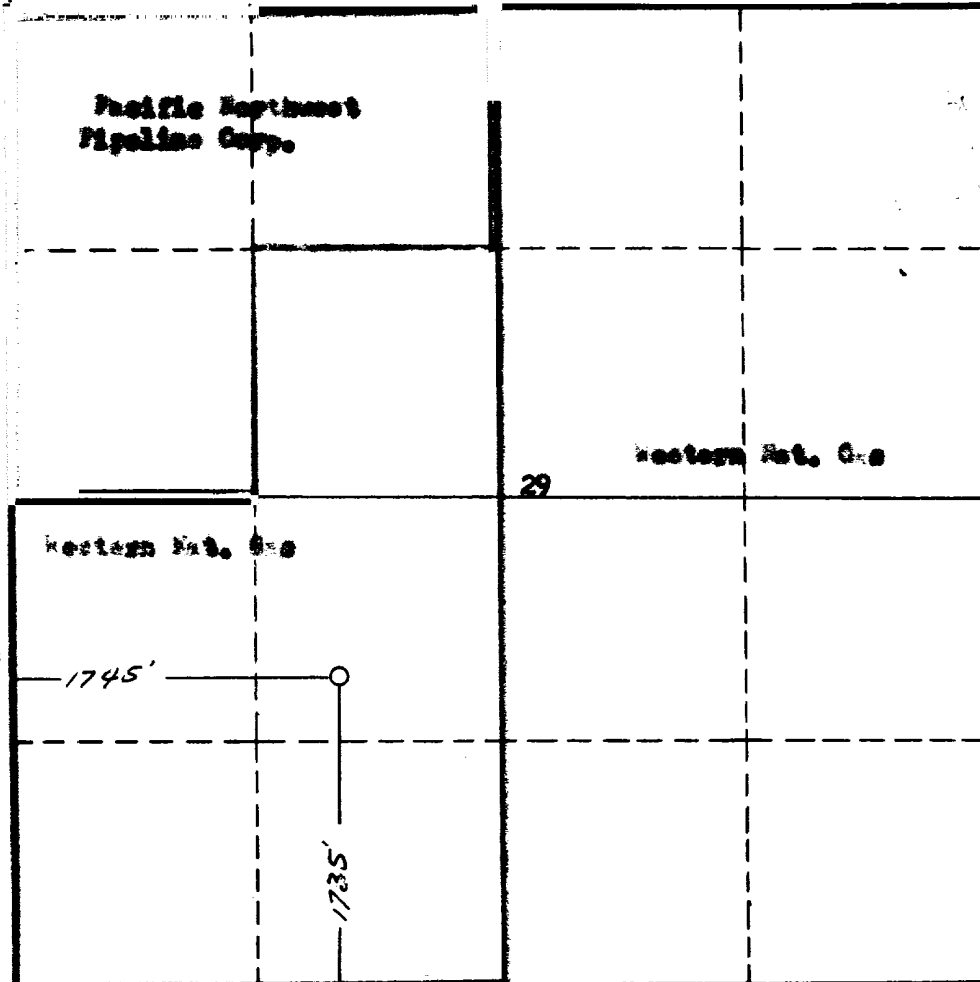

NOTE

This section of form is to be used for gas wells only.



SCALE: 1"=1000'

1. Is this Well a Dual Comp. ? Yes No.
2. If the answer to Question 1 is yes, are there any other dually completed wells within the dedicated acreage ? Yes No.

Name Original signed by T. A. Dugan
Position Chief Engineer
Represent Pacific Northwest Pipeline Corp.
Address 1001 W. Broadway, Farmington, New Mex.

This is to certify that the above plat was prepared from field notes of actual surveys made by me or under my supervision and that the same are true and correct to the best of my knowledge and belief.

Date Surveyed 29 FEBRUARY 1956
James P. Leese
Registered Professional Engineer and/or
Land Surveyor James P. Leese
M. Max. Reg. No. 1463