



COPY TO O.C.C.

UNITED STATES
DEPARTMENT OF THE INTERIOR
GEOLOGICAL SURVEY
P. O. Box 965
Farmington, New Mexico

June 28, 1955

Pacific Northwest Pipe Line Corporation
413 1/2 West Main
Farmington, New Mexico

Re: Jicarilla Cent #60
Tract 115

Gentlemen:

Receipt is acknowledged of your "Notice of Intention to Drill" dated June 27, 1955 covering your well No. 1 Indian "H" in SW 1/4 sec. 15, T. 28 N., R. 3 W., N. M. P. M., Rio Arriba County, New Mexico, Wildcat pool.

Your proposed work is hereby approved subject to compliance with the provisions of the "Oil and Gas Operating Regulations" revised May 25, 1942, a copy of which will be sent to you on request, and subject to the following conditions:

1. Drilling operations so authorized are subject to the attached sheet for general conditions of approval.
2. Furnish copies of all logs.

Very truly yours,

(Orig. Sgd.) P. T. McGrath

P. T. McGrath
District Engineer

PTMcGrath:as

cc: Jicarilla Agency

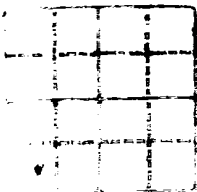

UNITED STATES
DEPARTMENT OF THE INTERIOR
GEOLOGICAL SURVEY
P. O. Box 305
Washington, D. C. 20540



1991, 25 April

Washington, New Mexico
 1917
 Pacific Northwest Pipe Line Corporation

Re: Travel 1964 1965 1966 1967 1968 1969 1970 1971 1972 1973 1974 1975 1976 1977 1978 1979 1980 1981 1982 1983 1984 1985 1986 1987 1988 1989 1990 1991 1992 1993 1994 1995 1996 1997 1998 1999 2000 2001 2002 2003 2004 2005 2006 2007 2008 2009 2010 2011 2012 2013 2014 2015 2016 2017 2018 2019 2020 2021 2022 2023 2024 2025 2026 2027 2028 2029 2030 2031 2032 2033 2034 2035 2036 2037 2038 2039 2040 2041 2042 2043 2044 2045 2046 2047 2048 2049 2050 2051 2052 2053 2054 2055 2056 2057 2058 2059 2060 2061 2062 2063 2064 2065 2066 2067 2068 2069 2070 2071 2072 2073 2074 2075 2076 2077 2078 2079 2080 2081 2082 2083 2084 2085 2086 2087 2088 2089 2090 2091 2092 2093 2094 2095 2096 2097 2098 2099 2100 2101 2102 2103 2104 2105 2106 2107 2108 2109 2110 2111 2112 2113 2114 2115 2116 2117 2118 2119 2120 2121 2122 2123 2124 2125 2126 2127 2128 2129 2130 2131 2132 2133 2134 2135 2136 2137 2138 2139 2140 2141 2142 2143 2144 2145 2146 2147 2148 2149 2150 2151 2152 2153 2154 2155 2156 2157 2158 2159 2160 2161 2162 2163 2164 2165 2166 2167 2168 2169 2170 2171 2172 2173 2174 2175 2176 2177 2178 2179 2180 2181 2182 2183 2184 2185 2186 2187 2188 2189 2190 2191 2192 2193 2194 2195 2196 2197 2198 2199 2200 2201 2202 2203 2204 2205 2206 2207 2208 2209 2210 2211 2212 2213 2214 2215 2216 2217 2218 2219 2220 2221 2222 2223 2224 2225 2226 2227 2228 2229 2230 2231 2232 2233 2234 2235 2236 2237 2238 2239 2240 2241 2242 2243 2244 2245 2246 2247 2248 2249 2250 2251 2252 2253 2254 2255 2256 2257 2258 2259 2260 2261 2262 2263 2264 2265 2266 2267 2268 2269 2270 2271 2272 2273 2274 2275 2276 2277 2278 2279 2280 2281 2282 2283 2284 2285 2286 2287 2288 2289 2290 2291 2292 2293 2294 2295 2296 2297 2298 2299 2300 2301 2302 2303 2304 2305 2306 2307 2308 2309 2310 2311 2312 2313 2314 2315 2316 2317 2318 2319 2320 2321 2322 2323 2324 2325 2326 2327 2328 2329 2330 2331 2332 2333 2334 2335 2336 2337 2338 2339 2340 2341 2342 2343 2344 2345 2346 2347 2348 2349 2350 2351 2352 2353 2354 2355 2356 2357 2358 2359 2360 2361 2362 2363 2364 2365 2366 2367 2368 2369 2370 2371 23

[illegible]

With the provisions of the Bill and the Operating Regulations, revised and approved subject to compliance with the provisions of the Bill and the Operating Regulations, and subject to the following conditions:

Drilling operations are subject to the approval of the General Conditions of Approval.

• 4901 115 70 201000 201000 •

• 3000 •

1950M.T.9 (bg2.ph0)

P. T. Houghton
District Engineer

32:18, 19, 20, 21

102



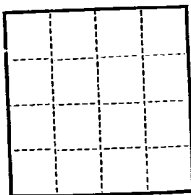

4 - U.S.G.S.
2 - U.S. Department of the Interior
1 - File
(SUBMIT IN TRIPLICATE)

UNITED STATES
DEPARTMENT OF THE INTERIOR
GEOLOGICAL SURVEY

Land Office Butte
Lease No. 60 Block 115
Unit Butte

SUNDRY NOTICES AND REPORTS ON WELLS

NOTICE OF INTENTION TO DRILL	<input checked="" type="checkbox"/>	SUBSEQUENT REPORT OF WATER SHUT-OFF	
NOTICE OF INTENTION TO CHANGE PLANS		SUBSEQUENT REPORT OF SHOOTING OR ACIDIZING	
NOTICE OF INTENTION TO TEST WATER SHUT-OFF		SUBSEQUENT REPORT OF ALTERING CASING	
NOTICE OF INTENTION TO RE-DRILL OR REPAIR WELL		SUBSEQUENT REPORT OF RE-DRILLING OR REPAIR	
NOTICE OF INTENTION TO SHOOT OR ACIDIZE		SUBSEQUENT REPORT OF ABANDONMENT	
NOTICE OF INTENTION TO PULL OR ALTER CASING		SUPPLEMENTARY WELL HISTORY	
NOTICE OF INTENTION TO ABANDON WELL			

(INDICATE ABOVE BY CHECK MARK NATURE OF REPORT, NOTICE, OR OTHER DATA)

Well No. 1 is located 900 ft. from N line and 900 ft. from W line of sec. 36
(1/4 Sec. and Sec. No.) (Twp.) (Range) (Section)
111000 (Field) 111000 (County or Subdivision) 111000 (State or Territory)

The elevation of the surface or above sea level is 1000.1 ft.

DETAILS OF WORK

(State names of and expected depths to objective sands; show sizes, weights, and lengths of proposed casings; indicate mudding jobs, cementing points, and all other important proposed work)

Prepare to drill 12" hole to 200', set 20-2 1/2" casing at that point and cement w/ 200 on 45 gal cement. Drill w/ 12" to 300', set 20-2 1/2" casing and cement w/ 200 on 45 gal cement. Drill w/ 12" to 400', set 20-2 1/2" casing and cement w/ 200 on 45 gal cement. Then drill the New York formation to 400', cement the point instead w/ 20,000 gal treatment and test. Perforate the casing opposite the Hunter, cement the formation w/ 20,000 gal treatment and test. Perforate the Williams and test w/ 20,000 gal treatment and test. Following these tests, close out well, run 2-1/2" casing and complete.

I understand that this plan of work must receive approval in writing by the Geological Survey before operations may be commenced.

Company Butte Petroleum Pipe Line Corporation

Address 413-1/2 N. 2nd
Farmington, New Mexico

By L. A. Rye
Title Engineer

...the ... of ...

...the ... of ...

...the ... of ...

...the ... of ...

...the ... of ...

...the ... of ...

...the ... of ...

...the ... of ...

...the ... of ...

...the ... of ...

...the ... of ...

...the ... of ...

...the ... of ...

...the ... of ...

...the ... of ...

...the ... of ...

...the ... of ...

...the ... of ...

...the ... of ...

...the ... of ...

...the ... of ...

...the ... of ...

...the ... of ...

...the ... of ...

Company..... **PACIFIC NORTHWEST PIPELINE CORPORATION**

Lease..... Well No.....

Sec. **15** , T. **28 N.** , R. **3 W.** **N.M.P.M.**

Location..... **990' from the South line and 990'**
from the West line

Elevation..... **7039.13 Ungraded ground**

Rio Arriba Co.

New Mexico

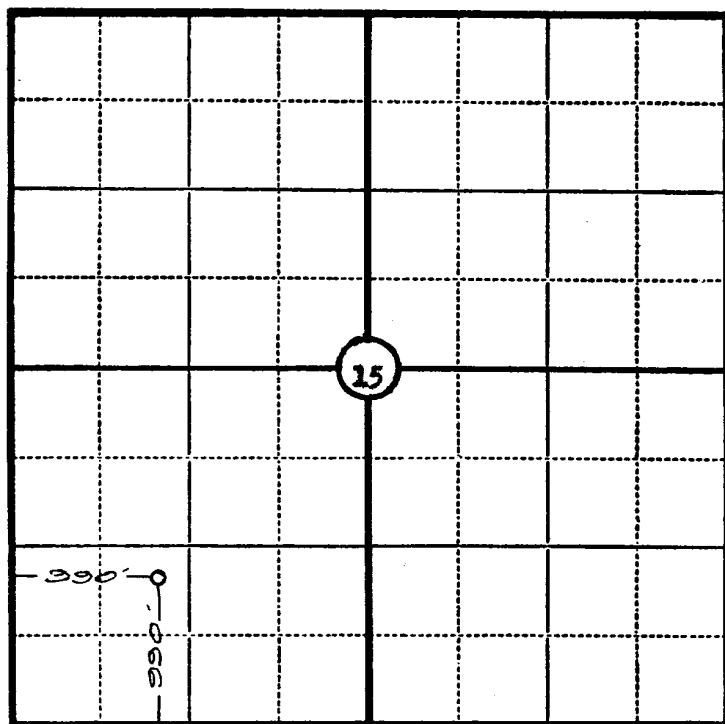

Scale—4 inches equal 1 mile.

This is to certify that the above plat was prepared from field notes of actual surveys made by me or under my supervision and that the same are true and correct to the best of my knowledge and belief.

Seal:

Jama P. Reese

Registered **Land Surveyor** **N.M. Reg. No. 1463**

Surveyed **June 24**, 19 **55**